



Microsoft

Exam Questions MS-101

Microsoft 365 Mobility and Security (beta)

About ExamBible

Your Partner of IT Exam

Found in 1998

ExamBible is a company specialized on providing high quality IT exam practice study materials, especially Cisco CCNA, CCDA, CCNP, CCIE, Checkpoint CCSE, CompTIA A+, Network+ certification practice exams and so on. We guarantee that the candidates will not only pass any IT exam at the first attempt but also get profound understanding about the certificates they have got. There are so many alike companies in this industry, however, ExamBible has its unique advantages that other companies could not achieve.

Our Advances

* 99.9% Uptime

All examinations will be up to date.

* 24/7 Quality Support

We will provide service round the clock.

* 100% Pass Rate

Our guarantee that you will pass the exam.

* Unique Gurantee

If you do not pass the exam at the first time, we will not only arrange FULL REFUND for you, but also provide you another exam of your claim, ABSOLUTELY FREE!

NEW QUESTION 1

- (Exam Topic 1)

You need to meet the compliance requirements for the Windows 10 devices. What should you create from the Intune admin center?

- A. a device compliance policy
- B. a device configuration profile
- C. an application policy
- D. an app configuration policy

Answer: C

NEW QUESTION 2

- (Exam Topic 1)

You need to meet the Intune requirements for the Windows 10 devices.

What should you do? To answer, select the appropriate options in the answer area.

NOTE: Each correct selection is worth one point.

Settings to configure in Azure AD:

| | |
|--------------------------|------------------------------|
| <input type="checkbox"/> | Device settings |
| <input type="checkbox"/> | Mobility (MDM and MAM) |
| <input type="checkbox"/> | Organizational relationships |
| <input type="checkbox"/> | User settings |

Settings to configure in Intune:

| | |
|--------------------------|------------------------------------|
| <input type="checkbox"/> | Device compliance |
| <input type="checkbox"/> | Device configuration |
| <input type="checkbox"/> | Device enrollment |
| <input type="checkbox"/> | Mobile Device Management Authority |

- A. Mastered
- B. Not Mastered

Answer: A

Explanation:

References:

<https://docs.microsoft.com/en-us/intune/windows-enroll>

NEW QUESTION 3

- (Exam Topic 1)

On which server should you install the Azure ATP sensor?

- A. Server 1
- B. Server 2
- C. Server 3
- D. Server 4
- E. Server 5

Answer: A

Explanation:

References:

<https://docs.microsoft.com/en-us/azure-advanced-threat-protection/atp-capacity-planning>

However, if the case study had required that the DCs can't have any s/w installed, then the answer would have been a standalone sensor on Server2. In this scenario, the given answer is correct. BTW, ATP now known as Defender for Identity.

NEW QUESTION 4

- (Exam Topic 1)

As of March, how long will the computers in each office remain supported by Microsoft? To answer, select the appropriate options in the answer area.

NOTE: Each correct selection is worth one point.

Seattle:

| | |
|-----------|---|
| | ▼ |
| 6 months | |
| 18 months | |
| 24 months | |
| 30 months | |
| 5 years | |

New York:

| | |
|-----------|---|
| | ▼ |
| 6 months | |
| 18 months | |
| 24 months | |
| 30 months | |
| 5 years | |

- A. Mastered
- B. Not Mastered

Answer: A

Explanation:

<https://support.microsoft.com/en-gb/help/13853/windows-lifecycle-fact-sheet> March Feature Updates: Serviced for 18 months from release date September Feature Updates: Serviced for 30 months from release date

References:

<https://www.windowscentral.com/whats-difference-between-quality-updates-and-feature-updates-windows-10>

NEW QUESTION 5

- (Exam Topic 1)

On which server should you use the Defender for identity sensor?

- A. Server1
- B. Server2
- C. Server3
- D. Server4
- E. Servers5

Answer: A

Explanation:

However, if the case study had required that the DCs can't have any s/w installed, then the answer would have been a standalone sensor on Server2. In this scenario, the given answer is correct. BTW, ATP now known as Defender for Identity.

NEW QUESTION 6

- (Exam Topic 2)

You need to protect the U.S. PII data to meet the technical requirements. What should you create?

- A. a data loss prevention (DLP) policy that contains a domain exception
- B. a Security & Compliance retention policy that detects content containing sensitive data
- C. a Security & Compliance alert policy that contains an activity
- D. a data loss prevention (DLP) policy that contains a user override

Answer: A

NEW QUESTION 7

- (Exam Topic 2)

You need to meet the requirement for the legal department.

Which three actions should you perform in sequence from the Security & Compliance admin center? To answer, move the appropriate actions from the list of actions to the answer area and arrange them in the correct order.

| Actions | Answer Area |
|---|-------------|
| Create a data loss prevention (DLP) policy. | |
| Create an eDiscovery case. | |
| Create a label. | |
| Run a content search. | |
| Create a label policy. | |
| Create a hold. | |
| Assign eDiscovery permissions. | |
| Publish a label. | |

- A. Mastered
B. Not Mastered

Answer: A

Explanation:

References:

<https://www.sherweb.com/blog/ediscovery-office-365/>

NEW QUESTION 8

- (Exam Topic 2)

You need to meet the technical requirement for large-volume document retrieval. What should you create?

- A. a data loss prevention (DLP) policy from the Security & Compliance admin center
B. an alert policy from the Security & Compliance admin center
C. a file policy from Microsoft Cloud App Security
D. an activity policy from Microsoft Cloud App Security

Answer: D

Explanation:

References:

<https://docs.microsoft.com/en-us/office365/securitycompliance/activity-policies-and-alerts>

NEW QUESTION 9

- (Exam Topic 2)

Which report should the New York office auditors view?

- A. DLP policy matches
B. DLP false positives and overrides
C. DLP incidents
D. Top Senders and Recipients

Answer: C

Explanation:

References:

<https://docs.microsoft.com/en-us/office365/securitycompliance/data-loss-prevention-policies>

This report also shows policy matches over time, like the policy matches report. However, the policy matches report shows matches at a rule level; for example, if an email matched three different rules, the policy matches report shows three different line items. By contrast, the incidents report shows matches at an item level; for example, if an email matched three different rules, the incidents report shows a single line item for that piece of content. Because the report counts are aggregated differently, the policy matches report is better for identifying matches with specific rules and fine tuning DLP policies. The incidents report is better for identifying specific pieces of content that are problematic for your DLP policies.

NEW QUESTION 10

- (Exam Topic 3)

You plan to implement the endpoint protection device configuration profiles to support the planned changes. You need to identify which devices will be supported, and how many profiles you should implement.

What should you identify? To answer, select the appropriate options in the answer area.

NOTE: Each correct selection is worth one point.

Supported devices:

| | |
|---|---|
| | ▼ |
| Device1 only | |
| Device1 and Device2 only | |
| Device1 and Device3 only | |
| Device1, Device2, and Device3 | |
| Device1, Device4, and Device5 | |
| Device1, Device2, Device3, Device4, and Device5 | |

Number of required profiles:

| | |
|---|---|
| | ▼ |
| 1 | |
| 2 | |
| 3 | |
| 4 | |
| 5 | |

- A. Mastered
- B. Not Mastered

Answer: A

Explanation:

Table Description automatically generated

Reference:

<https://docs.microsoft.com/en-us/mem/intune/configuration/device-profile-create>

NEW QUESTION 10

- (Exam Topic 4)

You plan to use the Security & Compliance admin center to import several PST files into Microsoft 365 mailboxes.

Which three actions should you perform before you import the data? Each correct answer presents part of the solution.

NOTE: Each correct selection is worth one point.

- A. From the Exchange admin center, create a public folder.
- B. Copy the PST files by using AzCopy.
- C. From the Exchange admin center, assign admin roles.
- D. From the Microsoft Azure portal, create a storage account that has a blob container.
- E. From the Microsoft 365 admin center, deploy an add-in.
- F. Create a mapping file that uses the CSV file format.

Answer: BCF

Explanation:

References:

<https://docs.microsoft.com/en-us/office365/securitycompliance/use-network-upload-to-import-pst-files>

NEW QUESTION 12

- (Exam Topic 4)

You have a Microsoft 365 E5 subscription that contains the users shown in the following table.

| Name | Member of |
|-------|----------------|
| User1 | Group1, Group2 |
| User2 | Group2, Group3 |
| User3 | Group1, Group3 |

In Microsoft Endpoint Manager, you have the Policies for Office apps settings shown in the following table.

| Name | Priority | Applies to |
|---------|----------|------------|
| Policy1 | 0 | Group1 |
| Policy2 | 1 | Group2 |
| Policy3 | 2 | Group3 |

The policies use the settings shown in the following table.

| Name | Cursor movement | Clear cache on close |
|---------|-----------------|----------------------|
| Policy1 | Logical | Disabled |
| Policy2 | Not configured | Enabled |
| Policy3 | Visual | Enabled |

For each of the following statements, select Yes if the statement is true. Otherwise, select No.

NOTE: Each correct selection is worth one point.

| Statements | Yes | No |
|--|-----------------------|-----------------------|
| User1 has their cache cleared on close. | <input type="radio"/> | <input type="radio"/> |
| User2 has Cursor movement set to Visual. | <input type="radio"/> | <input type="radio"/> |
| User3 has Cursor movement set to Visual. | <input type="radio"/> | <input type="radio"/> |

- A. Mastered
B. Not Mastered

Answer: A

Explanation:

Graphical user interface, text, application Description automatically generated

Reference:

<https://docs.microsoft.com/en-us/deployoffice/overview-office-cloud-policy-service>

NEW QUESTION 13

- (Exam Topic 4)

You have a Microsoft 365 tenant.

You plan to implement Endpoint Protection device configuration profiles. Which platform can you manage by using the profile?

- A. Ubuntu Linux
B. macOS
C. iOS
D. Android

Answer: B

Explanation:

Intune device configuration profiles can be applied to Windows 10 devices and macOS devices Note:

There are several versions of this question in the exam. The question has two possible correct answers:

- Windows 10
- macOS

Other incorrect answer options you may see on the exam include the following:

- Android Enterprise
- Windows 8.1 Reference:

<https://docs.microsoft.com/en-us/mem/intune/protect/endpoint-protection-configure>

NEW QUESTION 17

- (Exam Topic 4)

You have a Microsoft 365 E5 tenant that has sensitivity label support enabled for Microsoft and SharePoint Online.

You need to enable unified labeling for Microsoft 365 groups.

Which cmdlet should you run?

- A. set-unifiedGroup
B. Set-Labelpolicy
C. Execute-AzureAdLabelSync
D. Add-UnifiedGroupLinks

Answer: B

NEW QUESTION 22

- (Exam Topic 4)

You have a Microsoft 365 E5 subscription.

Users have the devices shown in the following table.

| Name | Platform | Owner | Enrolled in Microsoft Endpoint Manager |
|---------|------------|-------|--|
| Device1 | Android | User1 | Yes |
| Device2 | Android | User1 | No |
| Device3 | iOS | User1 | No |
| Device4 | Windows 10 | User2 | Yes |
| Device5 | Windows 10 | User2 | No |
| Device6 | iOS | User2 | Yes |

On which devices can you manage apps by using app configuration policies in Microsoft Endpoint Manager?

- A. Device1, Device4, and Device6
B. Device2, Device3, and Device5

- C. Device1, Device2, Device3, and Device6
- D. Device1, Device2, Device4, and Device5

Answer: C

Explanation:

You can create and use app configuration policies to provide configuration settings for both iOS/iPadOS or Android apps on devices that are and are not enrolled in Microsoft Endpoint Manager.

Reference:

<https://docs.microsoft.com/en-us/mem/intune/apps/app-configuration-policies-overview>

NEW QUESTION 23

- (Exam Topic 4)

You have a Microsoft 365 E5 subscription that uses Microsoft Intune and contains the devices shown in the following table.

| Name | Platform | Intune |
|---------|----------|--------------|
| Device1 | iOS | Enrolled |
| Device2 | macOS | Not enrolled |

You need to onboard Device1 and Device2 to Microsoft Defender for Endpoint.

What should you use to onboard each device? To answer, select the appropriate options in the answer area. NOTE: Each correct selection is worth one point.

Answer Area

Device1:

Microsoft Endpoint Manager

A local script

Group Policy

Microsoft Endpoint Manager

An app from the Google Play store

Integration with Microsoft Defender for Cloud

Device2:

A local script

A local script

Group Policy

Microsoft Endpoint Manager

An app from the Google Play store

Integration with Microsoft Defender for Cloud

- A. Mastered
- B. Not Mastered

Answer: A

Explanation:

Answer Area

Device1:

Microsoft Endpoint Manager

A local script

Group Policy

Microsoft Endpoint Manager

An app from the Google Play store

Integration with Microsoft Defender for Cloud

Device2:

A local script

A local script

Group Policy

Microsoft Endpoint Manager

An app from the Google Play store

Integration with Microsoft Defender for Cloud

NEW QUESTION 27

- (Exam Topic 4)

You have a Microsoft 365 tenant that contains 1,000 iOS devices enrolled in Microsoft Intune. You plan to purchase volume-purchased apps and deploy the apps to the devices. You need to track used licenses and manage the apps by using Intune. What should you use to purchase the apps?

- A. Microsoft Store for Business
- B. Apple Business Manager
- C. Apple iTunes Store
- D. Apple Configurator

Answer: B

Explanation:

Reference:

<https://docs.microsoft.com/en-us/mem/intune/apps/vpp-apps-ios>

NEW QUESTION 32

- (Exam Topic 4)

You need to notify the manager of the human resources department when a user in the department shares a file or folder from the departments Microsoft SharePoint Online site. What should you do?

- A. From the SharePoint Online site, create an alert.
- B. From the SharePoint Online admin center, modify the sharing settings.
- C. From the Microsoft 365 Defender portal, create an alert policy.
- D. From the Microsoft Purview compliance portal, create a data loss prevention (DLP) policy.

Answer: C

NEW QUESTION 35

- (Exam Topic 4)

You have a Microsoft 365 subscription that contains the alerts shown in the following table.

| Name | Severity | Status | Comment | Category |
|--------|----------|----------|----------|-------------------|
| Alert1 | Medium | Active | Comment1 | Threat management |
| Alert2 | Low | Resolved | Comment2 | Other |

Which properties of the alerts can you modify?

- A. Status only
- B. Status and Comment only
- C. Status and Severity only
- D. Status, Severity, and Comment only
- E. Status, Severity, Comment and Category

Answer: B

Explanation:

Reference:

<https://docs.microsoft.com/en-us/microsoft-365/security/defender-endpoint/update-alert?view=o365-worldwide#>

NEW QUESTION 37

- (Exam Topic 4)

You have a Microsoft 365 E5 tenant that contains 100 Windows 10 devices. You plan to attack surface reduction (ASR) rules for the Windows 10 devices.

You configure the ASR rules in audit mode and collect audit data in a Log Analytics workspace. You need to find the ASR rules that match the activities on the devices.

How should you complete the Kusto query? To answer, select the appropriate options in the answer area.

NOTE: Each correct selection is worth one point.

▼

AlertInfo

DeviceEvents

DeviceInfo

|

▼

ActionType startswith 'ASR'

lookup

project

render

where

- A. Mastered
- B. Not Mastered

Answer: A

Explanation:

Graphical user interface, application Description automatically generated

Reference:

<https://techcommunity.microsoft.com/t5/microsoft-defender-for-endpoint/demystifying-attack-surface-reduction>

NEW QUESTION 40

- (Exam Topic 4)

You have a Microsoft 365 tenant that contains a Windows 10 device named Device1 and the Microsoft Endpoint Manager policies shown in the following table.

| Name | Type | Block execution of potentially obfuscated scripts (js/vbs/ps) |
|---------|---------------------------------|---|
| Policy1 | Attack surface reduction (ASR) | Audit mode |
| Policy2 | Microsoft Defender ATP Baseline | Disable |
| Policy3 | Device configuration profile | Not configured |

The policies are assigned to Device1.

Which policy settings will be applied to Device1?

- A. only the settings of Policy1
- B. only the settings of Policy2
- C. only the settings of Policy3
- D. no settings

Answer: D

NEW QUESTION 42

- (Exam Topic 4)

You have a Microsoft Azure Active Directory (Azure AD) tenant named contoso.com. You have three applications named App1, App2, and App3 that have the same file format.

Your company uses Windows Information Protection (WIP). WIP has the following configurations:

- > Windows Information Protection mode: Silent
- > Protected apps: App1
- > Exempt apps: App2

From App1, you create a file named File1.

What is the effect of the configurations? To answer, select the appropriate options in the answer area.

NOTE: Each correct selection is worth one point.

You can open File1 from:

▼

App1 only

App1 and App2 only

App1 and App3 only

App1, App2 and App3

If you open File1 in App1, App2, and App3, an action will be logged for:

▼

App1 only

App3 only

App1 and App2 only

App2 and App3 only

App1, App2, and App3

- A. Mastered
- B. Not Mastered

Answer: A

Explanation:

You can open File1 from:

▼

App1 only

App1 and App2 only

App1 and App3 only

App1, App2 and App3

If you open File1 in App1, App2, and App3, an action will be logged for:

▼

App1 only

App3 only

App1 and App2 only

App2 and App3 only

App1, App2, and App3

NEW QUESTION 43

- (Exam Topic 4)

Note: This question is part of a series of questions that present the same scenario. Each question in the series contains a unique solution that might meet the stated goals. Some question sets might have more than one correct solution, while others might not have a correct solution.

After you answer a question in this section, you will NOT be able to return to it. As a result, these questions will not appear in the review screen.

You have a Microsoft 365 subscription.

From the Security & Compliance admin center, you create a role group named US eDiscovery Managers by copying the eDiscovery Manager role group.

You need to ensure that the users in the new role group can only perform content searches of mailbox content for users in the United States.

Solution: From Windows PowerShell, you run the New-AzureRmRoleAssignment cmdlet with the appropriate parameters.

Does this meet the goal?

A. Yes

B. No

Answer: B

Explanation:

References:

<https://docs.microsoft.com/en-us/powershell/module/azurerm.resources/new-azurermroleassignment?view=azur>

NEW QUESTION 45

- (Exam Topic 4)

You have a Microsoft 365 subscription that contains a user named User1 and a Microsoft SharePoint Online site named Site1. User1 is assigned the Owner role for Site1. To Site1, you publish the file plan retention labels shown in the following table.

| Name | Retention period | During the retention period |
|------------|------------------|-----------------------------------|
| Retention1 | 5 years | Retain items even if users delete |
| Retention2 | 5 years | Mark items as a record |
| Retention3 | 5 years | Mark items as a regulatory record |

Site1 contains the files shown in the following table.

| Name | Label |
|-------|------------|
| File1 | None |
| File2 | Retention1 |
| File3 | Retention2 |
| File4 | Retention3 |

Which files can User1 rename, and which files can User1 delete? To answer, select the appropriate options in the answer area.

NOTE: Each correct selection is worth one point.

Answer Area

Rename:

File1, File2, and File3 only

File1 only

File1 and File2 only

File1, File2, and File3 only

File1, File2, File3, and File4

Delete:

File1 and File2 only

File1 only

File1 and File2 only

File1, File2, and File3 only

File1, File2, File3, and File4

A. Mastered

B. Not Mastered

Answer: A

Explanation:

Answer Area

Rename:

File1, File2, and File3 only

File1 only

File1 and File2 only

File1, File2, and File3 only

File1, File2, File3, and File4

Delete:

File1 and File2 only

File1 only

File1 and File2 only

File1, File2, and File3 only

File1, File2, File3, and File4

NEW QUESTION 48

- (Exam Topic 4)
 You have a Microsoft 365 E5 tenant.
 The Microsoft Secure Score for the tenant is shown in the following exhibit.

Microsoft Secure Score

Overview

Improvement actions

History

Metrics & trends

Actions you can take to improve your Microsoft Secure Score. Score updates may take up to 24 hours.

Export

12 items

Search

Filter

Group by

Applied filters:

| Rank | Improvement action | Score impact | Points achieved |
|------|--|--------------|-----------------|
| 1 | Require MFA for administrative roles | +16.95% | 0/10 |
| 2 | Ensure all users can complete multi-factor authentication for... | +15.25% | 0/9 |
| 3 | Enable policy to block legacy authentication | +13.56% | 0/8 |
| 4 | Turn on user risk policy | +11.86% | 0/7 |
| 5 | Turn on sign-in risk policy | +11.86% | 0/7 |
| 6 | Do not allow users to grant consent to unmanaged applicatio... | +6.78% | 0/4 |
| 7 | Enable self-service password reset | +1.69% | 0/1 |
| 8 | Turn on customer lockbox feature | +1.69% | 0/1 |
| 9 | Use limited administrative roles | +1.69% | 0/1 |
| 10 | Designate more than one global admin | +1.69% | 0/1 |

You plan to enable Security defaults for Azure Active Directory (Azure AD).
 Which three improvement actions will this affect?

A. Require MFA for administrative roles.
 B. Ensure all users can complete multi-factor authentication for secure access
 C. Enable policy to block legacy authentication
 D. Enable self-service password reset
 E. Use limited administrative roles

Answer: ABC

Explanation:
 Reference:
<https://docs.microsoft.com/en-us/azure/active-directory/fundamentals/concept-fundamentals-security-defaults>

NEW QUESTION 49

- (Exam Topic 4)
 You have a Microsoft 365 E5 tenant that contains the users shown in the following table.

| Name | Member of |
|-------|-----------|
| User1 | Group1 |
| User2 | Group2 |

You purchase the devices shown in the following table.

| Name | Platform |
|---------|------------|
| Device1 | Windows 10 |
| Device2 | Android |

In Microsoft Endpoint Manager, you create an enrollment status page profile that has the following settings: ➤ Show app and profile configuration progress: Yes

- Allow users to collect logs about installation errors: Yes
- Only show page to devices provisioned by out-of-box experience (OOBE): No
- Assignments: Group2

For each of the following statements, select Yes if the statement is true. Otherwise, select No.
NOTE: Each correct selection is worth one point.

| Statements | Yes | No |
|---|-----------------------|-----------------------|
| If User1 enrolls Device1 in Microsoft Endpoint Manager, the enrollment status page will appear. | <input type="radio"/> | <input type="radio"/> |
| If User2 enrolls Device1 in Microsoft Endpoint Manager, the enrollment status page will appear. | <input type="radio"/> | <input type="radio"/> |
| If User2 enrolls Device2 in Microsoft Endpoint Manager, the enrollment status page will appear. | <input type="radio"/> | <input type="radio"/> |

- A. Mastered
- B. Not Mastered

Answer: A

Explanation:

Graphical user interface, text, application, email Description automatically generated

Reference:

<https://docs.microsoft.com/en-us/mem/intune/enrollment/windows-enrollment-status>

NEW QUESTION 54

- (Exam Topic 4)

You have a Microsoft 365 E5 subscription that contains the devices shown in the following table.

| Name | Platform |
|---------|------------|
| Device1 | Windows 11 |
| Device2 | Windows 10 |
| Device3 | Android |
| Device4 | iOS |

All the devices are onboarded To Microsoft Defender for Endpoint

You plan to use Microsoft Defender Vulnerability Management to meet the following requirements:

- Detect operating system vulnerabilities.

Answer Area

Detect operating system vulnerabilities

Device1 only

Device1 and Device2 only

Device1, Device2, and Device3 only

Device1, Device2, and Device4 only

Device1, Device2, Device3 and Device4

Perform a configuration assessment of the operating system

Device1 only

Device1 and Device2 only

Device1, Device2, and Device3 only

Device1, Device2, and Device4 only

Device1, Device2, Device3 and Device4

- A. Mastered
- B. Not Mastered

Answer: A

Explanation:

Answer Area

Detect operating system vulnerabilities

▼

Device1 only

Device1 and Device2 only

Device1, Device2, and Device3 only

Device1, Device2, and Device4 only

Device1, Device2, Device3 and Device4

Perform a configuration assessment of the operating system

▼

Device1 only

Device1 and Device2 only

Device1, Device2, and Device3 only

Device1, Device2, and Device4 only

Device1, Device2, Device3 and Device4

NEW QUESTION 58

- (Exam Topic 4)

You have a Microsoft 365 E5 subscription. The subscription contains users that have the following types of devices:

- Windows 10
- Android
- OS

On which devices can you configure the Endpoint DLP policies?

- A. Windows 10 only
- B. Windows 10 and Android only
- C. Windows 10 and macOS only
- D. Windows 10, Android, and iOS

Answer: C

Explanation:

Endpoint data loss prevention (Endpoint DLP) extends the activity monitoring and protection capabilities of DLP to sensitive items that are physically stored on Windows 10, Windows 11, and macOS (Catalina 10.15 and higher) devices. Once devices are onboarded into the Microsoft Purview solutions, the information about what users are doing with sensitive items is made visible in activity explorer and you can enforce protective actions on those items via DLP policies.

<https://docs.microsoft.com/en-us/microsoft-365/compliance/endpoint-dlp-learn-about?view=o365-worldwide>

NEW QUESTION 60

- (Exam Topic 4)

Note: This question is part of a series of questions that present the same scenario. Each question in the series contains a unique solution that might meet the stated goals. Some question sets might have more than one correct solution, while others might not have a correct solution.

After you answer a question in this section, you will NOT be able to return to it. As a result, these questions will not appear in the review screen.

Your network contains an on-premises Active Directory domain. The domain contains 2,000 computers that run Windows 8.1 and have applications installed as shown in the following table.

| Name | Application count | Used by |
|------|-------------------|--------------------------------------|
| App1 | 20 | Finance department, sales department |
| App2 | 100 | Marketing department |

You enroll all the computers in Upgrade Readiness.

You need to ensure that App1 and App2 have an UpgradeDecision status of Ready to upgrade. Solution: You set the ReadyForWindows status of App1 to Highly adopted.

Does this meet the goal?

- A. Yes
- B. No

Answer: B

Explanation:

App1 has a "low install count" (2% or less) so will be Ready to upgrade. We need to change the setting for App2.

References:

<https://docs.microsoft.com/en-us/windows/deployment/upgrade/upgrade-readiness-identify-apps>

NEW QUESTION 61

- (Exam Topic 4)

Your company uses Microsoft System Center Configuration Manager (Current Branch) and Microsoft Intune to co-manage devices.

Which two actions can be performed only from Intune? Each correct answer presents a complete solution.

NOTE: Each correct selection is worth one point.

- A. Deploy applications to Windows 10 devices.
- B. Deploy VPN profiles to iOS devices.
- C. Deploy VPN profiles to Windows 10 devices.
- D. Publish applications to Android devices.

Answer: BD

Explanation:

References:

<https://docs.microsoft.com/en-us/sccm/comanage/overview> <https://docs.microsoft.com/en-us/sccm/mdm/deploy-use/create-vpn-profiles>

NEW QUESTION 66

- (Exam Topic 4)

You have a Microsoft 365 tenant.

You need to retain Azure Active Directory (Azure AD) audit logs for two years. Administrators must be able to query the audit log information by using the Azure Active Directory admin center.

What should you do? To answer, select the appropriate options in the answer area. NOTE: Each correct selection is worth one point.

Answer Area

Save the audit logs to:

Azure Active Directory admin center blade to use to view the saved audit logs:

- A. Mastered
- B. Not Mastered

Answer: A

Explanation:

Answer Area

Save the audit logs to:

Azure Active Directory admin center blade to use to view the saved audit logs:

NEW QUESTION 68

- (Exam Topic 4)

Your company has a Microsoft 365 subscription.

You need to configure Microsoft 365 to meet the following requirements:

- Malware found in email attachments must be quarantined for 20 days.
- The email address of senders to your company must be verified.

Which two options should you configure in the Security & Compliance admin center? To answer, select the appropriate options in the answer area.

NOTE: Each correct selection is worth one point.

Answer Area



- A. Mastered
- B. Not Mastered

Answer: A

Explanation:

Answer Area



NEW QUESTION 69

- (Exam Topic 4)

You have a Microsoft 365 E5 subscription.

You create an account for a new security administrator named SecAdmin1.

You need to ensure that SecAdmin1 can manage Microsoft Defender for Office 365 settings and policies for Microsoft Teams, SharePoint and OneDrive.
Solution: From the Azure Active Directory admin center, you assign SecAdmin1 the Teams Administrator role.
Does this meet the goal?

- A. Yes
- B. no

Answer: B

NEW QUESTION 73

- (Exam Topic 4)

You have a Microsoft 365 tenant that contains the groups shown in the following table.

| Name | Type |
|--------|-----------------------|
| Group1 | Distribution |
| Group2 | Mail-enabled security |
| Group3 | Security |

You plan to create a new Windows 10 Security Baseline profile. To which groups can you assign to the profile?

- A. Group3 only
- B. Group1 and Group3 only
- C. Group2 and Group3 only
- D. Group1. Group2. and Group3

Answer: A

Explanation:

Reference:

<https://docs.microsoft.com/en-us/mem/intune/protect/security-baselines-configure#create-the-profile> <https://docs.microsoft.com/en-us/microsoft-365/admin/create-groups/compare-groups?view=o365-worldwide>

NEW QUESTION 77

- (Exam Topic 4)

Note: This question is part of a series of questions that present the same scenario. Each question in the series contains a unique solution that might meet the stated goals. Some question sets might have more than one correct solution, while others might not have a correct solution.

After you answer a question in this section, you will NOT be able to return to it. As a result, these questions will not appear in the review screen.

You have a Microsoft 365 subscription.

You need to prevent users from accessing your Microsoft SharePoint Online sites unless the users are connected to your on-premises network.

Solution: From the Device Management admin center, you create a trusted location and a compliance policy. Does this meet the goal?

- A. Yes
- B. No

Answer: B

Explanation:

Conditional Access in SharePoint Online can be configured to use an IP Address white list to allow access. References:

<https://techcommunity.microsoft.com/t5/Microsoft-SharePoint-Blog/Conditional-Access-in-SharePoint-Onlinea>

NEW QUESTION 81

- (Exam Topic 4)

DRAG DROP

You have a Microsoft 365 E5 tenant.

You need to implement compliance solutions that meet the following requirements:

- Use a file plan to manage retention labels.
- Identify, monitor, and automatically protect sensitive information.
- Capture employee communications for examination by designated reviewers.

Which solution should you use for each requirement? To answer, drag the appropriate solutions to the correct requirements. Each solution may be used once, more than once, or not at all. You may need to drag the split bar between panes or scroll to view content.

NOTE: Each correct selection is worth one point.

| Solutions | Answer Area |
|-------------------------|--|
| Data loss prevention | Identify, monitor, and automatically protect sensitive information: |
| Information governance | Capture employee communications for examination by designated reviewers: |
| Insider risk management | Use a file plan to manage retention labels: |
| Records management | |

- A. Mastered
- B. Not Mastered

Answer: A

Explanation:

Graphical user interface, text, application Description automatically generated

NEW QUESTION 82

- (Exam Topic 4)

You have a Microsoft 365 E5 tenant.

You need to ensure that administrators are notified when a user receives an email message that contains malware. The solution must use the principle of least privilege.

Which type of policy should you create and which Microsoft 365 compliance center role is required to create the policy? To answer, select the appropriate options in the answer area.

NOTE: Each correct selection is worth one point.

Answer Area



Policy type: Alert
Threat
Compliance

Role: Quarantine
Security Administrator
Organization Configuration
Communication Compliance Admin

- A. Mastered
- B. Not Mastered

Answer: A

Explanation:

Answer Area



Policy type: Alert
Threat
Compliance

Role: Quarantine
Security Administrator
Organization Configuration
Communication Compliance Admin

NEW QUESTION 83

- (Exam Topic 4)

You have computers that run Windows 10 Enterprise and are joined to the domain.

You plan to delay the installation of new Windows builds so that the IT department can test application compatibility.

You need to prevent Windows from being updated for the next 30 days.

Which two Group Policy settings should you configure? Each correct answer presents part of the solution.

NOTE: Each correct selection is worth one point.

- A. Select when Quality Updates are received
- B. Select when Preview Builds and Feature Updates are received
- C. Turn off auto-restart for updates during active hours
- D. Manage preview builds
- E. Automatic updates detection frequency

Answer: AB

NEW QUESTION 84

- (Exam Topic 4)

You are testing a data loss prevention (DLP) policy to protect the sharing of credit card information with external users.

During testing, you discover that a user can share credit card information with external users by using email. However, the user is prevented from sharing files that contain credit card information by using Microsoft SharePoint Online.

You need to prevent the user from sharing the credit card information by using email and SharePoint. What should you configure?

- A. the locations of the DLP policy
- B. the user overrides of the DLP policy rule
- C. the status of the DLP policy
- D. the conditions of the DLP policy rule

Answer: A

Explanation:

References:

<https://docs.microsoft.com/en-us/office365/securitycompliance/data-loss-prevention-policies>

NEW QUESTION 89

- (Exam Topic 4)

You have a Microsoft 365 E5 subscription that includes the following active eDiscovery case:

- > Name: Case1
 - > Included content: Group1, User1, Site1
 - > Hold location: Exchange mailboxes, SharePoint sites, Exchange public folders
- The investigation for Case1 completes, and you close the case.

What occurs after you close Case1? To answer, select the appropriate options in the answer area.
NOTE: Each correct selection is worth one point.

Holds are turned off for:

User1 only

All locations

Site1 and Group1 only

Holds are placed on a delay hold for:

30 days

90 days

120 days

- A. Mastered
B. Not Mastered

Answer: A

Explanation:

Graphical user interface, text, application Description automatically generated

Reference:

<https://docs.microsoft.com/en-us/microsoft-365/compliance/close-or-delete-case?view=o365-worldwide>

NEW QUESTION 91

- (Exam Topic 4)

Note: This question is part of a series of questions that present the same scenario. Each question in the series contains a unique solution that might meet the stated goals- Some question sets might have more than one correct solution, while others might not have a correct solution.

After you answer a question in this section, you will NOT be able to return to it. As a result, these questions will not appear in the review screen.

You have a Microsoft 365 subscription.

You discover that some external users accessed content on a Microsoft SharePoint site. You modify the SharePoint sharing policy to prevent sharing outside your organization.

You need to be notified if the SharePoint sharing policy is modified in the future. Solution: From the SharePoint admin center, you modify the sharing settings.

Does this meet the goal?

- A. Yes
B. No

Answer: B

NEW QUESTION 95

- (Exam Topic 4)

Note: This question is part of a series of questions that present the same scenario. Each question in the series contains a unique solution that might meet the stated goals. Some question sets might have more than one correct solution, while others might not have a correct solution.

After you answer a question in this section, you will NOT be able to return to it. As a result, these questions will not appear in the review screen.

You have a Microsoft Azure Active Directory (Azure AD) tenant named contoso.com. You create an Azure Advanced Threat Protection (ATP) workspace named Workspace1.

The tenant contains the users shown in the following table.

| Name | Member of group | Azure AD role |
|-------|-------------------------------------|------------------------|
| User1 | Azure ATP Workspace1 Administrators | None |
| User2 | Azure ATP Workspace1 Users | None |
| User3 | None | Security administrator |
| User4 | Azure ATP Workspace1 Users | Global administrator |

You need to modify the configuration of the Azure ATP sensors.

Solution: You instruct User4 to modify the Azure ATP sensor configuration. Does this meet the goal?

- A. Yes
B. No

Answer: A

Explanation:

Only Azure ATP administrators can modify the sensors.

Any global administrator or security administrator on the tenant's Azure Active Directory is automatically an Azure ATP administrator.

References:

<https://docs.microsoft.com/en-us/azure-advanced-threat-protection/atp-role-groups>

NEW QUESTION 96

- (Exam Topic 4)

HOTSPOT

Your company has a Microsoft 365 subscription.

You need to configure Microsoft 365 to meet the following requirements:

- Malware found in email attachments must be quarantined for 20 days.
- The email address of senders to your company must be verified.

Which two options should you configure in the Security & Compliance admin center? To answer, select the appropriate options in the answer area.

NOTE: Each correct selection is worth one point.

| | | |
|---|--|--|
| ATP anti-phishing  Protect users from phishing attacks (like impersonation and spoofing), and use safety tips to warn users about potentially harmful messages. | ATP safe attachments  Protect your organization from malicious content in email attachments and files in SharePoint, OneDrive, and Teams. | ATP Safe Links  Protect your users from opening and sharing malicious links in email messages and Office 2016 desktop apps. |
| Anti-spam  Protect your organization's email from spam, including what actions to take if spam is detected. | DKIM  Add DKIM (DomainKeys Identified Mail) signatures to your domains so recipients know that email messages actually came from your users. | Anti-malware  Protect your organization's email from malware, including what actions to take and who to notify if malware is detected. |

A. Mastered

B. Not Mastered

Answer: A

Explanation:

| | | |
|---|--|--|
| ATP anti-phishing  Protect users from phishing attacks (like impersonation and spoofing), and use safety tips to warn users about potentially harmful messages. | ATP safe attachments  Protect your organization from malicious content in email attachments and files in SharePoint, OneDrive, and Teams. | ATP Safe Links  Protect your users from opening and sharing malicious links in email messages and Office 2016 desktop apps. |
| Anti-spam  Protect your organization's email from spam, including what actions to take if spam is detected. | DKIM  Add DKIM (DomainKeys Identified Mail) signatures to your domains so recipients know that email messages actually came from your users. | Anti-malware  Protect your organization's email from malware, including what actions to take and who to notify if malware is detected. |

NEW QUESTION 99

- (Exam Topic 4)

You have a Microsoft 365 E5 tenant that contains a user named User1. You plan to implement insider risk management.

You need to ensure that User1 can perform the following tasks:

- Review alerts.
- Manage cases.
- Create notice templates.
- Review user emails by using Content explorer. The solution must use the principle of least privilege. To which role group should you add User1?

A. Insider Risk Management

B. Insider Risk Management Analysts

C. Insider Risk Management Investigators

D. Insider Risk Management Admin

Answer: C

Explanation:

Reference:

<https://docs.microsoft.com/en-us/microsoft-365/compliance/insider-risk-management-configure?view=o365-wo>

NEW QUESTION 101

- (Exam Topic 4)

You have a Microsoft 365 E5 tenant.

You need to create a policy that will trigger an alert when unusual Microsoft Office 365 usage patterns are detected.

What should you use to create the policy?

- A. the Microsoft 365 admin center
- B. the Microsoft Purview compliance portal
- C. the Microsoft Defender for Cloud Apps portal
- D. the Microsoft Apps admin center

Answer: B

NEW QUESTION 102

- (Exam Topic 4)

You have a Microsoft 365 subscription.

You need to be notified if users receive email containing a file that has a virus. What should you do?

- A. From the Exchange admin center, create a spam filter policy.
- B. From the Security & Compliance admin center, create a data governance event.
- C. From the Security & Compliance admin center, create an alert policy.
- D. From the Exchange admin center, create a mail-flow rule.

Answer: D

Explanation:

You can inspect email attachments in your Exchange Online organization by setting up mail flow rules. Exchange Online offers mail flow rules that provide the ability to examine email attachments as a part of your messaging security and compliance needs. When you inspect attachments, you can then take action on the messages that were inspected based on the content or characteristics of those attachments.

NEW QUESTION 103

- (Exam Topic 4)

You have a Microsoft 365 subscription that uses Microsoft Defender for Office 365. A Built-in protection preset security policy is applied to the subscription.

Which two policy types will be applied by the Built-in protection policy? Each correct answer presents a complete solution.

NOTE: Each correct selection is worth one point.

- A. Anti-malware
- B. Anti-phishing
- C. Safe Attachments
- D. Anti-spam
- E. Safe Links

Answer: CE

NEW QUESTION 105

- (Exam Topic 4)

You have a Microsoft 365 tenant that contains 1,000 Windows 10 devices. The devices are enrolled in Microsoft Intune.

Company policy requires that the devices have the following configurations:

- > Require complex passwords.
- > Require the encryption of removable data storage devices.
- > Have Microsoft Defender Antivirus real-time protection enabled. You need to configure the devices to meet the requirements.

What should you use?

- A. an app configuration policy
- B. a compliance policy
- C. a security baseline profile
- D. a conditional access policy

Answer: B

Explanation:

Reference:

<https://docs.microsoft.com/en-us/mem/intune/protect/device-compliance-get-started>

NEW QUESTION 108

- (Exam Topic 4)

You have the Microsoft Azure Active Director (Azure AD) users shown in the following table.

| Name | Member of |
|-------|-----------|
| User1 | Group1 |
| User2 | Group2 |

Your company uses Microsoft Intune.

Several devices are enrolled in Intune as shown in the following table.

| Name | Platform | BitLocker Drive Encryption (BitLocker) | Member of |
|---------|------------|--|-----------|
| Device1 | Windows 10 | Disabled | Group3 |
| Device2 | Windows 10 | Disabled | Group4 |

The device compliance policies in Intune are configured as shown in the following table.

| Name | Require BitLocker | Assigned to |
|---------|-------------------|-------------|
| Policy1 | Not configured | Group3 |
| Policy2 | Require | Group4 |

You create a conditional access policy that has the following settings:

- The Assignments settings are configured as follows:
- Users and groups: Group1
- Cloud apps: Microsoft Office 365 Exchange Online
- Conditions: Include All device state, exclude Device marked as compliant
- Access controls is set to Block access.

For each of the following statements, select Yes if the statement is true. Otherwise, select No. NOTE: Each correct selection is worth one point.

Answer Area

| Statements | Yes | No |
|--|-----------------------|----------------------------------|
| User1 can access Microsoft Exchange Online from Device1. | <input type="radio"/> | <input type="radio"/> |
| User1 can access Microsoft Exchange Online from Device2. | <input type="radio"/> | <input checked="" type="radio"/> |
| User2 can access Microsoft Exchange Online from Device2. | <input type="radio"/> | <input type="radio"/> |

- A. Mastered
- B. Not Mastered

Answer: A

Explanation:

Answer Area

| Statements | Yes | No |
|--|----------------------------------|----------------------------------|
| User1 can access Microsoft Exchange Online from Device1. | <input checked="" type="radio"/> | <input type="radio"/> |
| User1 can access Microsoft Exchange Online from Device2. | <input type="radio"/> | <input checked="" type="radio"/> |
| User2 can access Microsoft Exchange Online from Device2. | <input checked="" type="radio"/> | <input type="radio"/> |

NEW QUESTION 112

- (Exam Topic 4)

You have a Microsoft 365 E5 tenant.

You plan to deploy 1.000 new iOS devices to users. The devices will be shipped directly from the supplier to the users.

You need to recommend a Microsoft Intune enrollment option that meets the following requirements:

- Minimizes user interaction
- Minimizes administrative effort
- Automatically installs corporate apps

What should you recommend?

- A. Automated Device Enrollment (ADE)
- B. bring your own device (BYOD) user and device enrollment
- C. Apple Configurator enrollment

Answer: A

Explanation:

Reference:

<https://docs.microsoft.com/en-us/mem/intune/enrollment/ios-enroll>

NEW QUESTION 117

- (Exam Topic 4)

You have a Microsoft 365 E5 subscription that uses an Azure Active Directory (Azure AD) tenant named contoso.com.

You need to ensure that users can enroll devices in Microsoft Endpoint Manager without manually entering the address of Microsoft Endpoint Manager.

Which two DNS records should you create? Each correct answer presents part of the solution.
NOTE: Each correct selection is worth one point.

- A. a CNAME record for AutoDiscover.contoso.com
- B. a CNAME record for EnterpriseEnrollment.contoso.com
- C. a TXT record for EnterpriseRegistration.contoso.com
- D. an SRV record for _SIP._TLS.contoso.com
- E. an SRV record for _SIPfederationTLS.contoso.com
- F. a CNAME record for EnterpriseRegistration.contoso.com
- G. a TXT record for EnterpriseEnrollment.contoso.com

Answer: BF

NEW QUESTION 119

- (Exam Topic 4)
You have a Microsoft 365 subscription.
You have the devices shown in the following table.

| Operating system | Quantity |
|---------------------|----------|
| Windows 8.1 | 5 |
| Windows 10 | 5 |
| Windows Server 2016 | 5 |

You need to onboard the devices to Windows Defender Advanced Threat Protection (ATP). The solution must avoid installing software on the devices whenever possible.

Which onboarding method should you use for each operating system? To answer, drag the appropriate methods to the correct operating systems. Each method may be used once, more than once, or not at all. You may need to drag the split bar between panes or scroll to view content.

NOTE: Each correct selection is worth one point.

| Methods | Answer Area |
|------------------------------|----------------------------------|
| A Microsoft Azure ATP sensor | Windows 8.1: <div></div> |
| A local script | Windows 10: <div></div> |
| Microsoft Monitoring Agent | Windows Server 2016: <div></div> |

- A. Mastered
- B. Not Mastered

Answer: A

Explanation:

References:
<https://docs.microsoft.com/en-us/windows/security/threat-protection/windows-defender-atp/onboard-downlevel>- <https://docs.microsoft.com/en-us/windows/security/threat-protection/windows-defender-atp/configure-endpoints> <https://docs.microsoft.com/en-us/windows/security/threat-protection/windows-defender-atp/configure-server-en>

NEW QUESTION 121

- (Exam Topic 4)
You have the sensitivity labels shown in the following exhibit.

[Home](#) > sensitivity

Labels

Label policies

Auto-labeling(preview)

Sensitivity labels are used to classify email messages, documents, sites, and more. When a label is applied (automatically or by the user), the content or site is protected based on the settings you choose. For example, you can create labels that encrypt files, add content marking, and control user access to specific sites. [Learn more about sensitivity labels](#)

+ Create a label Publish labels Refresh

| Name ↑ | | Order | Created by | Last modified |
|----------|-----|-----------|------------|---------------|
| Label1 | ... | 0-highest | Prvi | 04/24/2020 |
| – Label2 | ... | 1 | Prvi | 04/24/2020 |
| Label3 | ... | 0-highest | Prvi | 04/24/2020 |
| Label4 | ... | 0-highest | Prvi | 04/24/2020 |
| – Label5 | ... | 5 | Prvi | 04/24/2020 |
| Label6 | | 0-highest | Prvi | 04/24/2020 |

Which labels can users apply to content?

- A. Label3, Label4, and Label6 only
- B. Label1, Label2, Label3, Label4, Label5, and Label6
- C. Label1, Label2, and Label5 only
- D. Label1, Label3, Label4, and Label6 only

Answer: D

Explanation:

Reference:

<https://docs.microsoft.com/en-us/microsoft-365/compliance/sensitivity-labels?view=o365-worldwide>

NEW QUESTION 124

- (Exam Topic 4)

Your company has a Microsoft 365 E5 subscription.

Users in the research department work with sensitive data.

You need to prevent the research department users from accessing potentially unsafe websites by using hyperlinks embedded in email messages and documents.

Users in other departments must not be restricted.

What should you do from the Security & Compliance admin center?

- A. Create a data loss prevention (DLP) policy that has a Content is shared condition.
- B. Modify the default safe links policy.
- C. Create a data loss prevention (DLP) policy that has a Content contains condition.
- D. Create a new safe links policy.

Answer: D

Explanation:

References:

<https://docs.microsoft.com/en-us/office365/securitycompliance/set-up-atp-safe-links-policies#policies-that-apply>

NEW QUESTION 127

- (Exam Topic 4)

You have a Microsoft 365 E5 tenant.

You plan to deploy a monitoring solution that meets the following requirements:

- Captures Microsoft Teams channel messages that contain threatening or violent language.
- Alerts a reviewer when a threatening or violent message is identified.

What should you include in the solution?

- A. Data Subject Requests (DSRs)
- B. Insider risk management policies
- C. Communication compliance policies
- D. Audit log retention policies

Answer: C

NEW QUESTION 131

- (Exam Topic 4)

You have a Microsoft 365 E5 tenant.

You have a sensitivity label configured as shown in the Sensitivity label exhibit. (Click the Sensitivity label tab.)

Review your settings and finish

Name
Sensitivity1

Display name
Sensitivity1

Description for users
Sensitivity1

Scope
File.Email

Encryption

Content marking
Watermark: Watermark
Header: Header

Auto-labeling

Group settings

Site settings

Auto-labeling for database columns
None

You have an auto-labeling policy as shown in the Auto-labeling policy exhibit. (Click the Auto-labeling policy tab.)

Auto-labeling policy

Edit Policy

Delete Policy

Policy name
Auto-labeling policy

Description

Label in simulation
Sensitivity1

Info to label
IP Address

Apply to content in these locations
Exchange email All

Rules for auto-applying this label
Exchange email 1 rule

Mode
On

Comment

A user sends an email that contains the components shown in the following table.

| Type | File | Includes IP address |
|------------|----------------|---------------------|
| Mail body | Not applicable | No |
| Attachment | File1.docx | Yes |
| Attachment | File2.xml | Yes |

For each of the following statements, select Yes if the statement is true. Otherwise, select No.
NOTE: Each correct selection is worth one point.

| Statements | Yes | No |
|---------------------------------------|-----------------------|-----------------------|
| Sensitivity1 is applied to the email. | <input type="radio"/> | <input type="radio"/> |
| A watermark is added to File1.docx. | <input type="radio"/> | <input type="radio"/> |
| A header is added to File2.xml. | <input type="radio"/> | <input type="radio"/> |

- A. Mastered
B. Not Mastered

Answer: A

Explanation:

Graphical user interface, text, application Description automatically generated

Reference:

<https://docs.microsoft.com/en-us/microsoft-365/compliance/apply-sensitivity-label-automatically?view=o365-w>

NEW QUESTION 134

- (Exam Topic 4)

Note: This question is part of a series of questions that present the same scenario. Each question in the series contains a unique solution that might meet the stated goals. Some question sets might have more than one correct solution, while others might not have a correct solution.

After you answer a question in this section, you will NOT be able to return to it. As a result, these questions will not appear in the review screen.

You have an Azure Active Directory (Azure AD) tenant that contains a user named User1. Your company purchases a Microsoft 365 subscription.

You need to ensure that User1 is assigned the required role to create file policies and manage alerts in the Cloud App Security admin center.

Solution: From the Security & Compliance admin center, you assign the Security Administrator role to User1. Does this meet the goal?

- A. Yes
B. No

Answer: B

Explanation:

References:

<https://docs.microsoft.com/en-us/cloud-app-security/manage-admins>

NEW QUESTION 137

- (Exam Topic 4)

You have a Microsoft 365 E5 tenant that contains the devices shown in the following table.

| Name | Windows 10 edition | Azure Active Directory (Azure AD) | Mobile device management (MDM) enrollment |
|---------|-----------------------|-----------------------------------|---|
| Device1 | Windows 10 Pro | Registered | Microsoft Intune |
| Device2 | Windows 10 Enterprise | Joined | Microsoft Intune |
| Device3 | Windows 10 Pro | Joined | Not enrolled |
| Device4 | Windows 10 Enterprise | Registered | Microsoft Intune |
| Device5 | Windows 10 Enterprise | Joined | Not enrolled |

You add custom apps to the private store in Microsoft Store Business.

You plan to create a policy to show only the private store in Microsoft Store for Business. To which devices can the policy be applied?

- A. Device2 only
B. Device1 and Device3 only
C. Device2 and Device4 only
D. Device2, Device3, and Device5 only
E. Device1, Device2, Device3, Device4, and Device5

Answer: C

NEW QUESTION 142

- (Exam Topic 4)

You have a Microsoft 365 E5 subscription that uses Microsoft Defender Advanced Threat Protection (Microsoft Defender ATP).

When users attempt to access the portal of a partner company, they receive the message shown in the following exhibit.



You need to enable user access to the partner company's portal. Which Microsoft Defender ATP setting should you modify?

- A. Custom detections
- B. Advanced hunting
- C. Alert notifications
- D. Indicators
- E. Alert suppression

Answer: D

Explanation:

Reference:

<https://docs.microsoft.com/en-us/windows/security/threat-protection/microsoft-defender-atp/manage-indicators>

NEW QUESTION 143

- (Exam Topic 4)

Your company has a Microsoft 365 tenant.

The company sells products online and processes credit card information.

You need to be notified if a file stored in Microsoft SharePoint Online contains credit card information. The file must be removed automatically from its current location until an administrator can review its contents.

What should you use?

- A. a Security & Compliance data loss prevention (DLP) policy
- B. a Microsoft Cloud App Security access policy
- C. a Security & Compliance retention policy
- D. a Microsoft Cloud App Security file policy

Answer: D

NEW QUESTION 144

- (Exam Topic 4)

Note: This question is part of a series of questions that present the same scenario. Each question in the series contains a unique solution that might meet the stated goals. Some question sets might have more than one correct solution, while others might not have a correct solution.

After you answer a question in this section, you will NOT be able to return to it. As a result, these questions will not appear in the review screen.

You are deploying Microsoft Intune.

You successfully enroll Windows 10 devices in Intune.

When you try to enroll an iOS device in Intune, you get an error. You need to ensure that you can enroll the iOS device in Intune. Solution: You configure the Apple MDM Push certificate.

Does this meet the goal?

- A. Yes
- B. No

Answer: A

Explanation:

References:

<https://docs.microsoft.com/en-us/intune/apple-mdm-push-certificate-get>

NEW QUESTION 147

- (Exam Topic 4)

HOTSPOT

You have a Microsoft 365 E5 tenant that contains the users shown in the following table.

| Name | Microsoft 365 role |
|-------|---------------------------------|
| User1 | Cloud application administrator |
| User2 | Application administrator |
| User3 | Application developer |
| User4 | None |

Users are assigned Microsoft Store for Business roles as shown in the following table.

| User | Role |
|-------|---------------------|
| User1 | None |
| User2 | Basic Purchaser |
| User3 | Purchaser |
| User4 | Device Guard signer |

Which users can add apps to the private store in Microsoft Store for Business, and which users can install apps from the private store? To answer, select the appropriate options in the answer area.

NOTE: Each correct selection is worth one point.

Add apps to the private store:

User3 only
User2 and User3 only
User1 and User3 only
User1, User2 and User3 only
User1, User2, User3, and User4

Install apps from the private store:

User3 only
User2 and User3 only
User1 and User3 only
User2, User3 and User4 only
User1, User2, User3, and User4

- A. Mastered
B. Not Mastered

Answer: A

Explanation:

Graphical user interface, text Description automatically generated

Reference:

<https://docs.microsoft.com/en-us/microsoft-store/acquire-apps-microsoft-store-for-business> <https://docs.microsoft.com/en-us/microsoft-store/distribute-apps-from-your-private-store>

NEW QUESTION 151

- (Exam Topic 4)

You have a Microsoft 365 subscription that uses Microsoft Defender Advanced Threat Protection (Microsoft Defender ATP).

All the devices in your organization are onboarded to Microsoft Defender ATP.

You need to ensure that an alert is generated if malicious activity was detected on a device during the last 24 hours.

What should you do?

- A. From Alerts queue, create a suppression rule and assign an alert
B. From the Security & Compliance admin center, create an audit log search
C. From Advanced hunting, create a query and a detection rule
D. From the Security & Compliance admin center, create a data loss prevention (DLP) policy

Answer: C

Explanation:

Reference:

<https://docs.microsoft.com/en-us/windows/security/threat-protection/microsoft-defender-atp/custom-detectionru>

NEW QUESTION 155

- (Exam Topic 4)

Note: This question is part of a series of questions that present the same scenario. Each question in the series contains a unique solution that might meet the stated goals. Some question sets might have more than one correct solution, while others might not have a correct solution.

After you answer a question in this section, you will NOT be able to return to it. As a result, these questions will not appear in the review screen.

You have a computer that runs Windows 10.

You need to verify which version of Windows 10 is installed.

Solution: From the Settings app, you select System, and then you select About to view information about the system.

Does this meet the goal?

- A. Yes
B. No

Answer: A

Explanation:

Reference:

<https://support.microsoft.com/en-us/windows/which-version-of-windows-operating-system-am-i-running-628be>

NEW QUESTION 158

- (Exam Topic 4)

You have a Microsoft 365 E5 subscription.

You plan to implement Microsoft 365 compliance policies to meet the following requirements:

- Identify documents that are stored in Microsoft Teams and SharePoint Online that contain Personally Identifiable Information (PII).
- Report on shared documents that contain PII. What should you create?

- A. an alert policy
- B. a data loss prevention (DLP) policy
- C. a retention policy
- D. a Microsoft Cloud App Security policy

Answer: B

Explanation:

Reference:

<https://docs.microsoft.com/en-us/microsoft-365/compliance/dlp-learn-about-dlp?view=o365-worldwide>

NEW QUESTION 160

- (Exam Topic 4)

You have a Microsoft Azure Activity Directory (Azure AD) tenant contains the users shown in the following table.

| Name | Member of |
|-------|-----------|
| User1 | Group1 |
| User2 | Group2 |
| User3 | Group3 |

Group3 is a member of Group1.

Your company uses Windows Defender Advanced Threat Protection (ATP). Windows Defender ATP contains the roles shown in the following table.

| Name | Permission | Assigned user group |
|--|---|---------------------|
| Windows Defender ATP administrator (default) | View data, Alerts investigation, Active remediation actions, Manage security settings | None |
| Role1 | View data, Alerts investigation | Group1 |
| Role2 | View data | Group2 |

Windows Defender ATP contains the device groups shown in the following table.

| Rank | Machine group | Machine | User access |
|------|------------------------------|---------|-------------|
| 1 | ATP1 | Device1 | Group1 |
| Last | Ungrouped machines (default) | Device2 | None |

For each of the following statements, select Yes if the statement is true. Otherwise, select No. NOTE: Each correct selection is worth one point.

| Statements | Yes | No |
|---|-----------------------|-----------------------|
| User1 can view Device1 in Windows Defender Security Center. | <input type="radio"/> | <input type="radio"/> |
| User2 can sign in to Windows Defender Security Center. | <input type="radio"/> | <input type="radio"/> |
| User3 can view Device1 in Windows Defender Security Center. | <input type="radio"/> | <input type="radio"/> |

- A. Mastered
- B. Not Mastered

Answer: A

Explanation:

| Statements | Yes | No |
|---|----------------------------------|----------------------------------|
| User1 can view Device1 in Windows Defender Security Center. | <input checked="" type="radio"/> | <input type="radio"/> |
| User2 can sign in to Windows Defender Security Center. | <input type="radio"/> | <input checked="" type="radio"/> |
| User3 can view Device1 in Windows Defender Security Center. | <input checked="" type="radio"/> | <input type="radio"/> |

NEW QUESTION 165

- (Exam Topic 4)

You have three devices enrolled in Microsoft Intune as shown in the following table.

| Name | Platform | Member of |
|---------|------------|----------------|
| Device1 | Windows 10 | Group1 |
| Device2 | Android | Group2, Group3 |
| Device3 | Windows 10 | Group2, Group3 |

The device compliance policies in Intune are configured as shown in the following table.

| Name | Platform | Assigned |
|---------|----------------------|----------|
| Policy1 | Windows 10 and later | Yes |
| Policy2 | Android | No |
| Policy3 | Windows 10 and later | Yes |

The device compliance policies have the assignments shown in the following table.

| Name | Include | Exclude |
|---------|---------|---------|
| Policy1 | Group3 | None |
| Policy2 | Group2 | Group3 |

For each of the following statements, select Yes if the statement is true. Otherwise, select No. NOTE: Each correct selection is worth one point.

| Statements | Yes | No |
|-----------------------------|-----------------------|-----------------------|
| Policy1 applies to Device3. | <input type="radio"/> | <input type="radio"/> |
| Policy2 applies to Device2. | <input type="radio"/> | <input type="radio"/> |

- A. Mastered
- B. Not Mastered

Answer: A

Explanation:

| Statements | Yes | No |
|-----------------------------|----------------------------------|-----------------------|
| Policy1 applies to Device3. | <input checked="" type="radio"/> | <input type="radio"/> |
| Policy2 applies to Device2. | <input checked="" type="radio"/> | <input type="radio"/> |

NEW QUESTION 166

- (Exam Topic 4)





You have a Microsoft 365 subscription that contains all the user data.

You plan to create the retention policy shown in the Locations exhibit. (Click the Locations tab.)

Choose locations

The policy will apply to content that's stored in the locations you choose.

- ☐ Apply policy only to content in Exchange email, public folders, Office 365 groups, OneDrive and SharePoint documents.
- ☒ Let me choose specific locations. 

| Status | Location | Include | Exclude |
|-------------------------------------|---|--|---|
| <input checked="" type="checkbox"/> |  Exchange email | 1 recipient Choose recipients | - Exclude recipients |
| <input type="checkbox"/> |  SharePoint sites | | |
| <input type="checkbox"/> |  OneDrive accounts | | |
| <input checked="" type="checkbox"/> |  Office 365 groups | 1 group Choose groups | - Exclude groups |

You configure the Advanced retention settings as shown in the Retention exhibit. (Click the Retention tab.)

Advanced retention

Keyword query editor

merger

acquisition

takeover

^ Actions

When content matches the conditions, perform the following actions.

Retention actions

☒ Retain the content 

For this long...

5

years

Do you want us to delete it after this time?

☒ Yes

☐ No

☐ Don't retain the content. Just delete it if it's older than 

1

years

Retain or delete the content based on

when it was created 

The locations specified in the policy include the groups shown in the following table.

| Location | Include |
|-------------------|--------------------------------------|
| Exchange email | A distribution group named LegalTeam |
| Office 365 groups | A security group named Legal365 |

For each of the following statements, select Yes if the statement is true. Otherwise, select No.
NOTE: Each correct selection is worth one point.

| Statements | Yes | No |
|---|-----------------------|-----------------------|
| Any file stored in Microsoft SharePoint group library by a user in the Legal365 group will be stored for five years, and then deleted. | <input type="radio"/> | <input type="radio"/> |
| An email message that contains the word takeover and is sent by a user in the LegalTeam group will be deleted automatically after five years. | <input type="radio"/> | <input type="radio"/> |
| If a new user is added to the LegalTeam group next week, and the user sends an email message that contains the word takeover, the message will be deleted automatically after five years. | <input type="radio"/> | <input type="radio"/> |

- A. Mastered
 B. Not Mastered

Answer: A

Explanation:

No, Yes, No References:

<https://community.spiceworks.com/topic/2150016-can-you-apply-a-retention-policy-to-users-within-a-group-on>

Distribution lists and mail-enabled security groups will be expanded so the policy will apply to all the mailboxes in the group. Only the mailboxes that are currently members of these groups will be covered by the policy. Mailboxes added to these groups later won't be covered, but ones that are removed later will still be covered.

NEW QUESTION 170

- (Exam Topic 4)

You have a Microsoft 365 E5 subscription that uses Microsoft Defender for Office 365. You have the policies shown in the following table.

| Name | Type |
|---------|------------------|
| Policy1 | Anti-phishing |
| Policy2 | Anti-spam |
| Policy3 | Anti-malware |
| Policy4 | Safe Attachments |

All the policies are configured to send malicious email messages to quarantine. Which policies support a customized quarantine retention period?

- A. Policy1 and Policy2 only
 B. Policy2 and Policy4 only
 C. Policy3 and Policy4 only
 D. Policy1 and Policy3only

Answer: A

NEW QUESTION 175

- (Exam Topic 4)

Note: This question is part of a series of questions that present the same scenario. Each question in the series contains a unique solution that might meet the stated goals. Some question sets might have more than one correct solution, while others might not have a correct solution.

After you answer a question in this section, you will NOT be able to return to it. As a result, these questions will not appear in the review screen.

You have a Microsoft 365 subscription.

From the Security & Compliance admin center, you create a role group named US eDiscovery Managers by copying the eDiscovery Manager role group.

You need to ensure that the users in the new role group can only perform content searches of mailbox content for users in the United States.

Solution: From Windows PowerShell, you run the New-ComplianceSecurityFilter cmdlet with the appropriate parameters.

Does this meet the goal?

- A. Yes
 B. No

Answer: A

Explanation:

References:

<https://docs.microsoft.com/en-us/office365/securitycompliance/permissions-filtering-for-content-search> <https://docs.microsoft.com/en-us/powershell/module/exchange/policy-and-compliance-content-search/newcomp>

NEW QUESTION 178

- (Exam Topic 4)

You purchase a new computer that has Windows 10, version 2004 preinstalled.

You need to ensure that the computer is up-to-date. The solution must minimize the number of updates installed.

What should you do on the computer?

- A. Install all the feature updates released since version 2004 and all the quality updates released since version 2004 only.
 B. install the West feature update and the latest quality update only.

- C. install all the feature updates released since version 2004 and the latest quality update only.
D. install the latest feature update and all the quality updates released since version 2004.

Answer: B

NEW QUESTION 180

- (Exam Topic 4)

You have a Microsoft 365 subscription.

You discover that some external users accessed center for a Microsoft SharePoint site. You modify the sharePoint sharing policy to prevent sharing, outside your organization. You need to be notified if the SharePoint sharing policy is modified in the future.

Solution: From the Security & Compliance admin center you create a threat management policy. Does this meet the goal?

- A. Yes
B. No

Answer: B

NEW QUESTION 183

- (Exam Topic 4)

Your company uses Windows Defender Advanced Threat Protection (ATP). Windows Defender ATP includes the machine groups shown in the following table.

| Rank | Machine group | Members |
|------|------------------------------|---|
| 1 | Group1 | Tag Equals demo And OS In Windows 10 |
| 2 | Group2 | Tag Equals demo |
| 3 | Group3 | Domain Equals adatum.com |
| 4 | Group4 | Domain Equals adatum.com And OS In Windows 10 |
| Last | Ungrouped machines (default) | <i>Not applicable</i> |

You onboard a computer named computer1 to Windows Defender ATP as shown in the following exhibit.

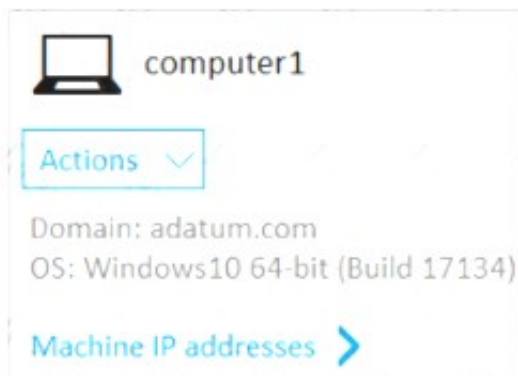

Use the drop-down menus to select the answer choice that completes each statement based on the information presented in the graphic.
NOTE: Each correct selection is worth one point.

Computer1 will be a member of [answer choice].

- Group3 only
- Group4 only
- Group3 and Group4 only
- Ungrouped machines

If you add the tag demo to Computer1, the computer will be a member of [answer choice].

- Group1 only
- Group1 and Group2 only
- Group1, Group2, Group3, and Group4
- Ungrouped machines

- A. Mastered
B. Not Mastered

Answer: A

Explanation:

Computer1 will be a member of [answer choice].

- Group3 only
- Group4 only
- Group3 and Group4 only
- Ungrouped machines

If you add the tag demo to Computer1, the computer will be a member of [answer choice].

- Group1 only
- Group1 and Group2 only
- Group1, Group2, Group3, and Group4
- Ungrouped machines

NEW QUESTION 185

- (Exam Topic 4)

You have a data loss prevention (DLP) policy.

You need to increase the likelihood that the DLP policy will apply to data that contains medical terms from the International Classification of Diseases (ICD-9-CM).

The solution must minimize the number of false positives.

Which two settings should you modify? To answer, select the appropriate settings in the answer area. NOTE: Each correct selection is worth one point.

Content contains

Any of these ▾

PII Identifiers

Sensitive info type

U.S. Social Security Number (SSN)

Instance count

min

1

max

any

Match accuracy

min

50

max

100

Add ▾

and ▾

Any of these ▾

Medical Terms

Sensitive info type

International Classification of Diseases (ICD-9-CM)

Instance count

min

1

max

any

Match accuracy

min

50

max

100

Add ▾

- A. Mastered
- B. Not Mastered

Answer: A

Explanation:

References:

<https://docs.microsoft.com/en-us/office365/securitycompliance/data-loss-prevention-policies> <https://docs.microsoft.com/en-us/office365/securitycompliance/what-the-sensitive-information-types-look-for#i>

NEW QUESTION 186

- (Exam Topic 4)

You have an Azure AD tenant.

You have 1,000 computers that run Windows 10 Pro and are joined to Azure AD. You purchase a Microsoft 365 E3 subscription.

You need to deploy Windows 10 Enterprise to the computers. The solution must minimize administrative effort.

What should you do?

- A. From the Microsoft Endpoint Manager admin center, create a Windows Autopilot deployment profile. Assign the profile to all the computer
- B. Instruct users to restart their computer and perform a network restart.
- C. Enroll the computers in Microsoft Intun
- D. Create a configuration profile by using the Edition upgrade and mode switch templat
- E. From the Microsoft Endpoint Manager admin center, assign the profile to all the computers and instruct users to restart their computer.
- F. From Windows Configuration Designer, create a provisioning package that has an EditionUpgrade configuration and upload the package to a Microsoft SharePoint Online sit
- G. Instruct users to run the provisioning package from SharePoint Online.
- H. From the Azure Active Directory admin center, create a security group that has dynamic device membershi
- I. Assign licenses to the group and instruct users to sign in to their computer.

Answer: A

NEW QUESTION 191

- (Exam Topic 4)

You create a new Microsoft 365 subscription and assign Microsoft 365 E3 licenses to 100 users. From the Security & Compliance admin center, you enable auditing.

You are planning the auditing strategy.

Which three activities will be audited by default? Each correct answer presents a complete solution.

NOTE: Each correct selection is worth one point.

- A. An administrator creates a new Microsoft SharePoint site collection.
- B. An administrator creates a new mail flow rule.
- C. A user shares a Microsoft SharePoint folder with an external user.
- D. A user delegates permissions to their mailbox.
- E. A user purges messages from their mailbox.

Answer: ABC

Explanation:

Your Partner of IT Exam

visit - <https://www.exambible.com>

References:

<https://docs.microsoft.com/en-us/office365/securitycompliance/search-the-audit-log-in-security-andcompliance?>

NEW QUESTION 194

- (Exam Topic 4)

You have a Microsoft 365 subscription.

Your company purchases a new financial application named App1.

From Cloud Discovery in Microsoft Cloud App Security, you view the Discovered apps page and discover that many applications have a low score because they are missing information about domain registration and consumer popularity.

You need to prevent the missing information from affecting the App1 score. What should you configure from the Cloud Discover settings?

- A. Organization details
- B. Default behavior
- C. Score metrics
- D. App tags

Answer: C

Explanation:

<https://docs.microsoft.com/en-us/cloud-app-security/discovered-app-queries>

NEW QUESTION 195

- (Exam Topic 4)

You have a Microsoft 365 E5 tenant that contains 500 Windows 10 devices. The devices are enrolled in Microsoft Intune.

You plan to use Endpoint analytics to identify hardware issues.

You need to enable Windows health monitoring on the devices to support Endpoint analytics. What should you do?

- A. Configure the Endpoint analytics baseline regression threshold.
- B. Create a configuration profile.
- C. Create a Windows 10 Security Baseline profile
- D. Create a compliance policy.

Answer: B

NEW QUESTION 198

- (Exam Topic 4)

You have a Microsoft 365 subscription that uses Microsoft Defender for Cloud Apps. You configure a session control policy to block downloads from SharePoint Online sites. Users report that they can still download files from SharePoint Online sites.

You need to ensure that file download is blocked while still allowing users to browse SharePoint Online sites. What should you configure?

- A. an access policy
- B. a data loss prevention (DLP) policy
- C. an activity policy
- D. a Conditional Access policy

Answer: A

NEW QUESTION 199

- (Exam Topic 4)

Your company has a Microsoft 365 E5 tenant.

Users at the company use the following versions of Microsoft Office:

- Microsoft 365 Apps for enterprise
- Office for the web
- Office 2016
- Office 2019

The company currently uses the following Office file types:

- .docx
- .xlsx
- .doc
- .xls

You plan to use sensitivity labels. You need to identify the following:

- Which versions of Office require an add-in to support the sensitivity labels.
- Which file types support the sensitivity labels.

What should you identify? To answer, select the appropriate options in the answer area, NOTE: Each correct selection is worth one point.

Answer Area

Office versions that require an add-in to support the sensitivity labels:

- Microsoft 365 Apps for enterprise and Office for the web only
- Office 2016 only
- Office 2019 only
- Office for the web only
- Office 2016 and Office 2019 only
- Microsoft 365 Apps for enterprise only
- Microsoft 365 Apps for enterprise and Office for the web only**

Office file types that support the sensitivity labels:

- .docx and .xlsx
- .doc only
- .docx only
- .xls only
- .xlsx only
- .doc and .xls
- .docx and .xlsx**

- A. Mastered
- B. Not Mastered

Answer: A

Explanation:

Answer Area

Office versions that require an add-in to support the sensitivity labels:

- Microsoft 365 Apps for enterprise and Office for the web only
- Office 2016 only
- Office 2019 only
- Office for the web only
- Office 2016 and Office 2019 only
- Microsoft 365 Apps for enterprise only
- Microsoft 365 Apps for enterprise and Office for the web only**

Office file types that support the sensitivity labels:

- .docx and .xlsx
- .doc only
- .docx only
- .xls only
- .xlsx only
- .doc and .xls
- .docx and .xlsx**

NEW QUESTION 200

- (Exam Topic 4)

You have a Microsoft 365 E5 tenant that contains 100 Windows 10 devices.

You plan to deploy a Windows 10 Security Baseline profile that will protect secrets stored in memory. What should you configure in the profile?

- A. Microsoft Defender Credential Guard
- B. BitLocker Drive Encryption (BitLocker)
- C. Microsoft Defender
- D. Microsoft Defender Exploit Guard

Answer: A

NEW QUESTION 205

- (Exam Topic 4)

You have a Microsoft Azure Active Directory (Azure AD) tenant named Contoso.com. You create a Microsoft Defender for identity instance Contoso.

The tenant contains the users shown in the following table.

| Name | Member of group | Azure AD role |
|-------|--|------------------------|
| User1 | Defender for Identity Contoso Administrators | None |
| User2 | Defender for Identity Contoso Users | None |
| User3 | None | Security administrator |
| User4 | Defender for Identity Contoso Users | Global administrator |

You need to modify the configuration of the Defender for identity sensors.

Solutions: You instruct User1 to modify the Defender for identity sensor configuration. Does this meet the goal?

- A. Yes
- B. No

Answer: A

NEW QUESTION 207

- (Exam Topic 4)

You use Windows Defender Advanced Threat Protection (Windows Defender ATP). You have the Windows Defender ATP machine groups shown in the following table.

| Name | Rank | Members |
|------------------------------|------|---|
| Group1 | 1 | Operating system in Windows 10 |
| Group2 | 2 | Name ends with London |
| Group3 | 3 | Operating system in Windows Server 2016 |
| Ungrouped machines (default) | Last | <i>Not applicable</i> |

You plan to onboard computers to Windows Defender ATP as shown in the following table.

| Name | Operating system |
|------------------|---------------------|
| Computer1-London | Windows 10 |
| Server1-London | Windows Server 2016 |

To which machine group will each computer be added? To answer, select the appropriate options in the answer are.

NOTE: Each correct selection is worth one point.

Computer1-London:

Server1-London:

- A. Mastered
- B. Not Mastered

Answer: A

Explanation:

Computer1-London:

Server1-London:

NEW QUESTION 211

- (Exam Topic 4)

You have a Microsoft 365 E5 tenant that contains four devices enrolled in Microsoft Intune as shown in the following table.

| Name | Platform |
|---------|------------|
| Device1 | Windows 10 |
| Device2 | Android |
| Device3 | macOS |
| Device4 | iOS |

You plan to deploy Microsoft 365 Apps for enterprise by using Microsoft Endpoint Manager. To which devices can you deploy Microsoft 365 Apps for enterprise?

- A. Device1 only
- B. Device1 and Device3 only
- C. Device2 and Device4 only
- D. Device1, Device2, and Device3 only
- E. Device1, Device2, Device3, and Device4

Answer: B

Explanation:

Reference:

<https://docs.microsoft.com/en-us/mem/intune/apps/apps-add>

NEW QUESTION 213

- (Exam Topic 4)

You create a Microsoft 365 subscription.

Your company's privacy policy states that user activities must NOT be audited. You need to disable audit logging in Microsoft 365.

How should you complete the command? To answer, select the appropriate options in the answer area.

NOTE: Each correct selection is worth one point.

Answer Area

| | | |
|-------------------------------|----------------------------------|---------|
| Set-AdminAuditLogConfig | -AdminAuditLogEnabled | \$false |
| Set-AuditConfig | -AdminAuditLogParameters | |
| Set-AuditConfigurationRule | -LogLevel | |
| Set-SupervisoryReviewPolicyV2 | -UnifiedAuditLogIngestionEnabled | |

A. Mastered

B. Not Mastered

Answer: A

Explanation:

References:

<https://docs.microsoft.com/en-us/office365/securitycompliance/turn-audit-log-search-on-or-off>

NEW QUESTION 214

- (Exam Topic 4)

You configure a conditional access policy. The locations settings are configured as shown in the Locations exhibit. (Click the Locations tab.)

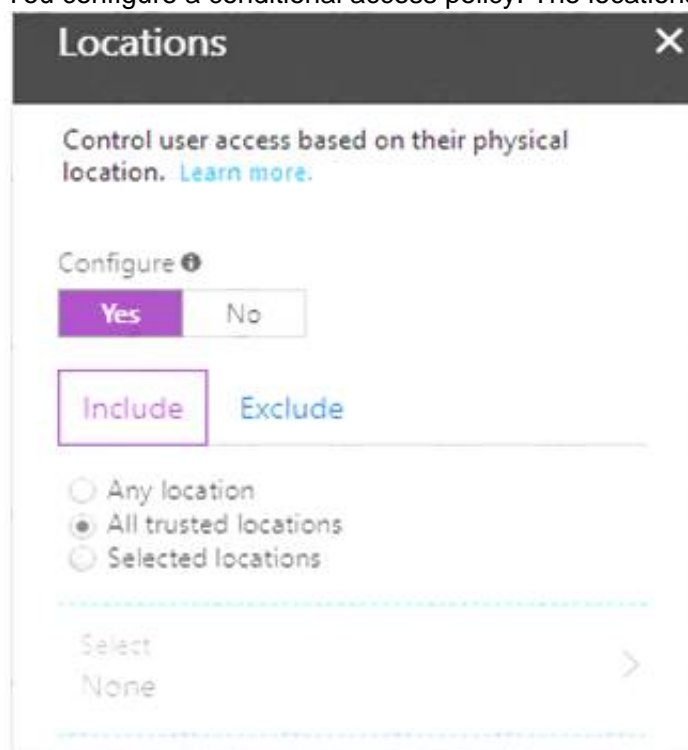

The users and groups settings are configured as shown in the Users and Groups exhibit. (Click Users and Groups tab.)

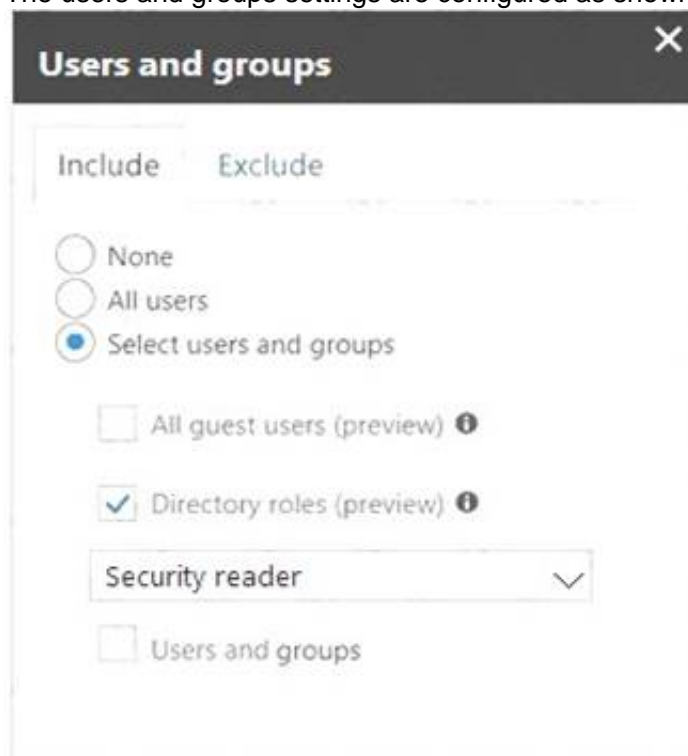

Members of the Security reader group report that they cannot sign in to Microsoft Active Directory (Azure AD) on their device while they are in the office.

You need to ensure that the members of the Security reader group can sign in to Azure AD on their device while they are in the office. The solution must use the principle of least privilege.

What should you do?

- A. From the conditional access policy, configure the device state.
- B. From the Azure Active Directory admin center, create a custom control.
- C. From the Intune admin center, create a device compliance policy.
- D. From the Azure Active Directory admin center, create a named location.

Answer: D

Explanation:

References:
<https://docs.microsoft.com/en-us/azure/active-directory/conditional-access/location-condition>

NEW QUESTION 218

- (Exam Topic 4)

Note: This question is part of a series of questions that present the same scenario. Each question in the series contains a unique solution that might meet the stated goals. Some question sets might have more than one correct solution, while others might not have a correct solution.

After you answer a question in this section, you will NOT be able to return to it. As a result, these questions will not appear in the review screen.

You have a new Microsoft 365 subscription.

You need to prevent users from sending email messages that contain Personally Identifiable Information (PII). Solution: From the Exchange admin center, you create a data loss prevention (DLP) policy.

Does this meet the goal?

- A. Yes
- B. No

Answer: A

NEW QUESTION 222

- (Exam Topic 4)

Note: This question is part of a series of questions that present the same scenario. Each question in the series contains a unique solution that might meet the stated goals- Some question sets might have more than one correct solution, while others might not have a correct solution.

After you answer a question in this section, you will NOT be able to return to it. As a result, these questions will not appear in the review screen.

You have a Microsoft 365 subscription.

You discover that some external users accessed content on a Microsoft SharePoint site. You modify the SharePoint shoring policy to prevent sharing outside your organization.

You need to be notified if the SharePoint sharing policy is modified m the future. Solution: From the SharePoint site, you create an alert.

Does this meet the goal?

- A. Yes
- B. No

Answer: B

NEW QUESTION 227

- (Exam Topic 4)

Note: This question is part of a series of questions that present the same scenario. Each question in the series contains a unique solution that might meet the stated goals. Some question sets might have more than one correct solution, while others might not have a correct solution.

After you answer a question in this section, you will NOT be able to return to it. As a result, these questions will not appear in the review screen.

Your network contains an on-premises Active Directory domain. The domain contains domain controllers that run Windows Server 2019. The functional level of the forest and the domain is Windows Server 2012 R2.

The domain contains 100 computers that run Windows 10 and a member server named Server1 that runs Windows Server 2012 R2.

You plan to use Server1 to manage the domain and to configure Windows 10 Group Policy settings. You install the Group Policy Management Console (GPMC) on Server1.

You need to configure the Windows Update for Business Group Policy settings on Server1.

Solution: You copy the Group Policy Administrative Templates from a Windows 10 computer to Server1. Does this meet the goal?

- A. yes
- B. No

Answer: A

NEW QUESTION 229

- (Exam Topic 4)

Note: This question is part of a series of questions that present the same scenario. Each question in the series contains a unique solution that might meet the stated goals. Some question sets might have more than one correct solution, while others might not have a correct solution.

After you answer a question in this section, you will NOT be able to return to it. As a result, these questions will not appear in the review screen.

You have a Microsoft 365 subscription.

From the Security & Compliance admin center, you create a role group named US eDiscovery Managers by copying the eDiscovery Manager role group.

You need to ensure that the users in the new role group can only perform content searches of mailbox content for users in the United States.

Solution: From the Security & Compliance admin center, you modify the roles of the US eDiscovery Managers role group.

Does this meet the goal?

- A. Yes
- B. No

Answer: B

NEW QUESTION 233

- (Exam Topic 4)

You have a Microsoft 365 E5 tenant that contains the devices shown in the following table.

| Name | Platform | Azure Active Directory (Azure AD) |
|---------|------------|-----------------------------------|
| Device1 | Windows 10 | Joined |
| Device2 | Windows 10 | Registered |
| Device3 | Windows 10 | Not joined or registered |
| Device4 | Android | Registered |

You plan to review device startup performance issues by using Endpoint analytics. Which devices can you monitor by using Endpoint analytics?

- A. Device1 only
- B. Device1 and Device2 only
- C. Device1, Device2, and Device3 only
- D. Device1, Device2, and Device4 only
- E. Device1, Device2, Device3, and Device4

Answer: A

Explanation:

Reference:

<https://docs.microsoft.com/en-us/mem/analytics/overview>

NEW QUESTION 235

- (Exam Topic 4)

You have a Microsoft 365 E5 subscription.

You plan to implement records management and enable users to designate documents as regulatory records. You need to ensure that the option to mark content as a regulatory record is visible when you create retention labels.

What should you do first?

- A. Configure custom detection rules.
- B. Create an Exact Data Match (EDM) schema.
- C. Run the Sec-RegulatoryComplianceUI cmdlet.
- D. Run the Sec-LabelPolicy cmdlet.

Answer: C

Explanation:

Reference:

<https://docs.microsoft.com/en-us/microsoft-365/compliance/declare-records?view=o365-worldwide>

NEW QUESTION 239

- (Exam Topic 4)

You have a Microsoft 365 E5 tenant that contains 500 Android devices enrolled in Microsoft Intune. You need to use Microsoft Endpoint Manager to deploy a managed Google Play app to the devices.

Which four actions should you perform in sequence? To answer, move the appropriate actions from the list of actions to the answer area and arrange them in the correct order.

Actions

Create an app configuration policy

Link the account to Intune

Create a Microsoft account

Configure a mobile device management (MDM) push certificate

Add the app

Create a Google account

Assign the app

Answer Area

>

<

↑

↓

- A. Mastered
- B. Not Mastered

Answer: A

Explanation:

Graphical user interface, text, application Description automatically generated

Reference:

<https://docs.microsoft.com/en-us/mem/intune/apps/apps-add-android-for-work#assign-a-managed-google-play-a>

NEW QUESTION 241

- (Exam Topic 4)

You have 100 computers that run Windows 8.1 and are enrolled in Upgrade Readiness. Two of the computers are configured as shown in the following table.

| Name | Architecture | Memory | Applications installed |
|-----------|--------------|--------|------------------------|
| Computer1 | 64-bit | 1 GB | App1 |
| Computer2 | 32-bit | 2 GB | App2 |

From Upgrade Readiness, you view the applications shown in the following table.

| Name | UpgradeDecision |
|------|--------------------|
| App1 | Ready to upgrade |
| App2 | Review in progress |

You enroll a computer named Computer3 in Upgrade Readiness. Computer3 has the following configurations:

- > 8 GB of memory
- > 64-bit architecture
- > An application named App3 installed App3 is installed on Computer3 only.

For each of the following statements, select Yes if the statement is true. Otherwise, select No.

NOTE: Each correct selection is worth one point.

| Statements | Yes | No |
|--|-----------------------|-----------------------|
| Computer1 has an UpgradeDecision status of Ready to upgrade. | <input type="radio"/> | <input type="radio"/> |
| Computer2 has an UpgradeDecision status of Ready to upgrade. | <input type="radio"/> | <input type="radio"/> |
| Computer3 has an UpgradeDecision status of Ready to upgrade. | <input type="radio"/> | <input type="radio"/> |

- A. Mastered
B. Not Mastered

Answer: A

Explanation:

| Statements | Yes | No |
|--|----------------------------------|----------------------------------|
| Computer1 has an UpgradeDecision status of Ready to upgrade. | <input type="radio"/> | <input checked="" type="radio"/> |
| Computer2 has an UpgradeDecision status of Ready to upgrade. | <input type="radio"/> | <input checked="" type="radio"/> |
| Computer3 has an UpgradeDecision status of Ready to upgrade. | <input checked="" type="radio"/> | <input type="radio"/> |

NEW QUESTION 243

- (Exam Topic 4)

You have a Microsoft 365 tenant that contains 100 Windows 10 devices. The devices are managed by using Microsoft Endpoint Manager.

You plan to create two attack surface reduction (ASR) policies named ASR1 and ASR2. ASR1 will be used to configure Microsoft Defender Application Guard.

ASR2 will be used to configure Microsoft Defender SmartScreen.

Which ASR profile type should you use for each policy? To answer, select the appropriate options in the answer area.

NOTE: Each correct selection is worth one point.

ASR1: 

Device control

Exploit protection

Application control

App and browser isolation

Attack surface reduction rules

ASR2: 

Device control

Exploit protection

Application control

App and browser isolation

Attack surface reduction rules

- A. Mastered
B. Not Mastered

Answer: A

Explanation:

Graphical user interface, text, application, chat or text message Description automatically generated

Reference:

<https://docs.microsoft.com/en-us/mem/intune/protect/endpoint-security-asr-policy>

NEW QUESTION 244

- (Exam Topic 4)

You have a Microsoft 365 tenant that contains the compliance policies shown in the following table.

| Name | Require BitLocker | Require the device to be at or under the machine risk score |
|---------|-------------------|---|
| Policy1 | Required | High |
| Policy2 | Not configured | Medium |
| Policy3 | Required | Low |

The tenant contains the devices shown in the following table.

| Name | BitLocker Drive Encryption (BitLocker) | Microsoft Defender for Endpoint risk status | Policies applied |
|---------|--|---|------------------|
| Device1 | Configured | High | Policy1, Policy3 |
| Device2 | Not configured | Medium | Policy2, Policy3 |
| Device3 | Not configured | Low | Policy1, Policy2 |

For each of the following statements, select Yes if the statement is true. Otherwise, select No.

| Statements | Yes | No |
|---------------------------------|-----------------------|-----------------------|
| Device1 is marked as compliant. | <input type="radio"/> | <input type="radio"/> |
| Device2 is marked as compliant. | <input type="radio"/> | <input type="radio"/> |
| Device3 is marked as compliant. | <input type="radio"/> | <input type="radio"/> |

- A. Mastered
B. Not Mastered

Answer: A

Explanation:

Graphical user interface, text, application Description automatically generated

NEW QUESTION 247

- (Exam Topic 4)

You have a Microsoft 365 tenant.

You plan to create a retention policy as shown in the following exhibit.

Create a policy to retain what you want and get rid of what you don't.

- ✓ Name your policy
- ✓ Settings
- ✓ Choose locations
- Review your settings

Review your settings

⚠ It will take up to 1 day to apply the retention policy to the locations you chose.

Policy name: contoso [Edit](#)

Description: [Edit](#)

Applies to content in these locations: [Edit](#)

- Exchange email
- OneDrive accounts
- SharePoint sites
- Office 365 groups

Settings: [Edit](#)

Retention period: Don't retain content, but delete it if it's older than 7 years

⚠ Content that's currently older than this will be deleted after you turn on the policy

[Back](#)
[Save for later](#)
[Create this policy](#)
[Cancel](#)

Use the drop-down menus to select the answer choice that completes each statement based on the information presented in the graphic.

NOTE: Each correct selection is worth one point.

Microsoft SharePoint files that are affected by the policy will be [answer choice].

recoverable for up to seven years
deleted seven years after they were created
retained for only seven years from when they were created

Once the policy is created, [answer choice].

some data may be deleted immediately
data will be retained for a minimum of seven years
users will be prevented from permanently deleting email messages for seven years

- A. Mastered
- B. Not Mastered

Answer: A

Explanation:

Microsoft SharePoint files that are affected by the policy will be [answer choice].

recoverable for up to seven years
deleted seven years after they were created
retained for only seven years from when they were created

Once the policy is created, [answer choice].

some data may be deleted immediately
data will be retained for a minimum of seven years
users will be prevented from permanently deleting email messages for seven years

NEW QUESTION 252

- (Exam Topic 4)

Your company uses Windows Defender Advanced Threat Protection (ATP). Windows Defender ATP contains the device groups shown in the following table.

| Rank | Machine group | Member |
|------|------------------------------|--|
| 1 | Group1 | Name starts with COMP |
| 2 | Group2 | Name starts with Comp And OS In Windows 10 |
| 3 | Group3 | OS In Windows Server 2016 |
| Last | Ungrouped machines (default) | Not applicable |

You onboard computers to Windows Defender ATP as shown in the following table.

| Name | Operating system |
|-----------|---------------------|
| Computer1 | Windows 10 |
| Computer2 | Windows Server 2016 |

Of which groups are Computer1 and Computer2 members? To answer, select the appropriate options in the answer area.
NOTE: Each correct selection is worth one point.

Computer1:

▼

Group1 only

Group2 only

Group1 and Group2

Ungrouped machines

Computer2:

▼

Group1 only

Group3 only

Group1 and Group3

- A. Mastered
- B. Not Mastered

Answer: A

Explanation:

Computer1:

▼

Group1 only

Group2 only

Group1 and Group2

Ungrouped machines

Computer2:

▼

Group1 only

Group3 only

Group1 and Group3

NEW QUESTION 253

- (Exam Topic 4)

You have a Microsoft 365 subscription

All users are assigned a Microsoft 365 E3 License.

You enable auditing for your organization.

What is the maximum amount of time data will be retained in the Microsoft 365 audit log?

- A. 2 years
- B. 1 year
- C. 30 days
- D. 90 days

Answer: D

Explanation:

References:

<https://docs.microsoft.com/en-us/office365/securitycompliance/search-the-audit-log-in-security-and-compliance>

NEW QUESTION 257

- (Exam Topic 4)

You have a Microsoft 365 E5 subscription that uses Microsoft Intune. The subscription contains the resources shown in the following table.

| Name | Type | Member of |
|---------|--------|-----------|
| User1 | User | Group1 |
| Device1 | Device | Group2 |

User1 is the owner of Device1.

You add Microsoft 365 Apps Windows 10 and later app types to Intune as shown in the following table. On Thursday, you review the results of the app deployments.

| Name | Shows in Company Portal | Assignment | Microsoft Office app to install | Day of creation |
|------|-------------------------|--------------------|---------------------------------|-----------------|
| App1 | Yes | Group1 - Required | Word | Monday |
| App2 | Yes | Group2 - Required | Excel | Tuesday |
| App3 | Yes | Group1 - Available | PowerPoint | Wednesday |

For each of the following statements, select Yes if the statement is true. Otherwise, select No. NOTE: Each correct selection is worth one point.

Answer Area

| Statements | Yes | No |
|--|-----------------------|-----------------------|
| Word is installed on Device1. | <input type="radio"/> | <input type="radio"/> |
| App3 is displayed in the Company Portal. | <input type="radio"/> | <input type="radio"/> |
| Excel is installed on Device1. | <input type="radio"/> | <input type="radio"/> |

- A. Mastered
- B. Not Mastered

Answer: A

Explanation:

Answer Area

| Statements | Yes | No |
|--|----------------------------------|-----------------------|
| Word is installed on Device1. | <input checked="" type="radio"/> | <input type="radio"/> |
| App3 is displayed in the Company Portal. | <input checked="" type="radio"/> | <input type="radio"/> |
| Excel is installed on Device1. | <input checked="" type="radio"/> | <input type="radio"/> |

NEW QUESTION 262

- (Exam Topic 4)

Your company has a Microsoft 365 subscription. you implement sensitivity Doris for your company.

You need to automatically protect email messages that contain the word Confidential m the subject line. What should you create?

- A. a sharing policy from the Exchange admin center
- B. a mail flow rule from the Exchange admin center
- C. a message Dace from the Microsoft 365 security center
- D. a data loss prevention (DLP) policy from the Microsoft 365 compliance center

Answer: B

NEW QUESTION 265

- (Exam Topic 4)

DRAG DROP

Your network contains an on-premises Active Directory domain that syncs to Azure Active Directory (Azure AD). The domain contains the servers shown in the following table.

| Name | Operating system | Configuration |
|---------|---------------------|-------------------------------------|
| Server1 | Windows Server 2016 | File Server Resource Manager (FSRM) |
| Server2 | Windows Server 2016 | None |

You use Azure Information Protection.

You need to ensure that you can apply Azure Information Protection labels to the file stores on Server1. Which three actions should you perform in sequence? To answer, move the appropriate actions from the list of actions to the answer area and arrange them in the correct order.

| Actions | Answer Area |
|---|-------------|
| Authorize Server1. | |
| Install the Microsoft Rights Management connector on Server2. | |
| Install a certificate on Server2. | |
| Install a certificate on Server1. | |
| Register a service principal name for Server1. | |
| Run GenConnectorConfig.ps1 on Server1. | |
| Run GenConnectorConfig.ps1 on Server2. | |

- A. Mastered
- B. Not Mastered

Answer: A

Explanation:
Reference:
<https://docs.microsoft.com/en-us/azure/information-protection/install-configure-rms-connector> <https://docs.microsoft.com/en-us/azure/information-protection/configure-servers-rms-connector>

NEW QUESTION 269
- (Exam Topic 4)
You have a Microsoft 365 E5 tenant.
You configure a device compliance policy as shown in the following exhibit.

Compliance settings Edit

Microsoft Defender ATP

| | |
|--|-----|
| Require the device to be at or under the machine risk score. | Low |
|--|-----|

Device Health

| | |
|--|-------|
| Rooted devices Require the device to be at or under the Device Threat Level | Block |
|--|-------|

System Security

| | |
|---|----------------|
| Require a password to unlock mobile devices | Require |
| Required password type | Device default |
| Encryption of data storage on device. | Require |
| Block apps from unknown sources | Block |

Actions for noncompliance Edit

| Action | |
|--------------------------------|-------------|
| | Schedule |
| Mark device noncompliant | Immediately |
| Retire the noncompliant device | Immediately |

Use the drop-down menus to select the answer choice that completes each statement based on the information presented in the graphic.
NOTE: Each correct selection is worth one point.

When a device reports a medium threat level, the device will

be locked remotely

display a notification

marked as compliant

marked as noncompliant

removed from the database

Rooted devices will be

allowed to access company resources

marked as compliant

prevented from accessing company resources

reported with a low device threat

- A. Mastered
B. Not Mastered

Answer: A

Explanation:
Graphical user interface, text, application, email Description automatically generated
Reference:
<https://docs.microsoft.com/en-us/mem/intune/protect/compliance-policy-create-android>

NEW QUESTION 272

- (Exam Topic 4)
You have 2,500 Windows 10 devices and a Microsoft 365 E5 tenant that contains two users named User1 and User2. The devices are not enrollment in Microsoft Intune.
In Microsoft Endpoint Manager, the Device limit restrictions are configured as shown in the following exhibit.

| Device limit restrictions | | | |
|---|-----------|--------------|----------|
| Define how many devices each user can enroll. | | | |
| Priority | Name | Device limit | Assigned |
| Default | All Users | 2 | Yes |

In Azure Active Directory (Azure AD), the Device settings are configured as shown in the following exhibit.

Users may register their devices with Azure AD ⓘ

All

None

Learn more on how this setting works

Require Multi-Factor Auth to join devices ⓘ

Yes

No

Maximum number of devices per user ⓘ

5

From Microsoft Endpoint Manager, you add User2 as a device enrollment manager (DEM). For each of the following statement, select Yes if the statement is true. Otherwise, select No. NOTE: Each correct selection is worth one point.

| Answer Area | | |
|---|-----------------------|-----------------------|
| Statements | Yes | No |
| User1 can enroll only five devices in Intune. | <input type="radio"/> | <input type="radio"/> |
| User1 can join only five devices to Azure AD. | <input type="radio"/> | <input type="radio"/> |
| User2 can enroll all the devices in Intune. | <input type="radio"/> | <input type="radio"/> |

- A. Mastered
B. Not Mastered

Answer: A

Explanation:

Answer Area

| Statements | Yes | No |
|---|----------------------------------|----------------------------------|
| User1 can enroll only five devices in Intune. | <input type="radio"/> | <input checked="" type="radio"/> |
| User1 can join only five devices to Azure AD. | <input type="radio"/> | <input checked="" type="radio"/> |
| User2 can enroll all the devices in Intune. | <input checked="" type="radio"/> | <input type="radio"/> |

NEW QUESTION 277

- (Exam Topic 4)

You have a Microsoft 365 tenant and a LinkedIn company page.

You plan to archive data from the LinkedIn page to Microsoft 365 by using the LinkedIn connector. Where can you store data from the LinkedIn connector?

- A. a Microsoft OneDrive for Business folder
- B. a Microsoft SharePoint Online document library
- C. a Microsoft 365 mailbox
- D. Azure Files

Answer: C

Explanation:

Reference:

<https://docs.microsoft.com/en-us/microsoft-365/compliance/archive-linkedin-data?view=o365-worldwide>

NEW QUESTION 282

- (Exam Topic 4)

Note: This question is part of a series of questions that present the same scenario. Each question in the series contains a unique solution that might meet the stated goals. Some question sets might have more than one correct solution, while others might not have a correct solution.

After you answer a question in this section, you will NOT be able to return to it. As a result, these questions will not appear in the review screen.

Your network contains an on-premises Active Directory domain. The domain contains domain controllers that run Windows Server 2019. The functional level of the forest and the domain is Windows Server 2012 R2.

The domain contains 100 computers that run Windows 10 and a member server named Server1 that runs Windows Server 2012 R2.

You plan to use Server1 to manage the domain and to configure Windows 10 Group Policy settings. You install the Group Policy Management Console (GPMC) on Server1.

You need to configure the Windows Update for Business Group Policy settings on Server1. Solution: You upgrade Server1 to Windows Server 2019.

Does this meet the goal?

- A. yes
- B. No

Answer: A

NEW QUESTION 287

- (Exam Topic 4)

You have a Microsoft 365 tenant.

All users are assigned the Enterprise Mobility + Security license.

You need to ensure that when users join their device to Microsoft Azure Active Directory (Azure AD), the device is enrolled in Microsoft Intune automatically.

What should you configure?

- A. Enrollment restrictions from the Intune admin center
- B. device enrollment managers from the Intune admin center
- C. MAM User scope from the Azure Active Directory admin center
- D. MDM User scope from the Azure Active Directory admin center

Answer: D

Explanation:

References:

<https://docs.microsoft.com/en-us/intune/windows-enroll>

NEW QUESTION 292

- (Exam Topic 4)

You have a Microsoft 365 subscription.

You need to view the IP address from which a user synced a Microsoft SharePoint library. What should you do?

- A. From the SharePoint admin center, view the usage reports.
- B. From the Security & Compliance admin center, perform an audit log search.
- C. From the Microsoft 365 admin center, view the usage reports.
- D. From the Microsoft 365 admin center, view the properties of the user's user account.

Answer: B

Explanation:

References:

<https://docs.microsoft.com/en-us/office365/securitycompliance/search-the-audit-log-in-security-and-compliance>

NEW QUESTION 297

- (Exam Topic 4)

You have a Microsoft 365 tenant.

You plan to enable BitLocker Disk Encryption (BitLocker) automatically for all Windows 10 devices that enroll in Microsoft Intune.

What should you use?

- A. an attack surface reduction (ASR) policy
- B. an app configuration policy
- C. a device compliance policy
- D. a device configuration profile

Answer: D

Explanation:

Reference:

<https://docs.microsoft.com/en-us/mem/intune/protect/encrypt-devices>

NEW QUESTION 302

- (Exam Topic 4)

You have a Microsoft 365 subscription that uses a default domain named contoso.com. The domain contains the users shown in the following table.

| Name | Member of |
|-------|----------------|
| User1 | Group1 |
| User2 | Group1, Group2 |

The domain contains the devices shown in the following table.

| Name | Compliance status |
|---------|-------------------|
| Device1 | Compliant |
| Device2 | Noncompliant |

The domain contains conditional access policies that control access to a cloud app named App1. The policies are configured as shown in the following table.

| Name | Includes | Excludes | Device state includes | Device state excludes | Grant |
|---------|----------|----------|-----------------------|----------------------------|--------------|
| Policy1 | Group1 | None | All device states | Device marked as compliant | Block access |
| Policy2 | Group1 | Group2 | None | None | Block Access |
| Policy3 | Group1 | None | All device states | None | Grant access |

For each of the following statements, select Yes if the statement is true. Otherwise, select No.

NOTE: Each correct selection is worth one point.

| Statements | Yes | No |
|-------------------------------------|-----------------------|-----------------------|
| User1 can access App1 from Device1. | <input type="radio"/> | <input type="radio"/> |
| User2 can access App1 from Device1. | <input type="radio"/> | <input type="radio"/> |
| User2 can access App1 from Device2. | <input type="radio"/> | <input type="radio"/> |

- A. Mastered
- B. Not Mastered

Answer: A

Explanation:

Yes Yes No

NEW QUESTION 305

- (Exam Topic 4)

Your company has a Microsoft E5 tenant.

The company must meet the requirements of the ISO/IEC 27001:2013 standard. You need to assess the company's current state of compliance.

What should you use?

- A. eDiscovery
- B. Information governance
- C. Compliance Manager
- D. Data Subject Requests (DSRs)

Answer: C

Explanation:

Reference:

<https://docs.microsoft.com/en-us/compliance/regulatory/offering-iso-27001>

NEW QUESTION 309

- (Exam Topic 4)

You have several devices enrolled in Microsoft Intune.

You have a Microsoft Azure Active Directory (Azure AD) tenant that includes the users shown in the following table.

| Name | Role | Member of |
|-------|----------------------------|-----------|
| User1 | Cloud device administrator | Group1 |
| User2 | Intune administrator | Group2 |
| User3 | None | None |

The device limit restrictions in Intune are configured as shown in the following table.

| Priority | Name | Device limit | Assigned to |
|----------|-----------|--------------|-------------|
| 1 | Policy1 | 15 | Group2 |
| 2 | Policy2 | 10 | Group1 |
| Default | All users | 5 | All users |

You add User3 as a device enrollment manager in Intune.

For each of the following statements, select Yes if the statement is true. Otherwise, select No.

NOTE: Each correct selection is worth one point.

| Statements | Yes | No |
|--|-----------------------|-----------------------|
| User1 can enroll a maximum of 10 devices in Intune. | <input type="radio"/> | <input type="radio"/> |
| User2 can enroll a maximum of 10 devices in Intune. | <input type="radio"/> | <input type="radio"/> |
| User3 can enroll an unlimited number of devices in Intune. | <input type="radio"/> | <input type="radio"/> |

A. Mastered

B. Not Mastered

Answer: A

Explanation:

References:

<https://docs.microsoft.com/en-us/sccm/mdm/deploy-use/enroll-devices-with-device-enrollment-manager>

NEW QUESTION 314

- (Exam Topic 4)

You have a Microsoft 365 E5 subscription that contains a user named User1.

The subscription has a single anti-malware policy as shown in the following exhibit.

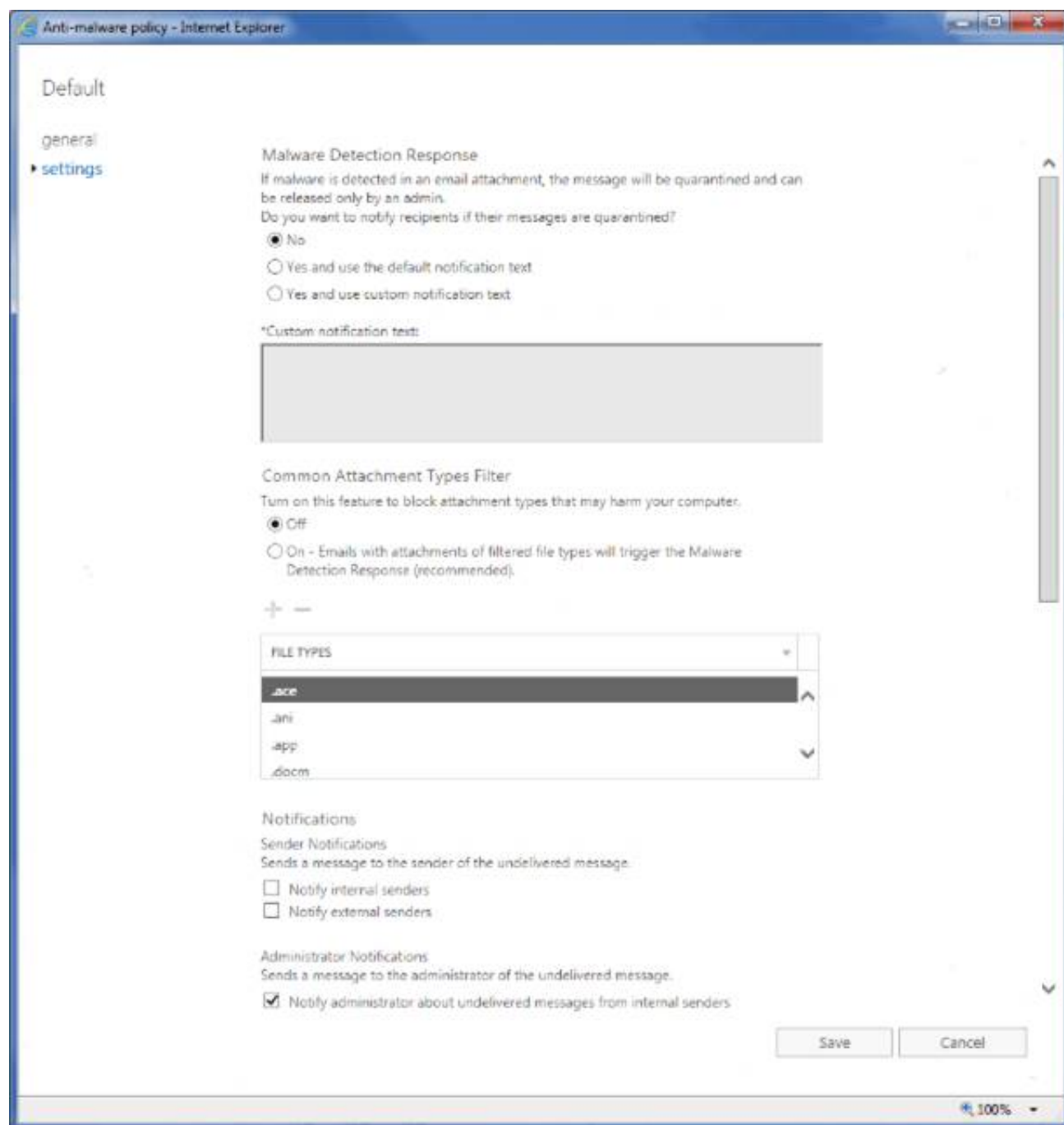

An email message that contains text and two attachments is sent to User1. One attachment is infected with malware. How will the email message and the attachments be processed?

- A. Both attachments will be remove
- B. The email message will be quarantined, and Used will receive an email message without any attachments and an email message that includes the following text: 'Malware was removed.'
- C. The email message will be quarantined, and the message will remain undelivered.
- D. Both attachments will be remove
- E. The email message will be quarantined, and User1 will receive a copy of the message containing the original text and a new attachment that includes the following text: 'Malware was removed.'
- F. The malware-infected attachment will be remove
- G. The email message will be quarantined, and User1 will receive a copy of the message containing only the uninfected attachment.

Answer: C

Explanation:

Reference:

<https://docs.microsoft.com/en-us/microsoft-365/security/office-365-security/anti-malware-protection?view=o366>

NEW QUESTION 315

- (Exam Topic 4)

Note: This question is part of a series of questions that present the same scenario. Each question in the series contains a unique solution that might meet the stated goals- Some question sets might have more than one correct solution, while others might not have a correct solution.

After you answer a question in this section, you will NOT be able to return to it. As a result, these questions will not appear in the review screen.

Your network contains an Active Directory domain named contoso.com that is synced to Microsoft Azure Active Directory (Azure AD).

You manage Windows 10 devices by using Microsoft System Center Configuration Manager (Current Branch).

You configure pilot co-management

You add a new device named Device 1 to the domain. You install the Configuration Manager client on Device1.

You need to ensure that you can manage Device1 by using Microsoft Intune and Configuration Manager.

Solution: You create a device configuration profile from the Intune admin center. Does this meet the goal?

- A. Yes
- B. No

Answer: B

NEW QUESTION 320

- (Exam Topic 4)

You have a Microsoft 365 E5 tenant.

industry regulations require that the tenant comply with the ISO 27001 standard. You need to evaluate the tenant based on the standard

- A. From Policy in the Azure portal, select Compliance, and then assign a pokey
- B. From Compliance Manager, create an assessment
- C. From the Microsoft J6i compliance center, create an audit retention policy.
- D. From the Microsoft 365 admin center enable the Productivity Score.

Answer: B

NEW QUESTION 322

- (Exam Topic 4)
You configure a data loss prevention (DLP) policy named DLP1 as shown in the following exhibit.

Choose the types of content to protect

This policy will protect that matches these requirements. You can choose sensitive info types and existing labels

Content contains

Any of these ▾

| Sensitive info type | Match accuracy |
|---------------------|----------------|
| | minmax |
| Credit Card Number | 85100x |

Retention labels

1 year

Add ▾

+ Add group

Use the drop-down menus to select the answer choice that completes each statement based on the information presented in the graphic.
NOTE: Each correct selection is worth one point.

DLP1 cannot be applied to [answer choice].

Exchange email

SharePoint sites

OneDrive accounts

DLP1 will be applied only to documents that have [answer choice].

both a credit card number and the 1 year label applied

either a credit card number or the 1 year label applied

between 85 and 100 credit card numbers

- A. Mastered
- B. Not Mastered

Answer: A

Explanation:
Using a retention label in a policy is only supported for items in SharePoint Online and OneDrive for Business.
Reference:
<https://docs.microsoft.com/en-us/microsoft-365/compliance/data-loss-prevention-policies?view=o365-worldwid>

NEW QUESTION 327

- (Exam Topic 4)
You have a Microsoft 365 E5 tenant that contains the users shown in the following table.

| Name | Azure Active Directory (Azure AD) role | Microsoft Store for Business role | Member of |
|-------|--|-----------------------------------|-----------|
| User1 | Application administrator | Basic Purchaser | Group1 |
| User2 | None | Purchaser | Group2 |
| User3 | None | Basic Purchaser | Group3 |

You perform the following actions:

- > Provision the private store in Microsoft Store for Business.
- > Add an app named App1 to the private store.
- > Set Private store availability for App1 to Specific groups, and then select Group3.

For each of the following statements, select Yes if the statement is true. Otherwise, select No.
NOTE: Each correct selection is worth one point.

Your Partner of IT Exam

visit - <https://www.exambible.com>

| Statements | Yes | No |
|--|-----------------------|-----------------------|
| User1 can install App1 from the private store. | <input type="radio"/> | <input type="radio"/> |
| User2 can install App1 from the private store. | <input type="radio"/> | <input type="radio"/> |
| User3 can install App1 from the private store. | <input type="radio"/> | <input type="radio"/> |

- A. Mastered
B. Not Mastered

Answer: A

Explanation:

Text Description automatically generated

Reference:

<https://docs.microsoft.com/en-us/microsoft-store/app-inventory-management-microsoft-store-for-business#priva>

NEW QUESTION 331

- (Exam Topic 4)

Note: This question is part of a series of questions that present the same scenario. Each question in the series contains a unique solution that might meet the stated goals. Some question sets might have more than one correct solution, while others might not have a correct solution.

After you answer a question in this section, you will NOT be able to return to it. As a result, these questions will not appear in the review screen.

You have a computer that runs Windows 10.

You need to verify which version of Windows 10 is installed. Solution: From Device Manager, you view the computer properties.

Does this meet the goal?

- A. Yes
B. No

Answer: B

Explanation:

Reference:

<https://support.microsoft.com/en-us/windows/which-version-of-windows-operating-system-am-i-running-628be>

NEW QUESTION 335

- (Exam Topic 4)

Note: This question is part of a series of questions that present the same scenario. Each question in the series contains a unique solution that might meet the stated goals. Some question sets might have more than one correct solution, while others might not have a correct solution.

After you answer a question in this section, you will NOT be able to return to it. As a result, these questions will not appear in the review screen.

Your network contains an on-premises Active Directory domain. The domain contains 2,000 computers that run Windows 8.1 and have applications installed as shown in the following table.

| Name | Application count | Used by |
|------|-------------------|--------------------------------------|
| App1 | 20 | Finance department, sales department |
| App2 | 100 | Marketing department |

You enroll all the computers in Upgrade Readiness.

You need to ensure that App1 and App2 have an UpgradeDecision status of Ready to upgrade. Solution: You set the Importance status of App1 to Business critical.

Does this meet the goal?

- A. Yes
B. No

Answer: B

Explanation:

Business Critical will prevent the app having a status of Ready to upgrade. References:

<https://docs.microsoft.com/en-us/windows/deployment/upgrade/upgrade-readiness-identify-apps>

NEW QUESTION 338

- (Exam Topic 4)

HOTSPOT

You have a Microsoft 365 E5 subscription linked to an Azure Active Directory (Azure AD) tenant. The tenant contains a group named Group1 and the users shown in the following table:

| Name | Role |
|--------|----------------------------------|
| Admin1 | Conditional Access administrator |
| Admin2 | Security administrator |
| Admin3 | User administrator |

The tenant has a conditional access policy that has the following configurations: Name: Policy1
Assignments:

- Users and groups: Group1
- Cloud aps or actions: All cloud apps
- > Access controls:
- > Grant, require multi-factor authentication
- > Enable policy: Report-only

You set Enabled Security defaults to Yes for the tenant.
For each of the following settings select Yes, if the statement is true. Otherwise, select No.
NOTE: Each correct selection is worth one point.

| Statements | Yes | No |
|---|-----------------------|-----------------------|
| Admin1 can set Enable policy for Policy1 to On . | <input type="radio"/> | <input type="radio"/> |
| Admin2 can set Enable policy for Policy1 to Off . | <input type="radio"/> | <input type="radio"/> |
| Admin3 can set Users and groups for Policy1 to All users . | <input type="radio"/> | <input type="radio"/> |

- A. Mastered
- B. Not Mastered

Answer: A

Explanation:
Report-only mode is a new Conditional Access policy state that allows administrators to evaluate the impact of Conditional Access policies before enabling them in their environment. With the release of report-only mode:

- > Conditional Access policies can be enabled in report-only mode.
- > During sign-in, policies in report-only mode are evaluated but not enforced.
- > Results are logged in the Conditional Access and Report-only tabs of the Sign-in log details.
- > Customers with an Azure Monitor subscription can monitor the impact of their Conditional Access policies using the Conditional Access insights workbook.

Reference:
<https://docs.microsoft.com/en-us/azure/active-directory/conditional-access/concept-conditional-access-report-on>

NEW QUESTION 339

- (Exam Topic 4)
You have a Microsoft Azure Active Directory (Azure AD) tenant named contoso.onmicrosoft.com. Your company implements Windows Information Protection (WIP).
You need to modify which users and applications are affected by WIP.
What should you do? To answer, select the appropriate options m the answer area. NOTE: Each correct selection is worth one point.

To modify which users are affected by WIP, configure:

The Azure AD app registration

The Azure AD device settings

The MAM User scope

The mobile device management (MDM) authority

To modify which applications are affected by WIP, configure:

App configuration policies

App protection policies

Compliance policies

Device configuration profiles

- A. Mastered
- B. Not Mastered

Answer: A

Explanation:
References:
<https://docs.microsoft.com/en-us/windows/security/information-protection/windows-information-protection/crea>

NEW QUESTION 340

- (Exam Topic 4)
You have a Microsoft 365 E5 tenant.
You create a retention label named Retention1 as shown in the following exhibit.

Review your settings

Name [Edit](#)

Retention1

Description for admins [Edit](#)

Description for users [Edit](#)

File plan descriptors [Edit](#)

Reference Id:1

Business function/department Legal

Category: Compliance

Authority type: Legal

Retention [Edit](#)

7 years

Retain only

Based on when it was created

[Back](#)

[Create this label](#)

[Cancel](#)

When users attempt to apply Retention1, the label is unavailable. You need to ensure that Retention1 is available to all the users. What should you do?

- A. Create a new label policy
- B. Modify the Authority type setting for Retention!
- C. Modify the Business function/department setting for Retention 1.
- D. Use a file plan CSV template to import Retention1.

Answer: A

Explanation:

Reference:

<https://docs.microsoft.com/en-us/microsoft-365/compliance/create-apply-retention-labels?view=o365-worldwid>

NEW QUESTION 342

- (Exam Topic 4)

A user receives the following message when attempting to sign in to <https://myapps.microsoft.com>:

"Your sign-in was blocked. We've detected something unusual about this sign-in. For example, you might be signing in from a new location device, or app. Before you can continue, we need to verify your identity. Please contact your admin."

Which configuration prevents the users from signing in?

- A. Microsoft Azure Active Directory (Azure AD) Identity Protection policies
- B. Microsoft Azure Active Directory (Azure AD) conditional access policies
- C. Security & Compliance supervision policies
- D. Security & Compliance data loss prevention (DIP) policies

Answer: B

Explanation:

References:

<https://docs.microsoft.com/en-us/azure/active-directory/conditional-access/overview>

NEW QUESTION 343

- (Exam Topic 4)

You have a Microsoft 365 tenant that has Enable Security defaults set to No in Azure Active Directory (Azure AD).

The tenant has two Compliance Manager assessments as shown in the following table.

| Name | Score | Status | Assessment progress | Your improvement actions | Microsoft actions | Group | Product | Regulation |
|--------------------------|-------|------------|---------------------|--------------------------|----------------------|--------|---------------|--------------------------|
| SP800 | 15444 | Incomplete | 72% | 3 of 450 completed | 887 of 887 completed | Group1 | Microsoft 365 | NIST 800-53 |
| Data Protection Baseline | 14370 | Incomplete | 70% | 3 of 489 completed | 835 of 835 completed | Group2 | Microsoft 365 | Data Protection Baseline |

The SP800 assessment has the improvement actions shown in the following table.

| Improvement action | Test status | Impact | Points achieved | Regulations |
|---|-------------|-----------|-----------------|---------------------------------------|
| Establish a threat intelligence program | None | +9 points | 0/9 | NIST 800-53, Data Protection Baseline |
| Establish and document a configuration management program | None | +9 points | 0/9 | NIST 800-53, Data Protection Baseline |

You perform the following actions:

- For the Data Protection Baseline assessment, change the Test status of Establish a threat intelligence program to Implemented.
- Enable multi-factor authentication (MFA) for all users.

For each of the following statements, select Yes if the statement is true. Otherwise, select No.

NOTE: Each correct selection is worth one point.

| Statements | Yes | No |
|---|-----------------------|-----------------------|
| Establish a threat intelligence program will appear as Implemented in the SP800 assessment. | <input type="radio"/> | <input type="radio"/> |
| The SP800 assessment score will increase by 54 points. | <input type="radio"/> | <input type="radio"/> |
| The Data Protection Baseline score will increase by 9 points. | <input type="radio"/> | <input type="radio"/> |

- A. Mastered
- B. Not Mastered

Answer: A

Explanation:

Graphical user interface, text Description automatically generated

Reference:

[https://docs.microsoft.com/en-us/microsoft-365/compliance/compliance-manager-assessments?view=o365-world](https://docs.microsoft.com/en-us/microsoft-365/compliance/compliance-manager-assessments?view=o365-worldwide) [https://docs.microsoft.com/en-us/microsoft-365/compliance/compliance-score-calculation?view=o365-worldwid](https://docs.microsoft.com/en-us/microsoft-365/compliance/compliance-score-calculation?view=o365-worldwide)

NEW QUESTION 345

- (Exam Topic 4)

You have a Microsoft 365 ES subscription that has three auto retention policies as show in the following exhibit.

```
Select Administrator: Windows PowerShell

Name           : Retention1
Priority        : 200
RecordTypes    : {MicrosoftTeams}
Operations     : {}
UserIds        : {}
RetentionDuration : ThreeMonths

Name           : Retention2
Priority        : 150
RecordTypes    : {MicrosoftTeams}
Operations     : {teamcreated}
UserIds        : {User1@sk200628outlook.onmicrosoft.com}
RetentionDuration : SixMonths

Name           : Retention3
Priority        : 100
RecordTypes    : {}
Operations     : {}
UserIds        : {User2@sk200628outlook.onmicrosoft.com}
RetentionDuration : TwelveMonths

PS C:\>
```

Use the drop-down menus to select the answer choice that completes each statement based on the information presented in the graphic NOTE Each correct selection is worth one point.

- Answer: A**

Answer Area

If User1 creates a team in Microsoft Teams, the event is [answer choice]

not retained
retained for 90 days
retained for six months
retained for one year

If User2 adds a channel in Microsoft Teams, the event is [answer choice]

not retained
retained for 90 days
retained for six months
retained for one year

in the Microsoft Endpoint Manager admin center, you discover many stale and inactive devices, You enable device clean-up rules. What can you configure as the minimum number of days before a device is removed automatically?

- Answer: D**

| Name | Date created | Date last modified |
|-------|------------------|--------------------|
| File1 | January 1, 2019 | January 16, 2019 |
| File2 | January 15, 2019 | January 20, 2019 |

On February 1, 2019, you apply a retention policy named Policy1 as shown in the following exhibit.

Back Next Cancel

Your Partner of IT Exam

NOTE: Each correct selection is worth one point.

| Statements | Yes | No |
|--|-----------------------|-----------------------|
| On March 1, 2019, File 1 is deleted automatically. | <input type="radio"/> | <input type="radio"/> |
| On February 20, 2019, File 2 is available in OneDrive. | <input type="radio"/> | <input type="radio"/> |
| On March 5, 2019, File 2 is deleted automatically. | <input type="radio"/> | <input type="radio"/> |

- A. Mastered
B. Not Mastered

Answer: A

Explanation:

| Statements | Yes | No |
|--|----------------------------------|-----------------------|
| On March 1, 2019, File 1 is deleted automatically. | <input checked="" type="radio"/> | <input type="radio"/> |
| On February 20, 2019, File 2 is available in OneDrive. | <input checked="" type="radio"/> | <input type="radio"/> |
| On March 5, 2019, File 2 is deleted automatically. | <input checked="" type="radio"/> | <input type="radio"/> |

NEW QUESTION 360

- (Exam Topic 4)

You have a Microsoft 365 subscription.

You are configuring permissions for Security & Compliance.

You need to ensure that the users can perform the tasks shown in the following table.

| Name | Task |
|-------|---|
| User1 | Download all Security & Compliance reports |
| User2 | Create and manage Security & Compliance alerts. |

The solution must use the principle of least privilege.

To which role should you assign each user? To answer, select the appropriate options in the answer area. NOTE: Each correct selection is worth one point.

User1:

Records Management

Security Administrator

Security Reader

Supervisory Review

User2:

Compliance Administrator

Organization Management

Security Administrator

Security Reader

Supervisory Review

- A. Mastered
B. Not Mastered

Answer: A

Explanation:

References:

<https://docs.microsoft.com/en-us/office365/securitycompliance/permissions-in-the-security-and-compliance-cen>

NEW QUESTION 363

- (Exam Topic 4)

From the Security & Compliance admin center, you create a retention policy named Policy1. You need to prevent all users from disabling the policy or reducing the retention period. Which command should you run? To answer, select the appropriate options in the answer area. NOTE: Each correct selection is worth one point.

Answer Area

▼

Set-ComplianceTag

Set-HoldCompliancePolicy

Set-RetentionCompliancePolicy

Set-RetentionPolicy

Set-RetentionPolicyTag

-Identity "Policy1"

▼

\$true

-enabled

-Force

-RestrictiveRetention

-RetentionPolicyTagLinks

-SystemTag

- A. Mastered
B. Not Mastered

Answer: A

Explanation:

References:

<https://docs.microsoft.com/en-us/powershell/module/exchange/policy-and-compliance-retention/set-retentionco>

NEW QUESTION 366

- (Exam Topic 4)

You have a Microsoft 365 subscription that contains the users shown in the following table.

| Name | Role |
|-------|------------------------|
| User1 | Exchange administrator |
| User2 | Security administrator |
| User3 | None |

You run the following cmdlet.

```
Set-MailboxAuditBypassAssociation -Identity User2
```

```
-AuditByPassEnabled $true
```

The users perform the following actions:

- > User1 accesses an item in the mailbox of User2.
- > User2 modifies a mailbox item in the mailbox of User3.
- > User3 signs in to her mailbox.

For each of the following statements, select Yes if the statement is true. Otherwise, select No.

NOTE: Each correct selection is worth one point.

| Statements | Yes | No |
|---|-----------------------|-----------------------|
| The action performed by User1 is audited. | <input type="radio"/> | <input type="radio"/> |
| The action performed by User2 is audited. | <input type="radio"/> | <input type="radio"/> |
| The action performed by User3 is audited. | <input type="radio"/> | <input type="radio"/> |

- A. Mastered
B. Not Mastered

Answer: A

Explanation:

Reference:

<https://docs.microsoft.com/en-us/powershell/module/exchange/set-mailboxauditbypassassociation?view=exchan>

NEW QUESTION 367

- (Exam Topic 4)

You have a Microsoft Azure Active Directory (Azure AD) tenant named contoso.com.

A user named User1 has files on a Windows 10 device as shown in the following table.

| Name | Text in file |
|------------|--|
| File1.docx | Importing and exporting is easy. For import, you need a source, and for export, you need a destination. |
| File2.docx | You must declare what you want to import. Dangerous items cannot be imported. If you want to import valuables, you must pay customs. |
| File3.docx | IM are initials for instant messaging. You can use Microsoft Skype for IM, but there are also other IM programs. |

In Azure Information Protection, you create a label named Label1 that is configured to apply automatically. Label1 is configured as shown in the following exhibit.

Condition: Condition1

Default Directory – Azure Information Protection

Save

Discard

Delete

Choose the type of condition

Information Types

Custom

Name

Condition1

Match exact phrase or pattern

im

Match as a regular expression

Off

On

Match with case sensitivity

Off

On

Minimum number of occurrences

2

Count occurrences with unique values only

Off

On

For each of the following statements, select Yes if the statement is true. Otherwise, select No.
NOTE: Each correct selection is worth one point.

| Statements | Yes | No |
|-------------------------------|-----------------------|-----------------------|
| Label1 applies to File1.docx. | <input type="radio"/> | <input type="radio"/> |
| Label1 applies to File2.docx. | <input type="radio"/> | <input type="radio"/> |
| Label1 applies to File3.docx. | <input type="radio"/> | <input type="radio"/> |

- A. Mastered
- B. Not Mastered

Answer: A

Explanation:

The phrase to match is "im" and it is case sensitive. The phrase must also appear at least twice. Box 1: No
File1.docx contain the word "import" once only
Box 2: Yes
File2.docx contains two occurrences of the word "import" as well as the word "imported" Box 3: No
File3.docx contains "IM" but his is not the correct letter case. References:
<https://docs.microsoft.com/en-us/azure/information-protection/configure-policy-classification>

NEW QUESTION 371

- (Exam Topic 4)
DRAG DROP

You have a Microsoft 365 E5 subscription. Several users have iOS devices.
You plan to enroll the iOS devices in Microsoft Endpoint Manager.
You need to ensure that you can create an iOS/iPadOS enrollment profile in Microsoft Endpoint Manager. Which three actions should you perform in sequence?
To answer, move the appropriate actions from the list of actions to the answer area and arrange them in the correct order.

Actions

From the Microsoft Endpoint Manager admin center, add a device enrollment manager.

From the Microsoft Endpoint Manager admin center, download a certificate signing request.

Upload an Apple MDM push certificate to Microsoft Endpoint Manager.

Create a certificate from the Apple Push Certificates Portal.

From the Microsoft Endpoint Manager admin center, configure device enrollment restrictions.

Answer Area

>

<

↑

↓

- A. Mastered
- B. Not Mastered

Answer: A

Explanation:
Reference:
<https://docs.microsoft.com/en-us/mem/intune/enrollment/apple-mdm-push-certificate-get>

NEW QUESTION 372

- (Exam Topic 4)
Your company uses Microsoft Defender Advanced Threat Protection (ATP). Microsoft Defender ATP includes the machine groups shown in the following table.

| Rank | Machine group | Members |
|------|------------------------------|---|
| 1 | Group1 | Tag Equals demo And OS In Windows 10 |
| 2 | Group2 | Tag Equals demo |
| 3 | Group3 | Domain Equals adatum.com |
| 4 | Group4 | Domain Equals adatum.com And OS In Windows 10 |
| Last | Ungrouped machines (default) | Not applicable |

You onboard a computer named computer1 to Microsoft Defender ATP as shown in the following exhibit.

computer1

Actions

Domain: adatum.com
OS: Windows10 64-bit (Build 17134)

Machine IP addresses

Use the drop-down menus to select the answer choice that completes each statement.
NOTE: Each correct selection is worth one point.

Computer1 will be a member of [answer choice].

Group3 only

Group4 only

Group3 and Group4 only

Ungrouped machines

If you add the tag demo to Computer1, the computer will be a member of [answer choice].

Group1 only

Group1 and Group2 only

Group1, Group2, Group3, and Group4

Ungrouped machines

- A. Mastered
- B. Not Mastered

Answer: A

Explanation:
According to this article <https://docs.microsoft.com/en-us/windows/security/threat-protection/microsoft-defender-atp/machine-groups>
- If a machine is also matched to other groups, it is added only to the highest ranked machine group. Part 1 answer should be - computer 1 will be a member of - Group 3 only.
Because its the highest rank and the machine is part of adatum.com Part 2 - if you add the tag demo to computer 1. then the answer should be group 1 only.
Because the machine is tagged "demo" and OS is windows 10.

NEW QUESTION 376

- (Exam Topic 4)

You configure an anti-phishing policy as shown in the following exhibit.

| | | | |
|-------------------|------------------------------------|---|------|
| Policy setting | Policy name | Managers | |
| | Description | | |
| | Applied to | If the email is sent to: IrvinS@M365x289755.OnMicrosoft.com MiriamG@M365x289755.OnMicrosoft.com Except if the email is sent to member of: test1ww@M365x289755.OnMicrosoft.com | Edit |
| Impersonation | Users to protect | On - 3 User(s) specified | |
| | Protect all domains I own | On | |
| | Protect specific domains | On - 2 Domain(s) specified | |
| | Action > User impersonation | Move message to the recipients' Junk Email folders | |
| | Action > Domain impersonation | Delete the message before it's delivered | Edit |
| | Safety tips > User impersonation | Off | |
| | Safety tips > Domain impersonation | Off | |
| | Safety tips > Unusual characters | Off | |
| | Mailbox intelligence | Off | |
| Spoof | Enable antispoofting protection | On | |
| | Action | Quarantine the message | Edit |
| Advanced settings | Advanced phishing thresholds | 3 - More Aggressive | Edit |

Use the drop-down menus to select the answer choice that completes each statement based on the information presented in the graphic.

NOTE: Each correct selection is worth one point.

If a message is identified as a domain impersonation, [answer choice].

the message is delivered to the Inbox folder

the message is moved to the Deleted Items folder

the messages are moved to the Junk Email folder

To reduce the likelihood of the impersonation policy generating false positives, configure [answer choice].

Advanced phishing thresholds

Domain impersonation

Enable antispoofting protection

Mailbox intelligence

- A. Mastered
- B. Not Mastered

Answer: A

Explanation:

References:

<https://docs.microsoft.com/en-us/office365/securitycompliance/set-up-anti-phishing-policies#learn-about-atp-an>

NEW QUESTION 381

.....

Relate Links

100% Pass Your MS-101 Exam with Examible Prep Materials

<https://www.exambible.com/MS-101-exam/>

Contact us

We are proud of our high-quality customer service, which serves you around the clock 24/7.

Viste - <https://www.exambible.com/>