



**Microsoft**

**Exam Questions AI-900**

Microsoft Azure AI Fundamentals (beta)

NEW QUESTION 1

DRAG DROP - (Topic 5)

You plan to deploy an Azure Machine Learning model by using the Machine Learning designer

Which four actions should you perform in sequence? To answer, move the appropriate actions from the list of actions to the answer area and arrange them in the correct order.

Actions

Evaluate the model against the original dataset.

Ingest and prepare a dataset.

Split the data randomly into training data and validation data.

Train the model.

Evaluate the model against the validation dataset.

>

<

Answer Area

1

2

3

4

>

<

- A. Mastered
- B. Not Mastered

Answer: A

Explanation:

Actions

Evaluate the model against the original dataset.

Ingest and prepare a dataset.

Split the data randomly into training data and validation data.

Train the model.

Evaluate the model against the validation dataset.

>

<

Answer Area

1 Ingest and prepare a dataset.

2 Split the data randomly into training data and validation data.

3 Train the model.

4 Evaluate the model against the validation dataset.

>

<

NEW QUESTION 2

HOTSPOT - (Topic 5)

Select the .

Answer Area

You can use the

Custom Vision

Computer Vision

Custom Vision

Form Recognizer

Azure Video Analyzer for Media

service to train an object detection model by using your own images.

- A. Mastered
- B. Not Mastered

Answer: A

Explanation:

Answer Area

You can use the

Custom Vision

Computer Vision

Custom Vision

Form Recognizer

Azure Video Analyzer for Media

service to train an object detection model by using your own images.

NEW QUESTION 3

- (Topic 5)

You have a website that includes customer reviews.

You need to store the reviews in English and present the reviews to users in their respective language by recognizing each user's geographical location.

Which type of natural language processing workload should you use?

- A. translation
- B. language modeling
- C. key phrase extraction
- D. speech recognition

Answer: C

NEW QUESTION 4

HOTSPOT - (Topic 5)

For each of the following statements, select Yes if the statement is true. Otherwise, select No.

NOTE: Each correct selection is worth one point.

Statements	Yes	No
A webchat bot can interact with users visiting a website.	<input type="radio"/>	<input type="radio"/>
Automatically generating captions for pre-recorded videos is an example of conversational AI.	<input type="radio"/>	<input type="radio"/>
A smart device in the home that responds to questions such as "What will the weather be like today?" is an example of conversational AI.	<input type="radio"/>	<input type="radio"/>

- A. Mastered
- B. Not Mastered

Answer: A

Explanation:

Statements	Yes	No
A webchat bot can interact with users visiting a website.	<input checked="" type="radio"/>	<input type="radio"/>
Automatically generating captions for pre-recorded videos is an example of conversational AI.	<input checked="" type="radio"/>	<input type="radio"/>
A smart device in the home that responds to questions such as "What will the weather be like today?" is an example of conversational AI.	<input checked="" type="radio"/>	<input type="radio"/>

NEW QUESTION 5

- (Topic 5)  
You have an Azure Machine Learning model that uses clinical data to predict whether a patient has a disease. You clean and transform the clinical data. You need to ensure that the accuracy of the model can be proven. What should you do next?

- A. Train the model by using the clinical data.
- B. Split the clinical data into Two datasets.
- C. Train the model by using automated machine learning (automated ML).
- D. Validate the model by using the clinical data.

Answer: D

NEW QUESTION 6

HOTSPOT - (Topic 5)  
Select the answer that correctly completes the sentence

Answer Area

Ensuring an AI system does not provide a prediction when important fields contain unusual or missing values is a privacy and security principle for responsible AI.

a privacy and security

an inclusiveness

a privacy and security

a reliability and safety

a transparency

- A. Mastered
- B. Not Mastered

Answer: A

Explanation:

Answer Area

Ensuring an AI system does not provide a prediction when important fields contain unusual or missing values is 

a privacy and security

an inclusiveness

a privacy and security

a reliability and safety

a transparency

 principle for responsible AI.

NEW QUESTION 7

HOTSPOT - (Topic 5)

For each of the following statements, select Yes if the statement is true. Otherwise, select No.

NOTE: Each correct selection is worth one point.

Statements	Yes	No
You train a regression model by using unlabeled data.	<input type="radio"/>	<input type="radio"/>
The classification technique is used to predict sequential numerical data over time.	<input type="radio"/>	<input type="radio"/>
Grouping items by their common characteristics is an example of clustering.	<input type="radio"/>	<input type="radio"/>

- A. Mastered
- B. Not Mastered

Answer: A

Explanation:

Statements	Yes	No
You train a regression model by using unlabeled data.	<input checked="" type="radio"/>	<input type="radio"/>
The classification technique is used to predict sequential numerical data over time.	<input type="radio"/>	<input checked="" type="radio"/>
Grouping items by their common characteristics is an example of clustering.	<input checked="" type="radio"/>	<input type="radio"/>

NEW QUESTION 8

HOTSPOT - (Topic 5)

Select the answer that correctly completes the sentence.

Answer Area

Predicting how many hours of overtime a delivery person will work based on the number of orders received is an example of 

classification.

clustering.

regression.

- A. Mastered
- B. Not Mastered

Answer: A

Explanation:

Answer Area

Predicting how many hours of overtime a delivery person will work based on the number of orders received is an example of 

classification.

clustering.

regression.

NEW QUESTION 9

HOTSPOT - (Topic 5)

For each of the following statements, select Yes if the statement is true. Otherwise, select No.

NOTE: Each correct selection is worth one point.

Statements	Yes	No
Providing an explanation of the outcome of a credit loan application is an example of the Microsoft transparency principle for responsible AI.	<input type="radio"/>	<input type="radio"/>
A triage bot that prioritizes insurance claims based on injuries is an example of the Microsoft reliability and safety principle for responsible AI.	<input type="radio"/>	<input type="radio"/>
An AI solution that is offered at different prices for different sales territories is an example of the Microsoft inclusiveness principle for responsible AI.	<input type="radio"/>	<input type="radio"/>

- A. Mastered
- B. Not Mastered

Answer: A

Explanation:

Statements	Yes	No
Providing an explanation of the outcome of a credit loan application is an example of the Microsoft transparency principle for responsible AI.	<input checked="" type="radio"/>	<input type="radio"/>
A triage bot that prioritizes insurance claims based on injuries is an example of the Microsoft reliability and safety principle for responsible AI.	<input type="radio"/>	<input checked="" type="radio"/>
An AI solution that is offered at different prices for different sales territories is an example of the Microsoft inclusiveness principle for responsible AI.	<input checked="" type="radio"/>	<input type="radio"/>

NEW QUESTION 10

- (Topic 5)

You need to develop a web-based AI solution for a customer support system. Users must be able to interact with a web app that will guide them to the best resource or answer.  
Which service should you use?

- A. Custom Vision
- B. QnA Maker
- C. Translator Text
- D. Face

Answer: B

Explanation:

QnA Maker is a cloud-based API service that lets you create a conversational question- and-answer layer over your existing data. Use it to build a knowledge base by extracting questions and answers from your semistructured content, including FAQs, manuals, and documents. Answer users' questions with the best answers from the QnAs in your knowledge base—automatically. Your knowledge base gets smarter, too, as it continually learns from user behavior.

Reference:  
<https://azure.microsoft.com/en-us/services/cognitive-services/qna-maker/>

NEW QUESTION 10

- (Topic 5)

You have the process shown in the following exhibit.

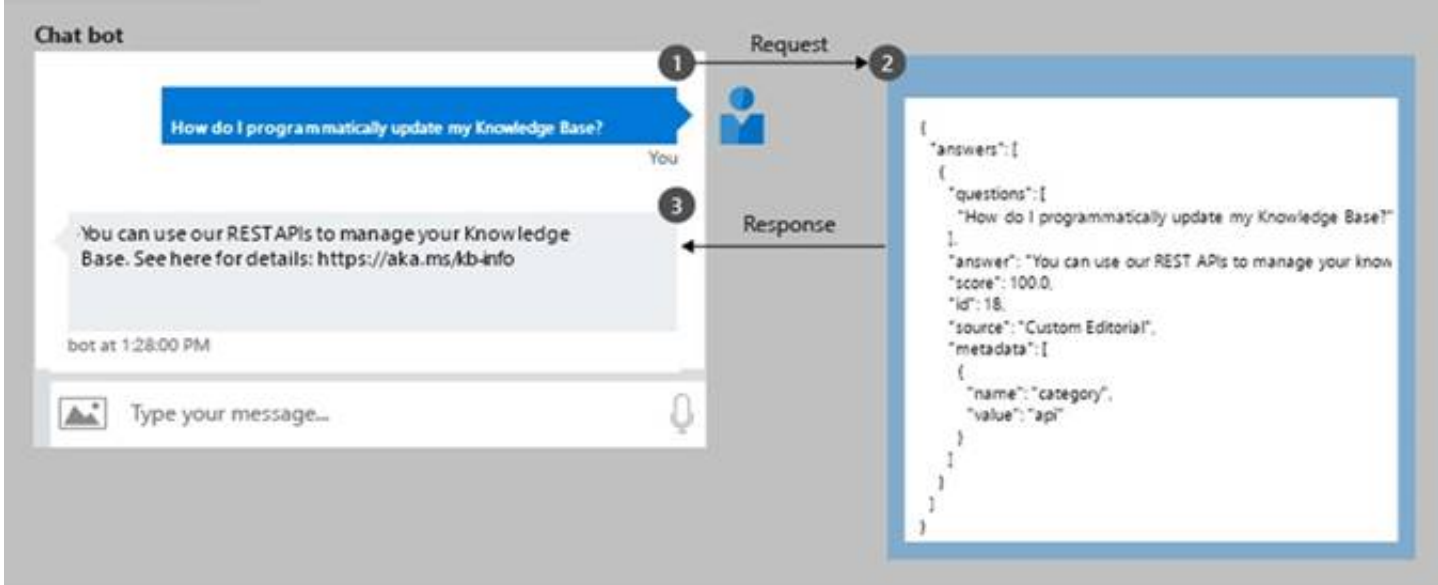

Which type AI solution is shown in the diagram?

- A. a sentiment analysis solution
- B. a chatbot
- C. a machine learning model
- D. a computer vision application



Answer: B

NEW QUESTION 14

HOTSPOT - (Topic 5)

Select the answer that correctly completes the sentence.

Answer Area

The 

Form Recognizer  
Computer Vision  
Conversational Language Understanding  
Custom Vision  
Form Recognizer

 service can be used to extract information from a driver's license to populate a database.

- A. Mastered
- B. Not Mastered

Answer: A

Explanation:

Answer Area

The 

Form Recognizer  
Computer Vision  
Conversational Language Understanding  
Custom Vision  
Form Recognizer

 service can be used to extract information from a driver's license to populate a database.

NEW QUESTION 15

HOTSPOT - (Topic 5)

Select the answer that correctly completes the sentence.

Answer Area

Creating a text transcript of a voice recording is an example of 

a computer vision workload.  
a knowledge mining workload.  
a natural language processing (NLP) workload.  
an anomaly detection workload.

- A. Mastered
- B. Not Mastered

Answer: A

Explanation:

Answer Area

Creating a text transcript of a voice recording is an example of 

a computer vision workload.  
a knowledge mining workload.  
a natural language processing (NLP) workload.  
an anomaly detection workload.

NEW QUESTION 20

HOTSPOT - (Topic 5)

Select the answer that correctly completes the sentence.

Answer Area

According to Microsoft's 

fairness  
accountability  
fairness  
inclusiveness  
transparency

 principle of responsible AI, AI systems should **NOT** reflect biases from the data sets that are used to train the systems.

- A. Mastered
- B. Not Mastered

Answer: A

Explanation:

Answer Area

According to Microsoft's

fairness

accountability

fairness

inclusiveness

transparency

principle of responsible AI,

AI systems should **NOT** reflect biases from the data sets that are used to train the systems.

NEW QUESTION 23

HOTSPOT - (Topic 5)

For each of the following statements, select Yes if the statement is True. Otherwise, select No. NOTE: Each correct selection is worth one point.

Answer Area

Statements	Yes	No
A smart device in the home that responds to questions such as "When is my next appointment?" is an example of conversational AI.	<input type="radio"/>	<input type="radio"/>
An interactive webchat feature on a company website can be implemented by using Azure Bot Service.	<input type="radio"/>	<input type="radio"/>
Automatically generating captions for pre-recorded videos is an example of conversational AI.	<input type="radio"/>	<input type="radio"/>

- A. Mastered
- B. Not Mastered

Answer: A

Explanation:

Answer Area

Statements	Yes	No
A smart device in the home that responds to questions such as "When is my next appointment?" is an example of conversational AI.	<input checked="" type="radio"/>	<input type="radio"/>
An interactive webchat feature on a company website can be implemented by using Azure Bot Service.	<input checked="" type="radio"/>	<input type="radio"/>
Automatically generating captions for pre-recorded videos is an example of conversational AI.	<input checked="" type="radio"/>	<input type="radio"/>

NEW QUESTION 26

- (Topic 5)

Which two scenarios are examples of a conversational AI workload? Each correct answer presents a complete solution. NOTE: Each correct selection is worth one point.

- A. a smart device in the home that responds to questions such as "What will the weather be like today?"
- B. a website that uses a knowledge base to interactively respond to users' questions
- C. assembly line machinery that autonomously inserts headlamps into cars
- D. monitoring the temperature of machinery to turn on a fan when the temperature reaches a specificThreshold

Answer: AB

NEW QUESTION 30

HOTSPOT - (Topic 5)

For each of the following statements, select Yes if the statement is true. Otherwise, select No. NOTE: Each correct selection is worth one point.

Statements	Yes	No
You can use QnA Maker to query an Azure SQL database.	<input type="radio"/>	<input type="radio"/>
You should use QnA Maker when you want a knowledge base to provide the same answer to different users who submit similar questions.	<input type="radio"/>	<input type="radio"/>
The QnA Maker service can determine the intent of a user utterance.	<input type="radio"/>	<input type="radio"/>

- A. Mastered
- B. Not Mastered

Answer: A

Explanation:

Statements	Yes	No
You can use QnA Maker to query an Azure SQL database.	<input type="radio"/>	<input checked="" type="radio"/>
You should use QnA Maker when you want a knowledge base to provide the same answer to different users who submit similar questions.	<input checked="" type="radio"/>	<input type="radio"/>
The QnA Maker service can determine the intent of a user utterance.	<input type="radio"/>	<input checked="" type="radio"/>

NEW QUESTION 33

HOTSPOT - (Topic 5)

For each of the following statements, select Yes if the statement is true. Otherwise, select No.

NOTE: Each correct selection is worth one point.

Statements	Yes	No
The following service call will accept English text as an input and output Italian and French text. /translate?from=it&to=fr&to=en	<input type="radio"/>	<input type="radio"/>
The following service call will accept English text as an input and output Italian and French text. /translate?from=en&to=fr&to=it	<input type="radio"/>	<input type="radio"/>
The Translator service can be used to translate documents from English to French.	<input type="radio"/>	<input type="radio"/>

- A. Mastered
- B. Not Mastered

Answer: A

Explanation:

Statements	Yes	No
The following service call will accept English text as an input and output Italian and French text. /translate?from=it&to=fr&to=en	<input checked="" type="radio"/>	<input type="radio"/>
The following service call will accept English text as an input and output Italian and French text. /translate?from=en&to=fr&to=it	<input checked="" type="radio"/>	<input type="radio"/>
The Translator service can be used to translate documents from English to French.	<input checked="" type="radio"/>	<input type="radio"/>

NEW QUESTION 34

HOTSPOT - (Topic 5)

For each of the following statements, select Yes if the statement is true. Otherwise, select No.

NOTE: Each correct selection is worth one point.

Statements	Yes	No
Providing an explanation of the outcome of a credit loan application is an example of the Microsoft transparency principle for responsible AI.	<input type="radio"/>	<input type="radio"/>
A triage bot that prioritizes insurance claims based on injuries is an example of the Microsoft reliability and safety principle for responsible AI.	<input type="radio"/>	<input type="radio"/>
An AI solution that is offered at different prices for different sales territories is an example of the Microsoft inclusiveness principle for responsible AI.	<input type="radio"/>	<input type="radio"/>

- A. Mastered
- B. Not Mastered

Answer: A

Explanation:

Statements	Yes	No
Providing an explanation of the outcome of a credit loan application is an example of the Microsoft transparency principle for responsible AI.	<input checked="" type="radio"/>	<input type="radio"/>
A triage bot that prioritizes insurance claims based on injuries is an example of the Microsoft reliability and safety principle for responsible AI.	<input type="radio"/>	<input checked="" type="radio"/>
An AI solution that is offered at different prices for different sales territories is an example of the Microsoft inclusiveness principle for responsible AI.	<input checked="" type="radio"/>	<input type="radio"/>



NEW QUESTION 38

HOTSPOT - (Topic 5)

Select the answer that correctly completes the sentence.

Answer Area

Detecting unusual temperature fluctuations for a large machine is an example of

an anomaly detection workload.

a computer vision workload.

a knowledge mining workload.

a natural language processing (NLP) workload.

an anomaly detection workload.

- A. Mastered
- B. Not Mastered

Answer: A

Explanation:

Answer Area

Detecting unusual temperature fluctuations for a large machine is an example of

an anomaly detection workload.

a computer vision workload.

a knowledge mining workload.

a natural language processing (NLP) workload.

an anomaly detection workload.

NEW QUESTION 42

- (Topic 5)

Which type of natural language processing (NLP) entity is used to identify a phone number?

- A. regular expression
- B. machine-learned
- C. list
- D. Pattern-any

Answer: C

NEW QUESTION 46

- (Topic 5)

You have an AI-based loan approval system.

During testing, you discover that the system has a gender bias. Which responsible AI principle does this violate?

- A. accountability
- B. transparency
- C. fairness
- D. reliability and safety

Answer: C

NEW QUESTION 48

HOTSPOT - (Topic 5)

To complete the sentence, select the appropriate option in the answer area.

Answer Area

An AI solution that helps photographers take better portrait photographs by providing feedback on exposure, noise, and occlusion is an example of facial

detection.

analysis.

detection.

recognition.

- A. Mastered
- B. Not Mastered

Answer: A

Explanation:

Answer Area

An AI solution that helps photographers take better portrait photographs by providing feedback on exposure, noise, and occlusion is an example of facial

detection.  
analysis.  
detection.  
recognition.

NEW QUESTION 50

HOTSPOT - (Topic 5)

Select the answer that correctly completes the sentence.

Answer Area

Regression  
Classification  
Clustering  
Regression

models can be used to predict the sale price of auctioned items.

- A. Mastered
- B. Not Mastered

Answer: A

Explanation:

Answer Area

Regression  
Classification  
Clustering  
Regression

models can be used to predict the sale price of auctioned items.

NEW QUESTION 55

- (Topic 5)

You need to implement a pre-built solution that will identify well-known brands in digital photographs. Which Azure AI sen/tee should you use?

- A. Face
- B. Custom Vision
- C. Computer Vision
- D. Form Recognizer

Answer: C

NEW QUESTION 59

- (Topic 5)

You need to reduce the load on telephone operators by implementing a Chabot to answer simple questions with predefined answers.

Which two AI services should you use to achieve the goal? Each correct answer presents part of the solution.

NOTE: Each correct selection is worth one point.

- A. Azure 8oI Service
- B. Azure Machine Learning
- C. Translator
- D. Language Service

Answer: AD

NEW QUESTION 64

- (Topic 5)

Which Azure Cognitive Services service can be used to identify documents that contain sensitive information?

- A. Custom Vision
- B. Conversational Language Understanding
- C. Form Recognizer

Answer: C

NEW QUESTION 65

HOTSPOT - (Topic 5)  
Select the answer that correctly completes the sentence.

Answer Area

Natural language processing can be used to

classify email messages as work-related or personal.

predict the number of future car rentals.

predict which website visitors will make a transaction.

stop a process in a factory when extremely high temperatures are registered.

- A. Mastered
- B. Not Mastered

Answer: A

Explanation:

Answer Area

Natural language processing can be used to

classify email messages as work-related or personal.

predict the number of future car rentals.

predict which website visitors will make a transaction.

stop a process in a factory when extremely high temperatures are registered.

NEW QUESTION 69

- (Topic 5)  
You use Azure Machine Learning designer to build a model pipeline. What should you create before you can run the pipeline?

- A. a Jupyter notebook
- B. a registered model
- C. a compute resource

Answer: C

NEW QUESTION 70

- (Topic 5)  
You have a natural language processing (NLP) model that was created by using data obtained without permission. Which Microsoft principle for responsible AI does this breach?

- A. privacy and security
- B. inclusiveness
- C. transparency
- D. reliability and safety

Answer: C

NEW QUESTION 73

- (Topic 5)  
You need to track multiple versions of a model that was trained by using Azure Machine Learning. What should you do?

- A. Provision an inference cluster.
- B. Explain the model.
- C. Register the model.
- D. Register the training data.

Answer: C

NEW QUESTION 74

HOTSPOT - (Topic 5)  
For each of the following statements, select Yes if the statement is true. Otherwise, select No.  
NOTE: Each correct selection is worth one point.

Answer Area

Statements	Yes	No
Chatbots can only be built by using custom code.	<input type="radio"/>	<input type="radio"/>
The Azure Bot Service provides services that can be used to host conversational bots.	<input type="radio"/>	<input type="radio"/>
Bots built by using the Azure Bot Service can communicate with Microsoft Teams users.	<input type="radio"/>	<input type="radio"/>

- A. Mastered
- B. Not Mastered

Answer: A

Explanation:

Answer Area

Statements	Yes	No
Chatbots can only be built by using custom code.	<input type="radio"/>	<input checked="" type="radio"/>
The Azure Bot Service provides services that can be used to host conversational bots.	<input checked="" type="radio"/>	<input type="radio"/>
Bots built by using the Azure Bot Service can communicate with Microsoft Teams users.	<input checked="" type="radio"/>	<input type="radio"/>

NEW QUESTION 76

HOTSPOT - (Topic 5)

For each of the following statements, select Yes If the statement is true. Otherwise, select No.

NOTE: Each correct selection is worth one point.

Answer Area

Statements	Yes	No
Object detection can identify the location of a damaged product in an image.	<input type="radio"/>	<input type="radio"/>
Object detection can identify multiple instances of a damaged product in an image.	<input type="radio"/>	<input type="radio"/>
Object detection can identify multiple types of damaged products in an image.	<input type="radio"/>	<input type="radio"/>

- A. Mastered
- B. Not Mastered

Answer: A

Explanation:

Answer Area

Statements	Yes	No
Object detection can identify the location of a damaged product in an image.	<input checked="" type="radio"/>	<input type="radio"/>
Object detection can identify multiple instances of a damaged product in an image.	<input type="radio"/>	<input checked="" type="radio"/>
Object detection can identify multiple types of damaged products in an image.	<input checked="" type="radio"/>	<input type="radio"/>

NEW QUESTION 77

HOTSPOT - (Topic 5)

correctly completes the sentence.

Answer Area

In a machine learning model, the data that is used as inputs are called

features.

functions.

labels.

instances.

- A. Mastered
- B. Not Mastered

Answer: A

Explanation:

Answer Area

In a machine learning model, the data that is used as inputs are called

features.

functions.

labels.

instances.

NEW QUESTION 82

HOTSPOT - (Topic 5)

For each of the following statements, select Yes if the statement is true. Otherwise, select No.

NOTE: Each correct selection is worth one point.



Statements	Yes	No
You can use the Translator service to translate text between languages.	<input type="radio"/>	<input type="radio"/>
You can use the Translator service to detect the language of a given text.	<input type="radio"/>	<input type="radio"/>
You can use the Translator service to transcribe audible speech into text.	<input type="radio"/>	<input type="radio"/>

- A. Mastered
- B. Not Mastered

Answer: A

Explanation:

Statements	Yes	No
You can use the Translator service to translate text between languages.	<input checked="" type="radio"/>	<input type="radio"/>
You can use the Translator service to detect the language of a given text.	<input checked="" type="radio"/>	<input type="radio"/>
You can use the Translator service to transcribe audible speech into text.	<input checked="" type="radio"/>	<input type="radio"/>

NEW QUESTION 87

HOTSPOT - (Topic 5)

Select the answer that correctly completes the sentence.

Answer Area

A historian can use 

optical character recognition (OCR)

facial analysis

image classification

object detection

optical character recognition (OCR)

 to digitize newspaper articles.

- A. Mastered
- B. Not Mastered

Answer: A

Explanation:

Answer Area

A historian can use 

optical character recognition (OCR)

facial analysis

image classification

object detection

optical character recognition (OCR)

 to digitize newspaper articles.

NEW QUESTION 91

- (Topic 5)

Which two scenarios are examples of a conversational AI workload? Each correct answer presents a complete solution.

NOTE: Each correct selection is worth one point.

- A. a telephone answering service that has a pre-recorder message
- B. a chatbot that provides users with the ability to find answers on a website by themselves
- C. telephone voice menus to reduce the load on human resources
- D. a service that creates frequently asked questions (FAQ) documents by crawling public websites

**Answer:** BC

**Explanation:**

B: A bot is an automated software program designed to perform a particular task. Think of it as a robot without a body.

C: Automated customer interaction is essential to a business of any size. In fact, 61% of consumers prefer to communicate via speech, and most of them prefer self-service. Because customer satisfaction is a priority for all businesses, self-service is a critical facet of any customer-facing communications strategy.

Reference:

<https://docs.microsoft.com/en-us/azure/architecture/data-guide/big-data/ai-overview>

<https://docs.microsoft.com/en-us/azure/architecture/solution-ideas/articles/interactive-voice-response-bot>

**NEW QUESTION 92**

HOTSPOT - (Topic 5)

To complete the sentence, select the appropriate option in the answer area.

The interactive answering of questions entered by a user as part of an application is an example of

<input type="text"/>
anomaly detection.
computer vision.
conversational AI.
forecasting.

- A. Mastered
- B. Not Mastered

**Answer:** A

**Explanation:**

With Microsoft's Conversational AI tools developers can build, connect, deploy, and manage intelligent bots that naturally interact with their users on a website, app, Cortana, Microsoft Teams, Skype, Facebook Messenger, Slack, and more.

**NEW QUESTION 96**

HOTSPOT - (Topic 5)

Select the answer that correctly completes the sentence.

Azure Machine Learning designer lets you create machine learning models by

<input type="text"/>
adding and connecting modules on a visual canvas.
adding and connecting modules on a visual canvas.
automatically performing common data preparation tasks.
automatically selecting an algorithm to build the most accurate model.
using a code-first notebook experience.

- A. Mastered
- B. Not Mastered

**Answer:** A

**Explanation:**

Azure Machine Learning designer lets you create machine learning models by

<input type="text"/>
adding and connecting modules on a visual canvas.
adding and connecting modules on a visual canvas.
automatically performing common data preparation tasks.
automatically selecting an algorithm to build the most accurate model.
using a code-first notebook experience.

**NEW QUESTION 99**

- (Topic 5)

Which statement is an example of a Microsoft responsible AI principle?

- A. AI systems must use only publicly available data.
- B. AI systems must protect the interests of the company
- C. AI systems must be understandable.
- D. AI systems must keep personal details public

**Answer:** C

**NEW QUESTION 101**

HOTSPOT - (Topic 5)

To complete the sentence, select the appropriate option in the answer area.

Answer Area

Returning a bounding box that indicates the location of a vehicle in an image is an example of

image classification.

object detection.

optical character recognition (OCR).

facial detection.

- A. Mastered  
B. Not Mastered

Answer: A

Explanation:

Answer Area

Returning a bounding box that indicates the location of a vehicle in an image is an example of

image classification.

object detection.

optical character recognition (OCR).

facial detection.

NEW QUESTION 103

- (Topic 5)  
You need to develop a chatbot for a website. The chatbot must answer users questions based on the information m the following documents

- A product troubleshooting guide m a Microsoft Word document
- A frequently asked questions (FAQ) list on a webpage Which service should you use to process the documents?

- A. Language Undemanding  
B. Text Analytics  
C. Azure Bot Service  
D. QnA Maker

Answer: D

NEW QUESTION 105

- (Topic 5)  
You have a bot that identifies the brand names of products in images of supermarket shelves.  
Which service does the bot use?

- A. AI enrichment for Azure Search capabilities  
B. Computer Vision Image Analysis capabilities  
C. Custom Vision Image Classification capabilities  
D. Language understanding capabilities

Answer: B

NEW QUESTION 109

- (Topic 5)  
You are building a knowledge base by using QnA Maker. Which file format can you use to populate the knowledge base?

- A. PDF  
B. PPTX  
C. XML  
D. ZIP

Answer: A

Explanation:

Reference:  
<https://docs.microsoft.com/en-us/azure/cognitive-services/qnamaker/concepts/data-sources-and-content>

NEW QUESTION 114

HOTSPOT - (Topic 5)  
For each of the following statements, select Yes if the statement is true. Otherwise, select No.  
NOTE: Each correct selection is worth one point.

Statements	Yes	No
Azure Bot Service and Azure Cognitive Services can be integrated.	<input type="radio"/>	<input type="radio"/>
Azure Bot Service engages with customers in a conversational manner.	<input type="radio"/>	<input type="radio"/>
Azure Bot Service can import frequently asked questions (FAQ) to question and answer sets.	<input type="radio"/>	<input type="radio"/>

- A. Mastered
- B. Not Mastered

Answer: A

Explanation:

Box 1: Yes  
Azure bot service can be integrated with the powerful AI capabilities with Azure Cognitive Services.  
Box 2: Yes  
Azure bot service engages with customers in a conversational manner.  
Box 3: No  
The QnA Maker service creates knowledge base, not question and answers sets.  
Note: You can use the QnA Maker service and a knowledge base to add question-and- answer support to your bot. When you create your knowledge base, you seed it with questions and answers.

NEW QUESTION 115

HOTSPOT - (Topic 5)  
HOTSPOT  
For each of the following statements, select Yes if the statement is true. Otherwise, select No.  
NOTE: Each correct selection is worth one point.

Statements	Yes	No
You can communicate with a bot by using email.	<input type="radio"/>	<input type="radio"/>
You can communicate with a bot by using Microsoft Teams.	<input type="radio"/>	<input type="radio"/>
You can communicate with a bot by using a webchat interface.	<input type="radio"/>	<input type="radio"/>

- A. Mastered
- B. Not Mastered

Answer: A

Explanation:

Statements	Yes	No
You can communicate with a bot by using email.	<input checked="" type="radio"/>	<input type="radio"/>
You can communicate with a bot by using Microsoft Teams.	<input checked="" type="radio"/>	<input type="radio"/>
You can communicate with a bot by using a webchat interface.	<input checked="" type="radio"/>	<input type="radio"/>

NEW QUESTION 119

- (Topic 5)  
You have a webchat bot that provides responses from a QnA Maker knowledge base.  
You need to ensure that the bot uses user feedback to improve the relevance of the responses over time.  
What should you use?

- A. key phrase extraction
- B. sentiment analysis
- C. business logic
- D. active learning

Answer: D

Explanation:

Reference:  
<https://docs.microsoft.com/en-us/azure/cognitive-services/qnamaker/how-to/improve-knowledge-base>

NEW QUESTION 122

HOTSPOT - (Topic 5)  
For each of the following statements, select Yes if the statement is true. Otherwise, select No. NOTE: Each correct selection is worth one point.



Statements	Yes	No
A bot that responds to queries by internal users is an example of a natural language processing workload.	<input type="radio"/>	<input type="radio"/>
A mobile application that displays images relating to an entered search term is an example of a natural language processing workload.	<input type="radio"/>	<input type="radio"/>
A web form used to submit a request to reset a password is an example of a natural language processing workload.	<input type="radio"/>	<input type="radio"/>

- A. Mastered
- B. Not Mastered

Answer: A

Explanation:

Statements	Yes	No
A bot that responds to queries by internal users is an example of a natural language processing workload.	<input checked="" type="radio"/>	<input type="radio"/>
A mobile application that displays images relating to an entered search term is an example of a natural language processing workload.	<input checked="" type="radio"/>	<input type="radio"/>
A web form used to submit a request to reset a password is an example of a natural language processing workload.	<input type="radio"/>	<input checked="" type="radio"/>

NEW QUESTION 123

HOTSPOT - (Topic 5)

To complete the sentence, select the appropriate option in the answer area.

Answer Area	
Data values that used to make a prediction are called	<div>features. dependant variables. features. identifiers. labels.</div>

- A. Mastered
- B. Not Mastered

Answer: A

Explanation:

Answer Area	
Data values that used to make a prediction are called	<div>features. dependant variables. features. identifiers. labels.</div>

NEW QUESTION 124

- (Topic 4)

In which scenario should you use key phrase extraction?

- A. translating a set of documents from English to German
- B. generating captions for a video based on the audio track
- C. identifying whether reviews of a restaurant are positive or negative
- D. identifying which documents provide information about the same topics

Answer: D

NEW QUESTION 127

- (Topic 4)

In which two scenarios can you use speech recognition? Each correct answer presents a complete solution.

NOTE: Each correct selection is worth one point.

- A. an in-car system that reads text messages aloud
- B. providing closed captions for recorded or live videos
- C. creating an automated public address system for a train station
- D. creating a transcript of a telephone call or meeting

Answer: BD

Explanation:

Reference:

<https://azure.microsoft.com/en-gb/services/cognitive-services/speech-to-text/#features>

NEW QUESTION 130

- (Topic 4)  
Which AI service can you use to interpret the meaning of a user input such as “Call me back later?”

- A. Translator Text
- B. Text Analytics
- C. Speech
- D. Language Understanding (LUIS)

Answer: D

Explanation:  
<https://docs.microsoft.com/en-us/azure/cognitive-services/luis/what-is-luis>

NEW QUESTION 133

HOTSPOT - (Topic 4)  
For each of the following statements, select Yes if the statement is true. Otherwise, select No.  
NOTE: Each correct selection is worth one point.

Statements	Yes	No
You can use the Translator service to translate text between languages.	<input type="radio"/>	<input type="radio"/>
You can use the Translator service to detect the language of a given text.	<input type="radio"/>	<input type="radio"/>
You can use the Translator service to transcribe audible speech into text.	<input type="radio"/>	<input type="radio"/>

- A. Mastered
- B. Not Mastered

Answer: A

Explanation:  
The translator service provides multi-language support for text translation, transliteration, language detection, and dictionaries. Speech-to-Text, also known as automatic speech recognition (ASR), is a feature of Speech Services that provides transcription.

NEW QUESTION 135

HOTSPOT - (Topic 4)  
For each of the following statements, select Yes if the statement is true. Otherwise, select No.  
NOTE: Each correct selection is worth one point.

Answer Area

Statements	Yes	No
The Text Analytics service can identify in which language text is written.	<input type="radio"/>	<input type="radio"/>
The Text Analytics service can detect handwritten signatures in a document.	<input type="radio"/>	<input type="radio"/>
The Text Analytics service can identify companies and organizations mentioned in a document.	<input type="radio"/>	<input type="radio"/>

- A. Mastered
- B. Not Mastered

Answer: A

Explanation:  
The Text Analytics API is a cloud-based service that provides advanced natural language processing over raw text, and includes four main functions: sentiment analysis, key phrase extraction, named entity recognition, and language detection.  
Box 1: Yes  
You can detect which language the input text is written in and report a single language code for every document submitted on the request in a wide range of languages, variants, dialects, and some regional/cultural languages. The language code is paired with a score indicating the strength of the score.  
Box 2: No  
Box 3: Yes  
Named Entity Recognition: Identify and categorize entities in your text as people, places, organizations, date/time, quantities, percentages, currencies, and more.

Well-known entities are also recognized and linked to more information on the web.

#### NEW QUESTION 136

DRAG DROP - (Topic 4)

You plan to apply Text Analytics API features to a technical support ticketing system.

Match the Text Analytics API features to the appropriate natural language processing scenarios.

To answer, drag the appropriate feature from the column on the left to its scenario on the right. Each feature may be used once, more than once, or not at all.

NOTE: Each correct selection is worth one point.

API Features	Answer Area
Entity recognition	API Feature Understand how upset a customer is based on the text contained in the support ticket.
Key phrase extraction	API Feature Summarize important information from the support ticket.
Language detection	API Feature Extract key dates from the support ticket.
Sentiment analysis	

- A. Mastered
- B. Not Mastered

**Answer:** A

#### Explanation:

Box1: Sentiment analysis

Sentiment Analysis is the process of determining whether a piece of writing is positive, negative or neutral.

Box 2: Broad entity extraction

Broad entity extraction: Identify important concepts in text, including key

Key phrase extraction/ Broad entity extraction: Identify important concepts in text, including key phrases and named entities such as people, places, and organizations.

Box 3: Entity Recognition

Named Entity Recognition: Identify and categorize entities in your text as people, places, organizations, date/time, quantities, percentages, currencies, and more.

Well-known entities are also recognized and linked to more information on the web.

#### NEW QUESTION 137

- (Topic 4)

You need to develop a chatbot for a website. The chatbot must answer users' questions based on the information in the following documents:

? A product troubleshooting guide in a Microsoft Word document

? A frequently asked questions (FAQ) list on a webpage

Which service should you use to process the documents?

- A. Azure Bot Service
- B. Language Understanding
- C. Text Analytics
- D. QnA Maker

**Answer:** D

#### Explanation:

Reference:

<https://docs.microsoft.com/en-us/azure/cognitive-services/QnAMaker/Overview/overview>

#### NEW QUESTION 142

- (Topic 4)

You are building a Language Understanding model for an e-commerce business.

You need to ensure that the model detects when utterances are outside the intended scope of the model.

What should you do?

- A. Test the model by using new utterances
- B. Add utterances to the None intent
- C. Create a prebuilt task entity
- D. Create a new model

**Answer:** B

#### Explanation:

The None intent is filled with utterances that are outside of your domain. Reference:

<https://docs.microsoft.com/en-us/azure/cognitive-services/LUIS/luis-concept-intent>

#### NEW QUESTION 143

- (Topic 4)

You are developing a Chabot solution in Azure.

Which service should you use to determine a user's intent?

- A. Translator
- B. Azure Cognitive Search
- C. Speech
- D. Language

**Answer:** B

**Explanation:**

Language Understanding (LUIS) is a cloud-based API service that applies custom machine-learning intelligence to a user's conversational, natural language text to predict overall meaning, and pull out relevant, detailed information.

Design your LUIS model with categories of user intentions called intents. Each intent needs examples of user utterances. Each utterance can provide data that needs to be extracted with machine-learning entities.

Reference:

<https://docs.microsoft.com/en-us/azure/cognitive-services/luis/what-is-luis>

**NEW QUESTION 145**

- (Topic 4)

You build a QnA Maker bot by using a frequently asked questions (FAQ) page.

You need to add professional greetings and other responses to make the bot more user friendly.

What should you do?

- A. Increase the confidence threshold of responses
- B. Enable active learning
- C. Create multi-turn questions
- D. Add chit-chat

**Answer:** D

**Explanation:**

Reference:

<https://docs.microsoft.com/en-us/azure/cognitive-services/qnamaker/how-to/chit-chat-knowledge-base?tabs=v1>

**NEW QUESTION 146**

- (Topic 4)

In which two scenarios can you use a speech synthesis solution? Each correct answer presents a complete solution.

NOTE: Each correct selection is worth one point.

- A. an automated voice that reads back a credit card number entered into a telephone by using a numeric keypad
- B. generating live captions for a news broadcast
- C. extracting key phrases from the audio recording of a meeting
- D. an AI character in a computer game that speaks audibly to a player

**Answer:** AD

**Explanation:**

Azure Text to Speech is a Speech service feature that converts text to lifelike speech.

Reference:

<https://azure.microsoft.com/en-in/services/cognitive-services/text-to-speech/>

**NEW QUESTION 147**

- (Topic 3)

You need to determine the location of cars in an image so that you can estimate the distance between the cars.

Which type of computer vision should you use?

- A. optical character recognition (OCR)
- B. object detection
- C. image classification
- D. face detection

**Answer:** B

**Explanation:**

Object detection is similar to tagging, but the API returns the bounding box coordinates (in pixels) for each object found. For example, if an image contains a dog, cat and person, the Detect operation will list those objects together with their coordinates in the image. You can use this functionality to process the relationships between the objects in an image. It also lets you determine whether there are multiple instances of the same tag in an image.

The Detect API applies tags based on the objects or living things identified in the image.

There is currently no formal relationship between the tagging taxonomy and the object detection taxonomy. At a conceptual level, the Detect API only finds objects and living things, while the Tag API can also include contextual terms like "indoor", which can't be localized with bounding boxes.

Reference:

<https://docs.microsoft.com/en-us/azure/cognitive-services/computer-vision/concept-object-detection>

**NEW QUESTION 148**

HOTSPOT - (Topic 3)

For each of the following statements, select Yes if the statement is true. Otherwise, select No.

NOTE: Each correct selection is worth one point.



Answer Area

Statements	Yes	No
When creating an object detection model in the Custom Vision service, you must choose a classification type of either <b>Multilabel</b> or <b>Multiclass</b> .	<input type="radio"/>	<input type="radio"/>
You can create an object detection model in the Custom Vision service to find the location of content within an image.	<input type="radio"/>	<input type="radio"/>
When creating an object detection model in the Custom Vision service, you can select from a set of predefined domains.	<input type="radio"/>	<input type="radio"/>

- A. Mastered
- B. Not Mastered

Answer: A

Explanation:

Answer Area

Statements	Yes	No
When creating an object detection model in the Custom Vision service, you must choose a classification type of either <b>Multilabel</b> or <b>Multiclass</b> .	<input type="radio"/>	<input checked="" type="radio"/>
You can create an object detection model in the Custom Vision service to find the location of content within an image.	<input checked="" type="radio"/>	<input type="radio"/>
When creating an object detection model in the Custom Vision service, you can select from a set of predefined domains.	<input checked="" type="radio"/>	<input type="radio"/>

NEW QUESTION 153

- (Topic 3)

What are two tasks that can be performed by using the Computer Vision service? Each correct answer presents a complete solution.

NOTE: Each correct selection is worth one point.

- A. Train a custom image classification model.
- B. Detect faces in an image.
- C. Recognize handwritten text.
- D. Translate the text in an image between languages.

Answer: BC

Explanation:

B: Azure's Computer Vision service provides developers with access to advanced algorithms that process images and return information based on the visual features you're interested in. For example, Computer Vision can determine whether an image contains adult content, find specific brands or objects, or find human faces.

C: Computer Vision includes Optical Character Recognition (OCR) capabilities. You can use the new Read API to extract printed and handwritten text from images and documents.

Reference:

<https://docs.microsoft.com/en-us/azure/cognitive-services/computer-vision/home>

Detect faces in an image - Face API

Microsoft Azure provides multiple cognitive services that you can use to detect and analyze faces, including:

Computer Vision, which offers face detection and some basic face analysis, such as determining age.

Video Indexer, which you can use to detect and identify faces in a video.

Face, which offers pre-built algorithms that can detect, recognize, and analyze faces. Recognize hand written text - Read API

The Read API is a better option for scanned documents that have a lot of text. The Read API also has the ability to automatically determine the proper recognition model

NEW QUESTION 155

- (Topic 2)

You are building a tool that will process images from retail stores and identify the products of competitors.

The solution will use a custom model.

Which Azure Cognitive Services service should you use?

- A. Custom Vision

- B. Form Recognizer
- C. Face
- D. Computer Vision

Answer: A

Explanation:

Reference:  
<https://docs.microsoft.com/en-us/azure/cognitive-services/custom-vision-service/overview>

NEW QUESTION 159

- (Topic 2)  
Which type of machine learning should you use to predict the number of gift cards that will be sold next month?

- A. classification
- B. regression
- C. clustering

Answer: B

NEW QUESTION 160

HOTSPOT - (Topic 3)  
To complete the sentence, select the appropriate option in the answer area.

Answer Area

You can use the 

Computer Vision

Custom Vision

Form Recognizer

Video Indexer

 service to train an object detection model by using your own images.

- A. Mastered
- B. Not Mastered

Answer: A

Explanation:

Azure Custom Vision is a cognitive service that lets you build, deploy, and improve your own image classifiers. An image classifier is an AI service that applies labels (which represent classes) to images, according to their visual characteristics. Unlike the Computer Vision service, Custom Vision allows you to specify the labels to apply.  
Note: The Custom Vision service uses a machine learning algorithm to apply labels to images. You, the developer, must submit groups of images that feature and lack the characteristics in question. You label the images yourself at the time of submission. Then the algorithm trains to this data and calculates its own accuracy by testing itself on those same images. Once the algorithm is trained, you can test, retrain, and eventually use it to classify new images according to the needs of your app. You can also export the model itself for offline use.

NEW QUESTION 162

HOTSPOT - (Topic 3)  
You have a database that contains a list of employees and their photos. You are tagging new photos of the employees. For each of the following statements select Yes if the statement is true. Otherwise, select No.  
NOTE: Each correct selection is worth one point.

Answer Area

Statements	Yes	No
The Face service can be used to group all the employees who have similar facial characteristics.	<input type="radio"/>	<input type="radio"/>
The Face service will be more accurate if you provide more sample photos of each employee from different angles.	<input type="radio"/>	<input type="radio"/>
If an employee is wearing sunglasses, the Face service will always fail to recognize the employee.	<input type="radio"/>	<input type="radio"/>

- A. Mastered
- B. Not Mastered

Answer: A

Explanation:

Answer Area

Statements	Yes	No
The Face service can be used to group all the employees who have similar facial characteristics.	<input checked="" type="radio"/>	<input type="radio"/>
The Face service will be more accurate if you provide more sample photos of each employee from different angles.	<input checked="" type="radio"/>	<input type="radio"/>
If an employee is wearing sunglasses, the Face service will always fail to recognize the employee.	<input type="radio"/>	<input checked="" type="radio"/>

NEW QUESTION 167

DRAG DROP - (Topic 3)

Match the types of computer vision to the appropriate scenarios.

To answer, drag the appropriate workload type from the column on the left to its scenario on the right. Each workload type may be used once, more than once, or not at all.

NOTE: Each correct selection is worth one point.

Workloads Types	Answer Area
Facial recognition	Workload Type Identify celebrities in images.
Image classification	Workload Type Extract movie title names from movie poster images.
Object detection	Workload Type Locate vehicles in images.
Optical character recognition (OCR)	

- A. Mastered
- B. Not Mastered

Answer: A

Explanation:

Box 1: Facial recognition

Face detection that perceives faces and attributes in an image; person identification that matches an individual in your private repository of up to 1 million people; perceived emotion recognition that detects a range of facial expressions like happiness, contempt, neutrality, and fear; and recognition and grouping of similar faces in images.

Box 2: OCR

Box 3: Objection detection

Object detection is similar to tagging, but the API returns the bounding box coordinates (in pixels) for each object found. For example, if an image contains a dog, cat and person, the Detect operation will list those objects together with their coordinates in the image. You can use this functionality to process the relationships between the objects in an image. It also lets you determine whether there are multiple instances of the same tag in an image.

The Detect API applies tags based on the objects or living things identified in the image. There is currently no formal relationship between the tagging taxonomy and the object detection taxonomy. At a conceptual level, the Detect API only finds objects and living things, while the Tag API can also include contextual terms like "indoor", which can't be localized with bounding boxes.

NEW QUESTION 172

- (Topic 3)

What are two tasks that can be performed by using computer vision? Each correct answer presents a complete solution.

NOTE: Each correct selection is worth one point.

- A. Predict stock prices.
- B. Detect brands in an image.
- C. Detect the color scheme in an image
- D. Translate text between languages.
- E. Extract key phrases.

Answer: BC

NEW QUESTION 177

DRAG DROP - (Topic 3)

Match the types of machine learning to the appropriate scenarios.

To answer, drag the appropriate machine learning type from the column on the left to its scenario on the right. Each machine learning type may be used once, more than once, or not at all.

NOTE: Each correct selection is worth one point.



Machine Learning Types	Answer Area
Facial detection	Machine Learning Type Separate images of polar bears and brown bears.
Facial recognition	Machine Learning Type Determine the location of a bear in a photo.
Image classification	Machine Learning Type Determine which pixels in an image are part of a bear.
Object detection	
Optical character recognition (OCR)	
Semantic segmentation	

- A. Mastered  
 B. Not Mastered

**Answer:** A

**Explanation:**

Box 1: Image classification

Image classification is a supervised learning problem: define a set of target classes (objects to identify in images), and train a model to recognize them using labeled example photos.

Box 2: Object detection

Object detection is a computer vision problem. While closely related to image classification, object detection performs image classification at a more granular scale. Object detection both locates and categorizes entities within images.

Box 3: Semantic Segmentation

Semantic segmentation achieves fine-grained inference by making dense predictions inferring labels for every pixel, so that each pixel is labeled with the class of its enclosing object ore region.

**NEW QUESTION 178**

- (Topic 2)

What are two metrics that you can use to evaluate a regression model? Each correct answer presents a complete solution.

NOTE: Each correct selection is worth one point.

- A. coefficient of determination (R2)  
 B. F1 score  
 C. root mean squared error (RMSE)  
 D. area under curve (AUC)  
 E. balanced accuracy

**Answer:** AC

**Explanation:**

A: R-squared (R2), or Coefficient of determination represents the predictive power of the model as a value between -inf and 1.00. 1.00 means there is a perfect fit, and the fit can be arbitrarily poor so the scores can be negative.

C: RMS-loss or Root Mean Squared Error (RMSE) (also called Root Mean Square Deviation, RMSD), measures the difference between values predicted by a model and the values observed from the environment that is being modeled.

Reference:

<https://docs.microsoft.com/en-us/dotnet/machine-learning/resources/metrics>

**NEW QUESTION 181**

HOTSPOT - (Topic 2)

To complete the sentence, select the appropriate option in the answer area.

**Answer Area**

Azure Machine Learning designer lets you create machine learning models by

adding and connecting modules on a visual canvas.  
 automatically performing common data preparation tasks.  
 automatically selecting an algorithm to build the most accurate model.  
 using a code-first notebook experience.

- A. Mastered  
 B. Not Mastered

**Answer:** A

**Explanation:**



## Answer Area

Azure Machine Learning designer lets you create machine learning models by

adding and connecting modules on a visual canvas.  
 automatically performing common data preparation tasks.  
 automatically selecting an algorithm to build the most accurate model.  
 using a code-first notebook experience.

### NEW QUESTION 182

HOTSPOT - (Topic 2)

To complete the sentence, select the appropriate option in the answer area.

## Answer Area

Predicting how many hours of overtime a delivery person will work based on the number of order received is an example of

classification.  
 clustering.  
 regression.

- A. Mastered
- B. Not Mastered

Answer: A

### Explanation:

In the most basic sense, regression refers to prediction of a numeric target. Linear regression attempts to establish a linear relationship between one or more independent variables and a numeric outcome, or dependent variable.

You use this module to define a linear regression method, and then train a model using a labeled dataset. The trained model can then be used to make predictions.

### NEW QUESTION 184

HOTSPOT - (Topic 2)

To complete the sentence, select the appropriate option in the answer area.

Classification models can be used to predict the sale price of auctioned items.

- A. Mastered
- B. Not Mastered

Answer: A

### Explanation:

Regression is a machine learning task that is used to predict the value of the label from a set of related features.

### NEW QUESTION 186

- (Topic 2)

You need to predict the income range of a given customer by using the following dataset.

First Name	Last Name	Age	Education Level	Income Range
Orlando	Gee	45	University	25,000-50,000
Keith	Harris	36	High school	25,000-50,000
Donna	Carreras	52	University	50,000-75,000
Janet	Gates	21	University	75,000-100,000
Lucy	Harrington	68	High school	50,000-75,000

Which two fields should you use as features? Each correct answer presents a complete solution.

NOTE: Each correct selection is worth one point.

- A. Education Level
- B. Last Name
- C. Age
- D. Income Range
- E. First Name

Answer: AC

Explanation:

First Name, Last Name, Age and Education Level are features. Income range is a label (what you want to predict). First Name and Last Name are irrelevant in that they have no bearing on income. Age and Education level are the features you should use.

NEW QUESTION 188

HOTSPOT - (Topic 2)

To complete the sentence, select the appropriate option in the answer area.

Assigning classes to images before training a classification model is an example of

	▼
evaluation.	
feature engineering	
hyperparameter tuning.	
labeling.	

- A. Mastered
- B. Not Mastered

Answer: A

Explanation:

Assigning classes to images before training a classification model is an example of

	▼
evaluation.	
feature engineering	
hyperparameter tuning.	
labeling.	

NEW QUESTION 189

- (Topic 2)

Which service should you use to extract text, key/value pairs, and table data automatically from scanned documents?

- A. Form Recognizer
- B. Text Analytics
- C. Ink Recognizer
- D. Custom Vision

Answer: A

Explanation:

Accelerate your business processes by automating information extraction. Form Recognizer applies advanced machine learning to accurately extract text, key/value pairs, and tables from documents. With just a few samples, Form Recognizer tailors its understanding to your documents, both on-premises and in the cloud. Turn forms into usable data at a fraction of the time and cost, so you can focus more time acting on the information rather than compiling it.

Reference:

<https://azure.microsoft.com/en-us/services/cognitive-services/form-recognizer/>

NEW QUESTION 192

HOTSPOT - (Topic 2)

HOTSPOT

For each of the following statements, select Yes if the statement is true. Otherwise, select No.

NOTE: Each correct selection is worth one point.

Statements	Yes	No
Organizing documents into groups based on similarities of the text contained in the documents is an example of clustering.	<input type="radio"/>	<input type="radio"/>
Grouping similar patients based on symptoms and diagnostic test results is an example of clustering.	<input type="radio"/>	<input type="radio"/>
Predicting whether a person will develop mild, moderate, or severe allergy symptoms based on pollen count is an example of clustering.	<input type="radio"/>	<input type="radio"/>

- A. Mastered
- B. Not Mastered

**Answer:** A

**Explanation:**

Clustering is a machine learning task that is used to group instances of data into clusters that contain similar characteristics. Clustering can also be used to identify relationships in a dataset

Regression is a machine learning task that is used to predict the value of the label from a set of related features.

**NEW QUESTION 194**

- (Topic 2)

You are evaluating whether to use a basic workspace or an enterprise workspace in Azure Machine Learning.

What are two tasks that require an enterprise workspace? Each correct answer presents a complete solution.

NOTE: Each correct selection is worth one point.

- A. Use a graphical user interface (GUI) to run automated machine learning experiments.
- B. Create a compute instance to use as a workstation.
- C. Use a graphical user interface (GUI) to define and run machine learning experiments from Azure Machine Learning designer.
- D. Create a dataset from a comma-separated value (CSV) file.

**Answer:** AC

**Explanation:**

Note: Enterprise workspaces are no longer available as of September 2020. The basic workspace now has all the functionality of the enterprise workspace.

Reference:

<https://www.azure.cn/en-us/pricing/details/machine-learning/> <https://docs.microsoft.com/en-us/azure/machine-learning/concept-workspace>

**NEW QUESTION 198**

- (Topic 2)

You need to predict the sea level in meters for the next 10 years. Which type of machine learning should you use?

- A. classification
- B. regression
- C. clustering

**Answer:** C

**Explanation:**

In the most basic sense, regression refers to prediction of a numeric target. Linear regression attempts to establish a linear relationship between one or more independent variables and a numeric outcome, or dependent variable.

You use this module to define a linear regression method, and then train a model using a labeled dataset. The trained model can then be used to make predictions.

Reference:

<https://docs.microsoft.com/en-us/azure/machine-learning/studio-module-reference/linear-regression>

Regression is a form of machine learning that is used to predict a numeric label based on an item's features.

<https://docs.microsoft.com/en-us/learn/modules/create-regression-model-azure-machine-learning-designer/introduction>

**NEW QUESTION 199**

HOTSPOT - (Topic 2)

For each of the following statements, select Yes if the statement is true. Otherwise, select No.

NOTE: Each correct selection is worth one point.

**Answer Area**

Statements	Yes	No
Labelling is the process of tagging training data with known values.	<input type="radio"/>	<input type="radio"/>
You should evaluate a model by using the same data used to train the model.	<input type="radio"/>	<input type="radio"/>
Accuracy is always the primary metric used to measure a model's performance.	<input type="radio"/>	<input type="radio"/>

- A. Mastered
- B. Not Mastered

**Answer:** A

**Explanation:**

Box 1: Yes

In machine learning, if you have labeled data, that means your data is marked up, or annotated, to show the target, which is the answer you want your machine learning model to predict.

In general, data labeling can refer to tasks that include data tagging, annotation, classification, moderation, transcription, or processing.

Box 2: No



Box 3: No  
Accuracy is simply the proportion of correctly classified instances. It is usually the first metric you look at when evaluating a classifier. However, when the test data is unbalanced (where most of the instances belong to one of the classes), or you are more interested in the performance on either one of the classes, accuracy doesn't really capture the effectiveness of a classifier.

**NEW QUESTION 203**  
HOTSPOT - (Topic 2)  
For each of the following statements, select Yes if the statement is true. Otherwise, select No.  
NOTE: Each correct selection is worth one point.

Answer Area

Statements	Yes	No
Azure Machine Learning designer provides a drag-and-drop visual canvas to build, test, and deploy machine learning models.	<input type="radio"/>	<input type="radio"/>
Azure Machine Learning designer enables you to save your progress as a pipeline draft.	<input type="radio"/>	<input type="radio"/>
Azure Machine Learning designer enables you to include custom JavaScript functions.	<input type="radio"/>	<input type="radio"/>

- A. Mastered
- B. Not Mastered

Answer: A

**Explanation:**  
Box 1: Yes  
Azure Machine Learning designer lets you visually connect datasets and modules on an interactive canvas to create machine learning models.  
Box 2: Yes  
With the designer you can connect the modules to create a pipeline draft.  
As you edit a pipeline in the designer, your progress is saved as a pipeline draft. Box 3: No

**NEW QUESTION 205**  
- (Topic 2)  
Which type of machine learning should you use to identify groups of people who have similar purchasing habits?

- A. classification
- B. regression
- C. clustering

Answer: C

**Explanation:**  
Clustering is a machine learning task that is used to group instances of data into clusters that contain similar characteristics. Clustering can also be used to identify relationships in a dataset  
Reference:  
<https://docs.microsoft.com/en-us/dotnet/machine-learning/resources/tasks>

**NEW QUESTION 207**  
DRAG DROP - (Topic 2)  
Match the types of machine learning to the appropriate scenarios.  
To answer, drag the appropriate machine learning type from the column on the left to its scenario on the right. Each machine learning type may be used once, more than once, or not at all.  
NOTE: Each correct selection is worth one point.

Learning Types	Answer Area
Classification	Learning Type Predict how many minutes late a flight will arrive basen on the amount of snowfall at an airport.
Clustering	Learning Type Segment customers into different groups to support a marketing department.
Regression	Learning Type Predict whether a student will complete a university course.

- A. Mastered
- B. Not Mastered

Answer: A

**Explanation:**



- 1- Regression
- 2- Clustering
- 3- Classification

**NEW QUESTION 209**

DRAG DROP - (Topic 1)

You plan to deploy an Azure Machine Learning model as a service that will be used by client applications.

Which three processes should you perform in sequence before you deploy the model? To answer, move the appropriate processes from the list of processes to the answer area and arrange them in the correct order.

**Processes**

**Answer Area**

data encryption

model retraining

model training

data preparation

model evaluation

>

<

- A. Mastered
- B. Not Mastered

**Answer:** A

**Explanation:**

**Processes**

**Answer Area**

data encryption

model retraining

model training

data preparation

model evaluation

>

<

data preparation

model training

model evaluation

**NEW QUESTION 210**

- (Topic 1)

You run a charity event that involves posting photos of people wearing sunglasses on Twitter.

You need to ensure that you only retweet photos that meet the following requirements:

Include one or more faces.

Contain at least one person wearing sunglasses. What should you use to analyze the images?

- A. the Verify operation in the Face service
- B. the Detect operation in the Face service
- C. the Describe Image operation in the Computer Vision service
- D. the Analyze Image operation in the Computer Vision service

**Answer:** B

**Explanation:**

Reference:

<https://docs.microsoft.com/en-us/azure/cognitive-services/face/overview>

**NEW QUESTION 215**

HOTSPOT - (Topic 1)  
For each of the following statements, select Yes if the statement is true. Otherwise, select No.  
NOTE: Each correct selection is worth one point.

Statements	Yes	No
Providing an explanation of the outcome of a credit loan application is an example of the Microsoft transparency principle for responsible AI.	<input type="radio"/>	<input type="radio"/>
A triage bot that prioritizes insurance claims based on injuries is an example of the Microsoft reliability and safety principle for responsible AI.	<input type="radio"/>	<input type="radio"/>
An AI solution that is offered at different prices for different sales territories is an example of the Microsoft inclusiveness principle for responsible AI.	<input type="radio"/>	<input type="radio"/>

- A. Mastered
- B. Not Mastered

Answer: A

Explanation:

Box 1: Yes  
Achieving transparency helps the team to understand the data and algorithms used to train the model, what transformation logic was applied to the data, the final model generated, and its associated assets. This information offers insights about how the model was created, which allows it to be reproduced in a transparent way.

Box 2: No  
A data holder is obligated to protect the data in an AI system, and privacy and security are an integral part of this system. Personal needs to be secured, and it should be accessed in a way that doesn't compromise an individual's privacy.

Box 3: No  
Inclusiveness mandates that AI should consider all human races and experiences, and inclusive design practices can help developers to understand and address potential barriers that could unintentionally exclude people. Where possible, speech-to-text, text-to- speech, and visual recognition technology should be used to empower people with hearing, visual, and other impairments.

NEW QUESTION 217

- (Topic 2)  
You have the Predicted vs. True chart shown in the following exhibit.

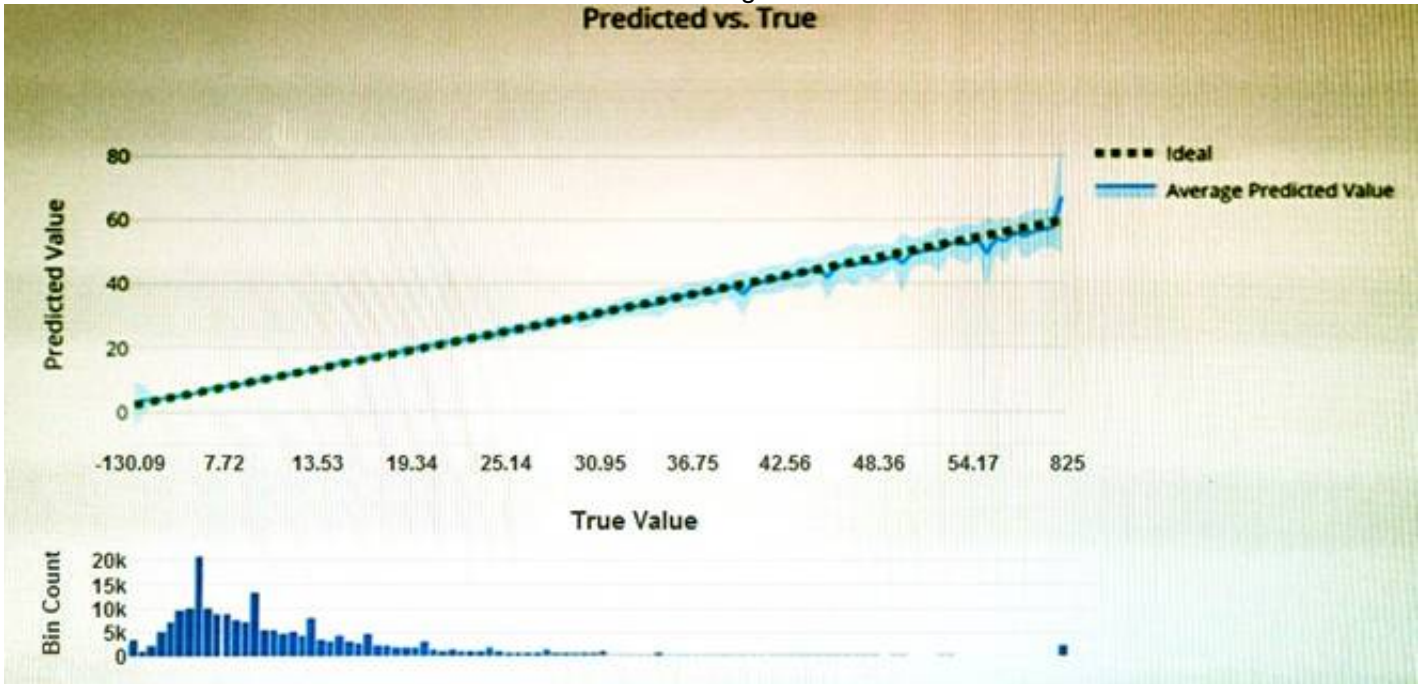

Which type of model is the chart used to evaluate?

- A. classification
- B. regression
- C. clustering

Answer: B

Explanation:

What is a Predicted vs. True chart?  
Predicted vs. True shows the relationship between a predicted value and its correlating true value for a regression problem. This graph can be used to measure performance of a model as the closer to the y=x line the predicted values are, the better the accuracy of a predictive model.  
Reference:  
<https://docs.microsoft.com/en-us/azure/machine-learning/how-to-understand-automated-m>

NEW QUESTION 219

DRAG DROP - (Topic 1)  
Match the types of AI workloads to the appropriate scenarios.  
To answer, drag the appropriate workload type from the column on the left to its scenario on the right. Each workload type may be used once, more than once, or not at all.  
NOTE: Each correct selection is worth one point.



Workload Types

Anomaly detection

Computer vision

Machine Learning (Regression)

Natural language processing

Answer Area

Workload Type

Identify handwritten letters.

Workload Type

Predict the sentiment of a social media post.

Workload Type

Identify a fraudulent credit card payment.

Workload Type

Predict next month's toy sales.

- A. Mastered  
B. Not Mastered

Answer: A

Explanation:

Workload Types

Anomaly detection

Computer vision

Machine Learning (Regression)

Natural language processing

Answer Area

Computer vision

Identify handwritten letters.

Natural language processing

Predict the sentiment of a social media post.

Anomaly detection

Identify a fraudulent credit card payment.

Machine Learning (Regression)

Predict next month's toy sales.

NEW QUESTION 224

- (Topic 1)  
You build a machine learning model by using the automated machine learning user interface (UI).  
You need to ensure that the model meets the Microsoft transparency principle for responsible AI.  
What should you do?

- A. Set Validation type to Auto.  
B. Enable Explain best model.  
C. Set Primary metric to accuracy.  
D. Set Max concurrent iterations to 0.

Answer: B

Explanation:

Model Explain Ability.  
Most businesses run on trust and being able to open the ML “black box” helps build transparency and trust. In heavily regulated industries like healthcare and banking, it is critical to comply with regulations and best practices. One key aspect of this is understanding the relationship between input variables (features) and model output. Knowing both the magnitude and direction of the impact each feature (feature importance) has on the predicted value helps better understand and explain the model. With model explain ability, we enable you to understand feature importance as part of automated ML runs.  
Reference:  
<https://azure.microsoft.com/en-us/blog/new-automated-machine-learning-capabilities-in-azure-machine-learning-service/>

NEW QUESTION 227

DRAG DROP - (Topic 1)  
Match the Microsoft guiding principles for responsible AI to the appropriate descriptions.  
To answer, drag the appropriate principle from the column on the left to its description on the right. Each principle may be used once, more than once, or not at all.  
NOTE: Each correct selection is worth one point.

Principles

Accountability

Fairness

Inclusiveness

Privacy and security

Reliability and safety

Answer Area

Principle

Ensure that AI systems operate as they were originally designed, respond to unanticipated conditions, and resist harmful manipulation.

Principle

Implementing processes to ensure that decisions made by AI systems can be overridden by humans.

Principle

Provide consumers with information and controls over the collection, use, and storage of their data.

- A. Mastered  
B. Not Mastered

Answer: A

**Explanation:**

Box 1: Reliability and safety

To build trust, it's critical that AI systems operate reliably, safely, and consistently under normal circumstances and in unexpected conditions. These systems should be able to operate as they were originally designed, respond safely to unanticipated conditions, and resist harmful manipulation.

Box 2: accountability

Box 3: Privacy and security

As AI becomes more prevalent, protecting privacy and securing important personal and business information is becoming more critical and complex. With AI, privacy and data security issues require especially close attention because access to data is essential for AI systems to make accurate and informed predictions and decisions about people. AI systems must comply with privacy laws that require transparency about the collection, use, and storage of data and mandate that consumers have appropriate controls to choose how their data is used

<https://docs.microsoft.com/en-us/learn/modules/responsible-ai-principles/4-guiding-principles>

**NEW QUESTION 229**

- (Topic 1)

What are three Microsoft guiding principles for responsible AI? Each correct answer presents a complete solution.

NOTE: Each correct selection is worth one point.

- A. knowledgeability
- B. decisiveness
- C. inclusiveness
- D. fairness
- E. opinionatedness
- F. reliability and safety

**Answer:** CDF

**Explanation:**

Reference:

<https://docs.microsoft.com/en-us/learn/modules/responsible-ai-principles/4-guiding-principles>

**NEW QUESTION 231**

HOTSPOT - (Topic 1)

To complete the sentence, select the appropriate option in the answer area.

**Answer Area**

The handling of unusual or missing values provided to an AI system is a consideration for the Microsoft  principle for responsible AI.

- inclusiveness
- privacy and security
- reliability and safety
- transparency

- A. Mastered
- B. Not Mastered

**Answer:** A

**Explanation:**

Reliability & Safety [https://en.wikipedia.org/wiki/Tay\\_\(bot\)](https://en.wikipedia.org/wiki/Tay_(bot))

"To build trust, it's critical that AI systems operate reliably, safely, and consistently under normal circumstances and in unexpected conditions. These systems should be able to

operate as they were originally designed, respond safely to unanticipated conditions, and resist harmful manipulation. It's also important to be able to verify that these systems are behaving as intended under actual operating conditions. How they behave and the variety of conditions they can handle reliably and safely largely reflects the range of situations and circumstances that developers anticipate during design and testing. We believe that rigorous testing is essential during system development and deployment to ensure AI systems can respond safely in unanticipated situations and edge cases, don't have unexpected performance failures, and don't evolve in ways that are inconsistent with original expectations"

**NEW QUESTION 232**

- (Topic 1)

You are building an AI-based app.

You need to ensure that the app uses the principles for responsible AI.

Which two principles should you follow? Each correct answer presents part of the solution.

NOTE: Each correct selection is worth one point.

- A. Implement an Agile software development methodology
- B. Implement a process of AI model validation as part of the software review process
- C. Establish a risk governance committee that includes members of the legal team, members of the risk management team, and a privacy officer
- D. Prevent the disclosure of the use of AI-based algorithms for automated decision making

**Answer:** BC



**Explanation:**

Reference:

<https://docs.microsoft.com/en-us/azure/cloud-adoption-framework/innovate/best-practices/trusted-ai>

<https://docs.microsoft.com/en-us/learn/modules/responsible-ai-principles/3-implications-responsible-ai-practical>

**NEW QUESTION 233**

.....

## Thank You for Trying Our Product

### We offer two products:

1st - We have Practice Tests Software with Actual Exam Questions

2nd - Questons and Answers in PDF Format

### AI-900 Practice Exam Features:

- \* AI-900 Questions and Answers Updated Frequently
- \* AI-900 Practice Questions Verified by Expert Senior Certified Staff
- \* AI-900 Most Realistic Questions that Guarantee you a Pass on Your FirstTry
- \* AI-900 Practice Test Questions in Multiple Choice Formats and Updatesfor 1 Year

**100% Actual & Verified — Instant Download, Please Click**  
**[Order The AI-900 Practice Test Here](#)**