

Exam Questions MS-100

Microsoft 365 Identity and Services

<https://www.2passeasy.com/dumps/MS-100/>



NEW QUESTION 1

- (Exam Topic 5)

Please wait while the virtual machine loads. Once loaded, you may proceed to the lab section. This may take a few minutes, and the wait time will not be deducted from your overall test time.

When the Next button is available, click it to access the lab section. In this section, you will perform a set of tasks in a live environment. While most functionality will be available to you as it would be in a live environment, some functionality (e.g., copy and paste, ability to navigate to external websites) will not be possible by design.

Scoring is based on the outcome of performing the tasks stated in the lab. In other words, it doesn't matter how you accomplish the task, if you successfully perform it, you will earn credit for that task.

Labs are not timed separately, and this exam may have more than one lab that you must complete. You can use as much time as you would like to complete each lab. But, you should manage your time appropriately to ensure that you are able to complete the lab(s) and all other sections of the exam in the time provided.

Please note that once you submit your work by clicking the Next button within a lab, you will NOT be able to return to the lab.

You may now click next to proceed to the lab. Lab information

Use the following login credentials as needed:

To enter your username, place your cursor in the Sign in box and click on the username below.

To enter your password, place your cursor in the Enter password box and click on the password below.

Microsoft 365 Username: admin@LODSe1211885.onmicrosoft.com Microsoft 365 Password: oL9z0=?Nq@ox

If the Microsoft 365 portal does not load successfully in the browser, press CTRL-K to reload the portal in a new browser tab.

The following information is for technical support purposes only:

Lab Instance: 11098651

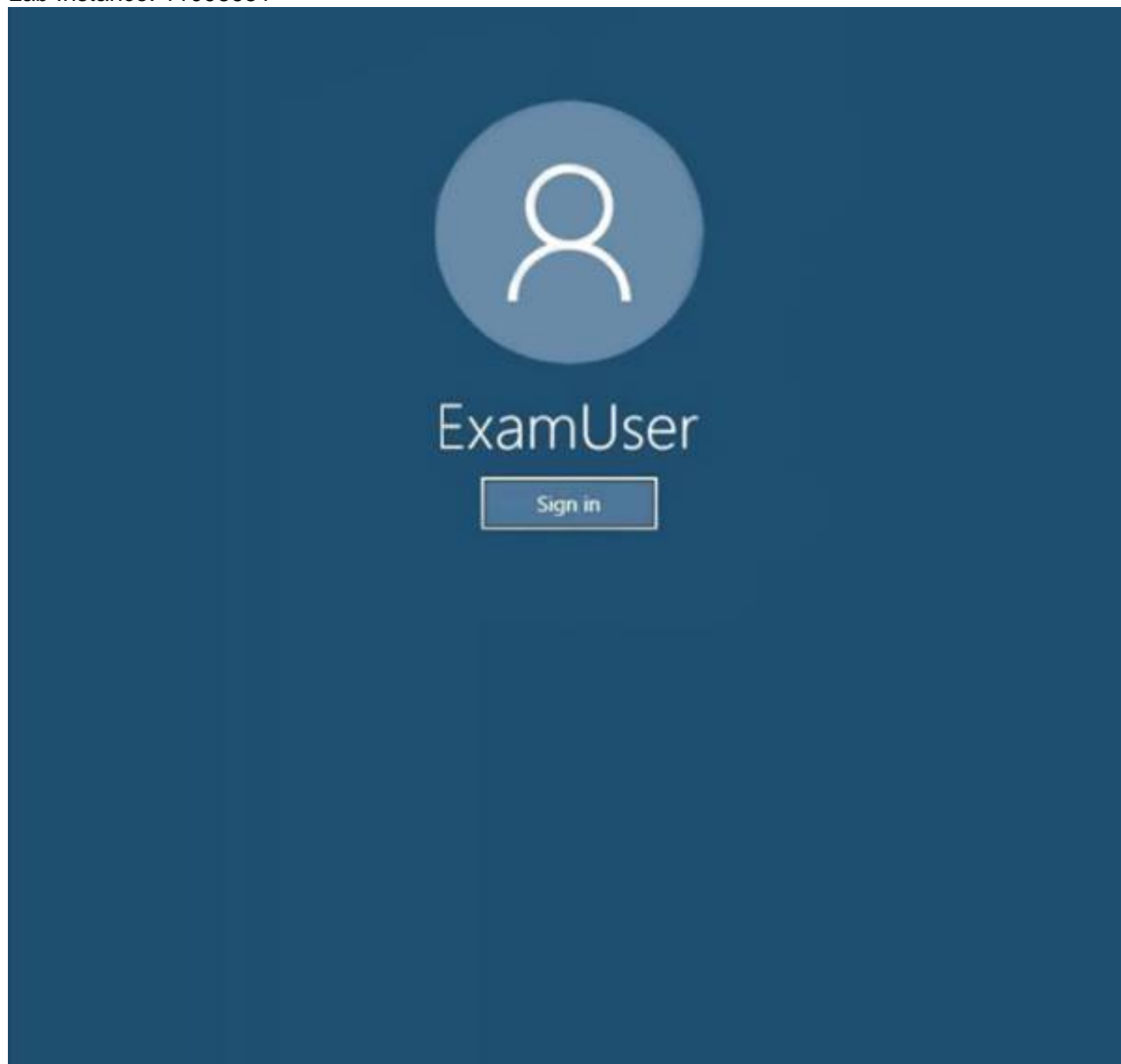

You recently discovered that several users in your organization have permissions on the mailbox of another user in the organization.

You need to ensure that Lee Gu receives a notification when a user is granted permissions on another user's mailbox.

To answer the question, sign in to the Microsoft 365 portal.

- A. Mastered
- B. Not Mastered

Answer: A

Explanation:

Create an activity alert

- * 1. Go to <https://protection.office.com/managealerts>.
- * 2. Sign in to Office 365 using your work or school account.
- * 3. On the Activity alerts page, click + New. The flyout page to create an activity alert is displayed.

* 4. Complete the following fields to create an activity alert:

- > Name - Type a name for the alert. Alert names must be unique within your organization.
- > Description (Optional) - Describe the alert, such as the activities and users being tracked, and the users that email notifications are sent to. Descriptions provide a quick and easy way to describe the purpose of the alert to other admins.
- > Alert type - Make sure the Custom option is selected.
- > Send this alert when – Click Send this alert when and then configure these two fields:
 - Activities - Click the drop-down list to display the activities that you can create an alert for. This is the same activities list that's displayed when you search the Office 365 audit log. You can select one or more specific activities or you can click the activity group name to select all activities in the group. For a description of these activities, see the "Audited activities" section in Search the audit log. When a user performs any of the activities that you've added to the alert, an email notification is sent.
 - Users - Click this box and then select one or more users. If the users in this box perform the activities that you added to the Activities box, an alert will be sent. Leave the Users box blank to send an alert when any user in your organization performs the activities specified by the alert.
- > Send this alert to – Click Send this alert, and then click in the Recipients box and type a name to add a users who will receive an email notification when a user (specified in the Users box) performs an activity (specified in the Activities box). Note that you are added to the list of recipients by default. You can remove your name from this list.

* 5. Click Save to create the alert. The new alert is displayed in the list on the Activity alerts page.

Name	Recipients	Status ▲	Date modified
Executive mailbox alert	compliance@contoso.com	On	2016-06-08 14:42:02
SharePoint upload alert	admin@contoso.com	Off	2016-06-08 14:23:39
External sharing alert	admin@contoso.com	Off	2016-06-08 14:24:08

The status of the alert is set to On. Note that the recipients who will received an email notification when an alert is sent are also listed.

References:

<https://docs.microsoft.com/en-us/microsoft-365/compliance/create-activity-alerts?view=o365-worldwide>

NEW QUESTION 2

- (Exam Topic 5)

You plan to deploy two Microsoft Power Platform environments as shown in the following table.

Name	Requirement
Environment1	<ul style="list-style-type: none"> • Supports multiple makers that customize the environment • Supports copying other environments to Environment1 • Minimizes effort to reset the environment
Environment2	<ul style="list-style-type: none"> • Is a learning environment • Supports the creation of unlimited apps • Does not count against storage allocation for the tenant

Which environment type should you use for each environment? To answer, select the appropriate options in the answer area.

NOTE: Each correct selection is worth one point.

Environment1: ▼

Developer
Production
Sandbox

Environment2: ▼

Developer
Production
Sandbox

- A. Mastered
B. Not Mastered

Answer: A

Explanation:

Graphical user interface, text, application, chat or text message Description automatically generated

Reference:

<https://docs.microsoft.com/en-us/power-platform/admin/environments-overview>

NEW QUESTION 3

- (Exam Topic 5)

You are developing an interactive invoicing application mat will be used by end users. The application will have the following features:

- Save invoices generated by a user to the user s OneDrive for Business.
- Email daily automated reminders.

You need to identify which permissions to grant for the application features. The solution must use the principle of least privilege. Which permission type should you grant for each feature? To answer, select the appropriate options in the answer area.

NOTE: Each correct selection is worth one point.

Answer Area

Save invoices: ▼

Administrator
Application
Delegated
Super User

Send automated reminders: ▼

Administrator
Application
Delegated
Super User

- A. Mastered
B. Not Mastered

Answer: A

Explanation:

Answer Area

Save invoices:	<div> Administrator Application Delegated Super User </div>
Send automated reminders:	<div> Administrator Application Delegated Super User </div>

NEW QUESTION 4

- (Exam Topic 5)

Your company has 20 employees, Each employees has a mailbox hosted in Outlook.com. The company purchases a Microsoft 365 subscription.

You plan to migrate all the mailboxes to Microsoft 365.

You need to recommend which type of migration to use for the mailboxes. What should recommend?

- A. Cutover migration
- B. Staged migration
- C. IMAP migration
- D. Minimal hybrid migration

Answer: C

Explanation:

To migrate mailboxes from Outlook.com to Office 365, you need to use the IMAP migration method.

After you've added your users to Office 365, you can use Internet Message Access Protocol (IMAP) to migrate email for those users from their IMAP-enabled email servers.

In the Microsoft 365 admin center, go to Setup

>Data migration

to start migrating IMAP enabled emails.

The email migrations page is pre-configured for migrations from Gmail, Outlook, Hotmail and Yahoo. You can also enter your own IMAP server name and connection parameters to migrate from an email service that is not listed.

References:

<https://docs.microsoft.com/en-us/exchange/mailbox-migration/migrating-imap-mailboxes/imap-migration-in-the>

NEW QUESTION 5

- (Exam Topic 5)

You have a Microsoft 365 subscription.

You suspect that several Microsoft Office 365 applications or services were recently updated. You need to identify which applications or services were recently updated.

What are two possible ways to achieve the goal? Each correct answer presents a complete solution.

NOTE: Each correct selection is worth one point.

- A. From the Microsoft 365 admin center, review the Message center blade.
- B. From the Office 365 Admin mobile app, review the messages.
- C. From the Microsoft 365 admin center, review the Products blade.
- D. From the Microsoft 365 admin center, review the Service health blade.

Answer: AB

Explanation:

The Message center in the Microsoft 365 admin center is where you would go to view a list of the features that were recently updated in the tenant. This is where Microsoft posts official messages with information including new and changed features, planned maintenance, or other important announcements.

The messages displayed in the Message center can also be viewed by using the Office 365 Admin mobile app. Reference:

<https://docs.microsoft.com/en-us/office365/admin/manage/message-center?view=o365-worldwide>

<https://docs.microsoft.com/en-us/office365/admin/admin-overview/admin-mobile-app?view=o365-worldwide>

NEW QUESTION 6

- (Exam Topic 5)

You have a Microsoft 365 subscription linked to an Azure Active Directory (Azure AD) tenant named contoso.onmicrosoft.com.

In the subscription, an administrator adds two custom domains named sub1.contoso.onmicrosoft.com and sub2.contoso.onmicrosoft.com and the objects shown in the following table.

Name	Type	Attribute
Group1	Distribution group	Group email: group1@sub1.contoso.onmicrosoft.com
Group2	Mail-enabled security group	Group email: group2@sub2.contoso.onmicrosoft.com
Group3	Office 365 group	Group email: group3@contoso.onmicrosoft.com
User1	User	Username: user1@sub1.contoso.onmicrosoft.com
Contact2	Contact	Email: contact2@sub2.contoso.onmicrosoft.com

You plan to delete sub1.contoso.onmicrosoft.com and sub2.contoso.onmicrosoft.com.
Which objects must you delete or modify manually before you can delete the domains? To answer, select the appropriate options in the answer area.
NOTE: Each correct selection is worth one point.

Sub1.contoso.onmicrosoft.com:

User1 only

Group1 only

User1 and Group1 only

User1, Group1, and Group3

No resources must be deleted or modified

Sub2.contoso.onmicrosoft.com:

Contact2 only

Group2 only

Contact2 and Group2 only

Contact2, Group2, and Group3

No resources must be deleted or modified

- A. Mastered
- B. Not Mastered

Answer: A

Explanation:
Anything with an email address in the subdomain needs to be removed or moved to another domain. This includes users, mail-enabled security groups, distribution groups and contacts. Office 365 groups will also need to be removed from the subdomains (they cannot be moved to another domain). However, the only Office 365 group in this question is in the parent domain, not the subdomains.
Reference:
<https://docs.microsoft.com/en-us/microsoft-365/admin/get-help-with-domains/remove-a-domain?view=o365-wo>

NEW QUESTION 7
- (Exam Topic 5)
You have a Microsoft 365 E5 subscription.
You have an Azure AD tenant named contoso.com that contains the following users:

- Admin 1
- Admin2
- User1

Contoso.com contains an administrative unit named AU1 that has no role assignments. User1 is a member of AU1.

Answer Area

Statements	Yes	No
You can add Admin1 as a member of AU1.	<input type="radio"/>	<input type="radio"/>
You can add User1 as a member of AU2.	<input type="radio"/>	<input type="radio"/>
You can assign Admin2 the User administrator role for AU1.	<input type="radio"/>	<input type="radio"/>

- A. Mastered
- B. Not Mastered

Answer: A

Explanation:

Answer Area

Statements	Yes	No
You can add Admin1 as a member of AU1.	<input checked="" type="radio"/>	<input type="radio"/>
You can add User1 as a member of AU2.	<input checked="" type="radio"/>	<input type="radio"/>
You can assign Admin2 the User administrator role for AU1.	<input type="radio"/>	<input checked="" type="radio"/>

NEW QUESTION 8

- (Exam Topic 5)

You have a Microsoft 365 Enterprise E5 subscription.

You need to enforce multi-factor authentication on all cloud-based applications for the users in the finance department.

What should you do?

- A. Create an activity policy.
- B. Create a new app registration.
- C. Create a conditional access policy.
- D. Create a session policy.

Answer: C

Explanation:

You can configure a conditional access policy that applies to the Finance department users. The policy can be configured to 'Allow access' but with multi-factor authentication as a requirement.

The reference below explains how to create a conditional access policy that requires MFA for all users. To apply the policy to finance users only, you would select Users and Group in the Include section instead of All Users and then specify the finance department group.

Reference:

<https://docs.microsoft.com/en-us/azure/active-directory/conditional-access/howto-conditional-access-policy-all>

NEW QUESTION 9

- (Exam Topic 5)

Your network contains an Active Directory domain named adatum.com that is synced to Microsoft Azure Active Directory (Azure AD).

The domain contains 100 user accounts.

The city attribute for all the users is set to the city where the user resides.

You need to modify the value of the city attribute to the three-letter airport code of each city. What should you do?

- A. From Active Directory Administrative Center, select the Active Directory users, and then modify the Properties settings.
- B. From the Microsoft 365 admin center, select the users, and then use the Bulk actions option.
- C. From Azure Cloud Shell, run the Get-MsolUser and Set-MSOLuser cmdlets.
- D. From Windows PowerShell on a domain controller, run the Get-AzureADUser and Set-AzureADUser cmdlets.

Answer: A

Explanation:

The user accounts are synced from the on-premise Active Directory to the Microsoft Azure Active Directory (Azure AD). Therefore, the city attribute must be changed in the on-premise Active Directory.

You can modify certain attributes of multiple user accounts simultaneously by selecting them in Active Directory Administrative Center or Active Directory Users and Computers, right clicking then selecting Properties.

The other three options all suggest modifying the city attribute of the users in the Azure Active Directory which is incorrect.

Reference:

<https://blogs.technet.microsoft.com/canitpro/2015/11/25/step-by-step-managing-multiple-user-accounts-via-acti>

NEW QUESTION 10

- (Exam Topic 5)

Please wait while the virtual machine loads. Once loaded, you may proceed to the lab section. This may take a few minutes, and the wait time will not be deducted from your overall test time.

When the Next button is available, click it to access the lab section. In this section, you will perform a set of tasks in a live environment. While most functionality will be available to you as it would be in a live environment, some functionality (e.g., copy and paste, ability to navigate to external websites) will not be possible by design.

Scoring is based on the outcome of performing the tasks stated in the lab. In other words, it doesn't matter how you accomplish the task, if you successfully perform it, you will earn credit for that task.

Labs are not timed separately, and this exam may have more than one lab that you must complete. You can use as much time as you would like to complete each lab. But, you should manage your time appropriately to ensure that you are able to complete the lab(s) and all other sections of the exam in the time provided.

Please note that once you submit your work by clicking the Next button within a lab, you will NOT be able to return to the lab.

You may now click next to proceed to the lab. Lab information

Use the following login credentials as needed:

To enter your username, place your cursor in the Sign in box and click on the username below.

To enter your password, place your cursor in the Enter password box and click on the password below.

Microsoft 365 Username: admin@LODSe878763.onmicrosoft.com

Microsoft 365 Password: m3t^We\$Z7&xy

If the Microsoft 365 portal does not load successfully in the browser, press CTRL-K to reload the portal in a new browser tab.

The following information is for technical support purposes only:

Lab Instance: 11440873



Sign in

No account? [Create one!](#)

[Can't access your account?](#)

[Sign-in options](#)

Next

You need to ensure that all the users in your organization are prompted to change their password every 60 days. The solution must ensure that the users are reminded that their password must be changed 10 days before the required change.
 To answer, sign in to the Microsoft 365 portal.

- A. Mastered
- B. Not Mastered

Answer: A

Explanation:

You need to configure the Password Expiration Policy.

- * 1. Sign in to the Microsoft 365 Admin Center.
- * 2. In the left navigation pane, expand the Settings section then select the Settings option.
- * 3. Click on Security and Privacy.
- * 4. Select the Password Expiration Policy.
- * 5. Ensure that the checkbox labelled "Set user passwords to expire after a number of days" is ticked.
- * 6. Enter 60 in the "Days before passwords expire" field.
- * 7. Enter 10 in the "Days before a user is notified about expiration" field.
- * 8. Click the 'Save changes' button.

NEW QUESTION 10

- (Exam Topic 5)

You have a Microsoft 365 subscription.

You use the Microsoft Office Deployment tool to install Office 365 ProPlus. You create a configuration file that contains the following settings.

```
<Configuration>
  <Add SourcePath="\\Server1\Office"
    OfficeClientEdition="32"
    Channel="Broad"
    AllowCdnFallback="False">
    <Product ID="0365ProPlusRetail">
      <Language ID="en-us" />
      <Language ID="ja-jp" />
    </Product>
    <Product ID="VisioProRetail">
      <Language ID="en-us" />
      <Language ID="ja-jp" />
    </Product>
  </Add>
  <Remove All="TRUE">
    <Product ID="0365ProPlusRetail">
      <Language ID="en-us" />
    </Product>
    <Product ID="VisioProRetail">
      <Language ID="en-us" />
    </Product>
  </Remove>
  <Updates Enabled="TRUE"
    UpdatePath="\\Server1\Office"
    Channel="Broad" />
  <Display Level="None" AcceptEULA="TRUE" />
  <Logging Level="Standard" Path="%temp%" />
</Configuration>
```

Use the drop-down menus to select the answer choice that completes each statement based on the information presented in the graphic.

NOTE: Each correct selection is worth one point.

The [answer choice] will be uninstalled from the computers.

▼
MSI version of Microsoft Visio only
C2R version of Microsoft Visio only
MSI and C2R versions of Microsoft Visio

If the Office share on Server1 is missing the Japanese language pack, Office 365 ProPlus will [answer choice].

▼
be installed in English only
be installed in a randomly selected language
NOT be installed

- A. Mastered
- B. Not Mastered

Answer: A

Explanation:

Box 1:

The C2R (click-to-run) version of Microsoft Visio only will be uninstalled from the computers.

To remove the MSI version of Microsoft Visio, you would need to specify the RemoveMSI parameter. The RemoveMSI parameter is not configured in the configuration file in this question. Therefore, only the C2R version will be installed.

Box 2:

If the Office share on Server1 is missing the Japanese language pack, Office 365 ProPlus will be installed in English only.

In the configuration file, English is the first in the list above Japanese. Therefore, English is the primary language and the installation will continue in English only.

Reference:

<https://docs.microsoft.com/en-us/deployoffice/configuration-options-for-the-office-2016-deployment-tool>

NEW QUESTION 12

- (Exam Topic 5)

Your network contains an Active Directory forest named contoso.local. You purchase a Microsoft 365 subscription.

You plan to move to Microsoft and to implement a hybrid deployment solution for the next 12 months. You need to prepare for the planned move to Microsoft 365.

What is the best action to perform before you implement directory synchronization? More than one answer choice may achieve the goal. Select the BEST answer.

- A. Purchase a third-party X.509 certificate.
- B. Rename the Active Directory forest.
- C. Purchase a custom domain name.
- D. Create an external forest trust.

Answer: C

Explanation:

The first thing you need to do before you implement directory synchronization is to purchase a custom domain name. This could be the domain name that you use in your on-premise Active Directory if it's a routable domain name, for example, contoso.com.

If you use a non-routable domain name in your Active Directory, for example contoso.local, you'll need to add the routable domain name as a UPN suffix in Active Directory.

Reference:

<https://docs.microsoft.com/en-us/office365/enterprise/set-up-directory-synchronization>

NEW QUESTION 16

- (Exam Topic 5)

Your network contains an on premises Active Directory domain named contoso.com. The domain contains five domain controllers.

Your company purchases Microsoft 365 and creates a Microsoft Azure Active Directory (Azure AD) tenant named contoso.onmicrosoft.com.

You plan to establish federation authentication between on premises Active Directory and the Azure AD tenant by using Active Directory Federation Services (AD FS).

You need to establish the federation.

What should you do? To answer, select the appropriate options in the answer area. NOTE: Each correct selection is worth one point

Action to perform before establishing the federation:

▼
From the Azure portal, add a custom domain name.
From the Azure portal, configure an authentication method.
From a domain controller, install a Pass-through Authentication Agent.
From a domain controller, install Windows Identity Foundation 3.5.

Tool to use to establish the federation:

▼
Active Directory Domains and Trusts
Azure AD Connect
The AD FS console
The Azure portal

- A. Mastered
- B. Not Mastered

Answer: A

Explanation:

The on-premises Active Directory domain is named contoso.com. Before you can configure federation authentication between on-premises Active Directory and the Azure AD tenant, you need to add the domain contoso.com to Microsoft 365. You do this by adding a custom domain name. The next step is to establish the federation. You can configure AD FS by using Azure AD Connect. Reference: <https://docs.microsoft.com/en-us/azure/active-directory/hybrid/how-to-connect-install-custom#configuring-feder>

NEW QUESTION 19

- (Exam Topic 5)

Your network contains an on-premises Active Directory domain. The domain contains 2,000 computers that run Windows 10.

You purchase a Microsoft 365 subscription.

You implement password hash synchronization and Azure Active Directory (Azure AD) Seamless Single Sign-On (Seamless SSO).

You need to ensure that users can use Seamless SSO from the Windows 10 computers. What should you do?

- A. Create a conditional access policy in Azure AD.
- B. Deploy an Azure AD Connect staging server.
- C. Join the computers to Azure AD.
- D. Modify the Intranet zone settings by using Group Policy

Answer: D

Explanation:

Reference:

<https://docs.microsoft.com/en-us/azure/active-directory/hybrid/how-to-connect-sso-quick-start>

NEW QUESTION 20

- (Exam Topic 5)

You have a Microsoft Azure Active Directory (Azure AD) tenant that contains the users shown in the following table.

Name	Member of
User1	Group1
User2	Group2
User3	Group3

Your company uses Windows Defender Advanced Threat Protection (ATP). Windows Defender ATP contains the roles shown in the following table.

Name	Permission	Assigner user group
Windows Defender ATP administrator (default)	View data, Alerts investigation, Active remediation actions, Manage security settings	Group3
Role1	View data, Alerts investigation	Group1
Role2	View data	Group2

Windows Defender ATP contains the device groups shown in the following table.

Rank	Machine group	Machine	User access
1	ATP1	Device1	Group1
Last	Ungrouped machines (default)	Device2	Group2

For each of the following statements, select Yes if the statement is true. Otherwise, select No.

NOTE: Each correct selection is worth one point.

Statements

Yes

No

User1 can view Device1 in Windows Defender Security Center.

☐
☐

User2 can sign in to Windows Defender Security Center.

☐
☐

User3 can view Device1 in Windows Defender Security Center.

☐
☐

- A. Mastered
- B. Not Mastered

Answer: A

Explanation:

Box 1:

Yes. User1 is in Group1 which is assigned to Role1. Device1 is in the device group named ATP1 which Group1 has access to. Role1 gives Group1 (and User1) View Data Permission. This is enough to view Device1 in Windows Security Center.

Box 2:

Yes. User2 is in Group2 which is assigned to Role2. Role2 gives Group2 (and User2) View Data Permission. This is enough to sign in to Windows Security Center.

Box 3:

Yes. User3 is in Group3 which is assigned the Windows ATP Administrator role. Someone with a Microsoft Defender ATP Global administrator role has unrestricted access to all machines, regardless of their machine group association and the Azure AD user groups assignments.

Reference:

<https://docs.microsoft.com/en-us/windows/security/threat-protection/microsoft-defender-atp/user-roles> <https://docs.microsoft.com/en-us/windows/security/threat-protection/microsoft-defender-atp/rbac>

NEW QUESTION 22

- (Exam Topic 5)

Please wait while the virtual machine loads. Once loaded, you may proceed to the lab section. This may take a few minutes, and the wait time will not be deducted from your overall test time.

When the Next button is available, click it to access the lab section. In this section, you will perform a set of tasks in a live environment. While most functionality will be available to you as it would be in a live environment, some functionality (e.g., copy and paste, ability to navigate to external websites) will not be possible by design.

Scoring is based on the outcome of performing the tasks stated in the lab. In other words, it doesn't matter how you accomplish the task, if you successfully perform it, you will earn credit for that task.

Labs are not timed separately, and this exam may have more than one lab that you must complete. You can use as much time as you would like to complete each lab. But, you should manage your time appropriately to ensure that you are able to complete the lab(s) and all other sections of the exam in the time provided.

Please note that once you submit your work by clicking the Next button within a lab, you will NOT be able to return to the lab.

You may now click next to proceed to the lab. Lab information

Use the following login credentials as needed:

To enter your username, place your cursor in the Sign in box and click on the username below.

To enter your password, place your cursor in the Enter password box and click on the password below.

Microsoft 365 Username: admin@LODSe878763.onmicrosoft.com

Microsoft 365 Password: m3t^We\$Z7&xy

If the Microsoft 365 portal does not load successfully in the browser, press CTRL-K to reload the portal in a new browser tab.

The following information is for technical support purposes only:

Lab Instance: 11440873

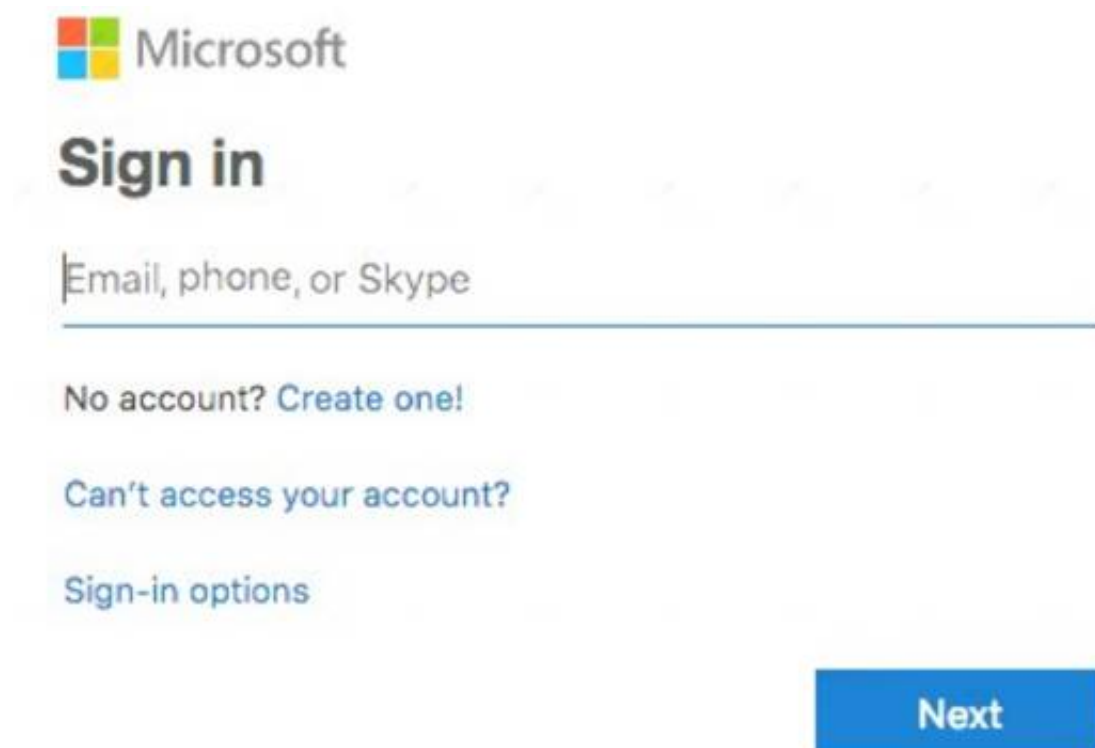

Your organization plans to start a new collaborative project that will contain email and chat communications, as well as regular meetings.

You need to create a team in Microsoft Teams for the planned project. The team must have the following configurations:

- > Be named Project1.
- > Have an owner named Lee Gu.
- > Have a channel named Channel1.

To answer, sign in to the Microsoft 365 portal.

- A. Mastered
- B. Not Mastered

Answer: A

Explanation:

You need to create a team. You can create a team in the Microsoft Teams Admin Center or in the Microsoft Teams app. However, to be able to specify the team owner when creating the team, you need to use the Teams Admin Center.

- * 1. Go to the Microsoft Teams Admin Center.
- * 2. In the left navigation pane, expand the Teams section and select 'Manage Teams'.
- * 3. Click the '+ Add' link to add a new team.
- * 4. Give the team the name Project1.
- * 5. In the Team Owner field, remove your name which is there by default and add Lee Gu.
- * 6. Click the 'Create a team' button to create the team.
- * 7. In the teams list, select the Project1 team.
- * 8. Click on 'Channels'.
- * 9. Click the '+ Add' link to add a new channel.
- * 10. Give the channel the name Channel1.
- * 11. Click the Apply button to create the channel.

NEW QUESTION 25

- (Exam Topic 5)

Your network contains an on-premises Active Directory domain. The domain contains the users shown in the following table.

Name	Country	Organizational unit (OU)
User1	United States	OU1
User2	Canada	OU1
User3	United States	OU2

You have a Microsoft 365 subscription that is linked to an Azure Active Directory (Azure AD) tenant named contoso.com. You configure Azure AD Connect to sync the on-premises domain to contoso.com as shown in the following exhibit.

Answer Area

Statements	Yes	No
User1 syncs to Azure AD.	<input type="radio"/>	<input type="radio"/>
User2 syncs to Azure AD.	<input type="radio"/>	<input type="radio"/>
User3 syncs to Azure AD.	<input type="radio"/>	<input type="radio"/>

- A. Mastered
B. Not Mastered

Answer: A

Explanation:

Answer Area

Statements	Yes	No
User1 syncs to Azure AD.	<input checked="" type="radio"/>	<input type="radio"/>
User2 syncs to Azure AD.	<input checked="" type="radio"/>	<input type="radio"/>
User3 syncs to Azure AD.	<input checked="" type="radio"/>	<input type="radio"/>

NEW QUESTION 30

- (Exam Topic 5)

You have a Microsoft 365 subscription.

All users have their email stored in Microsoft Exchange Online

In the mailbox of a user named User, you need to preserve a copy of all the email messages that contain the word ProjectX.

What should you do first?

- A. From the Exchange admin center, start a mail flow message trace.
B. From the Security & Compliance admin center, start a message trace.
C. From the Security & Compliance admin center, create a label and label policy.
D. From the Exchange admin center, create a mail flow rule.

Answer: C

Explanation:

When you configure conditions for a label, you can automatically assign a label to a document or email. In this case, we would create a label to label all email messages that contain the word ProjectX. We would then create a label policy to preserve a copy of all message that have the label assigned.

Reference:

<https://docs.microsoft.com/en-us/azure/information-protection/configure-policy-classification>

NEW QUESTION 34

- (Exam Topic 5)

Note: This question is part of a series of questions that present the same scenario. Each question in the series contains a unique solution that might meet the stated goals. Some question sets might have more than one correct solution, while others might not have a correct solution.

After you answer a question in this section, you will NOT be able to return to it. As a result, these questions will not appear in the review screen.

Your company plans to deploy several Microsoft Office 365 services.

You need to design an authentication strategy for the planned deployment. The solution must meet the following requirements:

- * Users must be able to authenticate during business hours only.
- * Authentication requests must be processed successfully if a single server fails.
- * When the password for an on-premises user account expires, the new password must be enforced the next time the user signs in.

* Users who connect to Office 365 services from domain-joined devices that are connected to the internal network must be signed in automatically.
Solution: You design an authentication strategy that uses password hash synchronization and seamless SSO. The solution contains two servers that have an Authentication Agent installed.
Does this meet the goal?

- A. Yes
- B. No

Answer: B

Explanation:

Reference:

<https://docs.microsoft.com/en-us/azure/security/azure-ad-choose-authn>

NEW QUESTION 35

- (Exam Topic 5)

Your company has three main offices and one branch office. The branch office is used for research. The company plans to implement a Microsoft 365 tenant and to deploy multi-factor authentication.

You need to recommend a Microsoft 365 solution to ensure that multi-factor authentication is enforced only for users in the branch office.

What should you include in the recommendation?

- A. Microsoft Azure Active Directory (Azure AD) conditional access.
- B. Microsoft Azure Active Directory (Azure AD) password protection.
- C. a device compliance policy
- D. a Microsoft Intune device configuration profile

Answer: A

Explanation:

With Azure Active Directory (Azure AD) Conditional Access, you can control how authorized users can access your cloud apps. The location condition of a Conditional Access policy enables you to tie access controls settings to the network locations of your users.

For this question, we need to configure a location condition in a conditional access policy and apply the policy to users in that location (the branch office). The conditional access policy can be required to 'Allow Access' but 'Required MFA'.

Reference:

<https://docs.microsoft.com/en-us/azure/active-directory/conditional-access/location-condition>

NEW QUESTION 39

- (Exam Topic 5)

Please wait while the virtual machine loads. Once loaded, you may proceed to the lab section. This may take a few minutes, and the wait time will not be deducted from your overall test time.

When the Next button is available, click it to access the lab section. In this section, you will perform a set of tasks in a live environment. While most functionality will be available to you as it would be in a live

environment, some functionality (e.g., copy and paste, ability to navigate to external websites) will not be possible by design.

Scoring is based on the outcome of performing the tasks stated in the lab. In other words, it doesn't matter how you accomplish the task, if you successfully perform it, you will earn credit for that task.

Labs are not timed separately, and this exam may have more than one lab that you must complete. You can use as much time as you would like to complete each lab. But, you should manage your time appropriately to ensure that you are able to complete the lab(s) and all other sections of the exam in the time provided.

Please note that once you submit your work by clicking the Next button within a lab, you will NOT be able to return to the lab.

You may now click next to proceed to the lab. Lab information

Use the following login credentials as needed:

To enter your username, place your cursor in the Sign in box and click on the username below.

To enter your password, place your cursor in the Enter password box and click on the password below.

Microsoft 365 Username: admin@M365x981607.onmicrosoft.com Microsoft 365 Password: *yfLo7lr2&yIf the Microsoft 365 portal does not load successfully in the browser, press CTRL-K to reload the portal in a new browser tab.

The following information is for technical support purposes only:

Lab Instance: 10811525

You plan to invite several guest users to access the resources in your organization.

You need to ensure that only guests who have an email address that uses the @contoso.com suffix can connect to the resources in your Microsoft 365 tenant.

- A. Mastered
- B. Not Mastered

Answer: A

Explanation:

You need to add contoso.com as an allowed domain in the 'External collaboration settings'.

* 1. Go to the Azure Active Directory admin center.

* 2. Select Users then select 'User settings'.

* 3. Under External Users, select the 'Manage external collaboration settings'.

* 4. Under 'Collaboration restrictions', select the 'Allow invitations only to the specified domains (most restrictive)' option.

* 5. Under, Target Domains, type in the domain name 'contoso.com'

* 6. Click the Save button at the top of the screen to save your changes. References:

<https://docs.microsoft.com/en-us/azure/active-directory/b2b/allow-deny-list>

NEW QUESTION 44

- (Exam Topic 5)

You have a Microsoft 365 E5 subscription and a hybrid deployment of Microsoft Exchange. The deployment contains TOO users who have on-premises mailboxes and 100 users who have mailboxes in Exchange Online.

You enable Microsoft Teams and assign a Microsoft Teams license to each user.

You need to ensure that the users who have on-premises mailboxes can use Microsoft Teams. All Microsoft Teams chat data must be searchable by using

Content search in the Security fit Compliance admin center.

What should you do? To answer, select the appropriate options in the answer area. NOTE: Each correct selection is worth one point.

License to assign to the users who have on-premises mailboxes:

Task to perform to enable Content search for the on-premises mailboxes:

- A. Mastered
- B. Not Mastered

Answer: A

Explanation:

License to assign to the users who have on-premises mailboxes:

Task to perform to enable Content search for the on-premises mailboxes:

NEW QUESTION 46

- (Exam Topic 5)

You have a Microsoft 365 tenant that contains a Microsoft Power Platform environment. You need to ensure that only specific users can create new environments. What should you do in the Power Platform admin center?

- A. From Data policies, create a new data policy.
- B. From Data integration, create a new connection set.
- C. From Power Platform settings, modify the Governance settings for the environment.
- D. From Environments, modify the behaviour settings for the default environment.

Answer: C

Explanation:

Reference:

<https://docs.microsoft.com/en-us/power-platform/admin/control-environment-creation>

NEW QUESTION 51

- (Exam Topic 5)

Your company has a Microsoft 365 subscription that has multi-factor authentication configured for all users. Users on the network report that they are prompted for multi-factor authentication multiple times a day.

You need to reduce the number of times the users are prompted for multi-factor authentication on their company-owned devices.

What should you do?

- A. Enable the multi-factor authentication trusted IPs setting, and then verify each device as a trusted device.
- B. Enable the remember multi-factor authentication setting, and then verify each device as a trusted device.
- C. Enable the multi-factor authentication trusted IPs setting, and then join all client computers to Microsoft Azure Active Directory (Azure AD).
- D. Enable the remember multi-factor authentication setting, and then join all client computers to Microsoft Azure Active Directory (Azure AD).

Answer: B

Explanation:

The remember Multi-Factor Authentication feature for devices and browsers that are trusted by the user is a free feature for all Multi-Factor Authentication users. Users can bypass subsequent verifications for a specified number of days, after they've successfully signed-in to a device by using Multi-Factor Authentication. The feature enhances usability by minimizing the number of times a user has to perform two-step verification on the same device.

Reference:

<https://docs.microsoft.com/en-us/azure/active-directory/authentication/howto-mfa-mfasettings>

NEW QUESTION 55

- (Exam Topic 5)

Please wait while the virtual machine loads. Once loaded, you may proceed to the lab section. This may take a few minutes, and the wait time will not be deducted from your overall test time.

When the Next button is available, click it to access the lab section. In this section, you will perform a set of tasks in a live environment. While most functionality will be available to you as it would be in a live environment, some functionality (e.g., copy and paste, ability to navigate to external websites) will not be possible by design.

Scoring is based on the outcome of performing the tasks stated in the lab. In other words, it doesn't matter how you accomplish the task, if you successfully perform it, you will earn credit for that task.

Labs are not timed separately, and this exam may have more than one lab that you must complete. You can use as much time as you would like to complete each lab. But, you should manage your time appropriately to ensure that you are able to complete the lab(s) and all other sections of the exam in the time provided. Please note that once you submit your work by clicking the Next button within a lab, you will NOT be able to return to the lab. You may now click next to proceed to the lab. Lab information
Use the following login credentials as needed:
To enter your username, place your cursor in the Sign in box and click on the username below.
To enter your password, place your cursor in the Enter password box and click on the password below.
Microsoft 365 Username: admin@LODSe878763.onmicrosoft.com
Microsoft 365 Password: m3t^We\$Z7&xy
If the Microsoft 365 portal does not load successfully in the browser, press CTRL-K to reload the portal in a new browser tab.
The following information is for technical support purposes only:
Lab Instance: 11440873

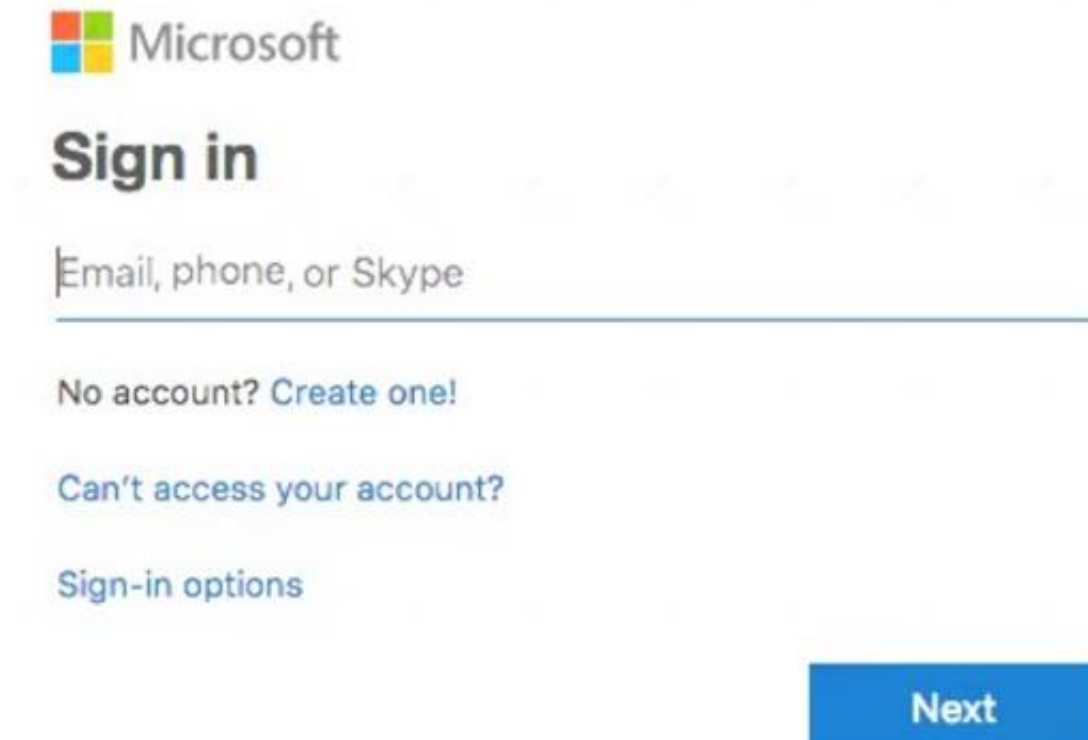

The screenshot shows the Microsoft 365 Sign in page. At the top is the Microsoft logo. Below it is the text "Sign in". There is a text input field with the placeholder text "Email, phone, or Skype". Below the input field are three links: "No account? Create one!", "Can't access your account?", and "Sign-in options". At the bottom of the sign-in section is a blue button labeled "Next".

You need to prevent all the users in your organization from sending an out of office reply to external users.
To answer, sign in to the Microsoft 365 portal.

- A. Mastered
- B. Not Mastered

Answer: A

Explanation:

You need to modify the default remote domain. When you add a remote domain, you specify the domain name and the settings apply to that domain. The default remote domain applies to all other domains. Therefore, we need to disable Out of Office replies for external users in the settings of the default remote domain.

- * 1. Go to the Exchange Admin Center.
- * 2. Click Mail Flow in the left navigation pane.
- * 3. Click on Remote Domains.
- * 4. Select the default remote domain and click the Edit icon (pencil icon).
- * 5. In the 'Out of Office automatic reply types' section, select 'None'.
- * 6. Click Save to save to changes to the default remote domain.

NEW QUESTION 56

- (Exam Topic 5)

Note: This question is part of a series of questions that present the same scenario. Each question in the series contains a unique solution that might meet the stated goals. Some question sets might have more than one correct solution, while others might not have a correct solution.

After you answer a question in this section, you will NOT be able to return to it. As a result, these questions will not appear in the review screen.

Your network contains an on-premises Active Directory forest named contoso.com. The forest contains the following domains:

- > Contoso.com
- > East.contoso.com

An Azure AD Connect server is deployed to contoso.com. Azure AD Connect syncs to an Azure Active Directory (Azure AD) tenant.

You deploy a new domain named west.contoso.com to the forest.

You need to ensure that west.contoso.com syncs to the Azure AD tenant.

Solution: You install a new Azure AD Connect server in west.contoso.com and set AD Connect to active mode.

Does this meet the goal?

- A. Yes
- B. No

Answer: A

NEW QUESTION 57

- (Exam Topic 5)

Your company has a hybrid deployment of Microsoft 365.

An on-premises user named User1 is synced to Microsoft Azure Active Directory (Azure AD). Azure AD Connect is configured as shown in the following exhibit.

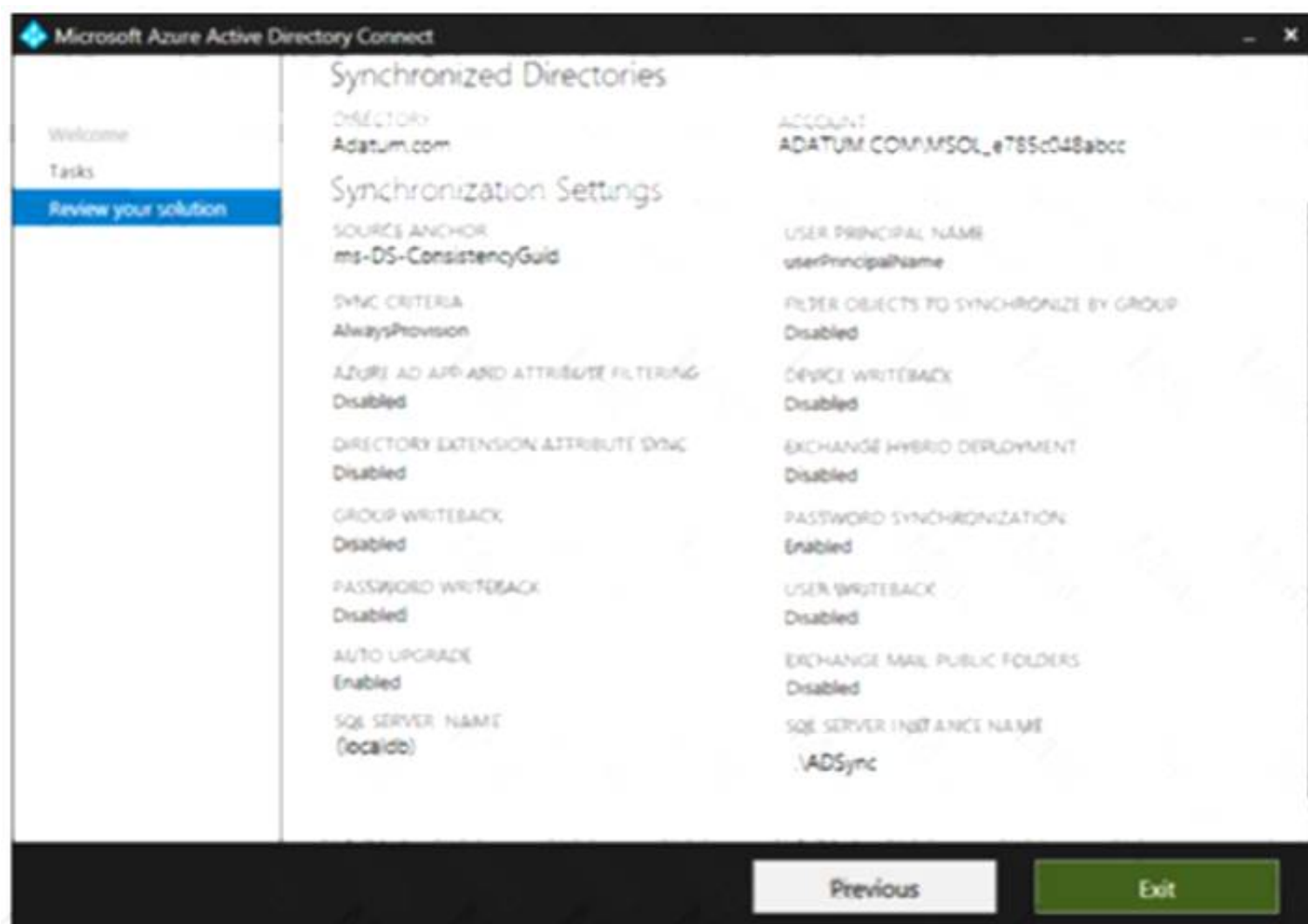

Use the drop-down menus to select the answer choice that completes each statement based on the information presented in the graphic.
 NOTE: Each correct selection is worth one point.

User1 [answer choice].

cannot change her password from any Microsoft portals
can change her password by using self-service password reset feature only
an change her password from the Office 365 admin center only

If the password for User1 is changed in Active Directory, [answer choice].

the password will be synchronized to Azure AD
a new randomly generated password will be assigned to User1
the password in Azure AD will be unchanged

- A. Mastered
- B. Not Mastered

Answer: A

Explanation:

User1 cannot change her password from any Microsoft portals because Password Writeback is disabled in the Azure AD Connect configuration.

If the password for User1 is changed in Active Directory, the password will be synchronized to Azure AD because Password Synchronization is enabled in the Azure AD Connect configuration.

Reference:

<https://docs.microsoft.com/en-us/azure/active-directory/hybrid/how-to-connect-install-custom>

NEW QUESTION 60

- (Exam Topic 5)

You have a Microsoft 365 E5 subscription that uses Microsoft Intune.

You need to access service health alerts from a mobile phone. What should you use?

- A. the Microsoft Authenticator app
- B. the Intune app
- C. the Microsoft 365 Admin mobile app
- D. Intune Company Portal

Answer: A

NEW QUESTION 63

- (Exam Topic 5)

Note: This question is part of a series of questions that present the same scenario. Each question in the series contains a unique solution that might meet the stated goals. Some question sets might have more than one correct solution, while others might not have a correct solution.

After you answer a question in this section, you will NOT be able to return to it. As a result, these questions will not appear in the review screen.

Your company has a Microsoft Office 365 tenant.

You suspect that several Office 365 features were recently updated.

You need to view a list of the features that were recently updated in the tenant. Solution: You use the View service requests option in the Microsoft 365 admin center. Does this meet the goal?

- A. Yes
- B. NO

Answer: B

Explanation:

A service request is a support ticket. Therefore, the View service requests option in the Microsoft 365 admin center displays a list of support tickets. It does not display a list of the features that were recently updated in the tenant so this solution does not meet the goal.

To meet the goal, you need to use Message center in the Microsoft 365 admin center.

Reference:

<https://docs.microsoft.com/en-us/office365/admin/manage/message-center?view=o365-worldwide>

NEW QUESTION 65

- (Exam Topic 5)

You plan to deploy Microsoft Teams to 2,500 users.

You need to estimate the internet bandwidth required for the deployment. What should you use?

- A. Advisor for Teams
- B. Network planner
- C. Skype for Business Server Remote Connectivity Test
- D. Microsoft Remote Connectivity Analyzer

Answer: B

Explanation:

From: <https://docs.microsoft.com/en-us/microsoftteams/network-planner>

Network Planner is a new tool that is available in the Teams admin center. It can be found by going to Planning > Network planner. In just a few steps, the Network Planner can help you determine and organize network requirements for connecting Microsoft Teams users across your organization. When you provide your network details and Teams usage, the Network Planner calculates your network requirements for deploying Teams and cloud voice across your organization's physical locations.

NEW QUESTION 66

- (Exam Topic 5)

Your network contains an on-premises Active Directory domain that syncs to Azure Active Directory (Azure AD).

The on-premises network contains a Microsoft SharePoint Server 2019 farm. The company purchases a Microsoft 365 subscription.

You have the users shown in the following table

Name	Source
User1	Windows Active Directory
User2	Azure Active Directory

You plan to assign User1 and User2 the required roles to run the SharePoint Hybrid Configuration Wizard. User1 will be used for on-premises credentials and User2 will be used for cloud credentials.

You need to assign the correct role to User2. The solution must use the principle of least privilege. Which role should you assign to User2?

- A. Application administrator
- B. SharePoint farm administrator
- C. Global administrator
- D. SharePoint administrator

Answer: C

Explanation:

To run the SharePoint Hybrid Configuration Wizard, you need to provide credentials of a user (in this case User2) of a Global Administrator account in Azure Active Directory.

Reference:

<https://www.c-sharpcorner.com/article/sharepoint-2019-enable-hybrid-experience/> <https://docs.microsoft.com/en-us/sharepoint/hybrid/accounts-needed-for-hybrid-configuration-and-testing>

NEW QUESTION 68

- (Exam Topic 5)

You have a Microsoft 365 subscription.

You view the service advisories shown in the following exhibit.

Home > Service health

Some services have posted advisories 2018-10-05 08:43(UTC) View history

All services	Office 365 Portal	1 advisory
Incidents	SharePoint Online	1 advisory
Advisories	Office Subscription	Service is healthy
	Microsoft Intune	Service is healthy
	Microsoft StaffHub	Service is healthy
	Microsoft Teams	Service is healthy
	Mobile Device Management for Office 365	Service is healthy
	Azure Information Protection	Service is healthy
	Exchange Online	Service is healthy

You need to ensure that users who administer Microsoft SharePoint Online can view the advisories to investigate health issues. Which role should you assign to the users?

- A. SharePoint administrator
- B. Message Center reader
- C. Reports reader
- D. Service administrator

Answer: D

Explanation:

People who are assigned the global admin or service administrator role can view service health. To allow Exchange, SharePoint, and Skype for Business admins to view service health, they must also be assigned the Service admin role. For more information about roles that can view service health.

Reference:

<https://docs.microsoft.com/en-us/office365/enterprise/view-service-health>

NEW QUESTION 73

- (Exam Topic 5)

You have a Microsoft 365 tenant that contains 300 users.

The users have Domestic and International Calling Plan licenses.

What is the maximum user phone numbers and toll-free service phone numbers can you acquire? To answer, select the appropriate options in the answer area.

NOTE: Each correct selection is worth one point.

Number of user phone numbers:

150
300
340
600

Number of toll-free service phone numbers:

20
30
45
65

- A. Mastered
- B. Not Mastered

Answer: A

Explanation:

Graphical user interface, text, application, email Description automatically generated

Reference:

<https://docs.microsoft.com/en-us/microsoftteams/how-many-phone-numbers-can-you-get>

NEW QUESTION 77

- (Exam Topic 5)

You have a Microsoft 365 subscription that uses an Azure Active Directory (Azure AD) tenant named contoso.com.

A temporary employee at your company uses an email address of user1@outlook.com.

You need to ensure that the temporary employee can sign in to contoso.com by using the user1@outlook.com account.

What should you do?

- A. From the Azure Active Directory admin center, create a new user.
- B. From the Microsoft 365 admin center, create a new contact.
- C. From the Azure Active Directory admin center, create a new guest user.
- D. From the Microsoft 365 admin center, create a new user.

Answer: C

Explanation:

You can invite guest users to the directory, to a group, or to an application. After you invite a user through any of these methods, the invited user's account is added to Azure Active Directory (Azure AD), with a user type of Guest. The guest user must then redeem their invitation to access resources. An invitation of a user does not expire.

The invitation will include a link to create a Microsoft account. The user can then authenticate using their Microsoft account. In this question, the external vendor already has a Microsoft account (user1@outlook.com) so he can authenticate using that.

Reference:

<https://docs.microsoft.com/en-us/azure/active-directory/b2b/add-users-administrator>

NEW QUESTION 79

- (Exam Topic 5)

You have a Microsoft 365 subscription

You have an Azure AD tenant that contains the users shown in the following table.

Name	Role
User1	Security administrator
User2	Global administrator
User3	Service support administrator

You configure Tenant properties as shown in the following exhibit

Technical contact: User1@contoso.com ✓

Global privacy contact: [Empty] ✓

Privacy statement URL: http://contoso.com/privacy ✓

Which users will be contacted by Microsoft if the tenant experiences a data breach?

- A. User1 only
- B. User2 only
- C. User3 only
- D. User1 and User2 only
- E. User2 and User3 only

Answer: A

NEW QUESTION 81

- (Exam Topic 5)

You manage multiple devices by using Microsoft Endpoint Manager. The devices run on the following operating systems:

- > Android 8.0, Android 8.1.0, and Android 9
- > iOS 12 and iOS 13
- > MacOS 10.14
- > Windows 10

You need to deploy Microsoft 365 apps to the devices.

From the Microsoft Endpoint Manager admin center, what is the minimum number of apps you should create?

- A. 1
- B. 3
- C. 4
- D. 7

Answer: C

Explanation:

Reference:

<https://docs.microsoft.com/en-us/mem/intune/apps/apps-add>

NEW QUESTION 82

- (Exam Topic 5)

Your network contains an on-premises Active Directory forest named contoso.com. The forest contains the users shown in the following table.

Name	Domain	User UPN suffix
User1	Contoso.com	Fabrikam.com
User2	East.contoso.com	Contoso.com

You create an Azure Active Directory (Azure AD) tenant named fabrikam.onmicrosoft.com.

You plan to sync the users in the forest to fabrikam.onmicrosoft.com by using Azure AD Connect. Which username will be assigned to User1 and User2 in Azure AD after the synchronization? To answer, select the appropriate options in the answer area.

NOTE: Each correct selection is worth one point.

User1:

User1@contoso.com

User1@east.contoso.com

User1@fabrikam.com

User1@fabrikam.onmicrosoft.com

User2:

User2@contoso.com

User2@east.contoso.com

User2@fabrikam.com

User2@fabrikam.onmicrosoft.com

- A. Mastered
- B. Not Mastered

Answer: A

Explanation:

If you added the contoso.com and east.contoso.com domains as custom domains in Microsoft 365, then the users would be assigned their user principle names as Microsoft 365 usernames.

However, the question does not state that you have added the domains as custom domains. Therefore, both users will use the default @fabrikam.onmicrosoft.com domain for their usernames.

NEW QUESTION 86

- (Exam Topic 5)

This question requires that you evaluate the underlined text to determine if it is correct-In Microsoft Word on Windows, before you can sideload a Microsoft Office Add-in, you must first: upload the manifest to Microsoft OneDrive instructions: Review the underlined text. If it makes the statement correct select "No change is needed," If the statement is incorrect select the answer choice that makes the statement correct

- A. No change is needed.
- B. deploy the manifest to an Azure website
- C. publish the manifest to a trusted network location
- D. set Microsoft Edge to Developer Mode

Answer: C

NEW QUESTION 91

- (Exam Topic 5)

Your network contains an on-premises Active Directory forest named contoso.com. The forest contains the following domains:

- > Contoso.com
- > East.contoso.com

The forest contains the users shown in the following table.

Name	UPN suffix
User1	Contoso.com
User2	East.contoso.com
User3	Fabrikam.com

The forest syncs to an Azure Active Directory (Azure AD) tenant named contoso.com as shown in the exhibit. (Click the Exhibit tab.)

PROVISION FROM ACTIVE DIRECTORY



Azure AD Connect cloud provisioning

This feature allows you to manage provisioning from the cloud.

[Manage provisioning \(Preview\)](#)

Azure AD Connect sync

Sync Status	Enabled
Last Sync	Less than 1 hour ago
Password Hash Sync	Disabled

USER SIGN-IN



Federation	Disabled	0 domains
Seamless single sign-on	Enabled	1 domain
Pass-through authentication	Enabled	2 agents

For each of the following statements, select Yes if the statement is true. Otherwise, select No.
NOTE: Each correct selection is worth one point.

Statements	Yes	NO
User1 can authenticate to Azure AD by using a username of user1@contoso.com.	<input type="radio"/>	<input type="radio"/>
User2 can authenticate to Azure AD by using a username of user2@contoso.com.	<input type="radio"/>	<input type="radio"/>
User3 can authenticate to Azure AD by using a username of user3@contoso.com	<input type="radio"/>	<input type="radio"/>

- A. Mastered
- B. Not Mastered

Answer: A

Explanation:

Box 1: Yes

The UPN of user1 is user1@contoso.com so he can authenticate to Azure AD by using the username user1@contoso.com.

Box 2: No

The UPN of user2 is user2@east.contoso.com so he cannot authenticate to Azure AD by using the username user2@contoso.com.

Box 3: No

The UPN of user3 is user3@fabrikam.com so he cannot authenticate to Azure AD by using the username user3@contoso.com.

NEW QUESTION 92

- (Exam Topic 5)

You create a Microsoft 365 Enterprise subscription. You assign licenses for all products to all users.

You need to ensure that all Microsoft Office 365 ProPlus installations occur from a network share. The solution must prevent the users from installing Office 365 ProPlus from the Internet.

Which three actions should you perform? Each correct answer presents part of the solution. NOTE: Each correct selection is worth one point.

- A. From your computer, run setup.exe /download downloadconfig.xml.
- B. Create an XML download file.
- C. From the Microsoft 365 admin center, deactivate the Office 365 licenses for all the users.
- D. From each client computer, run setup.exe /configure installconfig.xml.
- E. From the Microsoft 365 admin center, configure the Software download settings.

Answer: BDE

Explanation:

You can use the Office Deployment Tool (ODT) to download the installation files for Office 365 ProPlus from a local source on your network instead of from the Office Content Delivery Network (CDN).

The first step is to create the configuration file. You can download an XML template file and modify that. The next step to install Office 365 ProPlus is to run the ODT executable in configure mode with a reference to the configuration file you just saved. In the following example, the configuration file is named installconfig.xml. setup.exe /configure installconfig.xml

After running the command, you should see the Office installation start.

To prevent the users from installing Office 365 ProPlus from the Internet, you need to configure the Software download settings (disallow downloads) in the Microsoft 365 admin center.

Reference:

<https://docs.microsoft.com/en-us/deployoffice/overview-of-the-office-2016-deployment-tool#download-the-inst>

NEW QUESTION 97

- (Exam Topic 5)

You create a Microsoft 365 subscription.

You plan to deploy Microsoft Office 365 ProPlus applications to all the client computers at your company. You prepare the following XML file for the planned deployment.

```
<Configuration>
  <Add OfficeClientEdition="32"
    Channel="Broad">
    <Product ID="0365ProPlusRetail">
      <Language ID="en-us" />
    </Product>
  </Add>
  <Updates Enabled="TRUE"
    UpdatePath=""
    Channel="Targeted" />
  <Display Level="None"
    AcceptEULA="TRUE" />
</Configuration>
```

Use the drop-down menus to select the answer choice that completes each statement based on the information presented in the graphic.

NOTE: Each correct selection is worth one point.

Office 365 ProPlus feature updates will be installed [answer choice].

▼
once a month
once every six months
once a year

Office 365 ProPlus security updates will be installed [answer choice].

▼
once a month
every six months in January and July
every six months in March and September

- A. Mastered
- B. Not Mastered

Answer: A

Explanation:

References:

<https://docs.microsoft.com/en-us/deployoffice/configuration-options-for-the-office-2016-deployment-tool#updates> <https://docs.microsoft.com/en-us/deployoffice/overview-of-update-channels-for-office-365-proplus>

NEW QUESTION 102

- (Exam Topic 5)

You have a Microsoft 365 subscription that contains several Microsoft SharePoint Online sites. You discover that users from your company can invite external users to access files on the SharePoint sites. You need to ensure that the company users can invite only authenticated guest users to the sites. What should you do?

- A. From the Microsoft 365 admin center, configure a partner relationship.
- B. From SharePoint Online Management Shell, run the set-SPOSite cmdlet.
- C. From the Azure Active Directory admin center, configure a conditional access policy.
- D. From the SharePoint admin center, configure the sharing settings.

Answer: D

Explanation:

You need to set the Sharing settings to 'Existing Guests'. This setting allows sharing only with guests who are already in your directory. These guests may exist in your directory because they previously accepted sharing invitations or because they were manually added.

Reference:

<https://docs.microsoft.com/en-us/sharepoint/turn-external-sharing-on-or-off>

NEW QUESTION 106

- (Exam Topic 5)

You have a Microsoft 365 subscription.

You create an alert policy as shown in the following exhibit.

Policy1

Edit policy

Delete policy

Status

On

Description

Description

Edit

Severity

Low

Edit

Category

Threat management

Conditions

Activity is Detected malware in file

Edit

Aggregation

Aggregated

Threshold

20 activities

Window

120 minutes

Scope

All users

Email recipients

User1@sk190107outlook.onmicrosoft.com

Daily notification limit

No limit

Edit

Close

Use the drop-down menus to select the answer choice that completes each statement based on the information in the graphic.
 NOTE: Each correct selection is worth one point.

Policy1 will trigger an alert if malware is detected in [answer choice].

Exchange Online only

SharePoint Online only

SharePoint Online or OneDrive only

Exchange Online, SharePoint Online, or OneDrive

The maximum number of email messages that Policy1 will generate per day is [answer choice].

5

12

20

100

- A. Mastered
- B. Not Mastered

Answer: A

Explanation:

The 'Activity is' setting is configured as 'Detected malware in file'. This setting means the policy is applied to files stored in SharePoint or OneDrive. The Aggregation settings has a 120 minute window. This means that if there 20 detections in 120 minutes, an email will be generated. Therefore, the maximum number of emails generated in 24 hours is 12.

Reference:

<https://docs.microsoft.com/en-us/microsoft-365/compliance/alert-policies>

NEW QUESTION 110

- (Exam Topic 5)

You have retention policies in Microsoft 365 as shown in the following table.

Name	Location
Policy1	OneDrive accounts
Policy2	Exchange email, Exchange public folders, Office 365 groups, OneDrive accounts, SharePoint sites

Policy1 is configured as shown in the Policy1 exhibit. (Click the Policy1 tab.)

Policy1

Decide if you want to retain content, delete it, or both

Do you want to retain content? ⓘ

☐ Yes, I want to retain it ⓘ

For this long... 7 years

☒ No, just delete content that's older than ⓘ

1 years

Delete the content based on when it was created ⓘ

Need more options?

☐ Use advanced retention settings ⓘ

Back

Next

Cancel

Policy1 is configured as shown in the Policy2 exhibit. (Click the Policy2 tab.)

Policy2

Decide if you want to retain content, delete it, or both

Do you want to retain content? ⓘ

☒ Yes, I want to retain it ⓘ

For this long... 4 years

Retain the content based on when it was created ⓘ

Do you want us to delete it after this time? ⓘ

☐ Yes ☒ No

☐ No, just delete content that's older than ⓘ

2 years

Need more options?

☐ Use advanced retention settings ⓘ

Back

Next

Cancel

For each of the following statements, select Yes if the statement is true. Otherwise, select No.

NOTE: Each correct selection is worth one point.

Statements	Yes	No
If a user creates a file in Microsoft OneDrive on January 1, 2018, users will be able to access the file on January 15, 2020	<input type="radio"/>	<input type="radio"/>
If a user deletes a Microsoft OneDrive file that was created on January 1, 2018, and administrator will be able to recover the file on April 15, 2020.	<input type="radio"/>	<input type="radio"/>
If a user deletes a Microsoft OneDrive file that was created on January 1, 2018, an administrator will be able to recover the file on April 15, 2023.	<input type="radio"/>	<input type="radio"/>

- A. Mastered
 B. Not Mastered

Answer: A

Explanation:

> Retention wins over deletion. Suppose that one retention policy says to delete Exchange email after three years, but another retention policy says to retain Exchange email for five years and then delete it. Any content that reaches three years old will be deleted and hidden from the users' view, but still retained in the Recoverable Items folder until the content reaches five years old, when it is permanently deleted.

> The longest retention period wins. If content is subject to multiple policies that retain content, it will be retained until the end of the longest retention period.

Box 1: No.

The file will be deleted and hidden from the users' view, but still retained in the Recoverable Items folder. An administrator would need to recover the file.

Box 2: Yes.

The file will be deleted and hidden from the users' view, but still retained in the Recoverable Items folder. An administrator will be able to recover the file.

Box 3: Yes.

2018 to 2023 is five years. Policy2 has a retention period of four years. However, Policy2 is configured to not delete the files after the four-year retention period.

Reference:

<https://docs.microsoft.com/en-us/office365/securitycompliance/retention-policies#the-principles-of-retention-or>

NEW QUESTION 114

- (Exam Topic 5)

You need to develop a leave request app that will use Microsoft Outlook and adaptive cards. The leave requests of an employee will be sent as an actionable message to the employee's managers. When one of the managers performs an action on the actionable message, the other managers must see only the updated message and the action performed by the manager.

How should you complete the adaptive card JSON? To answer, select the appropriate options in the answer area.

NOTE: Each correct selection is worth one point.

Answer Area

```
{
  "$schema": "http://adaptivecards.io/schemas/adaptive-card.json",
  "type": "AdaptiveCard",
  "version": "1.0",
  ...
  "actions": [
    {
      "type": "Action.Submit",
      "title": "Submit",
      "url": "https://actionablemessages.contoso.com/api/getupdatedcard",
      "body": "",
      "type": "Action.Http"
    }
  ]
}
```

- A. Mastered
 B. Not Mastered

Answer: A

Explanation:

Graphical user interface, text, application, email Description automatically generated

Box 1: "autoInvokeAction": {

With the autoInvokeAction property on actionable messages, you can provide an HTTP endpoint to retrieve an up-to-date Adaptive Card payload with the latest information when the user opens the email in Outlook.

Box 2: "method": "POST",

With the autoInvokeAction property on actionable messages, you can provide an HTTP endpoint to retrieve an up-to-date Adaptive Card payload with the latest information when the user opens the email in Outlook.

Reference:

<https://docs.microsoft.com/en-us/outlook/actionable-messages/auto-invoke>

NEW QUESTION 118

- (Exam Topic 5)

You have a Microsoft 365 subscription that contains a guest user named User1. User1 is assigned the User administrator role.

You have a Microsoft Azure Active Directory (Azure AD) tenant named contoso.com. Contoso.com is configured as shown in the following exhibit.

External collaboration settings

Save

Discard

Guest users permissions are limited ⓘ

Yes

No

Admins and users in the guest inviter role can invite ⓘ

Yes

No

Members can invite ⓘ

Yes

No

Guests can invite ⓘ

Yes

No

Collaboration restrictions

☒ Allow invitations to be sent to any domain (most inclusive)
☐ Deny invitations to the specified domains
☐ Allow invitations only to the specified domains (most restrictive)

Use the drop-down menus to select the answer choice that completes each statement based on the information presented in the graphic.

NOTE: Each correct selection is worth one point.

User1 can [answer choice].

open the Azure portal only

open the Azure portal and view users only

open the Azure portal, view users, and create new guest users only

open the Azure portal, view users, create new users, and create new guest users

All other guest users can [answer choice].

open the Azure portal only

open the Azure portal and view users only

open the Azure portal, view users, and create new guest users only

open the Azure portal, view users, create new users, and create new guest users

- A. Mastered
 B. Not Mastered

Answer: A

Explanation:

Default permissions for guests are restrictive by default. Guests can be added to administrator roles, which grant them full read and write permissions contained in the role. There is one additional restriction available, the ability for guests to invite other guests. Setting Guests can invite to No prevents guests from inviting other guests.

User1 is assigned the User Administrator role. Therefore, User1 can open the Azure portal, view users, create new users, and create new guest users.

In the exhibit, the 'Guest user permissions are limited' is set to no. This means that guest users have the same permissions as members. However, the 'Guests can invite' setting is set to No. Therefore, other guest users (all guest users except User1) can open the Azure portal and view users in the same way as member users can.

Reference:

<https://docs.microsoft.com/en-us/azure/active-directory/b2b/delegate-invitations> <https://docs.microsoft.com/en-us/azure/active-directory/fundamentals/users-default-permissions>

NEW QUESTION 120

- (Exam Topic 5)

Your company has a Microsoft Azure Active Directory (Azure AD) directory tenant named contoso.onmicrosoft.com.

All users have client computers that run Windows 10 Pro and are joined to Azure AD. The company purchases a Microsoft 365 E3 subscription.

You need to upgrade all the computers to Windows 10 Enterprise. The solution must minimize administrative effort.

You assign licenses from the Microsoft 365 admin center. What should you do next?

- A. Add a custom domain name to the subscription.
 B. Deploy Windows 10 Enterprise by using Windows Autopilot.
 C. Create provisioning package, and then deploy the package to all the computers.

D. Instruct all the users to log off of their computer, and then to log in again.

Answer: B

Explanation:

With Windows Autopilot the user can set up pre-configure devices without the need consult their IT administrator.

Reference:

<https://docs.microsoft.com/en-us/windows/deployment/windows-10-deployment-scenarios> <https://docs.microsoft.com/en-us/windows/deployment/windows-autopilot/windows-autopilot>

NEW QUESTION 124

- (Exam Topic 5)

Note: This question is part of a series of questions that present the same scenario. Each question in the series contains a unique solution that might meet the stated goals. Some question sets might have more than one correct solution, while others might not have a correct solution.

After you answer a question in this section, you will NOT be able to return to it. As a result, these questions will not appear in the review screen.

Your network contains an Active Directory domain named contoso.com that is synced to Microsoft Azure Active Directory (Azure AD).

You manage Windows 10 devices by using Microsoft System Center Configuration Manager (Current Branch).

You configure a pilot for co-management.

You add a new device named Device1 to the domain. You install the Configuration Manager client on Device1.

You need to ensure that you can manage Device1 by using Microsoft Intune and Configuration Manager. Solution: You add Device1 to an Active Directory group. Does this meet the goal?

A. Yes

B. No

Answer: B

Explanation:

Device1 has the Configuration Manager client installed so you can manage Device1 by using Configuration Manager.

To manage Device1 by using Microsoft Intune, the device has to be enrolled in Microsoft Intune. In the Co-management Pilot configuration, you configure a Configuration Manager Device Collection that determines which devices are auto-enrolled in Microsoft Intune. You need to add Device1 to the Device Collection, not an Active Directory Group. Therefore, this solution does not meet the requirements.

Reference:

<https://docs.microsoft.com/en-us/configmgr/comanage/how-to-enable>

NEW QUESTION 126

- (Exam Topic 5)

Note: This question is part of a series of questions that present the same scenario. Each question in the series contains a unique solution that might meet the stated goals. Some question sets might have more than one correct solution, while others might not have a correct solution.

After you answer a question in this section, you will NOT be able to return to it. As a result, these questions will not appear in the review screen.

Your network contains an on-premises Active Directory forest named contoso.com. The forest contains the following domains:

➤ Contoso.com

➤ East.contoso.com

An Azure AD Connect server is deployed to contoso.com. Azure AD Connect syncs to an Azure Active Directory (Azure AD) tenant.

You deploy a new domain named west.contoso.com to the forest.

You need to ensure that west.contoso.com syncs to the Azure AD tenant.

Solution: You install a new Azure AD Connect server in west.contoso.com and set AD Connect to staging mode.

Does this meet the goal?

A. Yes

B. No

Answer: B

NEW QUESTION 127

- (Exam Topic 5)

You have a Microsoft 365 subscription. You add a domain named contoso.com.

When you attempt to verify the domain, you are prompted to send a verification email to admin@contoso.com.

D18912E1457D5D1DDCBD40AB3BF70D5D

You need to change the email address used to verify the domain. What should you do?

A. From the domain registrar, modify the contact information of the domain

B. Add a TXT record to the DNS zone of the domain

C. Modify the NS records for the domain

D. From the Microsoft 365 admin center, change the global administrator of the Microsoft 365 subscription

Answer: A

Explanation:

The email address that is used to verify that you own the domain is the email address listed with the domain registrar for the registered contact for the domain.

Reference:

<https://docs.microsoft.com/en-us/microsoft-365/admin/setup/add-domain?view=o365-worldwide>

NEW QUESTION 128

- (Exam Topic 5)

Your Network contains an on-premises Active Directory domain named contoso.local. The domain contains five domain controllers.

Your company purchases Microsoft 365 and creates a Microsoft Anne Active Directory (Azure AD) tenant named .contoso.onmicrosoft.com.

You plan to implement pass-through authentication.

You need to prepare the environment for the planned implementation of pass-through authentication. Which three actions should you perform? Each correct answer presents pan of the solution.

NOTE: Each correct selection is worth one point.

- A. Modify the email address attribute for each user account.
- B. From the Azure portal, add a custom domain name.
- C. From Active Directory Domains and Trusts, add a UPN suffix.
- D. Modify the User logon name for each user account.
- E. From the Azure portal, configure an authentication method.
- F. From a domain controller, install an authentication Agent.

Answer: BCF

Explanation:

To implement pass-through authentication, you need to install and configure Azure AD Connect.

The on-premise Active Directory domain is named contoso.local. Before you can configure Azure AD Connect, you need to purchase a routable domain, for example, contoso.com.

You then need to add the domain contoso.com to Microsoft as a custom domain name.

The user accounts in the Active Directory domain need to be configured to use the domain name contoso.com as a UPN suffix. You need to add contoso.com to the Active Directory first by using Active Directory Domains and Trusts to add contoso.com add a UPN suffix. You can then configure each account to use the new UPN suffix.

An Authentication Agent is required on a domain controller to perform the authentication when pass-through authentication is used. When the custom domain and user accounts are configured, you can install and configure Azure AD Connect. An Authentication Agent is installed when you select the pass-through authentication option in the Azure AD Connect configuration or you can install the Authentication Agent manually.

Reference:

<https://docs.microsoft.com/en-us/azure/active-directory/hybrid/how-to-connect-pta-quick-start>

NEW QUESTION 129

- (Exam Topic 5)

Your company has a Microsoft Azure Active Directory (Azure AD) tenant named contoso.onmicrosoft.com that contains a user named User1.

You suspect that an imposter is signing in to Azure AD by using the credentials of User1.

You need to ensure that an administrator named Admin1 can view all the sign in details of User1 from the past 24 hours.

To which three roles should you add Admin1? Each correct answer presents a complete solution. NOTE: Each correct selection is worth one point.

- A. Security administrator
- B. Password administrator
- C. User administrator
- D. Compliance administrator
- E. Reports reader
- F. Security reader

Answer: AEF

Explanation:

Users in the Security Administrator, Security Reader, Global Reader, and Report Reader roles can view the sign in details.

Reference:

<https://docs.microsoft.com/en-us/azure/active-directory/reports-monitoring/concept-sign-ins>

NEW QUESTION 130

- (Exam Topic 5)

You have an app that uses the Microsoft Graph API. The app will perform the following actions m sequence:

- Update a user's city to Redmond.
- Retrieve the current user s profile.

You need to implement batching for the app

Which HTTP methods should you use in the batch request? To answer, select the appropriate options in the answer area

NOTE: Each correct selection is worth one point.

Answer Area



- A. Mastered
- B. Not Mastered

Answer: A

Explanation:

Answer Area



NEW QUESTION 133

- (Exam Topic 5)

Note: This question is part of a series of questions that present the same scenario. Each question in the series contains a unique solution that might meet the stated goals. Some question sets might have more than one correct solution, while others might not have a correct solution.

After you answer a question in this section, you will NOT be able to return to it. As a result, these questions will not appear in the review screen.

Your company has 3,000 users. All the users are assigned Microsoft 365 E3 licenses.

Some users are assigned licenses for all Microsoft 365 services. Other users are assigned licenses for only certain Microsoft 365 services.

You need to determine whether a user named User1 is licensed for Exchange Online only. Solution: You launch the Azure portal, and then review the Licenses blade.

Does this meet the goal?

- A. Yes
- B. No

Answer: A

Explanation:

In the Licenses blade, click All Products then select the E3 License. This will display a list of all users assigned an E3 license. Select User1. You'll see how many services are assigned in the Enabled Services column. Click on the number in the Enabled Services column for User1 and you'll be taken to the licenses page for that user. Click on the number in the Enabled Services column for User1 again and a page will open which shows you exactly which services are enabled or disabled.

Alternatively, you can go into the user account properties directly then select Licenses. This will display the licenses blade for that user. You can then click on the number in the Enabled Services column for the user and a page will open which shows you exactly which services are enabled or disabled.

NEW QUESTION 137

- (Exam Topic 5)

You have a Microsoft 365 tenant that contains a Microsoft SharePoint Online site named Projects. You need to get a list of documents in the Documents library by using the Microsoft Graph API. How should you complete the query? To answer, select the appropriate options in the answer area.

NOTE: Each correct selection is worth one point.

Answer Area



- A. Mastered
- B. Not Mastered

Answer: A

Explanation:

Answer Area



NEW QUESTION 139

- (Exam Topic 5)

You have a Microsoft 365 E5 subscription.

Users have Android or iOS devices and access Microsoft 365 resources from computers that run Windows 11 or MacOS. You need to implement passwordless authentication. The solution must support all the devices. Which authentication method should you use?

- A. Windows Hello
- B. Microsoft Authenticator app
- C. FIDO2 compliant security keys

Answer: A

NEW QUESTION 140

- (Exam Topic 5)
You have a Microsoft 365 Enterprise subscription.
You create a password policy as shown in the following exhibit.

Search (Ctrl+J)

MANAGE

Password protection (Preview)

Save Discard

Custom smart lockout

Lockout threshold 5

Lockout duration in seconds 60

Custom banned passwords

Enforce custom list Yes No

Custom banned password list

Pa\$\$w0rd
Conto\$01
AzureAD!!

Password protection for Windows Server Active Directory

Enable password protection on Windows Server Active Directory Yes No

Mode Enforced Audit

Use the drop-down menus to select the answer choice that completes each statement based on the information presented in the graphic.
NOTE: Each correct selection is worth one point.

If users are locked out of their account, they have [answer choice].

five sign-in attempts each subsequent minute
one sign-in attempt each subsequent minute
five sign-in attempts every five minutes
one sign-in attempt every five minutes

Users can create a password of [answer choice].

Password11
Conto\$01Pa\$\$word
AzureAD!!111
pa\$\$w0rd

- A. Mastered
- B. Not Mastered

Answer: A

Explanation:

By default, smart lockout locks the account from sign-in attempts for one minute after 10 failed attempts. In this question, the lockout threshold if 5 failed attempts. The account locks again after each subsequent failed sign-in attempt, for one minute at first and longer in subsequent attempts. Password evaluation goes through several steps including normalization and Substring matching which is used on the normalized password to check for the user's first and last name as well as the tenant name. The next step is to identify all instances of banned passwords in the user's normalized new password. Then: ➤ Each banned password that is found in a user's password is given one point. ➤ Each remaining unique character is given one point. ➤ A password must be at least five (5) points for it to be accepted. Conto\$01Pa\$\$word contains two banned passwords and no remaining unique characters so is given a score of 2 points. This is less than the required 5 points so will be rejected. Pa\$\$w0rd contains a banned password and no remaining unique characters so is given a score of 1 point. This is less than the required 5 points so will be rejected. AzureAD!!111 contains a banned password (AzureAD!!) and has three remaining characters. However, the remaining characters are all the same (they're all 1s) so that is only one unique character. So that password will be given a score of 2. One for the banned password and 1 for the unique character. This is less than the required 5 points so will be rejected.

Password11 does not contain a banned password. Password11 contains 10 characters. However, there are two 's' and two '1' so there are 8 unique characters. Therefore, the password will be given a score of 8 points. This is more than the required 5 points so the password will be accepted.

Reference:

<https://docs.microsoft.com/en-us/azure/active-directory/authentication/concept-password-ban-bad> <https://docs.microsoft.com/en-us/azure/active-directory/authentication/howto-password-smart-lockout>

NEW QUESTION 145

- (Exam Topic 5)

Your network contains an on-premises Active Directory domain named Contoso.com.

Your company purchases a Microsoft 365 subscription and establishes a hybrid deployment of Azure Directory (Azure AD) by using password hash synchronization.

You create a new user User10 on-premises and a new user named User20 in Azure AD. You need to identify where an administrator can reset the password of each new user. What should you identify? To answer select the appropriate option in the answer area. NOTE: Each correct selection is worth one point.

User10:

Azure AD only
 On-premises Active Directory only
 On-premises Active Directory or Azure AD

User20:

Azure AD only
 On-premises Active Directory only
 On-premises Active Directory or Azure AD

- A. Mastered
- B. Not Mastered

Answer: A

Explanation:

If a user account is created in the on-premise Active Directory and synchronized to Azure Active Directory, you can reset the password of the user account in the on-premise Active Directory only.

If a user account is created in Azure Active Directory, you can reset the password of the user account in the Azure Active Directory only.

NEW QUESTION 147

- (Exam Topic 5)

Please wait while the virtual machine loads. Once loaded, you may proceed to the lab section. This may take a few minutes, and the wait time will not be deducted from your overall test time.

When the Next button is available, click it to access the lab section. In this section, you will perform a set of tasks in a live environment. While most functionality will be available to you as it would be in a live environment, some functionality (e.g., copy and paste, ability to navigate to external websites) will not be possible by design.

Scoring is based on the outcome of performing the tasks stated in the lab. In other words, it doesn't matter how you accomplish the task, if you successfully perform it, you will earn credit for that task.

Labs are not timed separately, and this exam may have more than one lab that you must complete. You can use as much time as you would like to complete each lab. But, you should manage your time appropriately to ensure that you are able to complete the lab(s) and all other sections of the exam in the time provided.

Please note that once you submit your work by clicking the Next button within a lab, you will NOT be able to return to the lab.

You may now click next to proceed to the lab. Lab information

Use the following login credentials as needed:

To enter your username, place your cursor in the Sign in box and click on the username below.

To enter your password, place your cursor in the Enter password box and click on the password below.

Microsoft 365 Username:

admin@M365x981607.onmicrosoft.com

Microsoft 365 Password: *yfLo7lr2&y

If the Microsoft 365 portal does not load successfully in the browser, press CTRL-K to reload the portal in a new browser tab.

The following information is for technical support purposes only:

Lab Instance: 10811525

You plan to migrate data from an on-premises email system to your Microsoft 365 tenant. You need to ensure that Debra Berger can import a PST file.

- A. Mastered
- B. Not Mastered

Answer: A

Explanation:

Debra will need the Mailbox Import Export and Mail Recipients roles to be able to import PST files. These roles cannot be assigned directly to a user account. The way to assign just those two roles to a user is to create a new role group, assign the roles to the role group and add the user as a member.

- * 1. Go to the Exchange admin center.
- * 2. Select Permissions.
- * 3. In the Admin roles section, click the plus (+) sign to create a new role.
- * 4. Give the role group a name such as PST Import.
- * 5. In the roles section, click the plus (+) sign.

- * 6. Select the Mailbox Import Export and Mail Recipients roles and click Add to add the roles.
- * 7. In the Members section, click the plus (+) sign.
- * 8. Select Debra Berger then click Add then Ok to add Debra as a member of the new role group.
- * 9. Click the Save button to save the new role group.

NEW QUESTION 149

- (Exam Topic 5)

Note: This question is part of a series of questions that present the same scenario. Each question in the series contains a unique solution that might meet the stated goals. Some question sets might have more than one correct solution, while others might not have a correct solution.

After you answer a question in this section, you will NOT be able to return to it. As a result, these questions will not appear in the review screen.

You have a Microsoft 365 subscription.

You need to prevent users from accessing your Microsoft SharePoint Online sites unless the users are connected to your on-premises network.

Solution: From the Device Management admin center, you a trusted location and compliance policy. Does this meet the goal?

- A. Yes
- B. No

Answer: B

Explanation:

Conditional Access in SharePoint Online can be configured to use an IP Address white list to allow access. References:

<https://techcommunity.microsoft.com/t5/Microsoft-SharePoint-Blog/Conditional-Access-in-SharePoint-Onlinea>

NEW QUESTION 152

- (Exam Topic 5)

Please wait while the virtual machine loads. Once loaded, you may proceed to the lab section. This may take a few minutes, and the wait time will not be deducted from your overall test time.

When the Next button is available, click it to access the lab section. In this section, you will perform a set of tasks in a live environment. While most functionality will be available to you as it would be in a live environment, some functionality (e.g., copy and paste, ability to navigate to external websites) will not be possible by design.

Scoring is based on the outcome of performing the tasks stated in the lab. In other words, it doesn't matter how you accomplish the task, if you successfully perform it, you will earn credit for that task.

Labs are not timed separately, and this exam may have more than one lab that you must complete. You can use as much time as you would like to complete each lab. But, you should manage your time appropriately to ensure that you are able to complete the lab(s) and all other sections of the exam in the time provided.

Please note that once you submit your work by clicking the Next button within a lab, you will NOT be able to return to the lab.

You may now click next to proceed to the lab. Lab information

Use the following login credentials as needed:

To enter your username, place your cursor in the Sign in box and click on the username below.

To enter your password, place your cursor in the Enter password box and click on the password below.

Microsoft 365 Username: admin@LODSe426243.onmicrosoft.com Microsoft 365 Password: 3&YWYjse-6-d

If the Microsoft 365 portal does not load successfully in the browser, press CTRL-K to reload the portal in a new browser tab.

The following information is for technical support purposes only:

Lab Instance: 10887751

You need to create a group named Group2. Users who are added to Group2 must be licensed automatically for Microsoft Office 365.

- A. Mastered
- B. Not Mastered

Answer: A

Explanation:

You need to create the group and assign a license to the group. Anyone who is added to the group will automatically be assigned the license that is assigned to the group.

- * 1. Go to the Azure Active Directory admin center.
- * 2. Select the Azure Active Directory link then select Groups.
- * 3. Click the New Group link.
- * 4. Select 'Security' as the group type and enter 'Group2' for the group name.
- * 5. Click the Create button to create the group.
- * 6. Back in the Groups list, select Group2 to open the properties page for the group.
- * 7. Select 'Licenses'.
- * 8. Select the '+ Assignments' link.
- * 9. Tick the box to select the license.
- * 10. Click the Save button to save the changes. References:

<https://docs.microsoft.com/en-us/azure/active-directory/users-groups-roles/licensing-groups-assign>

NEW QUESTION 157

- (Exam Topic 5)

You have a Microsoft 365 E5 subscription that uses Endpoint security.

You need to create a group and assign the Endpoint Security Manager role to the group, Which type of group can you use?

- A. Microsoft 365 only
- B. distribution, mail-enabled security
- C. Microsoft 365 and security
- D. security only
- E. mail-enabled security and security only
- F. mail-enabled security, Microsoft 365. and security only

Answer: E

NEW QUESTION 159

- (Exam Topic 5)

Your company has a Microsoft 365 subscription. All identities are managed in the cloud. The company purchases a new domain name. You need to ensure that all new mailboxes use the new domain as their primary email address. What are two possible ways to achieve the goal? Each correct answer presents a complete solution. NOTE: Each correct selection is worth one point.

- A. From Microsoft Exchange Online PowerShell, run the Update-EmailAddressPolicy policy command.
- B. From the Exchange admin center, click mail flow, and then configure the email address policies.
- C. From the Microsoft 365 admin center, click Setup, and then configure the domains.
- D. From Microsoft Exchange Online PowerShell, run the Set-EmailAddressPolicy policy command.
- E. From the Azure Active Directory admin center, configure the custom domain names.

Answer: BD

Explanation:

Email address policies define the rules that create email addresses for recipients in your Exchange organization whether this is Exchange on-premise or Exchange online.

You can configure email address policies using the graphical interface of the Exchange Admin Center or by using PowerShell with the Set-EmailAddressPolicy cmdlet.

The Set-EmailAddressPolicy cmdlet is used to modify an email address policy. The Update-EmailAddressPolicy cmdlet is used to apply an email address policy to users.

Reference:

<https://docs.microsoft.com/en-us/exchange/email-addresses-and-address-books/email-address-policies/email-add>

NEW QUESTION 164

- (Exam Topic 5)

You have a Microsoft 365 subscription that contains the users shown in the following table.

Name	Role
User1	Helpdesk admin
User2	Global Administrator
User3	None
User4	None
User5	None

The subscription contains the groups shown in the following table.

Name	Type	Members
Group1	Microsoft 365	User2, User3
Group2	Mail-enabled security	User1, Group3
Group3	Distribution list	User4, User5

You deploy an app as shown in the following exhibit

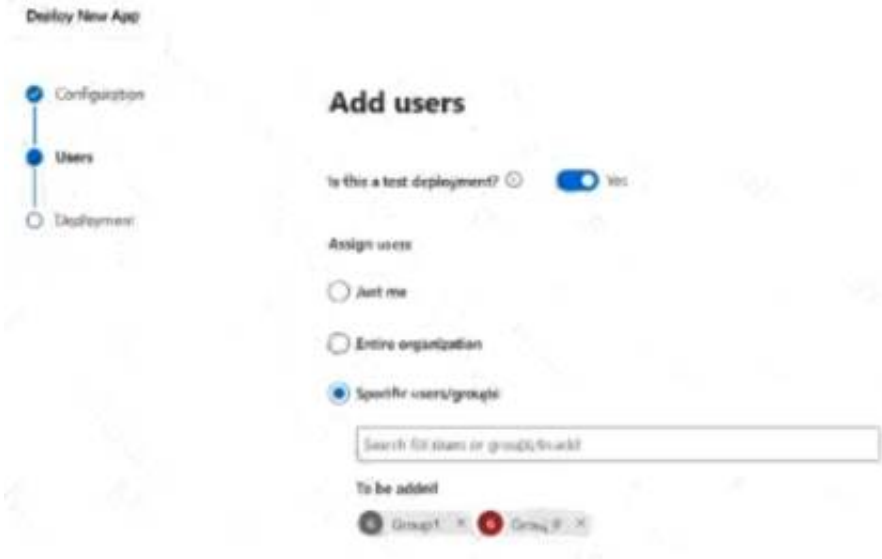

For each of the following statements, select Yes if the statement is true. Otherwise select No.

Statements	Yes	No
User1 can modify the app deployment.	<input type="radio"/>	<input type="radio"/>
User2 will receive the app.	<input type="radio"/>	<input type="radio"/>
User4 will receive the app.	<input type="radio"/>	<input type="radio"/>

- A. Mastered
- B. Not Mastered

Answer: A

Explanation:

Statements	Yes	No
User1 can modify the app deployment.	<input type="radio"/>	<input checked="" type="radio"/>
User2 will receive the app.	<input checked="" type="radio"/>	<input type="radio"/>
User4 will receive the app.	<input type="radio"/>	<input checked="" type="radio"/>

NEW QUESTION 165

- (Exam Topic 5)

You have a Microsoft 365 subscription. All users have client computers that run Windows 10 and have Microsoft Office 365 ProPlus installed.

Some users in the research department work for extended periods of time without an Internet connection. How many days can the research department users remain offline before they are prevented from editing Office documents?

- A. 10
- B. 30
- C. 90
- D. 120

Answer: B

Explanation:

After 30 days, Microsoft Office 365 ProPlus will go into reduced functionality mode. When this happens, users will be able to open files but they won't be able to edit them.

As part of the installation process, Office 365 ProPlus communicates with the Office Licensing Service and the Activation and Validation Service to obtain and activate a product key. Each day, or each time the user logs on to their computer, the computer connects to the Activation and Validation Service to verify the license status and extend the product key. As long as the computer can connect to the Internet at least once every 30 days, Office remains fully functional. If the computer goes offline for more than 30 days, Office enters reduced functionality mode until the next time a connection can be made.

Reference:

<https://docs.microsoft.com/en-us/deployoffice/overview-of-licensing-and-activation-in-office-365-proplus>

NEW QUESTION 167

- (Exam Topic 5)

Your network contains an Active Directory domain named contoso.com. You have a Microsoft 365 subscription.

You have a Microsoft Azure Active Directory (Azure AD) tenant named contoso.onmicrosoft.com. You implement directory synchronization.

The developers at your company plan to build an app named App1. App1 will connect to the Microsoft Graph API to provide access to several Microsoft Office 365 services.

You need to provide the URI for the authorization endpoint that App1 must use. What should you provide?

- A. <https://login.microsoftonline.com/>
- B. <https://contoso.com/contoso.onmicrosoft.com/app1>
- C. <https://login.microsoftonline.com/contoso.onmicrosoft.com/>
- D. <https://myapps.microsoft.com>

Answer: C

Explanation:

In a single tenant application, sign-in requests are sent to the tenant's sign-in endpoint. For example, for contoso.onmicrosoft.com the endpoint would be:

<https://login.microsoftonline.com/contoso.onmicrosoft.com>. Requests sent to a tenant's endpoint can sign in users (or guests) in that tenant to applications in that tenant.

Reference:

<https://docs.microsoft.com/en-us/azure/active-directory/develop/howto-convert-app-to-be-multi-tenant>

NEW QUESTION 168

- (Exam Topic 5)

You have a Microsoft 365 subscription that contains the domains shown in the following exhibit.

Contoso 1919
Dark mode
The new admin center

Domains

+ Add domain
Set as default
Manage DNS
1 selected x
Search
Filter

Domain name	Status	Choose columns
Sub1.Contoso1919.onmicrosoft.com (Default)	Possible service issues	
Contoso.com	Incomplete setup	
Contoso1919.onmicrosoft.com	Healthy	
Sub2.Contoso1919.onmicrosoft.com	Healthy	

Which domain name suffixes can you use when you create users?

- A. only Sub1.Contoso1919.onmicrosoft.com
- B. only Contoso1919.onmicrosoft.com and Sub2.Contoso1919.onmicrosoft.com
- C. only Contoso1919.onmicrosoft.com, Sub1.Contoso1919.onmicrosoft.com, and Sub2.Contoso1919.onmicrosoft.com
- D. all the domains in the subscription

Answer: C

NEW QUESTION 172

- (Exam Topic 5)

You have a Microsoft 365 E5 subscription linked to an Azure Active Directory (Azure AD) tenant named contoso.onmicrosoft.com. You plan to import the Microsoft Power Platform Center of Excellence (CoE) Starter Kit You need to configure the HTTP with Azure AD connection. Which base resource URL should you use?

- A. <https://graph.microsoft.com>
- B. <https://login.microsoftonline.com/contoso.onmicrosoft.com>
- C. <https://contoso.onmicrosoft.com>
- D. <https://login.microsoftonline.com/common/v2.0/oauth2/token>

Answer: B

NEW QUESTION 175

- (Exam Topic 5)

Your company has two offices. The offices are located in Seattle and New York. The company uses a third-party email system.

You implement Microsoft 365.

You move all the users in the Seattle office to Exchange Online. You configure Microsoft 365 to successfully receive all the email messages sent to the Seattle office users.

All the users in the New York office continue to use the third-party email system. The users use the email domains shown in the following table.

Users in	Email domain
Seattle	Contoso.com
New York	Adatum.com

You need to ensure that all the email messages sent to the New York office users are delivered successfully. The solution must ensure that all the email messages for the users in both offices are routed through Microsoft 365.

You create the required DNS records and Send connectors. What should you do next from Microsoft 365?

- A. From Microsoft 365 admin center, set the default domain
- B. From the Exchange admin center, create a transport rule for all the email messages sent to adatum.com.
- C. From Microsoft 365 admin center, add the adatum.com domain
- D. From the Exchange admin center, configure adatum.com as an internal relay domain.
- E. From Microsoft 365 admin center, add the adatum.com domain
- F. From the Exchange admin center, configure adatum.com as an authoritative domain.
- G. From Microsoft 365 admin center, set the default domain
- H. From the Exchange admin center, configure adatum.com as a remote domain.

Answer: B

Explanation:

The first step is to configure Exchange Online to accept emails for the adatum.com domain. To do this, we add the domain in Microsoft 365. When you add your domain to Microsoft 365, it's called an accepted domain.

The next step is to tell Exchange Online what to do with those emails. You need to configure the adatum.com domain as either an authoritative domain or an internal relay domain.

Authoritative domain means that the mailboxes for that domain are hosted in Office 365. In this question, the mailboxes for the adatum.com domain are hosted on the third-party email system. Therefore, we need to configure the adatum.com domain as an internal relay domain. For an internal relay domain, Exchange Online will receive the email for the adatum.com domain and then 'relay' (forward) the email on to the third-party email server.

References:

<https://docs.microsoft.com/en-us/exchange/mail-flow-best-practices/manage-accepted-domains/manage-accepted-domains>

NEW QUESTION 179

- (Exam Topic 5)

You have an on-premises Microsoft Exchange Server organization that contains 500 mailboxes and a third-party email archive solution.

You have a Microsoft 365 tenant that contains a user named User1.

You plan to use the User1 account to perform a PST import of the archive mailboxes to the tenant. Which two roles does User1 require to perform the import? The solution must use the principle of least privilege. Each correct answer presents part of the solution.

NOTE: Each correct selection is worth one point.

- A. Mail Recipients
- B. Exchange admin
- C. Records Management
- D. Mailbox Import Export
- E. eDiscovery Manager

Answer: AD

Explanation:

Reference:

<https://docs.microsoft.com/en-us/microsoft-365/compliance/importing-pst-files-to-office-365?view=o365-world>

NEW QUESTION 181

- (Exam Topic 5)

Your company has a Microsoft 365 subscription.

Your plan to add 100 newly hired temporary users to the subscription next week. You create the user accounts for the new users.

You need to assign licenses to the new users. Which command should you run?

- A.

```
$NewStaff = Get-AzureADUser -All -Department "Temp" -UsageLocation "";  
$NewStaff | foreach {Set-AzureADUser -LicenseOptions "contoso:ENTERPRISEPACK"}
```
- B.

```
$NewStaff = Get-AzureADUser -All -Department "Temp" -UsageLocation "US" -UnlicensedUsersOnly;  
$NewStaff | foreach {Set-AzureADUserLicense -AddLicenses "contoso:ENTERPRISEPACK"}
```
- C.

```
$NewStaff = Get-AzureADUser -All -Department "Temp" -UsageLocation "";  
$NewStaff | foreach {Set-AzureADUserLicense -LicenseOptions "contoso:ENTERPRISEPACK"}
```
- D.

```
$NewStaff = Get-AzureADUser -All -Department "Temp" -UsageLocation "US" -UnlicensedUsersOnly;  
$NewStaff | foreach {Set-AzureADUser -AddLicenses "contoso:ENTERPRISEPACK"}
```

- A. Option A
- B. Option B
- C. Option C
- D. Option D

Answer: B

Explanation:

The first line gets all users from the Temp department that have a UsageLocation assigned and stores them in the \$NewStaff variable. You cannot use PowerShell to assign a license to a user that does not have a UsageLocation configured.

The second line adds the licenses to each user in the \$NewStaff variable. Reference:

<https://docs.microsoft.com/en-us/office365/enterprise/powershell/assign-licenses-to-user-accounts-with-office-3>

NEW QUESTION 185

- (Exam Topic 5)

Please wait while the virtual machine loads. Once loaded, you may proceed to the lab section. This may take a few minutes, and the wait time will not be deducted from your overall test time.

When the Next button is available, click it to access the lab section. In this section, you will perform a set of tasks in a live environment. While most functionality will be available to you as it would be in a live environment, some functionality (e.g., copy and paste, ability to navigate to external websites) will not be possible by design.

Scoring is based on the outcome of performing the tasks stated in the lab. In other words, it doesn't matter how you accomplish the task, if you successfully perform it, you will earn credit for that task.

Labs are not timed separately, and this exam may have more than one lab that you must complete. You can use as much time as you would like to complete each lab. But, you should manage your time appropriately to ensure that you are able to complete the lab(s) and all other sections of the exam in the time provided.

Please note that once you submit your work by clicking the Next button within a lab, you will NOT be able to return to the lab.

You may now click next to proceed to the lab. Lab information

Use the following login credentials as needed:

To enter your username, place your cursor in the Sign in box and click on the username below.

To enter your password, place your cursor in the Enter password box and click on the password below.

Microsoft 365 Username: admin@LODSe878763.onmicrosoft.com

Microsoft 365 Password: m3t^We\$Z7&xy

If the Microsoft 365 portal does not load successfully in the browser, press CTRL-K to reload the portal in a new browser tab.

The following information is for technical support purposes only:

Lab Instance: 11440873

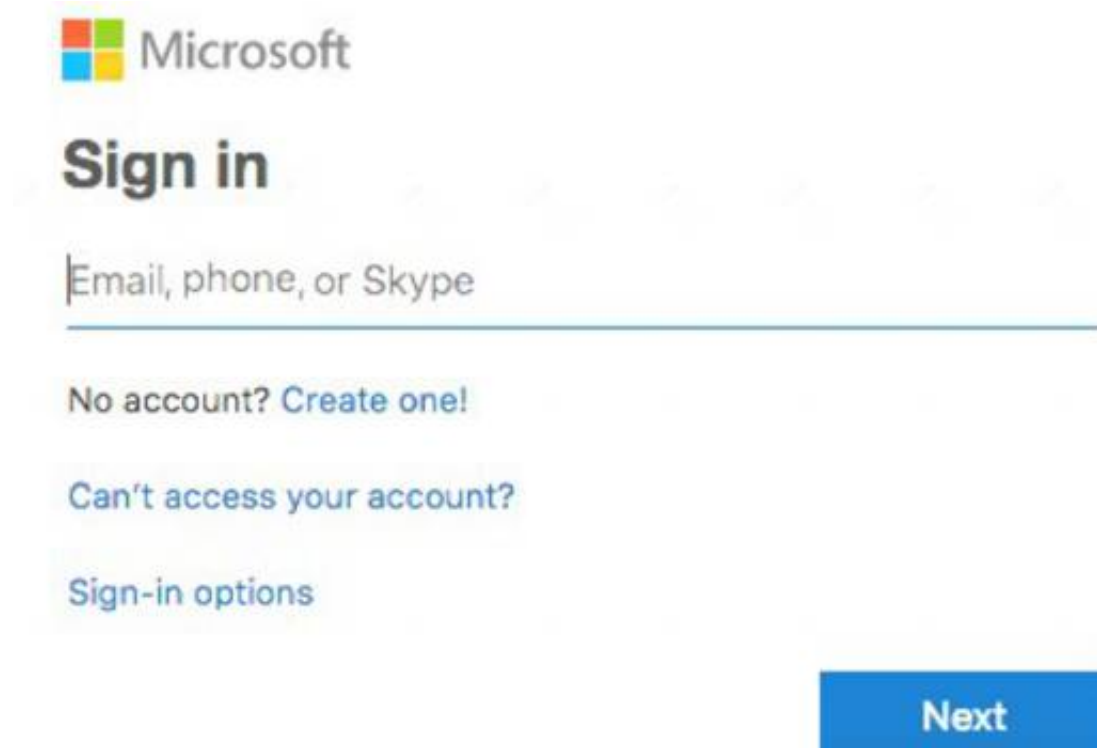

You need to create a SharePoint site named Project1. Users from your organization must be able to share content from the site to external users. To answer, sign in to the Microsoft 365 portal.

- A. Mastered
- B. Not Mastered

Answer: A

Explanation:

You need to create a SharePoint site and configure the sharing settings.

- * 1. Go to the SharePoint Admin Center.
- * 2. In the left navigation pane, expand Sites then select 'Active Sites'.
- * 3. Click on the '+ Create' link to add a new site.
- * 4. Select 'Other Options' then 'Team Site' for the template.
- * 5. Give the site the name 'Project1'.
- * 6. In the 'Primary Administrator' field, start typing 'admin' then select the admin@LODSe878763.onmicrosoft.com account when it appears.
- * 7. Click Finish to create the site.
- * 8. In the Active Sites list, select the Project1 site.
- * 9. Click the Sharing link at the top of the sites list.
- * 10. Under 'External Sharing', select 'Anyone'.
- * 11. Click Save to save the changes.

NEW QUESTION 186

- (Exam Topic 5)

Please wait while the virtual machine loads. Once loaded, you may proceed to the lab section. This may take a few minutes, and the wait time will not be deducted from your overall test time.

When the Next button is available, click it to access the lab section. In this section, you will perform a set of tasks in a live environment. While most functionality will be available to you as it would be in a live environment, some functionality (e.g., copy and paste, ability to navigate to external websites) will not be possible by design.

Scoring is based on the outcome of performing the tasks stated in the lab. In other words, it doesn't matter how you accomplish the task, if you successfully perform it, you will earn credit for that task.

Labs are not timed separately, and this exam may have more than one lab that you must complete. You can use as much time as you would like to complete each lab. But, you should manage your time appropriately to ensure that you are able to complete the lab(s) and all other sections of the exam in the time provided.

Please note that once you submit your work by clicking the Next button within a lab, you will NOT be able to return to the lab.

You may now click next to proceed to the lab. Lab information

Use the following login credentials as needed:

To enter your username, place your cursor in the Sign in box and click on the username below.

To enter your password, place your cursor in the Enter password box and click on the password below.

Microsoft 365 Username: admin@LODSe426243.onmicrosoft.com Microsoft 365 Password: 3&YWyse-6-d

If the Microsoft 365 portal does not load successfully in the browser, press CTRL-K to reload the portal in a new browser tab.

The following information is for technical support purposes only:

Lab Instance: 10887751

You hire a new global administrator named Irvin Sayers to manage your Microsoft 365 tenant.

You need to modify Irvin Sayers to meet the following requirements:

- > Uses at least two methods of user authentication
- > Has the highest Microsoft Office 365 administrative privileges

- A. Mastered
- B. Not Mastered

Answer: A

Explanation:

You need to assign the Global Admin role to Irvin Sayers. You then need to configure the account to require Multi-Factor Authentication (MFA).

- * 1. In the Microsoft 365 admin center, select Users then select Active Users.
- * 2. Select the Irvin Sayers account to open the account properties blade.
- * 3. In the Roles section, click on the 'Manage roles' link.
- * 4. Select the 'Admin center access' option.
- * 5. Select Global Administrator then click the 'Save changes' button.

The next step is to enable the account for Multi-Factor Authentication (MFA).

- * 1. If the Irvin Sayers account is selected in the user accounts list, deselect it (click on the tick icon next to the account name). Selecting a user account changes the menu options at the top of the page; deselecting the accounts changes the menu options back.
- * 2. Click on the 'Multi-factor authentication' link at the top of the page.
- * 3. In the 'Multi-factor authentication' page, select the Irvin Sayers account.
- * 4. Click the 'Enable' link on the right side of the page.
- * 5. In the pop-up window, click the 'enable multi-factor auth' button.

NEW QUESTION 189

- (Exam Topic 5)

You have a new Microsoft 365 subscription.

A user named User1 has a mailbox in Microsoft Exchange Online.

You need to log any changes to the mailbox folder permissions of User1.

Which command should you run? To answer, select the appropriate options in the answer area.

NOTE: Each correct selection is worth one point.

Command	Value
Set-AdminAuditLogConfig	
Set-Mailbox	
Set-UnifiedAuditSetting	

Parameter	Value
-AdminAuditLogEnabled	
-AuditEnabled	
-UnifiedAuditLogIngestionEnabled	

- A. Mastered
- B. Not Mastered

Answer: A

Explanation:

To enable auditing for a single mailbox (in this example, belonging to Holly Sharp), use this PowerShell command: Set-Mailbox username -AuditEnabled \$true
References:

<https://support.microsoft.com/en-us/help/4026501/office-auditing-in-office-365-for-admins> <https://docs.microsoft.com/en-us/powershell/module/exchange/mailboxes/set-mailbox?view=exchange-ps>

NEW QUESTION 193

- (Exam Topic 5)

Your company has a main office and 20 branch offices in North America and Europe. Each branch office connects to the main office by using a WAN link. All the offices connect to the Internet and resolve external host names by using the main office connections.

You plan to deploy Microsoft 365 and to implement a direct Internet connection in each office.

You need to recommend a change to the infrastructure to provide the quickest possible access to Microsoft 365 services.

What is the best recommendation to achieve the goal? More than one answer choice may achieve the goal. Select the BEST answer.

- A. For all the client computers in the branch offices, modify the MTU setting by using a Group Policy object (GPO).
- B. In each branch office, deploy a proxy server that has user authentication enabled.
- C. In each branch office, deploy a firewall that has packet inspection enabled.
- D. In each branch office, configure name resolution so that all external hosts are redirected to public DNS servers directly.

Answer: D

Explanation:

Being a cloud service, Office 365 would be classed as an external host to the office computers.

All the offices connect to the Internet and resolve external host names by using the main office connections. This means that all branch office computers perform DNS lookups and connect to the Internet over the WAN link.

Each branch office will have a direct connection to the Internet so the quickest possible access to Microsoft 365 services would be by using the direct Internet connections. However, the DNS lookups would still go over the WAN links to main office. The solution to provide the quickest possible access to Microsoft 365 services is to configure DNS name resolution so that the computers use public DNS servers for external hosts. That way DNS lookups for Office 365 and the connections to Office 365 will use the direct Internet connections.

NEW QUESTION 194

- (Exam Topic 5)

You have a Microsoft 365 subscription that uses a default domain named litwareinc.com. The subscription has a Microsoft SharePoint site collection named Collection1.

From the Azure Active Directory admin center, you configure the External collaboration settings as shown in the External Collaboration Settings exhibit. (Click the External Collaboration Settings tab.)

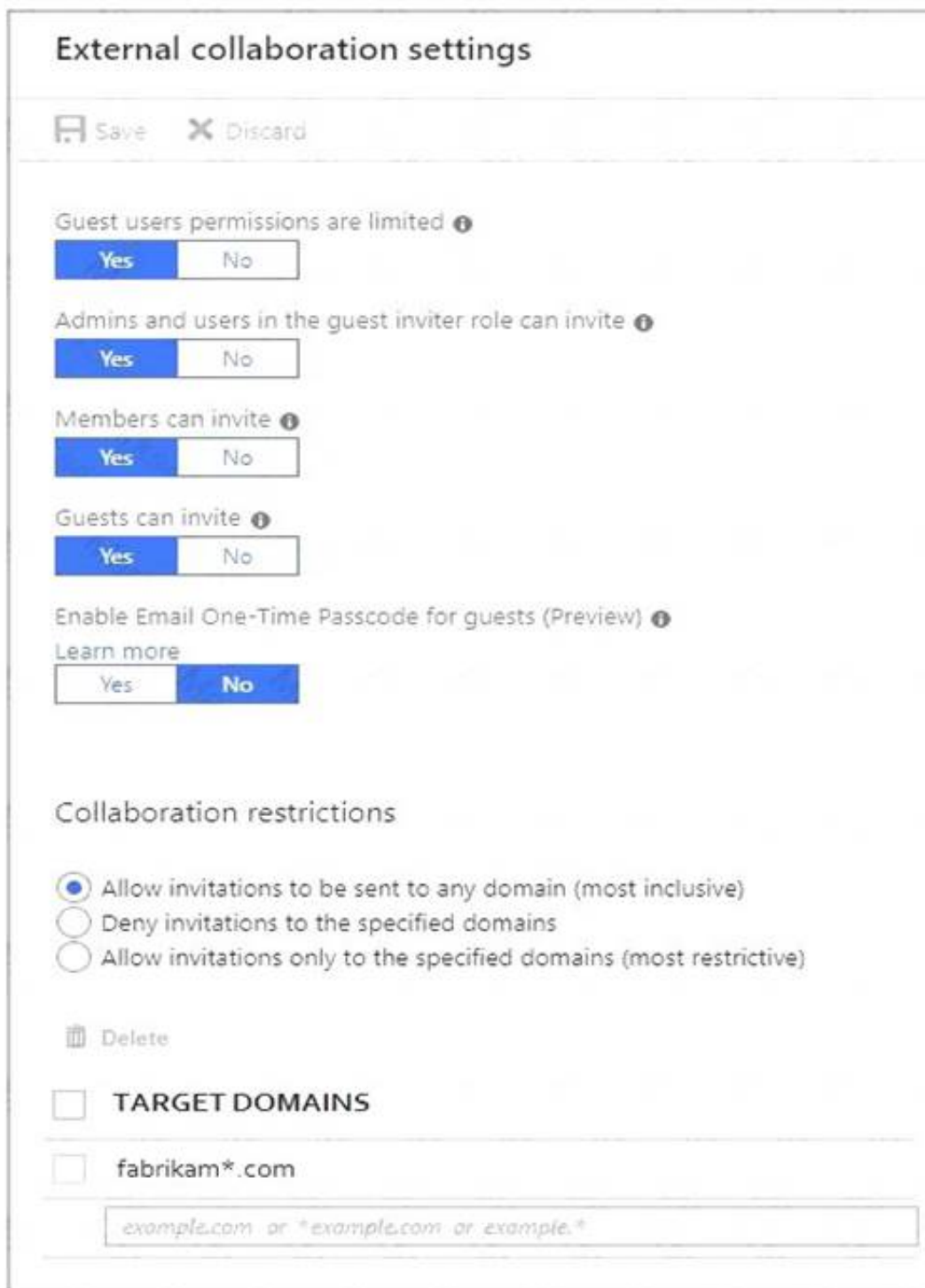

External collaboration settings

Save Discard

Guest users permissions are limited ⓘ

Yes No

Admins and users in the guest inviter role can invite ⓘ

Yes No

Members can invite ⓘ

Yes No

Guests can invite ⓘ

Yes No

Enable Email One-Time Passcode for guests (Preview) ⓘ

Learn more

Yes No

Collaboration restrictions

☒ Allow invitations to be sent to any domain (most inclusive)

☐ Deny invitations to the specified domains

☐ Allow invitations only to the specified domains (most restrictive)

Delete

☐ **TARGET DOMAINS**

☐ fabrikam*.com

example.com or *example.com or example.*

From the SharePoint admin center, you configure the sharing settings as shown in the SharePoint Sharing exhibit. (Click the SharePoint Sharing tab.)

☒ Other users invite additional external users to shared files

☒ External users accept invitations to access files

☒ An anonymous access link is created or changed

For each of the following statements, select Yes if the statement is true. Otherwise, select No.
NOTE: Each correct selection is worth one point.

Statements	Yes	No
You can share the files in Collection1 to user1@fabrikam.com.	<input type="radio"/>	<input type="radio"/>
You can share Collection1 to user2@fabrikam1.com.	<input type="radio"/>	<input type="radio"/>
You can share Collection1 to user3@us.contoso.com.	<input type="radio"/>	<input type="radio"/>

- A. Mastered
B. Not Mastered

Answer: A

Explanation:

Box 1: Yes

In the first exhibit, “Allow invitations to be sent to any domain (most inclusive) is enabled”. Also, everyone is allowed to ‘invite’. The Target Domains setting will have no effect. This would only apply if one of the Allow/Deny invitations to the specified domain options were selected. There is a restriction that blocks invitations being sent to contoso.com. However, this restriction does not apply to Fabrikam.com. Therefore, you can share the files in Collection1 to user1@fabrikam.com.

Box 2: Yes

As noted above, external sharing is enabled for any domain except contoso.com. The Target Domains setting in the first exhibit will have no effect. Therefore, you can share Collection1 to user2@fabrikam1.com.

Box 3: Yes

As noted above, external sharing is enabled for any domain except contoso.com. Blocking sharing to contoso.com does not block sharing to us.contoso.com. Therefore, you can share Collection1 to user3@us.contoso.com.

Reference:

https://docs.microsoft.com/en-us/sharepoint/turn-external-sharing-on-or-off

NEW QUESTION 195

- (Exam Topic 5)

You are creating a report that will query Azure Active Directory (Azure AD) for group information by using the Microsoft Graph API. You need to retrieve an ordered list of groups by title. The solution must minimize the amount of data returned m the response.

How should you complete the Graph API call? To answer, select the appropriate options in the answer area. NOTE: Each correct selection is worth one point.

Answer Area

GET https://graph.microsoft.com/v1.0/groups?

\$expand=id,displayName,description
\$filter=displayName
\$select=id,displayName,description

&\$orderby=description
&\$orderby=displayName
&\$orderby=id

- A. Mastered
B. Not Mastered

Answer: A

Explanation:

Answer Area

GET https://graph.microsoft.com/v1.0/groups?

\$expand=id,displayName,description
\$filter=displayName
\$select=id,displayName,description

&\$orderby=description
&\$orderby=displayName
&\$orderby=id

NEW QUESTION 200

- (Exam Topic 5)

Your company has a Microsoft Azure Active Directory (Azure AD) tenant named contoso.com that includes the users shown in the following table.

Name	Usage location	Membership
User1	<i>Not applicable</i>	Group1
User2	United States	Group2
User3	United States	<i>Not applicable</i>

Group2 is a member of Group1.

You assign a Microsoft Office 365 Enterprise E3 license to User2 as shown in the following exhibit.

License options

Office 365 Enterprise E3

Azure Rights Management	<input checked="" type="checkbox"/> Off	<input type="checkbox"/> On
Exchange Online (Plan 2)	<input checked="" type="checkbox"/> Off	<input type="checkbox"/> On
Flow for Office 365	<input checked="" type="checkbox"/> Off	<input type="checkbox"/> On
Microsoft Forms (Plan E3)	<input checked="" type="checkbox"/> Off	<input type="checkbox"/> On
Microsoft Planner	<input checked="" type="checkbox"/> Off	<input type="checkbox"/> On
Microsoft StaffHub	<input checked="" type="checkbox"/> Off	<input type="checkbox"/> On
Microsoft Teams	<input checked="" type="checkbox"/> Off	<input type="checkbox"/> On
Office 365 ProPlus	<input checked="" type="checkbox"/> Off	<input type="checkbox"/> On
Office Online	<input checked="" type="checkbox"/> Off	<input type="checkbox"/> On
PowerApps for Office 365	<input checked="" type="checkbox"/> Off	<input type="checkbox"/> On
SharePoint Online (Plan 2)	<input type="checkbox"/> Off	<input checked="" type="checkbox"/> On
Skype for Business Online (Plan 2)	<input checked="" type="checkbox"/> Off	<input type="checkbox"/> On
Stream for Office 365	<input checked="" type="checkbox"/> Off	<input type="checkbox"/> On
Sway	<input checked="" type="checkbox"/> Off	<input type="checkbox"/> On
To-Do (Plan 2)	<input checked="" type="checkbox"/> Off	<input type="checkbox"/> On
Yammer Enterprise	<input checked="" type="checkbox"/> Off	<input type="checkbox"/> On

You assign Office 365 Enterprise E3 licenses to Group1 as shown in the following exhibit.

License options

Office 365 Enterprise E3

Azure Rights Management	<div>Off</div>	<div>On</div>
Exchange Online (Plan 2)	<div>Off</div>	<div>On</div>
Flow for Office 365	<div>Off</div>	<div>On</div>
Microsoft Forms (Plan E3)	<div>Off</div>	<div>On</div>
Microsoft Planner	<div>Off</div>	<div>On</div>
Microsoft StaffHub	<div>Off</div>	<div>On</div>
Microsoft Teams	<div>Off</div>	<div>On</div>
Office 365 ProPlus	<div>Off</div>	<div>On</div>
Office Online	<div>Off</div>	<div>On</div>
PowerApps for Office 365	<div>Off</div>	<div>On</div>
SharePoint Online (Plan 2)	<div>Off</div>	<div>On</div>
Skype for Business Online (Plan 2)	<div>Off</div>	<div>On</div>
Stream for Office 365	<div>Off</div>	<div>On</div>
Sway	<div>Off</div>	<div>On</div>
To-Do (Plan 2)	<div>Off</div>	<div>On</div>
Yammer Enterprise	<div>Off</div>	<div>On</div>

For each of the following statements, select Yes if the statement is true. Otherwise, select No. NOTE: Each correct selection is worth one point.

Statements	Yes	No
User1 is licensed to use Microsoft Exchange Online.	<div><input type="radio"/></div>	<div><input type="radio"/></div>
User1 is licensed to use Microsoft Exchange Online and Microsoft Share Point Online.	<div><input type="radio"/></div>	<div><input type="radio"/></div>
If you add User3 to Group2, the user will be licensed to use Microsoft Exchange Online.	<div><input type="radio"/></div>	<div><input type="radio"/></div>

- A. Mastered
- B. Not Mastered

Answer: A

Explanation:

Group-based licensing currently does not support groups that contain other groups (nested groups). If you apply a license to a nested group, only the immediate first-level user members of the group have the licenses applied.

References:

<https://docs.microsoft.com/en-us/azure/active-directory/users-groups-roles/licensing-group-advanced>

NEW QUESTION 204

- (Exam Topic 5)

Note: This question is part of a series of questions that present the same scenario. Each question in the series contains a unique solution that might meet the stated goals. Some question sets might have more than one correct solution, while others might not have a correct solution.

After you answer a question in this section, you will NOT be able to return to it. As a result, these questions will not appear in the review screen.

Your network contains an Active Directory domain named contoso.com that is synced to Microsoft Azure Active Directory (Azure AD).

You manage Windows 10 devices by using Microsoft System Center Configuration Manager (Current Branch).

You configure a pilot for co-management.

You add a new device named Device1 to the domain. You install the Configuration Manager client on Device1.

You need to ensure that you can manage Device1 by using Microsoft Intune and Configuration Manager. Solution: You create a device configuration profile from the Intune admin center.

Does this meet the goal?

- A. Yes
- B. No

Answer: B

Explanation:

Device1 has the Configuration Manager client installed so you can manage Device1 by using Configuration Manager.
 To manage Device1 by using Microsoft Intune, the device has to be enrolled in Microsoft Intune. In the Co-management Pilot configuration, you configure a Configuration Manager Device Collection that determines which devices are auto-enrolled in Microsoft Intune. You need to add Device1 to the Device Collection. You do not need to create a device configuration profile from the Intune admin center. Therefore, this solution does not meet the requirements.
 Reference:
<https://docs.microsoft.com/en-us/configmgr/comanage/how-to-enable>

NEW QUESTION 205

- (Exam Topic 4)

You need to recommend a model for the expense claims solution. What should you recommend?

- A. actionable messages via connectors that use an actionable message card
- B. actionable messages via email that uses an adaptive card
- C. actionable messages via connectors that use an adaptive card
- D. actionable messages via email that uses an actionable message card

Answer: D

Explanation:

Sending actionable messages via email is supported. You use actionable message cards. Scenario:
 Create an email workflow solution for expense claims. Users will submit their expense claims and the system will email an approval request to their manager. The expense claims solution must provide managers with claim information and the ability to manage the claim by using Microsoft Outlook, Outlook on the web, or Outlook for iOS and Android.
 Reference:
<https://docs.microsoft.com/en-us/outlook/actionable-messages/send-via-email>

NEW QUESTION 207

- (Exam Topic 4)

You need to configure HRApp to enable users to search for specific jobs by using chat in Microsoft Teams. Which three actions should you perform in sequence? To answer, move the appropriate actions from the list of actions to the answer area and arrange them in the correct order.

Actions

Implement a handler for the `jobsearch` command in the Microsoft Bot Framework app.

In the HRApp manifest, configure the the `botId` value in the `bot` section to match the `botId` value of the bot registration.

Implement a handler for the `query` command in the Microsoft Bot Framework app.

Create a bot registration and a Microsoft Bot Framework app.

In the HRApp manifest, configure the `botId` value in the `ComposeExtensions` section to match the `botId` value of the bot registration.

>

<

Answer Area

- A. Mastered
- B. Not Mastered

Answer: A

Explanation:

Graphical user interface, text, application Description automatically generated
 Step 1: Create a bot registration..
 Step 2: In the HRApp manifest, configure the `botId` value in the `ComposeExtensions` section to match the `botId` value of the bot registration.
 Scenario: HRApp must include a messaging extension that enables users to search jobs by job title or job ID. Step 3: Implement a handler
 Reference:
<https://docs.microsoft.com/en-us/azure/bot-service/bot-service-quickstart-registration>

NEW QUESTION 210

- (Exam Topic 3)

You need to configure Azure AD Connect to support the planned changes for the Montreal Users and Seattle Use's OUs. What should you do?

- A. From PowerShell, run The `Add-ADSyncConnectorAttributeinclusion` cmdlet.
- B. From the Microsoft Azure Active Directory Connect wizard, select Customize synchronization options.
- C. From PowerShell, run the `start-ADSyncSyncCycle` cmdlet.
- D. From the Microsoft Azure Active Directory Connect wizard, select Manage federation.

Answer: D

NEW QUESTION 212

- (Exam Topic 3)

You need to configure just in time access to meet the technical requirements. What should you use?

- A. access reviews
- B. entitlement management
- C. Azure Active Directory (Azure AD) Privileged Identity Management (PIM)
- D. Azure Active Directory (Azure AD) Identity Protection

Answer: C

Explanation:

Reference:

<https://docs.microsoft.com/en-us/azure/active-directory/privileged-identity-management/pim-configure> joergsi 5 months, 1 week ago

Privileged access management

The effectiveness of an information protection strategy depends on how secure the administrative accounts used to manage that strategy are. If accounts that can be used to configure and manage an information protection strategy are not properly secured, then the information protection strategy itself can be easily compromised.

Privileged access management enables you to configure policies that apply

=> just-in-time administrative principles to sensitive administrative roles.

For example, if someone needs temporary access to configure an information protection policy, that person would need to go through an approval process to obtain the necessary set of rights instead of having an Azure Active Directory (Azure AD) account with those rights permanently assigned.

Thomas, Orin. Exam Ref MS-100 Microsoft 365 Identity and Services (S.10). Pearson Education. Kindle-Version.

NEW QUESTION 215

- (Exam Topic 2)

Which migration solution should you recommend for Project1?

- A. From the Exchange admin center, start a migration and select Staged migration.
- B. From the Microsoft 365 admin center, start a data migration and click Exchange as the data service.
- C. From the Microsoft 365 admin center, start a data migration and click Outlook as the data service.
- D. From the Exchange admin center, start a migration and select Cutover migration.

Answer: B

Explanation:

Project1: During Project1, the mailboxes of 100 users in the sales department will be moved to Microsoft 365. Fabrikam does NOT plan to implement identity federation.

All users must be able to exchange email messages successfully during Project1 by using their current email address.

During Project1, some users will have mailboxes in Microsoft 365 and some users will have mailboxes in Exchange on-premises. To enable users to be able to exchange email messages successfully during Project1 by using their current email address, we'll need to configure hybrid Exchange.

A new way to migrate mailboxes in a hybrid Exchange configuration is to use the Microsoft 365 data migration service. The data migration service can migrate Exchange, SharePoint and OneDrive. Therefore, we need to start a data migration and click Exchange as the service to be migrated.

Reference:

<https://docs.microsoft.com/en-us/fasttrack/O365-data-migration> <https://docs.microsoft.com/en-us/exchange/hybrid-deployment/move-mailboxes>

NEW QUESTION 220

- (Exam Topic 2)

Note: This question is part of a series of questions that present the same scenario. Each question in the series contains a unique solution that might meet the stated goals. Some question sets might have more than one correct solution, while others might not have a correct solution.

After you answer a question in this section, you will NOT be able to return to it. As a result, these questions will not appear in the review screen.

Your company has a Microsoft Office 365 tenant.

You suspect that several Office 365 features were recently updated.

You need to view a list of the features that were recently updated in the tenant. Solution: You use Monitoring and reports from the Compliance admin center. Does this meet the goal?

- A. Yes
- B. No

Answer: B

Explanation:

Depending on what your organization's Office 365 subscription includes, the Dashboard in Security & Compliance includes several widgets, such as Threat Management Summary, Threat Protection Status, Global Weekly Threat Detections, Malware, etc. The Compliance admin center in Microsoft 365 contains much of the same information but also includes additional entries focusing on alerts, data insights.

The Monitoring and reports section from the Compliance admin center does not display a list of the features that were recently updated in the tenant so this solution does not meet the goal.

To meet the goal, you need to use Message center in the Microsoft 365 admin center.

Reference:

<https://docs.microsoft.com/en-us/office365/admin/manage/message-center?view=o365-worldwide>

NEW QUESTION 221

- (Exam Topic 2)

You need to meet the application requirement for App1.

Which three actions should you perform? Each correct answer presents part of the solution. NOTE: Each correct selection is worth one point.

- A. From the Azure Active Directory admin center, configure the application URL settings.
- B. From the Azure Active Directory admin center, add an enterprise application.
- C. On an on-premises server, download and install the Microsoft AAD Application Proxy connector.
- D. On an on-premises server, install the Hybrid Configuration wizard.
- E. From the Microsoft 365 admin center, configure the Software download settings.

Answer: ABC

Explanation:

➤ An on-premises web application named App1 must allow users to complete their expense reports online. Application Proxy is a feature of Azure AD that enables users to access on-premises web applications from a remote client. Application Proxy includes both the Application Proxy service which runs in the cloud, and the Application Proxy connector which runs on an on-premises server. Azure AD, the Application Proxy service, and the Application Proxy connector work together to securely pass the user sign-on token from Azure AD to the web application.

In this question, we need to add an enterprise application in Azure and configure a Microsoft AAD Application Proxy connector to connect to the on-premises web application (App1).

Reference:

<https://docs.microsoft.com/en-us/azure/active-directory/manage-apps/application-proxy#how-application-proxy>

NEW QUESTION 223

- (Exam Topic 1)

You need to assign User2 the required roles to meet the security requirements and the technical requirements. To which two roles should you assign User2? Each correct answer presents part of the solution.

NOTE: Each correct selection is worth one point.

- A. the Exchange View-only Organization Management role
- B. the Microsoft 365 Records Management role
- C. the Exchange Online Help Desk role
- D. the Microsoft 365 Security Reader role
- E. the Exchange Online Compliance Management role

Answer: DE

Explanation:

➤ User2 must be able to view reports and schedule the email delivery of security and compliance reports. The Security Reader role can view reports but not schedule the email delivery of security and compliance reports.

The Exchange Online Compliance Management role can schedule the email delivery of security and compliance reports.

Reference:

<https://docs.microsoft.com/en-us/exchange/permissions-exo/permissions-exo>

NEW QUESTION 224

.....

THANKS FOR TRYING THE DEMO OF OUR PRODUCT

Visit Our Site to Purchase the Full Set of Actual MS-100 Exam Questions With Answers.

We Also Provide Practice Exam Software That Simulates Real Exam Environment And Has Many Self-Assessment Features. Order the MS-100 Product From:

<https://www.2passeasy.com/dumps/MS-100/>

Money Back Guarantee

MS-100 Practice Exam Features:

- * MS-100 Questions and Answers Updated Frequently
- * MS-100 Practice Questions Verified by Expert Senior Certified Staff
- * MS-100 Most Realistic Questions that Guarantee you a Pass on Your FirstTry
- * MS-100 Practice Test Questions in Multiple Choice Formats and Updatesfor 1 Year