



Microsoft

Exam Questions PL-500

Microsoft Power Automate RPA Developer

About ExamBible

[Your Partner of IT Exam](#)

Found in 1998

ExamBible is a company specialized on providing high quality IT exam practice study materials, especially Cisco CCNA, CCDA, CCNP, CCIE, Checkpoint CCSE, CompTIA A+, Network+ certification practice exams and so on. We guarantee that the candidates will not only pass any IT exam at the first attempt but also get profound understanding about the certificates they have got. There are so many alike companies in this industry, however, ExamBible has its unique advantages that other companies could not achieve.

Our Advances

* 99.9% Uptime

All examinations will be up to date.

* 24/7 Quality Support

We will provide service round the clock.

* 100% Pass Rate

Our guarantee that you will pass the exam.

* Unique Gurantee

If you do not pass the exam at the first time, we will not only arrange FULL REFUND for you, but also provide you another exam of your claim, ABSOLUTELY FREE!

NEW QUESTION 1

- (Exam Topic 1)

You need to ensure that the solution uses the correct accounts payable mailbox. Which three actions should you perform? Each correct answer part of the solution, NOTE: Each correct selection is worth one point.

- A. Set the current value for the accounts payable mailbox in the environment.
- B. Set the default value for the accounts payable mailbox in the environment.
- C. Turn off and then turn on the cloud flows.
- D. Use separate environment variables for the cloud flow and the canvas app.
- E. Use one environment variable for both the cloud flows and the canvas app.

Answer: ACD

NEW QUESTION 2

- (Exam Topic 1)

You need to resolve the fulfillment status flow issue.

Which three actions should you perform? Each correct answer presents part of the solution. NOTE: Each correct selection is worth one point.

- A. Ensure that the flow instance does not remain in the queue for more than three hours.
- B. Ensure that the flow is not using elevated privileges.
- C. Ensure that all users are signed out from the target machine.
- D. Use different local Windows accounts for all machines.
- E. Trigger the flow by using an on-premises data gateway.

Answer: BDE

NEW QUESTION 3

- (Exam Topic 2)

You need to address the issue with the capacity planning flow. What should you do?

- A. Increase the CPU and memory of the machine on which the gateway is hosted.
- B. Create a gateway cluster.
- C. Configure the system to send alerts when the gateway fails.
- D. Create a machine group and add machines to the group to handle requests.

Answer: D

NEW QUESTION 4

- (Exam Topic 2)

You need to resolve the issue with the DataCollector flow.

What are two possible ways to achieve the goal? Each correct answer presents a complete solution. NOTE: Each correct selection is worth one point

- A. Add an If web page contains action to determine whether a field exists and write data only when true.
- B. Configure the Populate text field on a web page actions to continue running the flow in case of error.
- C. Replace the Populate text field on a web page action with the Send keys action to write data.
- D. Remove the Focus text field on a web page actions that precede actions which write data to text fields.
- E. Modify selectors to ensure that field attributes are mapped correctly.

Answer: BCE

NEW QUESTION 5

- (Exam Topic 2)

You need to resolve the issue reported with the RailStatusUpdater flow.

What are two possible ways to achieve the goal? Each correct answer presents a complete solution.

NOTE:Each correct selection is worth one point.

- A. Put the desktop flow action into a Do until loop
- B. Run until the desktop flow is successful.
- C. Call a separate child cloud flow to perform the desktop flow a second time.
- D. Create a duplicate action for the desktop flow and configure the duplicate action to run if the first desktop flow action fails.
- E. Create a duplicate action for the desktop flow to run after the first desktop flow.

Answer: A

NEW QUESTION 6

- (Exam Topic 3)

A user is evaluating the capabilities of both process mining and task mining. You need to determine when you should use process mining or task mining.

Which Process advisor capability should you use? To answer, drag the appropriate capabilities to the correct requirements. Each capability may be used once, more than once, or not at all. You may need to drag the split bar between panes or scroll to view content.

NOTE: Each correct selection is worth one point.

Capabilities

Process mining

Task mining

Answer Area

Requirement

See the actual steps used to perform a process.

Reduce process time by evaluating event data from a system of record.

Understand what employees do while performing each task.

Identify the most common actions based on user interactions.

Capability

Capability

Capability

Capability

- A. Mastered
B. Not Mastered

Answer: A

Explanation:

Capabilities

Process mining

Task mining

Answer Area

Requirement

See the actual steps used to perform a process.

Reduce process time by evaluating event data from a system of record.

Understand what employees do while performing each task.

Identify the most common actions based on user interactions.

Capability

Process mining

Task mining

Process mining

Task mining

NEW QUESTION 7

- (Exam Topic 3)

You create a process map by using Process advisor. You plan to create a cloud flow based on the process map. You need to develop the cloud flow. Which two Process advisor features can you use? Each correct answer presents a complete solution. NOTE: Each correct selection is worth one point.

- A. Automatically build a cloud flow based on the process map.
B. Recommend automation opportunities based on the process map,
C. Suggest input variables to use in the cloud flow.
D. Suggest connectors to use in the cloud flow.

Answer: AB

NEW QUESTION 8

- (Exam Topic 3)

You are creating an automation for a company. When a new record is created in a Microsoft Dataverse table, the automation must add the same data to an enterprise resource planning (ERP) system. The ERP system does not have an API.

You need to create the automation solution.

What should you use? To answer, select the appropriate options in the answer area. NOTE: Each correct selection is worth one point.

Answer Area

Requirement

Trigger an automation to run when the new record is created.

Add the data to the ERP system.

Solution

Cloud flow

Desktop flow

Model-driven app

Cloud flow

Desktop flow

Model-driven app

- A. Mastered
B. Not Mastered

Answer: A

Explanation:

Requirement	Solution
Trigger an automation to run when the new record is created.	<div>Cloud flow</div> <div>Desktop flow</div> <div>Model-driven app</div>
Add the data to the ERP system.	<div>Cloud flow</div> <div>Desktop flow</div> <div>Model-driven app</div>

NEW QUESTION 9

- (Exam Topic 3)

You create the following flow:

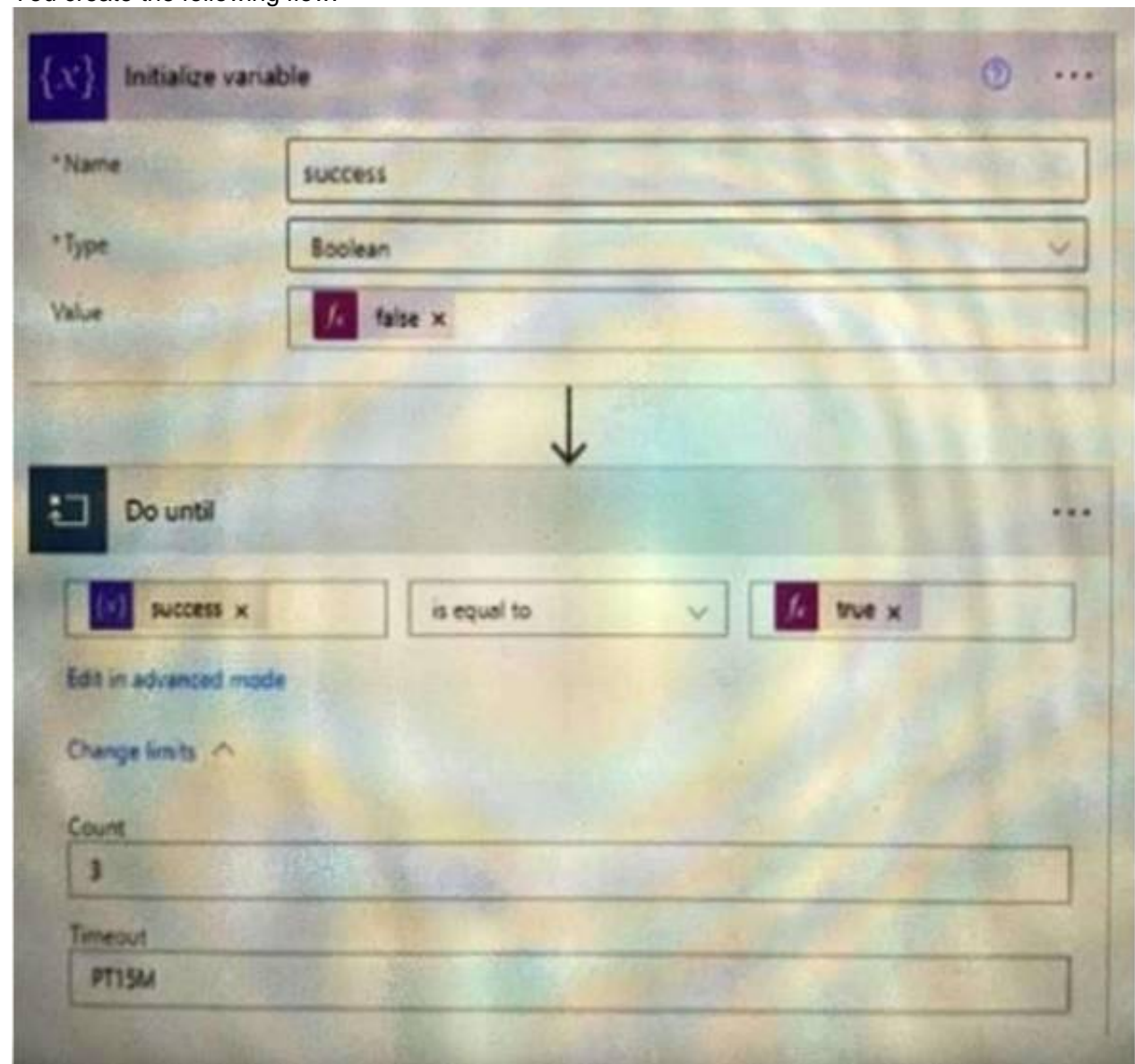

For each of the following statements, select Yes if the statement is true. Otherwise, select No. NOTE: Each correct selection is worth one point.

Questions	Response
What does the value 3 in the Count property represent?	<div>The do until action will retry up to three times if there are any failures.</div> <div>The do until actions must succeed three times before moving on to the next action.</div>
What does the value PT15M in the Timeout property represent?	<div>The do until must run for a minimum of 15 minutes.</div> <div>The flow cannot exceed 15 minutes of total run time.</div> <div>The do until will time out when it reaches 15 minutes.</div>

- A. Mastered
- B. Not Mastered

Answer: A

Explanation:

Questions	Response
What does the value 3 in the Count property represent?	<div><div></div><div>The do until action will retry up to three times if there are any failures.</div><div>The do until actions must succeed three times before moving on to the next action.</div></div>
What does the value PT15M in the Timeout property represent?	<div><div></div><div>The do until must run for a minimum of 15 minutes.</div><div>The flow cannot exceed 15 minutes of total run time.</div><div>The do until will time out when it reaches 15 minutes.</div></div>

NEW QUESTION 10

- (Exam Topic 3)

You are developing a solution for a medical practice. The solution must use an artificial intelligence (AI) model to evaluate medical X-ray images and detect broken bones.

You need to create the AI model for the solution. Solution: Use Visual Studio to create the model.

Does the solution meet the goal?

- A. Yes
- B. No

Answer: A

NEW QUESTION 10

- (Exam Topic 3)

You are designing a user interface automation that uses a Power Automate for desktop flow.

The solution must allow you to use wildcard characters including question marks and asterisks to define a window

You need to select the window mode for the automation. Which window mode should you use?

- A. By window UI element
- B. By title and/or class
- C. By window instance/handle
- D. By variable

Answer: D

NEW QUESTION 12

- (Exam Topic 3)

You develop automation solutions for a company.

You need to implement actions to meet the company's requirements.

What should you do? To answer, select the appropriate options in the answer area. NOTE: Each correct selection is worth one point.

Scenario	Requirement	Action
You have a desktop flow that is currently in queue.	You must ensure that the flow is the next flow to run.	<div><div></div><div>Move to the top</div><div>Change the priority</div><div>Cancel and resubmit the flow</div></div>
You have a business-critical desktop flow that runs on a virtual machine. The virtual machine also handles multiple ad-hoc desktop flows.	You must ensure that the business-critical flow runs when it is needed.	<div><div></div><div>Change the priority</div><div>Move to the top</div><div>Created a scheduled trigger</div></div>

- A. Mastered
- B. Not Mastered

Answer: A

Explanation:

Scenario	Requirement	Action
You have a desktop flow that is currently in queue.	You must ensure that the flow is the next flow to run.	<div><div></div><div>Move to the top</div><div>Change the priority</div><div>Cancel and resubmit the flow</div></div>
You have a business-critical desktop flow that runs on a virtual machine. The virtual machine also handles multiple ad-hoc desktop flows.	You must ensure that the business-critical flow runs when it is needed.	<div><div></div><div>Change the priority</div><div>Move to the top</div><div>Created a scheduled trigger</div></div>

NEW QUESTION 17

- (Exam Topic 3)

You develop Power Automate flows for a company. You need to help users locate and run the flows. Where should you direct users to find the flows? To answer
NOTE: Each correct selection is worth one point.

Answer Area

Requirement

You select the **Send a copy** button from the flow portal to send the flow to a business user group.

You select the **Share** button from the portal to share the flow with business users.

Value

the Solutions page

the Shared with me tab of the My flows page

the Shared with me tab of the Templates page

the Solutions page

the Shared with me tab of the My flows page

the Shared with me tab of the Templates page

- A. Mastered
- B. Not Mastered

Answer: A

Explanation:

Answer Area

Requirement

You select the **Send a copy** button from the flow portal to send the flow to a business user group.

You select the **Share** button from the portal to share the flow with business users.

Value

the Solutions page

the Shared with me tab of the My flows page

the Shared with me tab of the Templates page

the Solutions page

the Shared with me tab of the My flows page

the Shared with me tab of the Templates page

NEW QUESTION 22

- (Exam Topic 3)

You are developing desktop flows for a company.
You need to use Recorder to record steps that you are performing in target applications.
Which recording modes will Recorder use? To answer, drag the appropriate recording modes to the correct target applications. Each recording mode may be used once, more than once, or not at all. You may need to drag the split bar between panes or scroll to view content.
NOTE: Each correct selection is worth one point.

Recording modes

Standard

Image based

Web

Answer Area

Target application

Web browser

iFrame within a web browser

Java applet

Windows application

Recording mode

Recording mode

Recording mode

Recording mode

Recording mode

- A. Mastered
- B. Not Mastered

Answer: A

Explanation:

Recording modes

Standard

Image based

Web

Answer Area

Target application

Web browser

iFrame within a web browser

Java applet

Windows application

Recording mode

Web

Image based

Standard

Standard

NEW QUESTION 27

- (Exam Topic 3)

You develop a desktop flow. The flow performs five actions in sequence.

If an error occurs, you must restart the flow from the first action. You add the five actions to an On block error action.

You need to configure error handling.

Which two actions should you perform? Each correct answer presents part of the solution. NOTE: Each correct selection is worth one point.

- A. Change the exception handling mode to Go to the beginning of the block.
- B. Select Continue flow run.
- C. Select Throw error.
- D. Change the exception handling mode to Go to next action.
- E. Configure an On error condition for the first action.

Answer: ACE

NEW QUESTION 28

- (Exam Topic 3)

You are creating a cloud flow that will use two Update Row actions to interact with Microsoft Dataverse. Neither of these actions are dependent on each other.

You must minimize the amount of processing time required to complete the flow. You need to implement the actions in the cloud flow.

Solution: Create a switch condition. Does the solution meet the goal?

- A. Yes
- B. No

Answer: B

NEW QUESTION 29

- (Exam Topic 3)

You create several desktop flows. Each flow will run on a single user's device. You need to determine how Power Automate will orchestrate the flows.

Which three rules will Power Automate apply? Each correct answer presents a complete solution. NOTE: Each correct selection is worth one point.

- A. All the flows are run simultaneously.
- B. The next flow will run when each run completes based on the priority and the time requested.
- C. The first flow runs on the target device based on the priority and the time requested.
- D. The first flow runs on the target device based on Next to run status and time requested.
- E. The first and last flows run based on the priority and the time requested.
- F. The remaining flows are queued.

Answer: AEF

NEW QUESTION 30

- (Exam Topic 3)

You are developing a cloud flow.

The flow must be able to query several Azure endpoints and must use standard actions where possible. You need to configure the flow.

Which actions should you use? To answer, select the appropriate options in the answer area. NOTE: Each correct selection is worth one point.

Answer Area

Requirement	Action
Issue POST requests to the Microsoft Graph API by using application permissions.	<div>HTTP</div> <div>HTTP with Azure AD</div> <div>Send an HTTP request to SharePoint</div> <div>Office 365 groups send an HTTP request</div>
Issue GET requests to the Microsoft Graph API by using delegated permissions.	<div>HTTP</div> <div>HTTP with Azure AD</div> <div>Send an HTTP request to SharePoint</div> <div>Office 365 groups send an HTTP request</div>
Issue POST requests to Office 365 Management APIs by using delegated permissions.	<div>HTTP</div> <div>HTTP with Azure AD</div> <div>Send an HTTP request to SharePoint</div> <div>Office 365 groups send an HTTP request</div>
Issue GET requests to the SharePoint REST API by using delegated permissions.	<div>HTTP</div> <div>HTTP with Azure AD</div> <div>Send an HTTP request to SharePoint</div> <div>Office 365 groups send an HTTP request</div>
Issue POST requests to SharePoint REST API by using application permissions.	<div>HTTP</div> <div>HTTP with Azure AD</div> <div>Send an HTTP request to SharePoint</div> <div>Office 365 groups send an HTTP request</div>

- A. Mastered
- B. Not Mastered

Answer: A

Explanation:

Answer Area

Requirement	Action
Issue POST requests to the Microsoft Graph API by using application permissions.	<div>HTTP</div> <div>HTTP with Azure AD</div> <div>Send an HTTP request to SharePoint</div> <div>Office 365 groups send an HTTP request</div>
Issue GET requests to the Microsoft Graph API by using delegated permissions.	<div>HTTP</div> <div>HTTP with Azure AD</div> <div>Send an HTTP request to SharePoint</div> <div>Office 365 groups send an HTTP request</div>
Issue POST requests to Office 365 Management APIs by using delegated permissions.	<div>HTTP</div> <div>HTTP with Azure AD</div> <div>Send an HTTP request to SharePoint</div> <div>Office 365 groups send an HTTP request</div>
Issue GET requests to the SharePoint REST API by using delegated permissions.	<div>HTTP</div> <div>HTTP with Azure AD</div> <div>Send an HTTP request to SharePoint</div> <div>Office 365 groups send an HTTP request</div>
Issue POST requests to SharePoint REST API by using application permissions.	<div>HTTP</div> <div>HTTP with Azure AD</div> <div>Send an HTTP request to SharePoint</div> <div>Office 365 groups send an HTTP request</div>

NEW QUESTION 31

- (Exam Topic 3)

You manage automation solutions for a company.

You need to select the appropriate patch type for each scenario.

Which patch types should you use? To answer, drag the appropriate patch types to the correct requirements. Each patch type may be used once, more than once, or not at all. You may need to drag the bar between panes or scroll to view content.

NOTE: Each correct selection is worth one point.

Patch types

Upgrade

Stage for upgrade

Update

Answer Area

Requirement	Patch type
Upgrade a solution to the latest version. Delete any components from the previous version that do not exist in the new version.	Patch type
Upgrade a solution to the latest version. Retain all components from the previous version.	Patch type
Replace a solution with the latest version. Retain all components from the previous version.	Patch type

- A. Mastered
- B. Not Mastered

Answer: A

Explanation:

Patch types

Upgrade

Stage for upgrade

Update

Answer Area

Requirement	Patch type
Upgrade a solution to the latest version. Delete any components from the previous version that do not exist in the new version.	Upgrade
Upgrade a solution to the latest version. Retain all components from the previous version.	Update
Replace a solution with the latest version. Retain all components from the previous version.	Stage for upgrade

NEW QUESTION 34

- (Exam Topic 3)

You have a Microsoft Dataverse table in a solution. You delete fields from the table.

You need to automatically delete the fields from the Microsoft Dataverse table when you import the updated solution into a target environment

Which import option should you use?

- A. Stage for upgrade
- B. Update
- C. Upgrade

Answer: C

NEW QUESTION 38

- (Exam Topic 3)

You are developing automation solutions for a company.

You need to select the components to use for each scenario. You must minimize development efforts. Which methods should you use? To answer, select the appropriate options in the answer area.

NOTE: Each correct selection is worth one point.

Answer Area

Scenario	Component
Query items from a SharePoint list.	<div><div>Built-in connector</div><div>Custom connector</div><div>HTTP connector</div><div>Azure API Management</div></div>
Share methods from a third-party REST API with an organization.	<div><div>Built-in connector</div><div>Custom connector</div><div>HTTP connector</div><div>Browser automation</div></div>
Call a Microsoft Graph API endpoint using application permissions.	<div><div>Built-in connector</div><div>Custom connector</div><div>HTTP connector</div><div>Azure API Management</div></div>

- A. Mastered
- B. Not Mastered

Answer: A

Explanation:

Answer Area

Scenario	Component
Query items from a SharePoint list.	<div><div>Built-in connector</div><div>Custom connector</div><div>HTTP connector</div><div>Azure API Management</div></div>
Share methods from a third-party REST API with an organization.	<div><div>Built-in connector</div><div>Custom connector</div><div>HTTP connector</div><div>Browser automation</div></div>
Call a Microsoft Graph API endpoint using application permissions.	<div><div>Built-in connector</div><div>Custom connector</div><div>HTTP connector</div><div>Azure API Management</div></div>

NEW QUESTION 42

- (Exam Topic 3)

You have a desktop flow that interacts with a desktop-based application. You plan to enter data into each field by using the Send keys action.

You test the flow. The Send keys action runs successfully but the input fields are empty. You need to add a step before the Send keys action to resolve the issue.

Which two steps can you use? Each correct answer presents a complete solution. NOTE: Each correct selection is worth one point.

- A. Use the Wait for window action.
- B. Set the key state.
- C. Use the Focus window action.
- D. Set the window state.
- E. Use the Wait for mouse action

Answer: DE

NEW QUESTION 47

- (Exam Topic 3)

A company has a customer relationship management (CRM) application that runs on a virtual machine (VM) in Azure.

The solution must automatically extract common invoice data from documents sent as email attachments and save the data to the company's CRM application.

You need to design the solution.

In which order should you perform the actions? To answer, move all actions from the list of actions to the answer area and arrange them in the correct order.

Actions

Define input variables in the desktop flow.

Create an instance of the Invoice processing AI Builder model.

Define the logic in the desktop flow to write data to the CRM.

Create a cloud flow that extracts information from the model and triggers the desktop flow.

Create a desktop flow.

Answer Area

- A. Mastered
- B. Not Mastered

Answer: A

Explanation:

Actions

Define input variables in the desktop flow.

Create an instance of the Invoice processing AI Builder model.

Define the logic in the desktop flow to write data to the CRM.

Create a cloud flow that extracts information from the model and triggers the desktop flow.

Create a desktop flow.

Answer Area

Create a desktop flow.

Define the logic in the desktop flow to write data to the CRM.

Define input variables in the desktop flow.

Create an instance of the Invoice processing AI Builder model.

Create a cloud flow that extracts information from the model and triggers the desktop flow.

NEW QUESTION 50

- (Exam Topic 3)

You create an environment for a company. You need to configure security to meet the company's requirements and follow the principle of least privilege. Which security roles should you assign? To answer, select the appropriate options in the answer area.

NOTE:Each correct selection is worth one point.

Answer Area

Requirement	Security role
A user must be able to register new machines in the environment.	<div>Environment Maker</div> <div>Desktop Flows Machine Owner</div>
A user must be able to share their machine with another user.	<div>Environment Maker</div> <div>Desktop Flows Machine User</div> <div>Desktop Flows Machine User Can Share</div>
A user must be able to run desktop flows on a registered machine.	<div>Environment Maker</div> <div>Desktop Flows Machine User</div> <div>Desktop Flows Machine User Can Share</div>
A user must be able to create a machine group and add machines to the machine group.	<div>Environment Maker</div> <div>Desktop Flows Machine User</div> <div>Desktop Flows Machine Owner</div>

- A. Mastered
- B. Not Mastered

Answer: A

Explanation:

Answer Area

Requirement	Security role
A user must be able to register new machines in the environment.	Environment Maker Desktop Flows Machine Owner
A user must be able to share their machine with another user.	Environment Maker Desktop Flows Machine User Desktop Flows Machine User Can Share
A user must be able to run desktop flows on a registered machine.	Environment Maker Desktop Flows Machine User Desktop Flows Machine User Can Share
A user must be able to create a machine group and add machines to the machine group.	Environment Maker Desktop Flows Machine User Desktop Flows Machine Owner

NEW QUESTION 54

- (Exam Topic 3)

You are developing an RPA solution that requires browser automation. You are testing the flow. You observe that the flow does not interact with web page elements in Microsoft Edge. You need to troubleshoot the issue. What should you do?

- A. Enable error handling on the action to retry on failure.
- B. Ensure the UI flows/Selenium extension is downloaded and enabled in Microsoft Edge.
- C. Open Power Automate machine runtime and select Troubleshoot
- D. Ensure the Power Automate for desktop browser extension is downloaded and enabled in Microsoft Edge.

Answer: A

NEW QUESTION 57

- (Exam Topic 3)

You deploy a cloud flow to a production environment. You make changes to the cloud flow in a development environment. You import the updated solution to the production environment. You observe that the cloud flow is not updated. You need to resolve the issue.

Which four actions should you perform in sequence? To answer, move the appropriate actions from the list of actions to the answer area and arrange them in the correct order.

Actions

- Remove all dependencies.
- Show solution layers.
- Select the cloud flow that was upgraded.
- Show dependencies.
- Remove all unmanaged layers.
- In the production environment, navigate to the solution contents.
- In the development environment, navigate to the solution contents.

Answer Area

Navigation arrows: > < (left of answer area), < > (right of answer area)

- A. Mastered
- B. Not Mastered

Answer: A

Explanation:

Actions

- Remove all dependencies.
- Show solution layers.
- Select the cloud flow that was upgraded.
- Show dependencies.
- Remove all unmanaged layers.
- In the production environment, navigate to the solution contents.
- In the development environment, navigate to the solution contents.

Answer Area

Sequence of actions in Answer Area:

- In the production environment, navigate to the solution contents.
- Show solution layers.
- Remove all dependencies.
- Remove all unmanaged layers.

Navigation arrows: > < (left of answer area), < > (right of answer area)

NEW QUESTION 59

- (Exam Topic 3)

You are creating a cloud flow that will use two Update Row actions to interact with Microsoft Dataverse. Neither of these actions are dependent on each other. You must minimize the amount of processing time required to complete the flow. You need to implement the actions in the cloud flow.

Solution: Create two sequential Update Row actions. Does the solution meet the goal?

- A. Yes
- B. No

Answer: A

NEW QUESTION 60

- (Exam Topic 3)

A company plans to implement AI models to perform business processes. You need to determine whether to use prebuilt or custom AI models.

Which type of model should you use for each scenario? To answer, drag the appropriate model types to the correct scenarios. Each model may be used once, more than once, or not at all. You may need to drag the split bar between panes or scroll to view content.

NOTE: Each correct selection is worth one point.

Model types		Scenario	Model type
Prebuilt	⋮	Extract information from a receipt.	Model type
Custom	⋮	Detect spam emails.	Model type
	⋮	Identify the language used in a text document.	Model type
	⋮	Extract information from tax documents.	Model type

- A. Mastered
- B. Not Mastered

Answer: A

Explanation:

Model types		Scenario	Model type
Prebuilt	⋮	Extract information from a receipt.	Custom
Custom	⋮	Detect spam emails.	Custom
	⋮	Identify the language used in a text document.	Prebuilt
	⋮	Extract information from tax documents.	Custom

NEW QUESTION 61

- (Exam Topic 3)

You are developing a desktop flow.

You need to include an IF statement that contains AND logic within the flow. Which expression should you use for the IF statement?

A)

```
IF $'' '%IsEmpty(Variable1)% AND %IsEmpty(Variable2)%'' = $'''True'''
```

B)

```
IF IsEmpty(IsEmpty(Variable1) AND IsEmpty(Variable2))
```

C)

```
IF IsEmpty(Variable1 AND Variable2)
```

D)

```
IF (IsEmpty(Variable1) OR IsEmpty(Variable2)) = $'''True'''
```

E)

```
IF (IsEmpty(Variable1) AND IsEmpty(Variable2)) = $'''True'''
```

- A. Option A
- B. Option B
- C. Option C
- D. Option D

Answer: C

NEW QUESTION 62

- (Exam Topic 3)

You are designing automation processes for a company.

You need to select the appropriate action for each automation scenario.
Which actions should you perform? To answer, select the appropriate options in the answer area. NOTE: Each correct selection is worth one point.

Answer Area

Requirement	Action
Automate keyboard input and mouse movements for a product ordering website that does not have an API.	<div>Add an HTTP trigger. Create a custom connector. Create a desktop flow.</div>
Automate a process for a desktop application that provides an API with authenticated access.	<div>Create and run a dataflow. Create a custom connector. Create and run a Dataverse view. Create a desktop flow.</div>
Automate keyboard input and mouse movements for a desktop application.	<div>Create a custom connector. Create a cloud flow. Create a desktop flow.</div>

- A. Mastered
- B. Not Mastered

Answer: A

Explanation:

Answer Area

Requirement	Action
Automate keyboard input and mouse movements for a product ordering website that does not have an API.	<div>Add an HTTP trigger. Create a custom connector. Create a desktop flow.</div>
Automate a process for a desktop application that provides an API with authenticated access.	<div>Create and run a dataflow. Create a custom connector. Create and run a Dataverse view. Create a desktop flow.</div>
Automate keyboard input and mouse movements for a desktop application.	<div>Create a custom connector. Create a cloud flow. Create a desktop flow.</div>

NEW QUESTION 65

.....

Relate Links

100% Pass Your PL-500 Exam with ExamBible Prep Materials

<https://www.exambible.com/PL-500-exam/>

Contact us

We are proud of our high-quality customer service, which serves you around the clock 24/7.

Viste - <https://www.exambible.com/>