



Microsoft

Exam Questions PL-500

Microsoft Power Automate RPA Developer

About ExamBible

[Your Partner of IT Exam](#)

Found in 1998

ExamBible is a company specialized on providing high quality IT exam practice study materials, especially Cisco CCNA, CCDA, CCNP, CCIE, Checkpoint CCSE, CompTIA A+, Network+ certification practice exams and so on. We guarantee that the candidates will not only pass any IT exam at the first attempt but also get profound understanding about the certificates they have got. There are so many alike companies in this industry, however, ExamBible has its unique advantages that other companies could not achieve.

Our Advances

* 99.9% Uptime

All examinations will be up to date.

* 24/7 Quality Support

We will provide service round the clock.

* 100% Pass Rate

Our guarantee that you will pass the exam.

* Unique Gurantee

If you do not pass the exam at the first time, we will not only arrange FULL REFUND for you, but also provide you another exam of your claim, ABSOLUTELY FREE!

NEW QUESTION 1

- (Exam Topic 1)
You need to ensure that the solution uses the correct accounts payable mailbox. Which three actions should you perform? Each correct answer part of the solution, NOTE: Each correct selection is worth one point.

- A. Set the current value for the accounts payable mailbox in the environment.
- B. Set the default value for the accounts payable mailbox in the environment.
- C. Turn off and then turn on the cloud flows.
- D. Use separate environment variables for the cloud flow and the canvas app.
- E. Use one environment variable for both the cloud flows and the canvas app.

Answer: ACD

NEW QUESTION 2

- (Exam Topic 1)
You need to determine the causes for the reported issues.
What are the causes? To answer, select the appropriate options in the answer area. NOTE: Each correct selection is worth one point.

Answer Area	
Issue	Cause
New environment	<div>Flow checker did not run.</div> <div>Admin mode is turned on.</div> <div>Admin mode is turned off.</div> <div>A connector was added to a DLP policy.</div>
FlowA	<div>The user is in the wrong environment.</div> <div>The user does not have the correct permissions.</div>
Dataverse error	<div>There is no Microsoft Dataverse database provisioned.</div> <div>The user did not sign into Power Automate by using a Microsoft work account.</div> <div>Microsoft Dataverse was not shared with the user from the development environment.</div>

- A. Mastered
- B. Not Mastered

Answer: A

Explanation:

Answer Area	
Issue	Cause
New environment	<div>Flow checker did not run.</div> <div>Admin mode is turned on.</div> <div>Admin mode is turned off.</div> <div>A connector was added to a DLP policy.</div>
FlowA	<div>The user is in the wrong environment.</div> <div>The user does not have the correct permissions.</div>
Dataverse error	<div>There is no Microsoft Dataverse database provisioned.</div> <div>The user did not sign into Power Automate by using a Microsoft work account.</div> <div>Microsoft Dataverse was not shared with the user from the development environment.</div>

NEW QUESTION 3

- (Exam Topic 2)
You need to address the issue with the capacity planning flow. What should you do?

- A. Increase the CPU and memory of the machine on which the gateway is hosted.
- B. Create a gateway cluster.
- C. Configure the system to send alerts when the gateway fails.
- D. Create a machine group and add machines to the group to handle requests.

Answer: D

NEW QUESTION 4

- (Exam Topic 2)
You need to configure the desktop action for the MaintenanceScheduler cloud flow. Which two actions should you perform? Each correct answer presents part of the solution. NOTE: Each correct selection is worth one point.

- A. Select machine settings in Power Automate for desktop.
- B. Select the Timeout property and update the duration to PT20M.
- C. Select the Timeout property and update the duration to P20M.

- D. Launch Power Automate for desktop.
- E. Navigate to Desktop flow action settings in the cloud flow.

Answer: AD

NEW QUESTION 5

- (Exam Topic 2)

You need to configure sharing for MaintenanceScheduler.

Which sharing methods should you use? To answer, select the appropriate options in the answer area. NOTE: Each correct selection is worth one point.

Answer Area

User	Sharing method
User1	<div><div></div><div>Share as user</div><div>Share as owner</div><div>Share as co-owner</div><div>Share as run-only user</div></div>
User2	<div><div></div><div>Share as user</div><div>Share as owner</div><div>Share as co-owner</div><div>Share as run-only user</div></div>
User3	<div><div></div><div>Share as user</div><div>Share as owner</div><div>Share as co-owner</div><div>Share as run-only user</div></div>

- A. Mastered
- B. Not Mastered

Answer: A

Explanation:

Answer Area

User	Sharing method
User1	<div><div></div><div>Share as user</div><div>Share as owner</div><div>Share as co-owner</div><div>Share as run-only user</div></div>
User2	<div><div></div><div>Share as user</div><div>Share as owner</div><div>Share as co-owner</div><div>Share as run-only user</div></div>
User3	<div><div></div><div>Share as user</div><div>Share as owner</div><div>Share as co-owner</div><div>Share as run-only user</div></div>

NEW QUESTION 6

- (Exam Topic 2)

You need to package the automations. What should you do?

- A. Show dependencies within the solution.
- B. Remove unmanaged layers.
- C. Add required components to each item within the solution.
- D. Add existing components to the solution.

Answer: B

NEW QUESTION 7

- (Exam Topic 3)

You develop automation solutions for a company. The company does not permit changes to a deployed solution in user acceptance testing (UAT) a environments. You need to package the solutions.

Which type of solutions should you create? To answer, drag the appropriate solution types to the correct requirements. Each solution type may be used once, more the once, or not at all. You may need to drag the split bar between panes or scroll to view content.

NOTE: Each correct selection is worth one point.

Solution types	Answer Area
<div>Unmanaged</div> <div>Managed</div>	<div>Requirement</div> <div>Deploy a solution to a source control system.</div> <div>Deploy a solution to a user acceptance testing (UAT) environment.</div> <div>Deploy a solution to a production environment.</div> <div>Deploy a solution to another development environment.</div> <div>Solution type</div> <div><div>Solution type</div></div> <div><div>Solution type</div></div> <div><div>Solution type</div></div> <div><div>Solution type</div></div>

- A. Mastered
- B. Not Mastered

Answer: A

Explanation:

Solution types	Answer Area
<div>Unmanaged</div> <div>Managed</div>	<div>Requirement</div> <div>Deploy a solution to a source control system.</div> <div>Deploy a solution to a user acceptance testing (UAT) environment.</div> <div>Deploy a solution to a production environment.</div> <div>Deploy a solution to another development environment.</div> <div>Solution type</div> <div><div>Unmanaged</div></div> <div><div>Unmanaged</div></div> <div><div>Managed</div></div> <div><div>Unmanaged</div></div>

NEW QUESTION 8

- (Exam Topic 3)

You are developing automation solutions for a company. You need to use an environment variable in a cloud flow. Which three actions should you perform in sequence? To answer, move the appropriate actions from the list of actions to the order.

Actions	Answer Area
<div>Add an environment variable to a solution.</div> <div>Create a cloud flow in a solution.</div> <div>Navigate to https://flow.microsoft.com.</div> <div>Navigate to https://admin.powerplatform.com.</div> <div>Select the desired environment variable.</div>	<div><div>></div></div> <div><div><</div></div>

- A. Mastered
- B. Not Mastered

Answer: A

Explanation:

Actions	Answer Area
<div>Add an environment variable to a solution.</div> <div>Create a cloud flow in a solution.</div> <div>Navigate to https://flow.microsoft.com.</div> <div>Navigate to https://admin.powerplatform.com.</div> <div>Select the desired environment variable.</div>	<div><div>Create a cloud flow in a solution.</div></div> <div><div>></div></div> <div><div>Navigate to https://admin.powerplatform.com.</div></div> <div><div><</div></div> <div><div>Add an environment variable to a solution.</div></div>

NEW QUESTION 9

- (Exam Topic 3)

A company publishes a list of contacts each day as an HTML table on a web page. The company has a customer relationship management (CRM) application that

runs on employee desktop devices.

You need to implement an RPA solution that reads data from the HTML table and create records in the CRM application.

Which four actions should you perform in sequence? To answer, move the appropriate actions from the list of actions to the answer area and arrange them in the correct order.

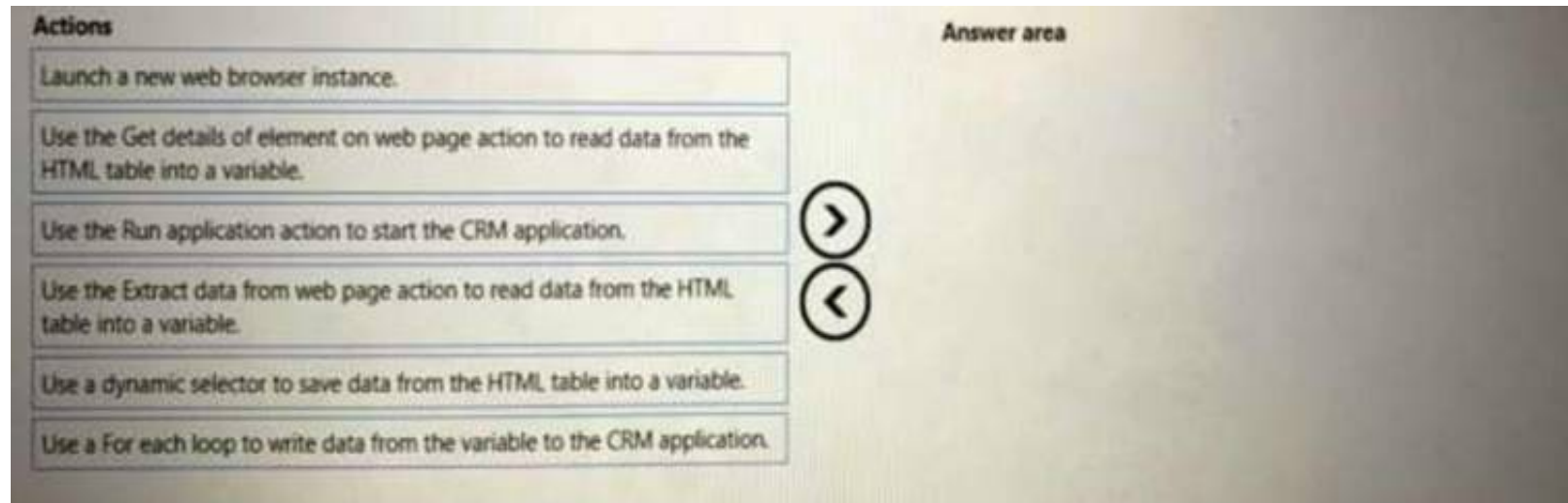

The screenshot shows a list of actions on the left and an empty answer area on the right. The actions are:

- Launch a new web browser instance.
- Use the Get details of element on web page action to read data from the HTML table into a variable.
- Use the Run application action to start the CRM application.
- Use the Extract data from web page action to read data from the HTML table into a variable.
- Use a dynamic selector to save data from the HTML table into a variable.
- Use a For each loop to write data from the variable to the CRM application.

Between the two columns are two circular arrows, one pointing right and one pointing left, indicating a drag-and-drop interface.

- A. Mastered
- B. Not Mastered

Answer: A

Explanation:

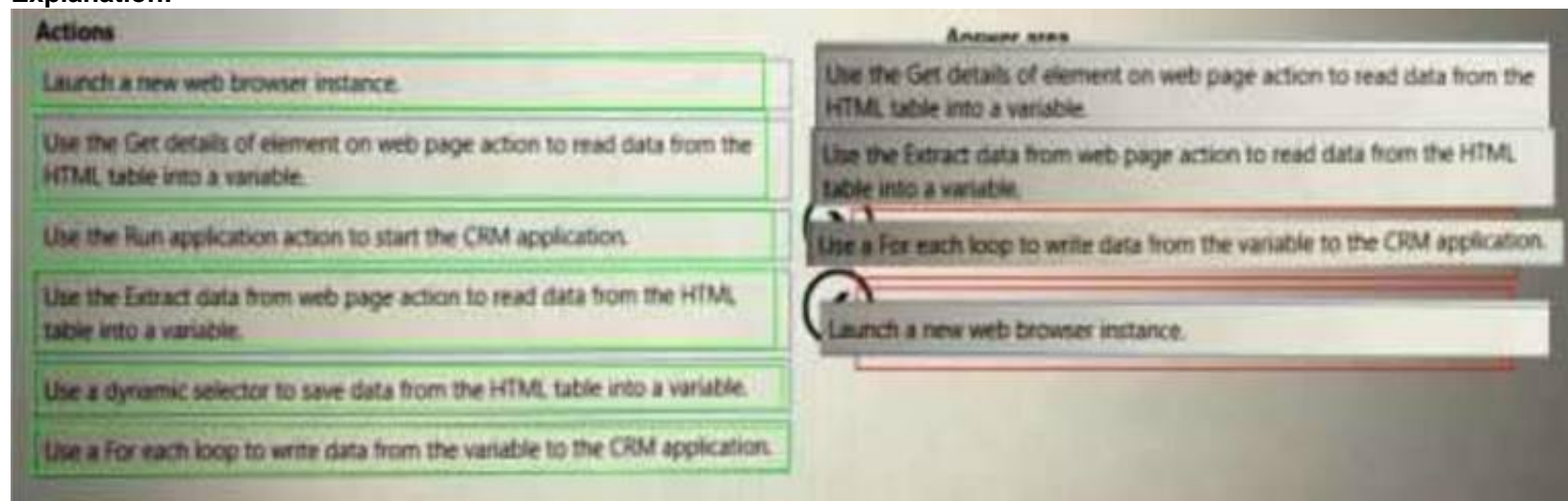

The screenshot shows the same list of actions and answer area as before. The correct sequence of four actions is highlighted with a green border and red arrows indicating the order:

- Use the Get details of element on web page action to read data from the HTML table into a variable.
- Use the Extract data from web page action to read data from the HTML table into a variable.
- Use a For each loop to write data from the variable to the CRM application.
- Launch a new web browser instance.

NEW QUESTION 10

- (Exam Topic 3)

You are creating a solution that will use a Choice field for approvals.

You need to ensure that other users can use the Choice field with their Microsoft Dataverse tables.

What should you use?

- A. Environment variable
- B. Local choice
- C. Global choice

Answer: C

NEW QUESTION 10

- (Exam Topic 3)

You are preparing to share a desktop flow. You need to share the flow with another user. Which two methods can you use? Each correct answer presents a complete solution.

NOTE: Each correct selection is worth one point.

- A. Share the desktop flow by using the Microsoft Power Platform admin center.
- B. Share the desktop flow by using the Power Automate portal
- C. Grant the user permissions to access the flow.
- D. Export a solution that contains the desktop flow and provide the solution to the user.
- E. Create a managed solution that contains the desktop flow and share the solution with another user.

Answer: CD

NEW QUESTION 11

- (Exam Topic 3)

You plan to use a cloud flow.

The flow must be contained within a solution. You need to add the cloud flow to a solution.

Solution: Add an existing cloud flow from a managed solution to a new unmanaged solution. Does the solution meet the goal?

- A. Yes
- B. No

Answer: B

NEW QUESTION 12

- (Exam Topic 3)

You are trying to record the process that a hospitality facility uses to check in patients. You need to identify bottlenecks and variations in the process. What should you use?

- A. Process Advisor
- B. Flow checker
- C. AI Builder
- D. Solution checker

Answer: D

NEW QUESTION 13

- (Exam Topic 3)

A company uses Microsoft 365 apps. You are building a flow that is triggered when a new email arrives.

If an email message contains a Microsoft Excel workbook attachment the solution must post the Excel data to an external customer relationship management (CRM) system that runs on a user's workstation. The CRM system is not accessible by using an API.

You need to design the solution.

Which three actions should you perform? Each correct answer presents part of the solution. NOTE: Each correct selection is worth one point.

- A. Implement the Create file action from the OneDrive connector in a cloud flow.
- B. Create a desktop flow.
- C. Implement the When a new email arrives trigger in a cloud flow.
- D. Implement the Retrieve email messages action from a desktop flow.
- E. Create a desktop flow and define an input variable of type file.

Answer: ACE

NEW QUESTION 16

- (Exam Topic 3)

You are developing automation solutions for a company.

You plan to use Process advisor to gain a better understanding of business processes. You need to select the process types to use to meet the company's requirements.

Which process types should you use? To answer, drag the appropriate process types to the correct requirements. Each process type may be used once, more than once, or not at all. You may need to drag the split bar between panes or scroll to view content.

NOTE: Each correct selection is worth one point.

Process types		Requirement	Process type
Process mining		Identify and eliminate unnecessary process tasks.	Process type
Task mining		Reduce total process time.	Process type
		Automate tasks that will accelerate processes and reduce human error.	Process type

- A. Mastered
- B. Not Mastered

Answer: A

Explanation:

Process types		Requirement	Process type
Process mining		Identify and eliminate unnecessary process tasks.	Task mining
Task mining		Reduce total process time.	Task mining
		Automate tasks that will accelerate processes and reduce human error.	Process mining

NEW QUESTION 18

- (Exam Topic 3)

You are developing a cloud flow.

The flow must be able to query several Azure endpoints and must use standard actions where possible. You need to configure the flow.

Which actions should you use? To answer, select the appropriate options in the answer area. NOTE: Each correct selection is worth one point.

Requirement	Action
Issue POST requests to the Microsoft Graph API by using application permissions.	HTTP HTTP with Azure AD Send an HTTP request to SharePoint Office 365 groups send an HTTP request
Issue GET requests to the Microsoft Graph API by using delegated permissions.	HTTP HTTP with Azure AD Send an HTTP request to SharePoint Office 365 groups send an HTTP request
Issue GET requests to the SharePoint REST API by using delegated permissions.	HTTP HTTP with Azure AD Send an HTTP request to SharePoint Office 365 groups send an HTTP request
Issue GET requests to the SharePoint REST API by using delegated permissions.	HTTP HTTP with Azure AD Send an HTTP request to SharePoint Office 365 groups send an HTTP request
Issue POST requests to SharePoint REST API by using application permissions.	HTTP HTTP with Azure AD Send an HTTP request to SharePoint Office 365 groups send an HTTP request

- A. Mastered
B. Not Mastered

Answer: A

Explanation:

Requirement	Action
Issue POST requests to the Microsoft Graph API by using application permissions.	HTTP HTTP with Azure AD Send an HTTP request to SharePoint Office 365 groups send an HTTP request
Issue GET requests to the Microsoft Graph API by using delegated permissions.	HTTP HTTP with Azure AD Send an HTTP request to SharePoint Office 365 groups send an HTTP request
Issue GET requests to the SharePoint REST API by using delegated permissions.	HTTP HTTP with Azure AD Send an HTTP request to SharePoint Office 365 groups send an HTTP request
Issue GET requests to the SharePoint REST API by using delegated permissions.	HTTP HTTP with Azure AD Send an HTTP request to SharePoint Office 365 groups send an HTTP request
Issue POST requests to SharePoint REST API by using application permissions.	HTTP HTTP with Azure AD Send an HTTP request to SharePoint Office 365 groups send an HTTP request

NEW QUESTION 22

- (Exam Topic 3)

You are developing a solution for a medical practice. The solution must use an artificial intelligence (AI) model to evaluate medical X-ray images and detect broken bones.

You need to create the AI model for the solution. Solution: Use Visual Studio to create the model.

Does the solution meet the goal?

- A. Yes
B. No

Answer: A

NEW QUESTION 24

- (Exam Topic 3)

You are designing automation processes.

You need to configure the run mode for each automation scenario.

Which run modes should you use? To answer, drag the appropriate run modes to the correct scenarios. Each run mode may be used once, more than once, or not at all. You may need to drag the split bar between panes or scroll to view content.

NOTE: Each correct selection is worth one point.

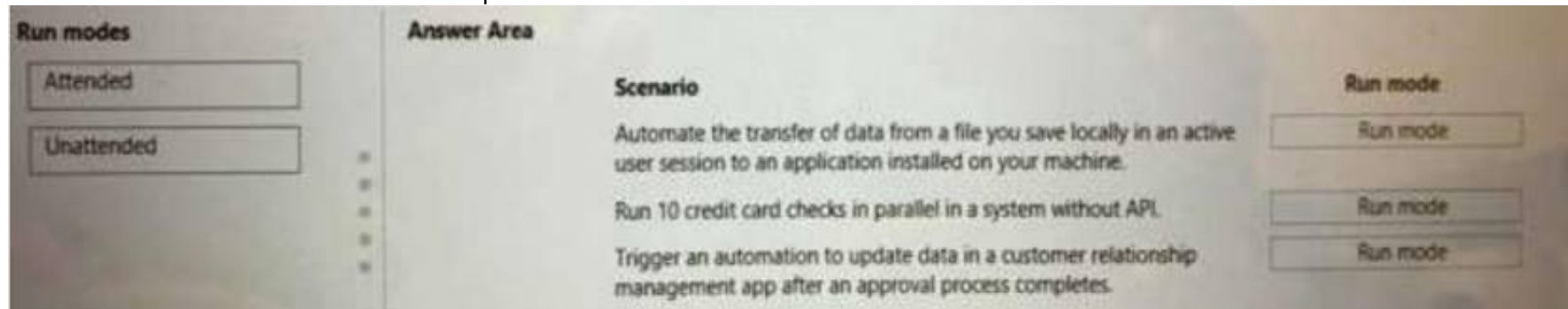

- A. Mastered
- B. Not Mastered

Answer: A

Explanation:

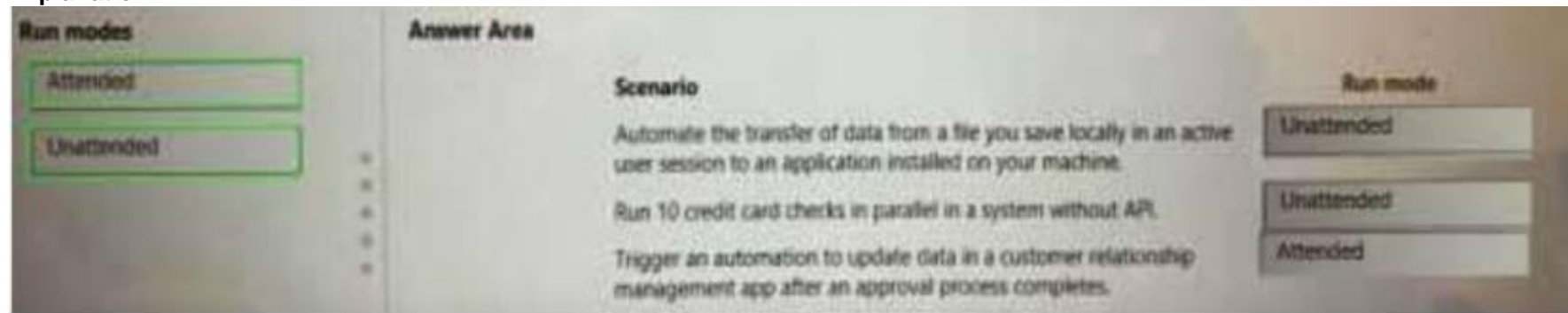

NEW QUESTION 29

- (Exam Topic 3)

You develop automation solutions for a company.

You need to implement actions to meet the company's requirements.

What should you do? To answer, select the appropriate options in the answer area. NOTE: Each correct selection is worth one point.

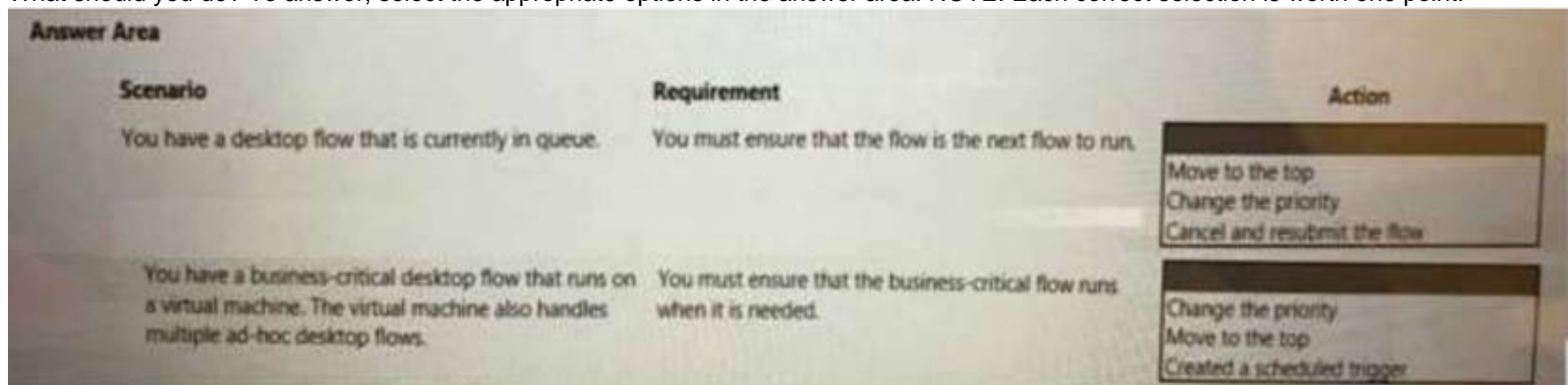

- A. Mastered
- B. Not Mastered

Answer: A

Explanation:

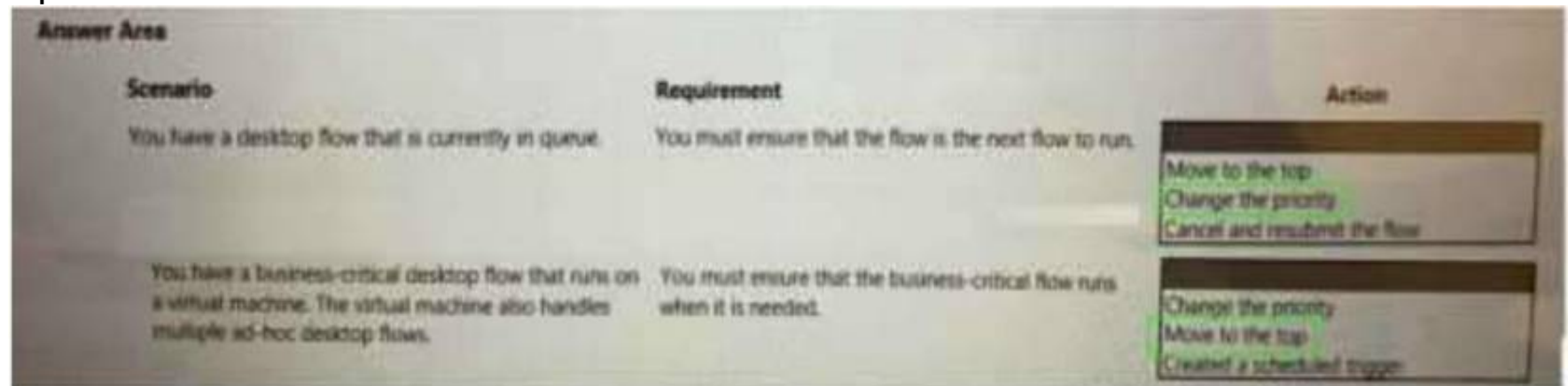

NEW QUESTION 30

- (Exam Topic 3)

You develop a desktop flow. The flow performs five actions in sequence.

If an error occurs, you must restart the flow from the first action. You add the five actions to an On block error action.

You need to configure error handling.

Which two actions should you perform? Each correct answer presents part of the solution. NOTE: Each correct selection is worth one point.

- A. Change the exception handling mode to Go to the beginning of the block.
- B. Select Continue flow run.
- C. Select Throw error.
- D. Change the exception handling mode to Go to next action.
- E. Configure an On error condition for the first action.

Answer: ACE

NEW QUESTION 34

- (Exam Topic 3)

You must create new flows within a solution and import existing flows into the solution. You need to configure the solution.

Which three actions can you perform? Each correct answer presents a complete solution. NOTE: Each correct selection is worth one point.

- A. Create the flows within the solution to automatically create connection references.
- B. Add credential information to each connection reference.
- C. Modify each trigger and action when you add a flow into the solution to use connection references
- D. Select connections for connection references when you import solutions into an environment
- E. Add an existing connection reference into the solution in the same environment.

Answer: ADE

NEW QUESTION 39

- (Exam Topic 3)

You are developing a cloud flow.

The flow must be able to query several Azure endpoints and must use standard actions where possible. You need to configure the flow.

Which actions should you use? To answer, select the appropriate options in the answer area. NOTE: Each correct selection is worth one point.

Answer Area

Requirement	Action
Issue POST requests to the Microsoft Graph API by using application permissions.	HTTP HTTP with Azure AD Send an HTTP request to SharePoint Office 365 groups send an HTTP request
Issue GET requests to the Microsoft Graph API by using delegated permissions.	HTTP HTTP with Azure AD Send an HTTP request to SharePoint Office 365 groups send an HTTP request
Issue POST requests to Office 365 Management APIs by using delegated permissions.	HTTP HTTP with Azure AD Send an HTTP request to SharePoint Office 365 groups send an HTTP request
Issue GET requests to the SharePoint REST API by using delegated permissions.	HTTP HTTP with Azure AD Send an HTTP request to SharePoint Office 365 groups send an HTTP request
Issue POST requests to SharePoint REST API by using application permissions.	HTTP HTTP with Azure AD Send an HTTP request to SharePoint Office 365 groups send an HTTP request

- A. Mastered
- B. Not Mastered

Answer: A

Explanation:

Answer Area	
Requirement	Action
Issue POST requests to the Microsoft Graph API by using application permissions.	<div> HTTP HTTP with Azure AD Send an HTTP request to SharePoint Office 365 groups send an HTTP request </div>
Issue GET requests to the Microsoft Graph API by using delegated permissions.	<div> HTTP HTTP with Azure AD Send an HTTP request to SharePoint Office 365 groups send an HTTP request </div>
Issue POST requests to Office 365 Management APIs by using delegated permissions.	<div> HTTP HTTP with Azure AD Send an HTTP request to SharePoint Office 365 groups send an HTTP request </div>
Issue GET requests to the SharePoint REST API by using delegated permissions.	<div> HTTP HTTP with Azure AD Send an HTTP request to SharePoint Office 365 groups send an HTTP request </div>
Issue POST requests to SharePoint REST API by using application permissions.	<div> HTTP HTTP with Azure AD Send an HTTP request to SharePoint Office 365 groups send an HTTP request </div>

NEW QUESTION 40

- (Exam Topic 3)

You are developing a cloud flow.

You write expressions for the following JSON object. (Line numbers are included for reference only.)

```

01  {
02    "customerNumber": 10091,
03    "customerPhones": [
04      "011-2345213",
05      "0114456129"
06    ]
07  }
```

The flow parses JSON data by using the following schema;

```
09 {
10   "type": "object",
11   "properties": {
12     "customerName": {
13       "type": [
14         "string",
15         "null"
16       ]
17     },
18     "customerNumber": {
19       "type": "integer"
20     },
21     "customerPhones": {
22       "type": "array",
23       "minItems": 1,
24       "items": {
25         "type": "string"
26       }
27     }
28   }
29 }
```

For each of the following statements, select Yes if the statement is true. Otherwise, select No. NOTE: Each correct selection is worth one point.

Answer Area

Statements	Yes	No
The expression <code>empty(body('Parse_JSON')['customerName'])</code> returns true.	<input type="radio"/>	<input type="radio"/>
The expression <code>concat(body('Parse_JSON').customerName, ': ', body('Parse_JSON').customerNumber)</code> returns 10091.	<input type="radio"/>	<input type="radio"/>
The expression <code>equals(body('Parse_JSON')?.customerPhones[2], '')</code> returns true.	<input type="radio"/>	<input type="radio"/>
The expression <code>int(body('Parse_JSON')?['customerPhones']?[1])</code> returns 114456129.	<input type="radio"/>	<input type="radio"/>

- A. Mastered
- B. Not Mastered

Answer: A

Explanation:

Answer Area

Statements	Yes	No
The expression <code>empty(body('Parse_JSON')['customerName'])</code> returns true.	<input checked="" type="radio"/>	<input type="radio"/>
The expression <code>concat(body('Parse_JSON').customerName, ': ', body('Parse_JSON').customerNumber)</code> returns 10091.	<input checked="" type="radio"/>	<input type="radio"/>
The expression <code>equals(body('Parse_JSON')?.customerPhones[2], '')</code> returns true.	<input checked="" type="radio"/>	<input type="radio"/>
The expression <code>int(body('Parse_JSON')?['customerPhones']?[1])</code> returns 114456129.	<input type="radio"/>	<input checked="" type="radio"/>

NEW QUESTION 45

- (Exam Topic 3)

A company hires you to develop a solution that helps the company manage new hires. Users will enter information about the new employee into an app and the app will save the information to a database.

The app must be simple to use and must rely on a data model. You must implement a workflow that automatically notifies the IT department when new employee records are created in the database.
 You need to create the solution.
 Which three actions should you perform in sequence? To answer, move the appropriate actions from the list of actions to the answer area and arrange them in the correct order.

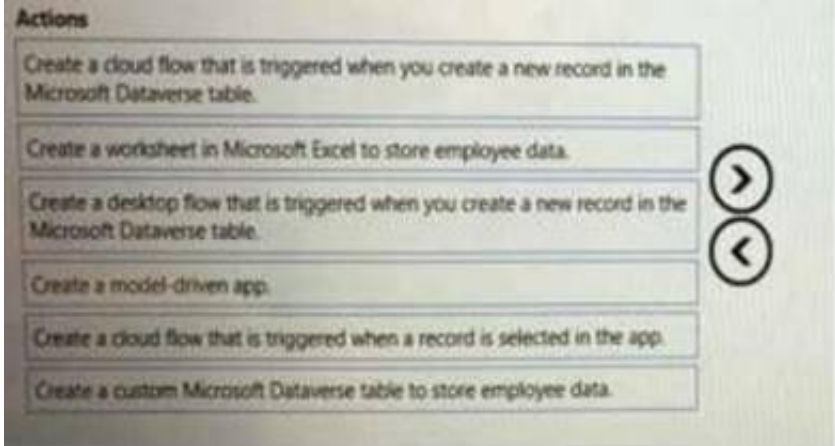

- A. Mastered
- B. Not Mastered

Answer: A

Explanation:

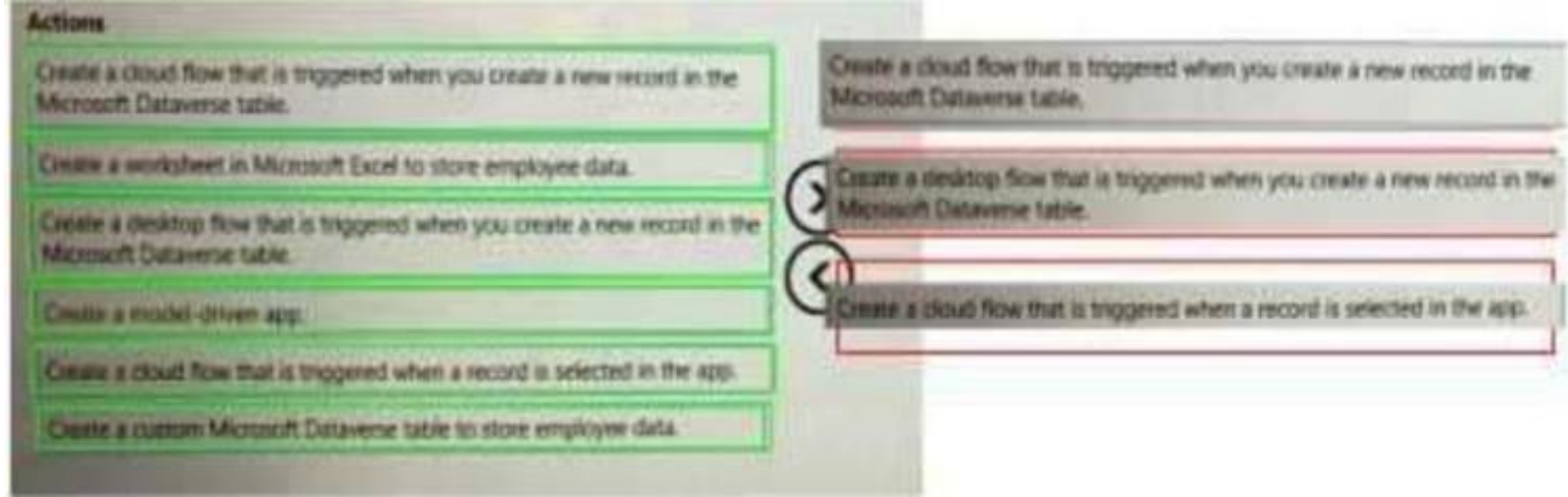

NEW QUESTION 47

- (Exam Topic 3)
 You have a Microsoft Dataverse table in a solution. You delete fields from the table.
 You need to automatically delete the fields from the Microsoft Dataverse table when you import the updated solution into a target environment.
 Which import option should you use?

- A. Stage for upgrade
- B. Update
- C. Upgrade

Answer: C

NEW QUESTION 50

- (Exam Topic 3)
 You develop automation solutions for a company.
 When a new record is added to a Microsoft Dataverse table, the solution must add the contents of the record to a Microsoft Word Online (Business) template. The solution must convert the template to a PDF document and email the PDF document to a stakeholder.
 You need to design the solution.
 Which three actions should you perform? Each correct answer presents part of the solution. NOTE: Each correct selection is worth one point.

- A. Use the Populate a Microsoft Word Online (Business) template action in a desktop flow.
- B. Create a cloud flow that uses the When a row is added or modified trigger in Microsoft Dataverse.
- C. Use the Populate a Microsoft Word Online (Business) template action in a cloud flow.
- D. Use the Convert Word Document to PDF and Send an email actions in a cloud flow.
- E. Use the Convert Word Document to PDF and Send an email actions in a desktop flow.

Answer: ABE

NEW QUESTION 52

- (Exam Topic 3)
 You are developing a new release for an automation solution. You need to use the right feature.
 Which feature should you use? To answer, select the appropriate options in the answer area. NOTE: Each correct selection is worth one point.

Scenario	Action
Upgrade a single cloud flow from a solution.	Clone a patch. Clone a solution. Export as managed solution. Export as unmanaged solution.
Release a new major version of a solution.	Clone a patch. Clone a solution. Export as managed solution. Export as unmanaged solution.
Synchronize solution components between development and production environments.	Update. Upgrade. Import as managed solution. Import as unmanaged solution.
Overwrite a solution in a production environment.	Update. Upgrade. Import as managed solution. Import as unmanaged solution.

- A. Mastered
- B. Not Mastered

Answer: A

Explanation:

Scenario	Action
Upgrade a single cloud flow from a solution.	Clone a patch. Clone a solution. Export as managed solution. Export as unmanaged solution.
Release a new major version of a solution.	Clone a patch. Clone a solution. Export as managed solution. Export as unmanaged solution.
Synchronize solution components between development and production environments.	Update. Upgrade. Import as managed solution. Import as unmanaged solution.
Overwrite a solution in a production environment.	Update. Upgrade. Import as managed solution. Import as unmanaged solution.

NEW QUESTION 54

- (Exam Topic 3)

You have a desktop flow that interacts with a desktop-based application. You plan to enter data into each field by using the Send keys action. You test the flow. The Send keys action runs successfully but the input fields are empty. You need to add a step before the Send keys action to resolve the issue. Which two steps can you use? Each correct answer presents a complete solution. NOTE: Each correct selection is worth one point.

- A. Use the Wait for window action.
- B. Set the key state.
- C. Use the Focus window action.
- D. Set the window state.
- E. Use the Wait for mouse action

Answer: DE

NEW QUESTION 58

- (Exam Topic 3)

You are developing a desktop flow that reads data from a table in a Microsoft Excel workbook. You need to read the cell in the fourth row and first column of the table. Which two expressions can you use? Each correct answer presents a complete solution.

NOTE: Each correct answer is worth one point.

- A. %ExcelData[4]['Column1']%
- B. %ExcelData[1][4]%
- C. %ExcelData["Column1"][4]X
- D. XExcelData[4][9]X

Answer: D

NEW QUESTION 59

- (Exam Topic 3)

A company develops an automation solution.

You need to manage the flows. To answer, select the appropriate options in the answer area. NOTE: Each correct selection is worth one point.

Answer Area

Requirement	Action
You must run one specific flow from the queue after a flow which is currently running completes.	<div><div>In the desktop flow queue: select move to top.</div><div>In the desktop flow queue: change the priority.</div><div>In the cloud flow: change the priority for the desktop flow action to High.</div></div>
You develop an automation. The automation must run at high priority each time it runs.	<div><div>In the Desktop flow runs page: change the priority.</div><div>In the Desktop flow run queue: change the priority.</div><div>In the cloud flow: change the priority for the desktop flow action to High.</div></div>

- A. Mastered
- B. Not Mastered

Answer: A

Explanation:

Answer Area

Requirement	Action
You must run one specific flow from the queue after a flow which is currently running completes.	<div><div>In the desktop flow queue: select move to top.</div><div>In the desktop flow queue: change the priority.</div><div>In the cloud flow: change the priority for the desktop flow action to High.</div></div>
You develop an automation. The automation must run at high priority each time it runs.	<div><div>In the Desktop flow runs page: change the priority.</div><div>In the Desktop flow run queue: change the priority.</div><div>In the cloud flow: change the priority for the desktop flow action to High.</div></div>

NEW QUESTION 62

- (Exam Topic 3)

You need to design automation solutions for a company.

What should you implement? To answer, select the appropriate configuration in the answer area. NOTE: Each correct selection is worth one point.

Scenario	Technology
Sign into a web application that does not have an API and download a CSV file.	Cloud flow Desktop flow File system connector Outlook connector
Access a CSV file from a local drive.	SharePoint connector OneDrive connector File system connector Outlook connector
Send an email that includes a CSV file attachment.	SharePoint connector OneDrive connector File system connector Outlook connector

- A. Mastered
- B. Not Mastered

Answer: A

Explanation:

Scenario	Technology
Sign into a web application that does not have an API and download a CSV file.	Cloud flow Desktop flow File system connector Outlook connector
Access a CSV file from a local drive.	SharePoint connector OneDrive connector File system connector Outlook connector
Send an email that includes a CSV file attachment.	SharePoint connector OneDrive connector File system connector Outlook connector

NEW QUESTION 65

- (Exam Topic 3)

You deploy a cloud flow to a production environment. You make changes to the cloud flow in a development environment

You import the updated solution to the production environment. You observe that the cloud flow is not updated.

You need to resolve the issue.

Which four actions should you perform in sequence? To answer, move the appropriate actions from the list of actions to the answer area and arrange them in the correct order.

Actions

Remove all dependencies.

Show solution layers.

Select the cloud flow that was upgraded.

Show dependencies.

Remove all unmanaged layers.

In the production environment, navigate to the solution contents.

In the development environment, navigate to the solution contents.

Answer Area

>

<

↑

↓

- A. Mastered
- B. Not Mastered

Answer: A

Explanation:

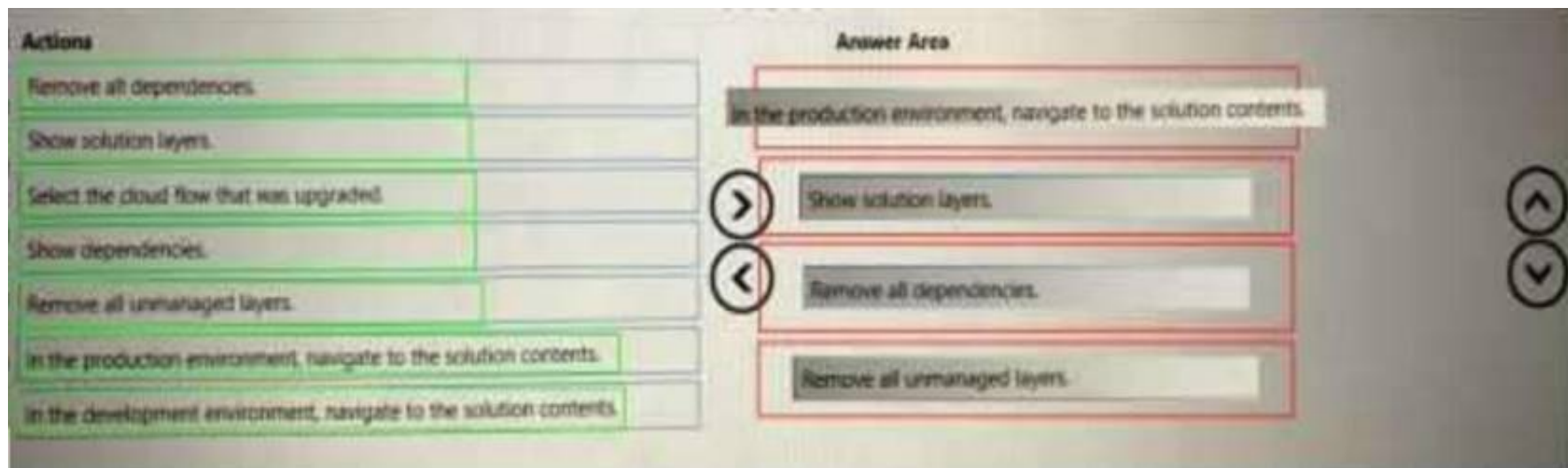

NEW QUESTION 66

- (Exam Topic 3)

You create an unattended Office 365 automation. The automation stops running.

You suspect that the runtime identity used by the automation caused the automation to stop running. Which two issues can the runtime identity cause in this scenario? Each correct answer presents a complete solution. NOTE: Each correct selection is worth one point.

- A. The automation is attempting to open files that cannot be opened or edited based on per-user access permissions
- B. The automation is not set up to handle an additional sign-in UI element.
- C. The unattended automation process suppressed an alert that was generated.
- D. The location of a specific user interface element has changed.

Answer: BD

NEW QUESTION 68

- (Exam Topic 3)

You are designing automation solutions that interact with a desktop application.

You need to select the appropriate UI automation action for each business requirement.

Which automation action should you use? To answer, select the appropriate options in the answer area. NOTE: Each correct selection is worth one point.

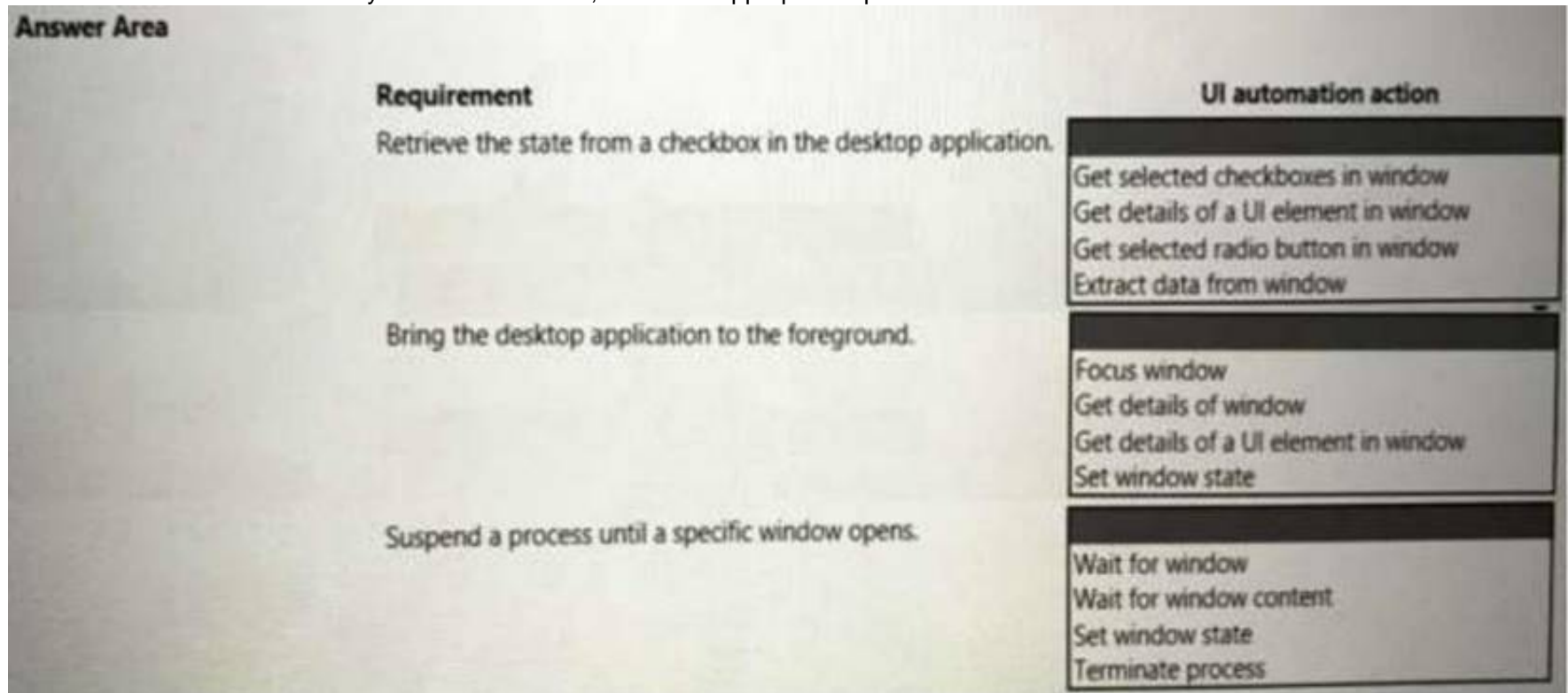

- A. Mastered
- B. Not Mastered

Answer: A

Explanation:

Requirement	UI automation action
Retrieve the state from a checkbox in the desktop application.	<div>Get selected checkboxes in window</div> <div>Get details of a UI element in window</div> <div>Get selected radio button in window</div> <div>Extract data from window</div>
Bring the desktop application to the foreground.	<div>Focus window</div> <div>Get details of window</div> <div>Get details of a UI element in window</div> <div>Set window state</div>
Suspend a process until a specific window opens.	<div>Wait for window</div> <div>Wait for window content</div> <div>Set window state</div> <div>Terminate process</div>

NEW QUESTION 72

- (Exam Topic 3)

You are developing a solution for a medical practice. The solution must use an artificial intelligence (AI) model to evaluate medical X-ray images and detect broken bones.

You need to create the AI model for the solution. Solution: Use Azure machine learning to create the model. Does the solution meet the goal?

- A. Yes
- B. No

Answer: B

NEW QUESTION 73

- (Exam Topic 3)

You create a solution within a Microsoft Power Platform environment. The environment includes all connections required for the solution.

You need to create a connection reference for the flows.

Which four actions should you perform in sequence? To answer, move the appropriate actions from the list of actions to the answer area and arrange them in the order.

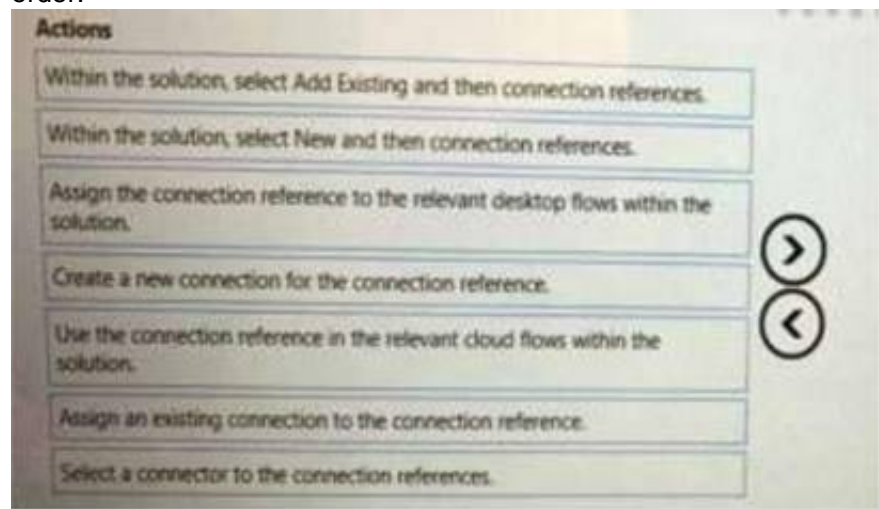

- A. Mastered
- B. Not Mastered

Answer: A

Explanation:

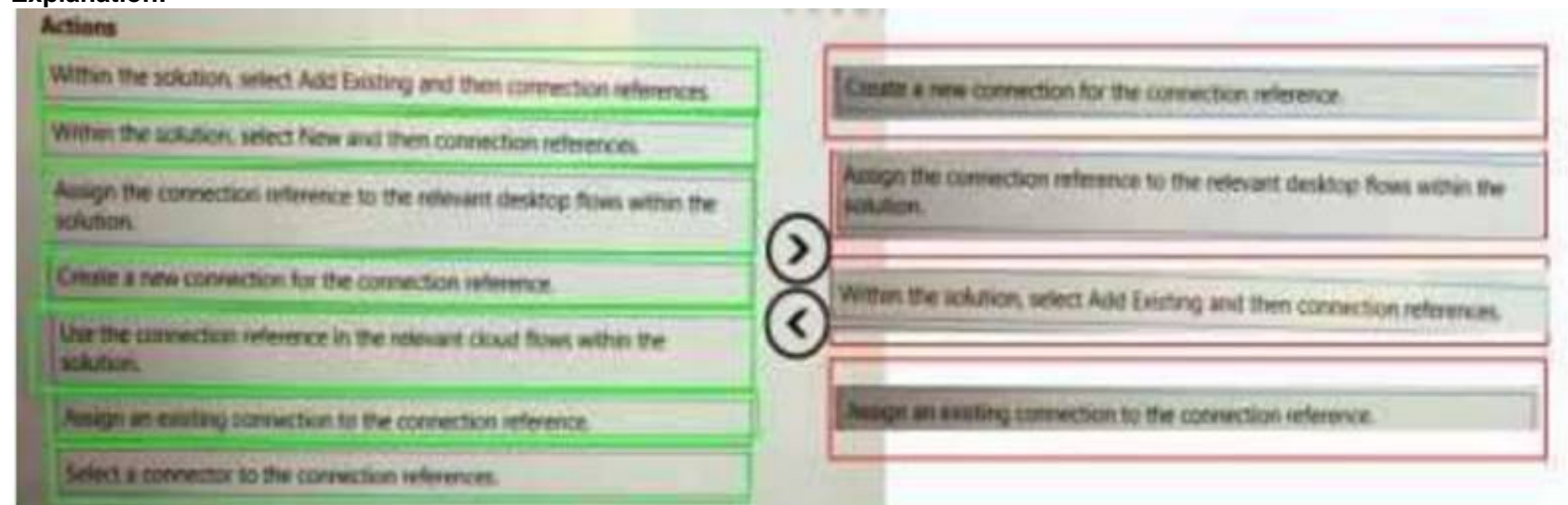

NEW QUESTION 77

- (Exam Topic 3)

A company stores confidential documents in a SharePoint document library.

A developer must create an automation solution in a default environment that processes documents from the SharePoint library and uploads approved documents to Azure File Storage for archiving purposes. The automation must meet the following requirements:

- Prevent modification or deletion of approved documents from Azure File Storage.
- Prevent sharing of documents from SharePoint or Azure File Storage. You need to configure a data loss prevention (DLP) policy.

Which five actions should you perform in sequence? To answer, move the appropriate actions from the list of actions to the answer area and arrange them in the correct order.

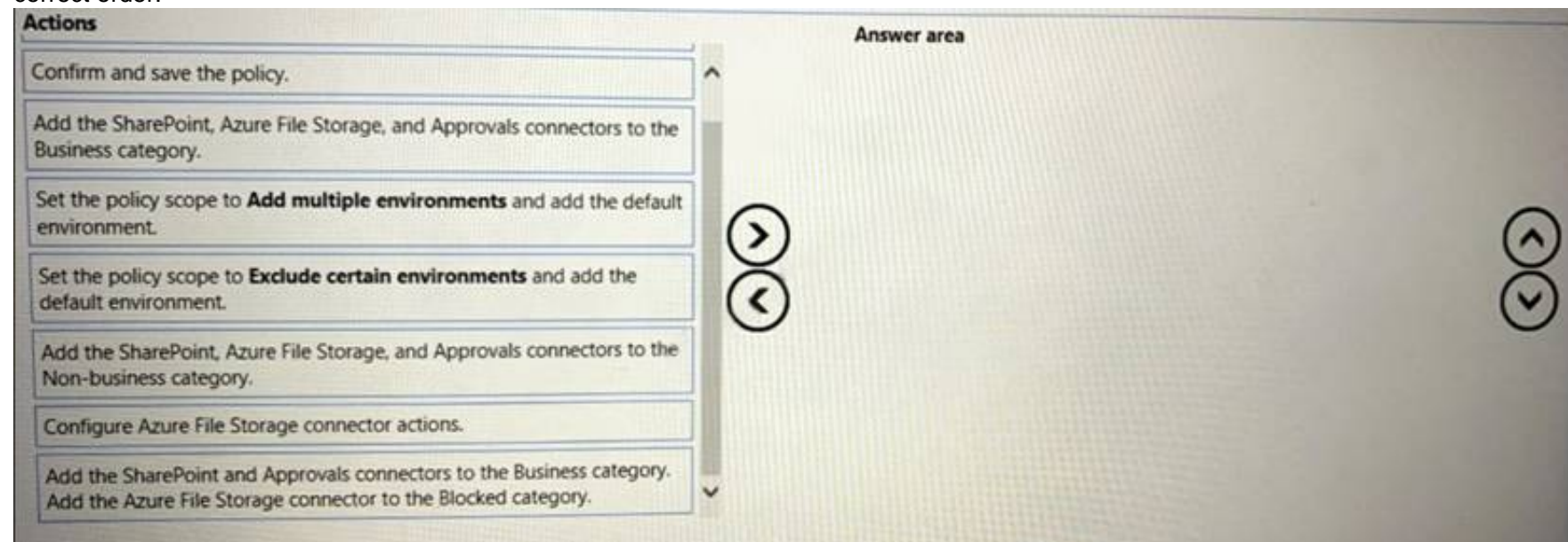

Actions

- Confirm and save the policy.
- Add the SharePoint, Azure File Storage, and Approvals connectors to the Business category.
- Set the policy scope to **Add multiple environments** and add the default environment.
- Set the policy scope to **Exclude certain environments** and add the default environment.
- Add the SharePoint, Azure File Storage, and Approvals connectors to the Non-business category.
- Configure Azure File Storage connector actions.
- Add the SharePoint and Approvals connectors to the Business category. Add the Azure File Storage connector to the Blocked category.

Answer area

- A. Mastered
B. Not Mastered

Answer: A

Explanation:

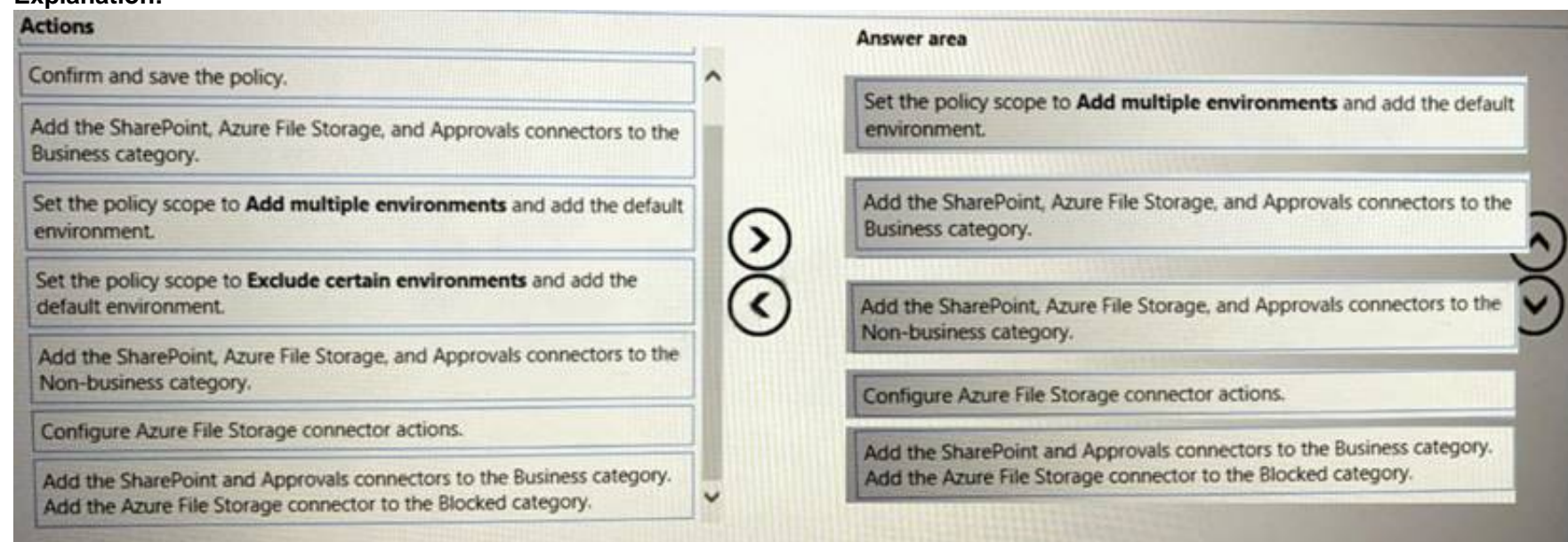

Actions

- Confirm and save the policy.
- Add the SharePoint, Azure File Storage, and Approvals connectors to the Business category.
- Set the policy scope to **Add multiple environments** and add the default environment.
- Set the policy scope to **Exclude certain environments** and add the default environment.
- Add the SharePoint, Azure File Storage, and Approvals connectors to the Non-business category.
- Configure Azure File Storage connector actions.
- Add the SharePoint and Approvals connectors to the Business category. Add the Azure File Storage connector to the Blocked category.

Answer area

- Set the policy scope to **Add multiple environments** and add the default environment.
- Add the SharePoint, Azure File Storage, and Approvals connectors to the Business category.
- Add the SharePoint, Azure File Storage, and Approvals connectors to the Non-business category.
- Configure Azure File Storage connector actions.
- Add the SharePoint and Approvals connectors to the Business category. Add the Azure File Storage connector to the Blocked category.

NEW QUESTION 80

- (Exam Topic 3)

You develop automation solutions for a company.

You need to configure variables for a cloud flow solution.

Which types of variables should you use for each type of data? To answer, select the appropriate options in the answer area.

NOTE: Each correct selection is worth one point.

Answer Area	
Requirement	Variable type
Store a list of names in JSON format.	<div>Object</div> <div>Float</div> <div>Integer</div> <div>Array</div>
Store the URL for a website.	<div>Object</div> <div>String</div> <div>Float</div> <div>Integer</div> <div>Array</div>
Store a date using the following pattern: yyyy-MM-dd.	<div>Object</div> <div>String</div> <div>Float</div> <div>Integer</div> <div>Array</div>
Store a price for a product.	<div>Object</div> <div>String</div> <div>Float</div> <div>Integer</div> <div>Array</div>

- A. Mastered
- B. Not Mastered

Answer: A

Explanation:

Answer Area	
Requirement	Variable type
Store a list of names in JSON format.	<div>Object</div> <div>Float</div> <div>Integer</div> <div>Array</div>
Store the URL for a website.	<div>Object</div> <div>String</div> <div>Float</div> <div>Integer</div> <div>Array</div>
Store a date using the following pattern: yyyy-MM-dd.	<div>Object</div> <div>String</div> <div>Float</div> <div>Integer</div> <div>Array</div>
Store a price for a product.	<div>Object</div> <div>String</div> <div>Float</div> <div>Integer</div> <div>Array</div>

NEW QUESTION 82

- (Exam Topic 3)

You are developing an automation solution for a bank. The solution will use a cloud flow and a desktop flow. The cloud flow retrieves sensitive information from Azure Key Vault and must pass the information to the desktop flow. You configure a Get secret action as shown in the Get secret exhibit. (Click the Get Secret tab.)

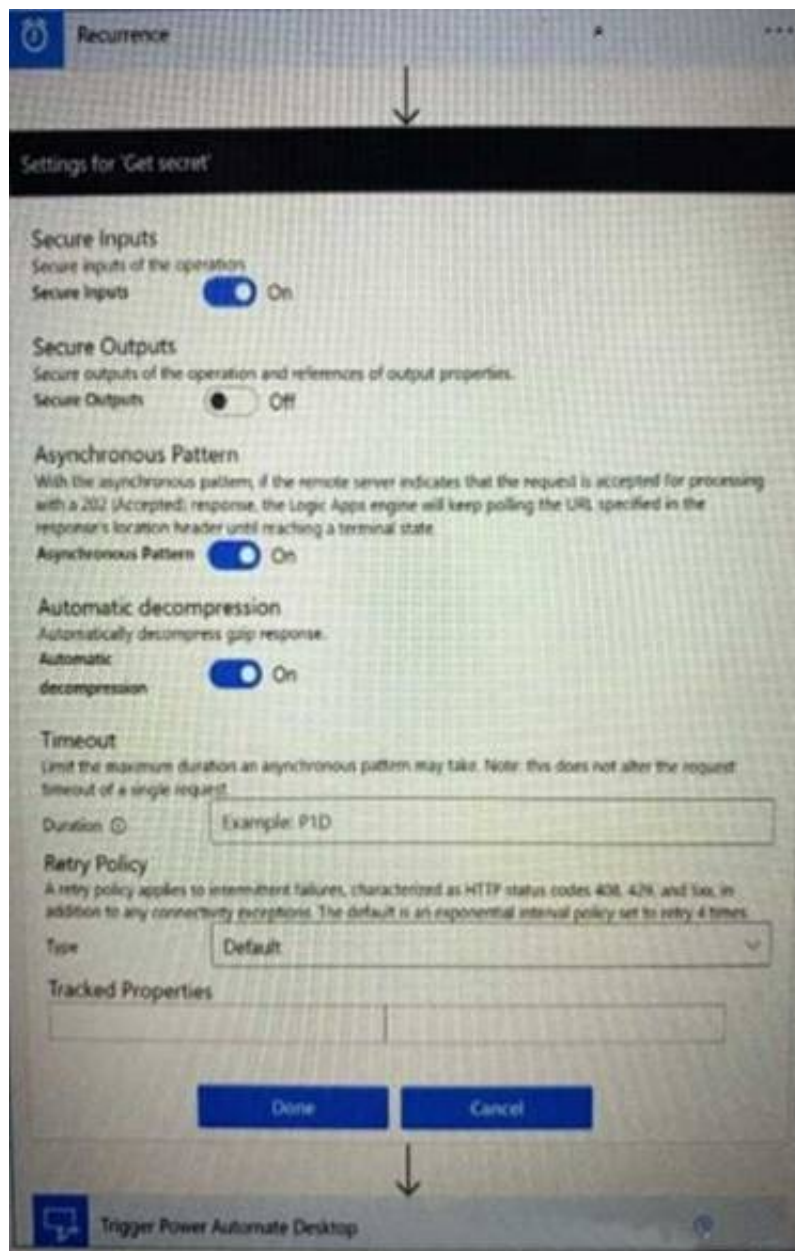

You configure the desktop flow as shown in the Desktop flow exhibit. (Click the Desktop flow tab.)

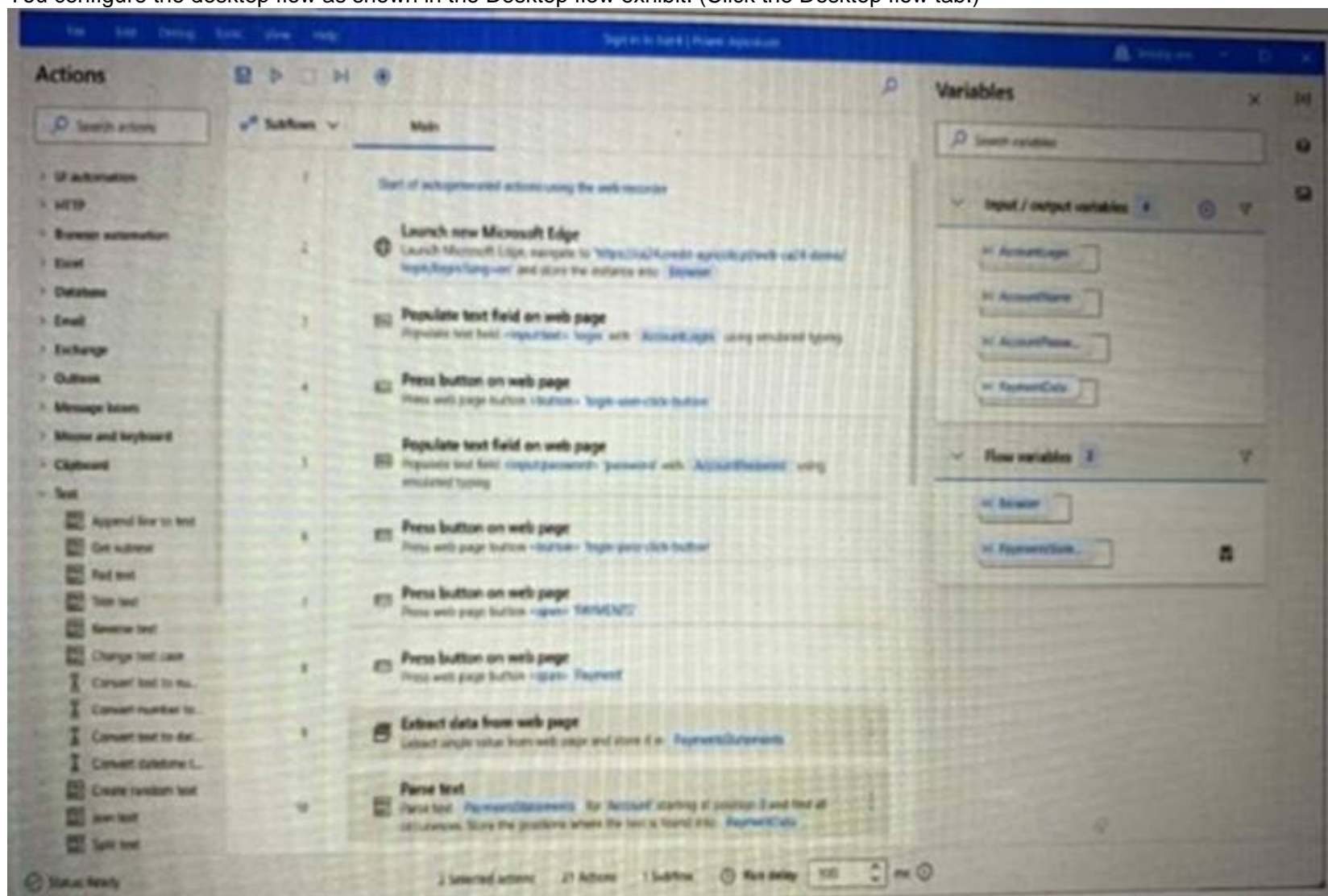

You need to ensure that no one can preview sensitive information by viewing the cloud flow or desktop flow run details.
 For each of the following statements, select Yes if the statement is true. Otherwise, select No. NOTE: Each correct selection is worth one point.

Answer Area			
Statement		Yes	No
The Get Secret action is configured to protect sensitive data in the cloud flow.		<input type="radio"/>	<input type="radio"/>
The desktop flow is configured to protect account login and password data.		<input type="radio"/>	<input type="radio"/>
Data extracted by the desktop flow is visible to users.		<input type="radio"/>	<input type="radio"/>

- A. Mastered
- B. Not Mastered

Answer: A

Explanation:

Answer Area			
Statement		Yes	No
The Get Secret action is configured to protect sensitive data in the cloud flow.		<input checked="" type="radio"/>	<input type="radio"/>
The desktop flow is configured to protect account login and password data.		<input type="radio"/>	<input checked="" type="radio"/>
Data extracted by the desktop flow is visible to users.		<input type="radio"/>	<input checked="" type="radio"/>

NEW QUESTION 84

.....

Relate Links

100% Pass Your PL-500 Exam with ExamBible Prep Materials

<https://www.exambible.com/PL-500-exam/>

Contact us

We are proud of our high-quality customer service, which serves you around the clock 24/7.

Viste - <https://www.exambible.com/>