

# Microsoft

## Exam Questions PL-900

Microsoft Power Platform Fundamentals



NEW QUESTION 1

DRAG DROP - (Topic 1)

A travel company plans to use the Power Platform to create tools that help travel agents book customer travel. You need to recommend solutions for the company.

What should you recommend? To answer, drag the appropriate tools to the correct requirements. Each tool may be used once, more than once, or not at all. You may need to drag the split bar between panes or scroll to view content.

NOTE: Each correct selection is worth one point.

Tools

Business rule

Business process flow

Power Automate

Power BI

Answer Area

Requirement

If a customer is travelling with a person under the age of 18, a field must display to collect date of birth for the under 18 traveler only.

Ensure that all travel agents use the same process with all customers.

Send a confirmation email to customers after reservations are complete.

Tool

Tool

Tool

- A. Mastered
- B. Not Mastered

Answer: A

Explanation:

Tools

Business rule

Business process flow

Power Automate

Power BI

Answer Area

Requirement

If a customer is travelling with a person under the age of 18, a field must display to collect date of birth for the under 18 traveler only.

Ensure that all travel agents use the same process with all customers.

Send a confirmation email to customers after reservations are complete.

Tool

Business rule

Business process flow

Power Automate

NEW QUESTION 2

HOTSPOT - (Topic 1)

You have version 1.0.0.0 of a published Power Apps app. You create and publish version 2.0.0.0 of the app. A customer goes through the process of restoring the previous version of the app.

How many versions of the app are displayed in the Version tab for the app? To answer, select the appropriate option in the answer area.

You will see

0

1

2

versions of the app.

- A. Mastered
- B. Not Mastered

Answer: A

Explanation:

You will see

0

1

2

versions of the app.

NEW QUESTION 3

HOTSPOT - (Topic 1)

A company plans to implement Power Platform apps. The company does not plan to use any development tools or plug-ins. Which actions can you perform?

For each of the following statements, select Yes if the statement is true. Otherwise, select No.

NOTE: Each correct selection is worth one point.

Statement	Yes	No
You can synchronize account names with a third-party proprietary database.	<input type="radio"/>	<input type="radio"/>
You can create invoices from orders and then send the invoices to the customer.	<input type="radio"/>	<input type="radio"/>

- A. Mastered  
B. Not Mastered

**Answer:** A

**Explanation:**

The Power Platform uses PowerApps, Power BI, and Power Automate (previously named Flow) to customize, extend, and build all the apps you need for your business and unlock the potential of Office 365 and Dynamics 365.

**NEW QUESTION 4**

- (Topic 2)

A company plans to use AI Builder to help improve business performance. You need to determine which AI Models are available for use. Which three types of models can you use? Each correct answer presents a complete solution.

NOTE: Each correct selection is worth one point.

- A. linear regression  
B. binary classification  
C. object detection  
D. anomaly detection  
E. text classification

**Answer:** BCE

**Explanation:**

Reference:

<https://carldesouza.com/using-the-ai-builder-in-the-microsoft-power-platform-for-binary- classification/>

**NEW QUESTION 5**

DRAG DROP - (Topic 2)

A manufacturing company is evaluating AI Builder.

You need to select AI Builder models to address specified requirements.

Which model types should you use? To answer, drag the appropriate model types to the correct requirements. Each model type may be used once, more than once, or not at all. You may need to drag the split bar between panes or scroll to view content.

NOTE: Each correct selection is worth one point.

**Model types**

prediction

form processing

object detection

**Requirement**

Identify products without labels or serial numbers.

Identify customers who might not pay their invoices on time.

**Model type**

model type

model type

- A. Mastered  
B. Not Mastered

**Answer:** A

**Explanation:**

**Model types**

prediction

form processing

object detection

**Requirement**

Identify products without labels or serial numbers.

Identify customers who might not pay their invoices on time.

**Model type**

object detection

prediction

**NEW QUESTION 6**

HOTSPOT - (Topic 2)

A business is evaluating AI Builder. Which actions can you perform?

For each of the following statements, select Yes if the statement is true. Otherwise, select No.

NOTE: Each correct selection is worth one point.

Statement	Yes	No
You can use a text classification model in AI Builder to retrieve text and perform sentiment analysis for ServiceNow incidents.	<input type="radio"/>	<input type="radio"/>
You can tag Instagram posts that mention your new product.	<input type="radio"/>	<input type="radio"/>
You can send results about the number of mentions of your new product in Instagram to Power BI for inclusion on a dashboard.	<input type="radio"/>	<input type="radio"/>

- A. Mastered  
B. Not Mastered

Answer: A

Explanation:

Statement	Yes	No
You can use a text classification model in AI Builder to retrieve text and perform sentiment analysis for ServiceNow incidents.	<input checked="" type="radio"/>	<input type="radio"/>
You can tag Instagram posts that mention your new product.	<input checked="" type="radio"/>	<input type="radio"/>
You can send results about the number of mentions of your new product in Instagram to Power BI for inclusion on a dashboard.	<input checked="" type="radio"/>	<input type="radio"/>

**NEW QUESTION 7**

HOTSPOT - (Topic 2)

A company is evaluating Power Platform and has questions about the role that Common Data Service plays in using Power Apps and Power Automate. For each of the following statements, select Yes if the statement is true. Otherwise, select No.  
NOTE: Each correct selection is worth one point.

Statement	Yes	No
Model-driven apps require a Common Data Service database.	<input type="radio"/>	<input type="radio"/>
A flow instance can only access one Common Data Service database.	<input type="radio"/>	<input type="radio"/>
Canvas apps require a Common Data Service database.	<input type="radio"/>	<input type="radio"/>

- A. Mastered  
B. Not Mastered

Answer: A

Explanation:

Statement	Yes	No
Model-driven apps require a Common Data Service database.	<input checked="" type="radio"/>	<input type="radio"/>
A flow instance can only access one Common Data Service database.	<input checked="" type="radio"/>	<input type="radio"/>
Canvas apps require a Common Data Service database.	<input checked="" type="radio"/>	<input type="radio"/>

**NEW QUESTION 8**

- (Topic 3)

You create a Power BI dashboard that displays data from Dynamics 365 Customer Engagement. You need to share the Power BI dashboard with coworkers. What are three possible ways to achieve the goal? Each correct answer presents a complete solution.



NOTE: Each correct selection is worth one point.

- A. Create a Power BI workspace and grant coworkers permissions.
- B. Publish the dashboard as an app to your coworkers.
- C. Export the data into Common Data Service for others to manipulate in Power BI.
- D. Export the data to Microsoft Excel for coworkers to import and view in Power BI.
- E. Embed reports in your company's internal web portal.

**Answer:** ABE

**Explanation:**

A: Basic Sharing for Dashboards and Reports through a workspace is the most common way of sharing the Power BI content. Basic Sharing is very simple and easy to use method. You can simply click on the Share button in the dashboard or report, and then share it with other users.



B: Apps are great sharing method for multiple environment, and best way of sharing for users in production environment.

Power BI App is the solution for multiple environment approach. With Power BI App, your development environment (workspace), and user environment (App) are isolated from each other.

Note: If you are using SharePoint online as a portal for document management and some other reasons already, then consider using Embed in SharePoint Online feature of Power BI reports. This method is secure and you can share the report only with Power BI users you want.

E: Sometimes, you don't need a secure way of sharing, you may search for an easy and free way of sharing, and your content is not confidential or sensitive.

Publish to web is your friend in such situation. This is the only free way of sharing in Power BI, but be aware that this method is not secure.

Publish to web method, gives you an embed code, which you can use in any web pages to embed the Power BI report in it

Reference:

<https://radacad.com/power-bi-sharing-methods-comparison-all-in-one-review>

**NEW QUESTION 9**

DRAG DROP - (Topic 3)

A company needs to create a series of mobile applications to empower their field engineers to accomplish several tasks with varying degrees of complexity.

Match each option to its answer.

Instructions: To answer, drag the appropriate app type from the column on the left to its definition on the right. Each app type may be used once, more than once, or not at all.

NOTE: Each correct match is worth one point.

App types	Answer Area	App type
model-driven	Quickly create apps for very complex business processes with very little or no code.	App type
dashboard	Create simple apps with a highly customizable user interface layouts.	App type
dataset		
canvas		

- A. Mastered
- B. Not Mastered

**Answer:** A

**Explanation:**

Box 1: canvas

Both model-driven and canvas apps allow you to easily build business apps. They both share access to the Common Data Service providing standard and custom entities. Canvas apps start with your user experience, crafting a highly tailored interface with the power of a blank canvas and connecting it to 200 data sources. Canvas apps can be built for web, mobile, and tablet applications. Model-driven apps start with your data model – building up from the shape of your core business data and processes in the Common Data Service to model forms, views, and other components. Model-driven apps automatically generate great UI that is responsive across devices.

Box 2: model-driven

**NEW QUESTION 10**

- (Topic 3)

You are using Dynamics 365 Sales.

You need to pull data into a Power BI report for your team. The City and State columns must be combined to form one column on the report.

Which function would you use? Each correct answer presents a complete solution. NOTE: Each correct selection is worth one point.

- A. Use Power Query to merge columns.

- B. Import the dat
- C. 18912E1457D5D1DDCBD40AB3BF70D5D
- D. Export data to Microsoft Excel.
- E. Create a view.

**Answer:** A

**Explanation:**

Reference:

<https://docs.microsoft.com/en-us/power-bi/desktop-shape-and-combine-data>

**NEW QUESTION 10**

DRAG DROP - (Topic 3)

A company plans to implement Power BI to analyze retail operations data. You need to recommend solutions for the company.

Which Power BI components should the company use? To answer, drag the appropriate Power BI components to the correct requirements. Each Power BI component may be used once, more than once, or not at all. You may need to drag the split bar between panes or scroll to view content.

NOTE: Each correct selection is worth one point.

Power BI components	Requirement	Power BI component
reports	Allow users to set and receive alerts when data changes beyond specified limits.	
workspaces		
dashboards	View and filter data and export data to Microsoft Excel for further manipulation and analysis.	
dataset		

- A. Mastered
- B. Not Mastered

**Answer:** A

**Explanation:**

Power BI components	Requirement	Power BI component
reports	Allow users to set and receive alerts when data changes beyond specified limits.	workspaces
workspaces		
dashboards	View and filter data and export data to Microsoft Excel for further manipulation and analysis.	dataset
dataset		

**NEW QUESTION 15**

- (Topic 3)

A recent update has been made to a canvas app. The update has caused a negative impact to users. You need to roll back the app to a previous version. What should you do?

- A. Restore the previous version of the app.
- B. Uninstall the app for all users and reinstall by using the previous versions' package.
- C. Deactivate the live app, import the previous version of the app, and then activate the app.
- D. Delete the app and create a new app based on the previous version.

**Answer:** A

**Explanation:**

Restore a canvas app to a previous version in PowerApps. Restore an app from your account

? Open powerapps.com, and then click or tap Apps in the left navigation bar.

? Near the right edge, click or tap the info icon for the app that you want to restore.

? Click or tap the Versions tab, and then click or tap Restore for the version that you want to restore.

? In the confirmation dialog box, click or tap Restore. A new version is added to your list.

Reference:

<https://docs.microsoft.com/en-us/powerapps/maker/canvas-apps/restore-an-app>

**NEW QUESTION 20**

- (Topic 3)

You are creating Power BI reports.

You need to choose which filters you can use for reports.

Which three types of filters can you use? Each correct answer presents a complete solution.

NOTE: Each correct selection is worth one point.

- A. drill-down
- B. automatic
- C. database

- D. manual
- E. external

**Answer:** ABD

**Explanation:**

Reference:  
<https://docs.microsoft.com/en-us/power-bi/power-bi-report-filter-types>

**NEW QUESTION 23**

DRAG DROP - (Topic 3)

A company plans to display support call metrics on a screen that is visible to all call center staff.

You need to recommend solutions to meet the company's requirements.

What should you recommend? To answer, drag the appropriate components to the correct requirements. Each component may be used once, more than once, or not at all. You may need to drag the split bar between panes or scroll to view content.

NOTE: Each correct selection is worth one point.

Components

Tile	Theme
Template App	Alert
Treemap	DirectQuery
Page	Workspace

Answer Area

Requirement	Component
Display a chart with incoming calls versus wait time and pin the chart to a dashboard.	<div>Component</div>
Send a specific user a notification when the number of customer support calls waiting is over 20.	<div>Component</div>
Display metrics from different datasets that have related data.	<div>Component</div>

- A. Mastered
- B. Not Mastered

**Answer:** A

**Explanation:**

Components

Tile	Theme
Template App	Alert
Treemap	DirectQuery
Page	Workspace

Answer Area

Requirement	Component
Display a chart with incoming calls versus wait time and pin the chart to a dashboard.	<div>Tile</div>
Send a specific user a notification when the number of customer support calls waiting is over 20.	<div>Alert</div>
Display metrics from different datasets that have related data.	<div>DirectQuery</div>

**NEW QUESTION 25**

- (Topic 3)

You are a district manager for a large retail organization. You train each store manager to use Power BI to track sales and daily sales targets.

A store manager remembers learning about the Analyze in Excel option but cannot find the option in their Power BI dashboard.

You need to help the user resolve the issue. How should you advise the user?

- A. Install the Power BI Desktop app.
- B. Navigate to the report used by the dashboard.
- C. Select the Spotlight button on the dashboard tile.
- D. Subscribe to the dashboard and follow the email link.

**Answer:** B

**Explanation:**

Reference:  
<https://docs.microsoft.com/en-us/power-bi/collaborate-share/service-analyze-in-excel>

**NEW QUESTION 30**

DRAG DROP - (Topic 3)

You create a Power BI dashboard.

Match each option to its function. To answer, drag the appropriate option from the column on the left to its function on the right. Each option may be used once, more than once, or not at all.

NOTE: Each correct match is worth one point.

Products

Share
Embed
Get Data
Pin
Import

Answer Area

Requirement	Product
Ensure that coworkers can see the dashboard.	<div></div>
Display data from Microsoft Excel in the dashboard.	<div></div>
Add a report tile to the dashboard.	<div></div>



- A. Mastered
- B. Not Mastered

**Answer:** A

**Explanation:**

Products	Requirement	Product
Share	Ensure that coworkers can see the dashboard.	Share
Embed	Display data from Microsoft Excel in the dashboard.	Get Data
Get Data	Add a report tile to the dashboard.	Pin
Pin		
Import		

### NEW QUESTION 31

- (Topic 3)

Your company has an on premises Microsoft SQL Server database that contains legacy sales data. You must display information from the database in a new Power Apps app.

You need to establish a secure connection between the database and the app.

What should you use?

- A. Data source
- B. App
- C. Gateway
- D. Flow

**Answer:** C

**Explanation:**

For an on-premises database, identify a data gateway that was shared with you (or create one).

Specify Connect using on-premises data gateway, type or paste the server name, the database name, the user name, and the password for the database that you want to use, and specify the authentication type and the gateway.

Reference:

<https://docs.microsoft.com/en-us/powerapps/maker/canvas-apps/connections/connection-azure-sqldatabase>

### NEW QUESTION 34

DRAG DROP - (Topic 3)

A company plans to create an information portal that managers can use to view critical information about their teams.

You need to recommend the type of Power BI components that the company should use. What should you recommend? To answer, drag the appropriate components to the correct

requirements. Each component may be used once, more than once, or not at all. You may need to drag the split bar between panes or scroll to view content.

NOTE. Each correct selection is worth one point.

Component types	Requirement	Component type
Dashboard	Display data from a Microsoft Excel workbook that has multiple worksheets into one chart.	Component type
Report	Display the top departmental goal metrics and alert users when specific thresholds targets are met.	Component type
	Display Sales charts that can be filtered by region.	Component type

- A. Mastered
- B. Not Mastered

**Answer:** A

**Explanation:**

Box 1: Report

Reports are more detailed data displayed in many formats like chart, graphs list and in tabular, etc.

Box 2: Dashboard

Dashboards are a business key performance indicator view where it displays key values that can change business profits and can be glanced at one screen.

Box 3: Report

Power BI dashboards cannot slice and dice, but reports have many ways to filter and slice.

Note: Power BI dashboards are one placeholder to display the most important decision- making facts to run a business. But reports are more detailed data displayed in many formats like chart, graphs list and in tabular, etc. Reports are based on one dataset or one business unit data for example reports of a store belonging to California.

### NEW QUESTION 38



DRAG DROP - (Topic 4)

You are creating a model-driven app to track requests for quotes. The app must use the following navigation structure:

- Sales
  - ? Sales Log
  - ? Request for Quotes
  - ? Projects
  - ? Settings
  - ? Customers
  - ? Product Lines
  - ? Sales Territories Administration
  - ? User Admin
  - ? Users
  - ? Roles

You need to create the app navigation.

Which sitemap component types should you use? To answer, drag the appropriate component types to the correct navigation elements. Each component type may be used once, more than once, or not at all. You may need to drag the split bar between panes or scroll to view content.

NOTE: Each correct selection is worth one point.

Component types

Area

Group

Subarea

Answer Area

Navigation element	Component type
Administration	Component type
Sales log	Component type
Customers	Component type

- A. Mastered
- B. Not Mastered

Answer: A

Explanation:

Component types

Area

Group

Subarea

Answer Area

Navigation element	Component type
Administration	Group
Sales log	Subarea
Customers	Subarea

NEW QUESTION 39

- (Topic 4)

You are creating a canvas app. You need to configure the app.

Which two objects are provided by the connector? Each correct answer presents a complete solution.

NOTE: Each correct selection is worth one point.

- A. customizations
- B. data sources
- C. actions
- D. tables
- E. triggers

Answer: CD

Explanation:

Reference:  
<https://docs.microsoft.com/en-us/powerapps/maker/canvas-apps/connections-list>

NEW QUESTION 41

- (Topic 4)

You create a canvas app that allows contractors to submit time they work against a project.

Contractors must be able to use the canvas app to enter time. Contractors must not be able to perform any other actions in the app.

You need to configure permissions for the contractors. Which type of permissions should you use?

- A. application-level

- B. task-level
- C. record-level
- D. field-level

**Answer:** D

**Explanation:**

Field-level security feature to allow more granular control of security at the field level.

Reference:

<https://docs.microsoft.com/en-us/power-platform/admin/security-roles-privileges> <https://docs.microsoft.com/en-us/power-platform/admin/wp-security-cds>

**NEW QUESTION 45**

- (Topic 4)

A company has a Power Apps app that is used by most employees. The company is expanding to other countries/regions.

You need to recommend a solution to translate text generated within the Power Apps in near real-time.

What should you recommend?

- A. Microsoft Azure Synapse Analytics
- B. Microsoft Azure Cognitive Services
- C. Common Data Service connector
- D. Power BI

**Answer:** B

**Explanation:**

Reference:

[https://docs.microsoft.com/en-gb/azure/cognitive-services/welcome?ocid=AID2339762\\_TWITTER\\_oo\\_spl100000827964250](https://docs.microsoft.com/en-gb/azure/cognitive-services/welcome?ocid=AID2339762_TWITTER_oo_spl100000827964250)

<https://powerapps.microsoft.com/en-us/blog/cognitive-services-with-powerapps-using-custom-connectors/>

**NEW QUESTION 47**

- (Topic 4)

You create a Power App portal.

When a user signs into the portal the following error displays: user not found You confirm that the user's sign in information is correct.

You need to determine the cause of the error. What should you do?

- A. Disable custom error messages.
- B. Create a custom error message.
- C. Enable diagnostic tools in Lifecycle Services.
- D. Enable Maintenance mode.

**Answer:** C

**Explanation:**

Reference:

<https://docs.microsoft.com/en-us/dynamics365/fin-ops-core/dev-itpro/lifecycle-services/monitoring-diagnostics>

<https://docs.microsoft.com/en-us/dynamics365/fin-ops-core/dev-itpro/lifecycle-services/user-logins>

**NEW QUESTION 52**

HOTSPOT - (Topic 4)

You are designing a Power Apps solution that allows users to upload a status report directly to the company Microsoft SharePoint project management site from their mobile device.

For each of the following statements, select Yes if the statement is true. Otherwise, select No.

NOTE: Each correct selection is worth one point.

Statement	Yes	No
You should build a model-driven app in Power Apps.	<input type="radio"/>	<input type="radio"/>
You should build a canvas app in Power Apps.	<input type="radio"/>	<input type="radio"/>
Users must download and run the Power Apps mobile application to use the solution.	<input type="radio"/>	<input type="radio"/>

- A. Mastered
- B. Not Mastered

**Answer:** A

**Explanation:**

Box 1: No

Box 2: Yes

Box 3: Yes

When you create an app, or someone shares an app with you, you can run that app on Windows, iOS, Android, or in a web browser.

References:

<https://docs.microsoft.com/en-us/powerapps/maker/canvas-apps/app-from-sharepoint> <https://docs.microsoft.com/en-us/powerapps/user/run-app-client>

#### NEW QUESTION 56

- (Topic 4)

You create a Power Apps canvas app.

You need to ensure that your coworkers can run the app. What should you do?

- A. Share the app.
- B. Send the URL for the app to coworkers.
- C. Add a license for the app.
- D. Create a Flow for the app.

**Answer:** A

**Explanation:**

Reference:

<https://docs.microsoft.com/en-us/powerapps/maker/canvas-apps/share-app>

#### NEW QUESTION 61

DRAG DROP - (Topic 4)

A company plans to build new apps for the business to allow employees to work more efficiently.

You need to recommend the appropriate types of Power Apps to meet the company's requirements.

To answer, drag the appropriate app types to the correct requirements. Each app type may be used once, more than once, or not at all. You may need to drag the split bar between panes or scroll to view content.

NOTE: Each correct selection is worth one point.

App types	Answer Area	
	Requirement	App type
model-driven	Build mobile apps that use cameras and location data.	
portals	Give external users secure access to your data.	
canvas		
AI Builder		

- A. Mastered
- B. Not Mastered

**Answer:** A

**Explanation:**

App types	Answer Area	
	Requirement	App type
model-driven	Build mobile apps that use cameras and location data.	canvas
portals	Give external users secure access to your data.	portals
canvas		
AI Builder		

#### NEW QUESTION 66

- (Topic 4)

A company plans to create a canvas app that connects to three databases with different proprietary database formats. What is the minimum number of connectors required?

- A. 1
- B. 2
- C. 3

**Answer:** B

**Explanation:**

Reference:

<https://docs.microsoft.com/en-us/powerapps/maker/canvas-apps/working-with-data-sources>

#### NEW QUESTION 68

DRAG DROP - (Topic 4)

A company is building a model-driven app.

You need to create and configure the objects needed for the app.

Which component categories should you use? To answer, drag the appropriate component categories to the correct objects. Each component category may be used once, more than once, or not at all. You may need to drag the split bar between panes or scroll to view content.  
NOTE: Each correct selection is worth one point.

Component categories

UI

Data

Logic

Visulaization

Answer Area

Object	Component category
Relationship	
Form	
Business rule	
View	

- A. Mastered
- B. Not Mastered

Answer: A

Explanation:

Component categories

UI

Data

Logic

Visulaization

Answer Area

Object	Component category
Relationship	Data
Form	UI
Business rule	Logic
View	UI

**NEW QUESTION 72**  
HOTSPOT - (Topic 5)  
A company plans to implement Power Apps.  
For each of the following statements, select Yes if the statement is true. Otherwise, select No.  
NOTE: Each correct selection is worth one point.

Answer Area

Statement	Yes	No
Building Power Apps apps requires proficiency in JavaScript programming.	<input type="radio"/>	<input type="radio"/>
You must select one of the app templates to create an app.	<input type="radio"/>	<input type="radio"/>

- A. Mastered
- B. Not Mastered

Answer: A

Explanation:

Answer Area

Statement	Yes	No
Building Power Apps apps requires proficiency in JavaScript programming.	<input type="radio"/>	<input checked="" type="radio"/>
You must select one of the app templates to create an app.	<input type="radio"/>	<input checked="" type="radio"/>

**NEW QUESTION 76**



- (Topic 5)  
A company performs on-site inspections and services for air industrial equipment.  
Field technicians must perform a series of maintenance checks every time they visit a customer site. Every technician performs maintenance tasks in a different order. Some technicians miss steps. You need to ensure that all technicians perform the same steps in the same order.  
What should you use?

- A. Business process flow
- B. AI Builder
- C. Business rule
- D. Virtual Agent

Answer: A

**Explanation:**  
You can help ensure that people enter data consistently and follow the same steps every time they work with a customer by creating a business process flow. For example, you might want to create a business process flow to have everyone handle customer service requests the same way, or to require that people get approval for an invoice before submitting an order. Business process flows use the same underlying technology as other processes, but the capabilities that they provide are very different from other features that use processes.  
Reference:  
<https://docs.microsoft.com/en-us/power-automate/business-process-flows-overview>

NEW QUESTION 78

HOTSPOT - (Topic 5)  
A company plans to synchronize data between Dynamics 365 Supply Chain management and Dynamics 365 Sales.  
For each of the following statements, select Yes if the statement is true. Otherwise, select No.  
NOTE: Each correct selection is worth one point.

Statement	Yes	No
You can implement a process-based integration by using the Data Integration feature.	<input type="radio"/>	<input type="radio"/>
You can use Microsoft Azure Data Migration to synchronize data between the apps.	<input type="radio"/>	<input type="radio"/>

- A. Mastered
- B. Not Mastered

Answer: A

Explanation:

Statement	Yes	No
You can implement a process-based integration by using the Data Integration feature.	<input checked="" type="radio"/>	<input type="radio"/>
You can use Microsoft Azure Data Migration to synchronize data between the apps.	<input type="radio"/>	<input checked="" type="radio"/>

NEW QUESTION 82

HOTSPOT - (Topic 5)  
You are creating a number of Power Automate flows.  
You need to select the triggers for the flows.  
Which flow types should you use? To answer, select the appropriate options in the answer area.  
NOTE: Each correct selection is worth one point.

Answer Area

Requirement	Flow type
Trigger a flow when a button is selected.	<div><div></div><div>UI Flow Automatic Business Process Flow Instant</div></div>
Trigger a flow when a record is created.	<div><div></div><div>UI Flow Automatic Business Process Flow Instant</div></div>
Guide a user through a series of steps in a model-driven app.	<div><div></div><div>UI Flow Automatic Business Process Flow Instant</div></div>

- A. Mastered
- B. Not Mastered

Answer: A

Explanation:

Answer Area

Requirement	Flow type
Trigger a flow when a button is selected.	<div><div></div><div>UI Flow Automatic Business Process Flow Instant</div></div>
Trigger a flow when a record is created.	<div><div></div><div>UI Flow Automatic Business Process Flow Instant</div></div>
Guide a user through a series of steps in a model-driven app.	<div><div></div><div>UI Flow Automatic Business Process Flow Instant</div></div>

NEW QUESTION 84

HOTSPOT - (Topic 5)

A company uses a third party application and an approval process via email. At the end of the month, the IT department enters the data into Microsoft Excel to create pivot charts.

The Excel pivot charts must use the same data source as Dynamics 365 Field Service to generate charts and reports.

You need to recommend a solution.

What should you recommend? To answer, select the appropriate configuration in the answer area.

NOTE: Each correct selection is worth one point.

Requirement	Solution
Create an approval workflow.	<div><div></div><div>Dynamics 365 Workflow Notifications</div><div>Microsoft Outlook Integration</div><div>AI Builder</div><div>Microsoft Flow</div></div>
Connect to report data.	<div><div></div><div>Common Data Service and Power BI</div><div>Third-party from AppSource</div><div>Custom Code flat file integration</div><div>Dynamics 365 Field Service</div></div>

- A. Mastered
- B. Not Mastered

Answer: A

Explanation:

Box 1: Dynamics 365 Workflow notifications

You can configure the system to send email messages to users when workflow-related events occur.

Note:

? Go to Navigation pane > Modules > System administration > Users > Users.

? In the list, find and select the desired record.

? On the Action pane, click User options.

? Click the Workflow tab. Make sure that the Notifications section is expanded. In the Notifications section, you can specify how you want the user to be notified about workflow-related events.

Box 2: Dynamics 365 Field Service

Supply Chain Management enables synchronization of business processes between Dynamics 365 Supply Chain Management and Dynamics 365 Field Service.

The integration scenarios are configured by using extensible Data integrator templates and Common Data Service to enable the synchronization of business processes. Standard templates can be used to create custom integration projects, where additional standard and custom fields and entities can be mapped to adjust the integration and meet specific business needs.

NEW QUESTION 87

- (Topic 5)

This question requires that you evaluate the BOLD text to determine if it is correct.

A company requires that service representatives schedule customer visits every six months. Each service representative is required to enter a scheduled task for the next checkup as they are leaving a client site. A service representative wants to automate task entry by creating a business process flow that can be initiated from the service call screen on a phone.

Review the underlined text. If it makes the statement correct, select “No change is needed.” If the statement is incorrect, select the answer choice that makes the statement correct.

- A. No change is needed.
- B. a scheduled
- C. an instant
- D. an action

Answer: D

Explanation:

Note: Create a flow (see step 6 below)

\* 1. Sign in to PowerApps.

\* 2. In the left navigation bar, select Business logic, and then select Flows.

\* 3. In the upper-left corner of the My Flows page, select New, and then select Create from blank.

\* 4. Option to create a flow without using a template

Near the bottom of the page that appears, select Search hundreds of connections and triggers.

\* 5. In the search box, type PowerApps, and then select the PowerApps icon.

\* 6. Create a PowerApps trigger

\* 7. On the next page, select the PowerApps icon again, and then select New step.

\* 8. In the box that says Search connectors and actions, specify an action for your flow, as in this example:

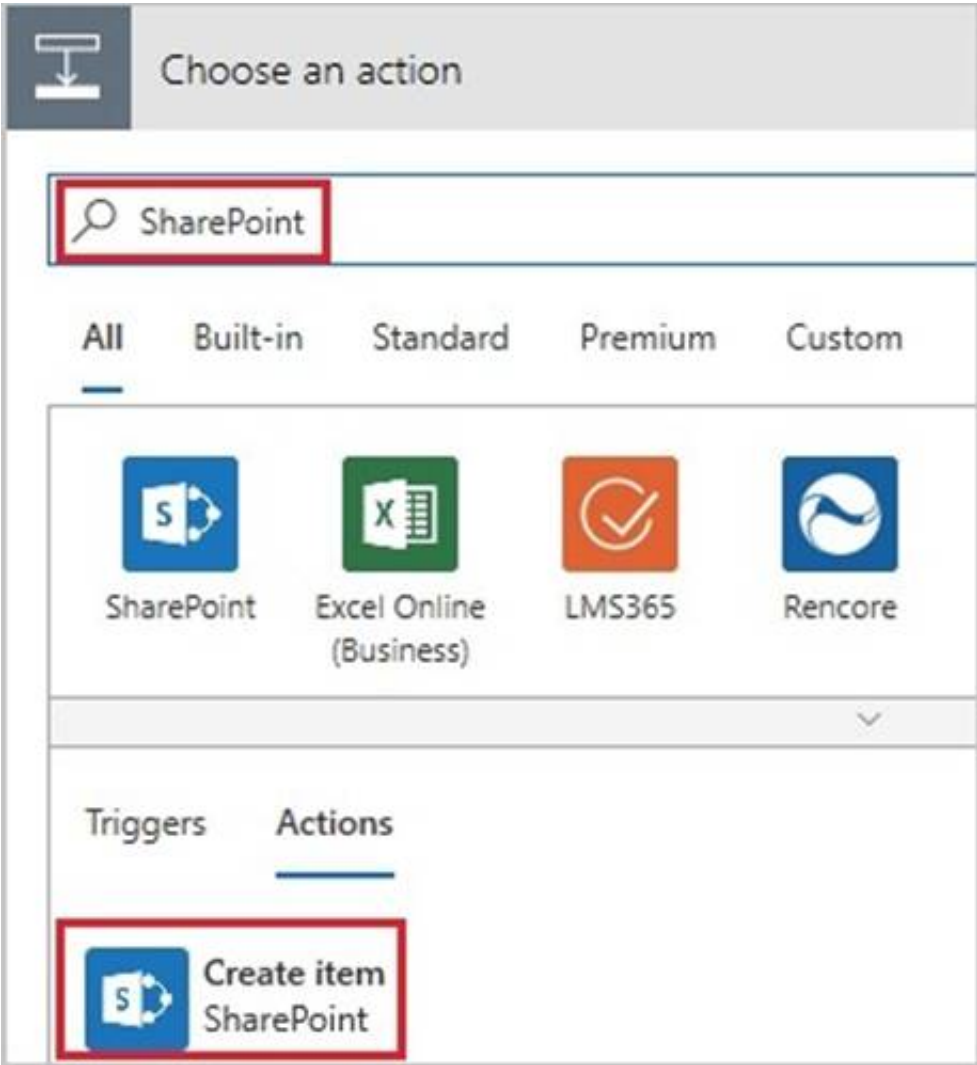

Reference:  
<https://docs.microsoft.com/en-us/powerapps/maker/canvas-apps/using-logic-flows>

**NEW QUESTION 91**

DRAG DROP - (Topic 5)

You plan to use Microsoft Flow to monitor what people are saying about your company's products. You store the feedback for research and development purposes. You need to recommend Flow components to use for the solution. To answer, drag the appropriate components to the correct requirements. Each component may be used once, more than once, or not at all. You may need to drag the split bar between panes or scroll to view content. NOTE: Each correct selection is worth one point.

Components	Answer Area	Requirement	Component
action			
expression		Retrieve the top five posts from your company's Facebook page.	Component
service		Enter the resulting posts into the product database.	Component
trigger		Combine author and link fields into a single field.	Component
flow type		Run flow every hour.	Component

- A. Mastered
- B. Not Mastered

Answer: A

**Explanation:**

Box 1: Trigger  
A trigger is something that triggers or starts the workflow. It could be a new file uploaded to a document library, a new item created in the list or an email sent to your Inbox – something that will start (kick-off the workflow). There are two types of triggers:  
? Automatic trigger is pre-programmed into the workflow based on a certain rule (i.e. new document or item created, email sent, etc.)  
? Manual Trigger is a trigger initiated by a user. Unlike with automatic trigger above, the workflow will only start when initiated manually by the end user (for example, from the Document Library for a selected file). Manual trigger is only supported for certain types of workflows (i.e. Get feedback from your manager for the selected file)  
Box 2: action  
An action is something that occurs as a result of the workflow.  
Box 3: expression  
Sometimes users just need to do basic operations like getting the current time, adding numbers together, or replacing a part of a string of text. That's possible inline in any flow action. Microsoft Flow leverages the same Workflow Definition Language used by Azure Logic apps. For new users who are unfamiliar with the expression language, there is an inline help experience that shows how to use each expression as they build out their flow.  
Box 4: flow type  
There are four different Flow types that you can choose from when starting out. You can create a scheduled flow, automated flow, instant flow, or a business



process flow.

NEW QUESTION 95

HOTSPOT - (Topic 5)

A company plans to create a workflow that periodically runs a Dynamics 365 action based on data in third-party cloud-based solutions. Which features should you use to create the workflow? To answer, select the appropriate options in the answer area.

NOTE: Each correct selection is worth one point.

Action	Component
Ensure that Power Automate can interact with the third-party application.	<div><div></div><div>Triggers</div><div>Logic Apps</div><div>Connectors</div><div>Gateways</div></div>
Periodically check for data changes in the third-party application.	<div><div></div><div>Actions</div><div>Triggers</div><div>Connectors</div><div>DirectQuery</div></div>

- A. Mastered
- B. Not Mastered

Answer: A

Explanation:

Action	Component
Ensure that Power Automate can interact with the third-party application.	<div><div></div><div>Triggers</div><div>Logic Apps</div><div>Connectors</div><div>Gateways</div></div>
Periodically check for data changes in the third-party application.	<div><div></div><div>Actions</div><div>Triggers</div><div>Connectors</div><div>DirectQuery</div></div>

NEW QUESTION 100

- (Topic 5)

You are creating a canvas app that uses one connector.

Which two objects are provided to Power Apps by the connector? Each correct answer presents a complete solution.

NOTE: Each correct selection is worth one point.

- A. tables
- B. customizations
- C. triggers
- D. actions

Answer: AD

NEW QUESTION 101

- (Topic 5)

A company has a website. The website includes a form that allows the company to collect information about leads.

You need to set up an automated workflow to create leads in Dynamics 365 Sales when leads are created on the company's custom website. What should you create?

- A. Task Flow
- B. Power Automate flow
- C. Dynamics 365 workflow
- D. Business Process Flow

Answer: B

Explanation:

Reference:  
<https://trellispoint.com/create-crm-leads-using-microsoft-flow/>

NEW QUESTION 106

HOTSPOT - (Topic 5)

A company plans to use Power Apps to connect to a series of custom services. There are no connectors available for the custom services. For each of the following statements, select Yes if the statement is true. Otherwise, select No.  
NOTE: Each correct selection is worth one point.

Statement	Yes	No
Custom connectors for customer-specific services do not require review and certification by Microsoft.	<input checked="" type="radio"/>	<input type="radio"/>
You can build a custom connector once and reuse the connector for Power Apps and Microsoft Flow.	<input checked="" type="radio"/>	<input type="radio"/>
You can make custom connectors publicly available for all Power Platform users without having Microsoft certify the connector.	<input type="radio"/>	<input checked="" type="radio"/>

- A. Mastered
- B. Not Mastered

Answer: A

Explanation:

Box 1: Yes  
Only if you would like to share your connector with all users of Logic Apps, Microsoft Flow, and PowerApps, you can submit your connector for Microsoft certification. Microsoft will review your connector.  
Box 2: Yes  
Connectors created in Microsoft Flow are available in PowerApps. Likewise, connectors created in PowerApps are available in Microsoft Flow.  
Box 3: No  
If you would like to share your connector with all users of Logic Apps, Microsoft Flow, and PowerApps, you can submit your connector for Microsoft certification. Microsoft will review your connector.

NEW QUESTION 108

- (Topic 5)

A company uses Power Automate.  
Which three items can trigger flows? Each correct answer presents a complete solution. NOTE: Each correct selection is worth one point.

- A. Lifecycle Services
- B. Microsoft 365 Admin center
- C. Common Data Service
- D. Microsoft Outlook 365
- E. Microsoft Windows Desktop

Answer: ACD

Explanation:

<https://docs.microsoft.com/en-us/power-automate/email-triggers> <https://docs.microsoft.com/en-us/power-automate/connection-cds>  
<https://dynamics365.wordpress.com/category/powerapps/>

NEW QUESTION 111

HOTSPOT - (Topic 5)

For which scenarios can you use Power Automate?  
For each of the following statements, select Yes if the statement is true. Otherwise, select No.  
NOTE: Each correct selection is worth one point.

Statement	Yes	No
Notify team members when a response is recorded in a form in Microsoft Forms.	<input type="radio"/>	<input type="radio"/>
When email is received, save email attachments to OneDrive for Business.	<input type="radio"/>	<input type="radio"/>
Receive notifications when negative comments about the company are posted on Twitter.	<input type="radio"/>	<input type="radio"/>

- A. Mastered
- B. Not Mastered

Answer: A

Explanation:

Statement	Yes	No
Notify team members when a response is recorded in a form in Microsoft Forms.	<input checked="" type="radio"/>	<input type="radio"/>
When email is received, save email attachments to OneDrive for Business.	<input checked="" type="radio"/>	<input type="radio"/>
Receive notifications when negative comments about the company are posted on Twitter.	<input checked="" type="radio"/>	<input type="radio"/>

NEW QUESTION 115

HOTSPOT - (Topic 5)

A software company plans to use Power Automate.

For each of the following statements, select Yes if the statement is true. Otherwise, select No.

NOTE: Each correct selection is worth one point.

Statement	Yes	No
You must certify custom connectors before users in other departments within your organization can use the connectors.	<input type="radio"/>	<input type="radio"/>
You must use Microsoft Azure API apps to create a public custom connector.	<input type="radio"/>	<input type="radio"/>

- A. Mastered
- B. Not Mastered

Answer: A

Explanation:

Statement	Yes	No
You must certify custom connectors before users in other departments within your organization can use the connectors.	<input type="radio"/>	<input checked="" type="radio"/>
You must use Microsoft Azure API apps to create a public custom connector.	<input checked="" type="radio"/>	<input type="radio"/>



**NEW QUESTION 117**

- (Topic 5)

A company uses Dynamics 365 Supply Chain Management.

When a sales order is created for one of the customers that a specific user manages, a Microsoft Outlook task must be created to remind the user to perform any follow up activities that are required.

You need to implement the functionality to create Outlook tasks.

Which two features should you use? Each correct answer presents part of the solution. NOTE: Each correct selection is worth one point.

- A. AI Builder
- B. Power Apps
- C. Business Events
- D. Microsoft Flow
- E. Common Data Service

**Answer:** C

**Explanation:**

Business events in Microsoft Power Automate

Business events can be consumed in Microsoft Power Automate via the application connector. The connector has a trigger that is named when a business event occurs. This trigger can be used to subscribe to any of the business events that are available in the target instance of the application.

Reference:

<https://docs.microsoft.com/en-us/dynamics365/fin-ops-core/dev-itpro/business-events/business-events-flow>

**NEW QUESTION 119**

HOTSPOT - (Topic 5)

A business plans to including AI Builder. Which actions can you perform?

For each of the following statements, select Yes if the statement is true. Otherwise, select No.

NOTE: Each correct selection is worth one point.

Statement	Yes	No
You can use a text classification model in AI Builder to retrieve text and analyze its meaning.	<input type="radio"/>	<input type="radio"/>
You can tag Instagram posts that mention your new product.	<input type="radio"/>	<input type="radio"/>
You can send results about the number of mentions of your new product in Instagram to Power BI for inclusion on a dashboard.	<input type="radio"/>	<input type="radio"/>

- A. Mastered
- B. Not Mastered

**Answer:** A

**Explanation:**

Statement	Yes	No
You can use a text classification model in AI Builder to retrieve text and analyze its meaning.	<input checked="" type="radio"/>	<input type="radio"/>
You can tag Instagram posts that mention your new product.	<input checked="" type="radio"/>	<input type="radio"/>
You can send results about the number of mentions of your new product in Instagram to Power BI for inclusion on a dashboard.	<input checked="" type="radio"/>	<input type="radio"/>

**NEW QUESTION 124**

- (Topic 5)

You are building a Power Automate flow to manage sales.

The sales team saves quotes as PDF files to a Microsoft OneDrive folder. You create a Microsoft SharePoint list to help the sales team manage follow ups to quotes. You need to copy the customer name, phone number, and the amount of the potential sale from the sales quote and insert the data into the SharePoint list. Which AI Builder model should you use?

- A. key phrase extraction



- B. sentiment analysis OC.
- C. text recognition
- D. language detection

Answer: C

Explanation:

Reference:  
<https://docs.microsoft.com/en-us/ai-builder/prebuilt-text-recognition>

NEW QUESTION 127

- (Topic 5)

You have a Power Automate flow that saves attachments from emails into OneDrive for Business. You need to determine why the flow is not working. What are three possible ways to achieve the goal? Each correct answer presents a complete solution. NOTE: Each correct selection is worth one point.

- A. Navigate to the Power Automate web portal and click view notifications.
- B. Enable Repair Tips for the flow.
- C. Navigate to the Action Items section of the Power Automate portal.
- D. Navigate to the Power Automate admin center and view the projects.
- E. Navigate to the flow and view the run history.

Answer: BCE

Explanation:

Reference:  
<https://docs.microsoft.com/en-us/power-automate/fix-flow-failures>

NEW QUESTION 129

HOTSPOT - (Topic 6)

You are creating a Power Virtual Agents chatbot for a company. Which component types should you use for each scenario? To answer, select the appropriate options in the answer area. NOTE: Each correct selection is worth one point.

Answer Area

Scenario	Component type
The chatbot needs to capture of the user id for authentication.	<div>Topic</div> <div>Entity</div> <div>Action</div>
A customer asks a question that needs to be handed off to a live Customer Support representative.	<div>Topic</div> <div>Entity</div> <div>Action</div>

- A. Mastered
- B. Not Mastered

Answer: A

Explanation:

Answer Area

Scenario	Component type
The chatbot needs to capture of the user id for authentication.	<div>Topic</div> <div>Entity</div> <div>Action</div>
A customer asks a question that needs to be handed off to a live Customer Support representative.	<div>Topic</div> <div>Entity</div> <div>Action</div>

NEW QUESTION 130

- (Topic 6)

You are building a Power Virtual Agents chatbot for a company. You are working with an existing topic and would like to call an action. Which technology is available to perform the action?

- A. Power Virtual Agent Entity
- B. Power Apps
- C. Power Automate
- D. Power BI

Answer: C

Explanation:

Reference:  
<https://docs.microsoft.com/en-us/power-virtual-agents/advanced-flow>

NEW QUESTION 134

- (Topic 6)  
You create a Power Virtual Agents chatbot for a company. The chatbot will use common channels and services by which the company communicates with customers.  
You need to determine which services the chatbot can be used with or added to. Which two services can the chatbot be used with? Each correct answer presents a complete solution.  
NOTE: Each correct selection is worth one point.

- A. Facebook
- B. Power BI
- C. Microsoft Azure Event Grid
- D. Microsoft Azure Service Bus
- E. Microsoft Azure Bot Framework

Answer: AE

NEW QUESTION 135

- (Topic 6)  
You are planning to allow members of your team to test your chatbot. You must ensure this is done in a secure way.  
A team member named User1 must test the chatbot. You need to ensure that User1 can complete testing. What should you do?

- A. Sign in to the authoring environment as the chatbot author.
- B. Sign in to Microsoft Azure DevOps as the chatbot author.
- C. Sign in to Microsoft Azure DevOps as User1.
- D. Sign in to the authoring environment as User1.

Answer: A

NEW QUESTION 140

HOTSPOT - (Topic 6)  
You are creating a Power Virtual Agents chatbot to help users search for available meeting rooms within a building.  
The chatbot must meet the following requirements:  
? Allow users to initiate the chatbot by typing the phrase Help me Meeting Guru.  
? Provide meeting room capacity options of 1-4 people and 5-10 people.  
? End the chatbot session if the user attempts to schedule a meeting room for more than 10 people.  
You need to identify the actions to use.  
Which actions should you use? To answer, select the appropriate options in the answer area.  
NOTE: Each correct selection is worth one point.

Requirement	Action
Allow users to initiate the chatbot by typing the phrase <b>Help me Meeting Guru</b> .	<div><div></div><div>Call a fallback topic.</div><div>Call an action.</div><div>Create a question node.</div><div>Create a trigger phrase.</div></div>
Provide meeting room capacity options of 1-4 people and 5-10 people.	<div><div></div><div>Call an action.</div><div>Call a fallback topic.</div><div>Create a condition.</div><div>Create a question node.</div></div>
End the chatbot session when the user attempts to schedule meeting room for more than 10 people.	<div><div></div><div>Add a condition.</div><div>Call an action.</div><div>Configure a fallback topic.</div><div>Create a trigger phrase.</div></div>

- A. Mastered
- B. Not Mastered

Answer: A

Explanation:

Requirement	Action
Allow users to initiate the chatbot by typing the phrase <b>Help me Meeting Guru</b> .	<div><div></div><div>Call a fallback topic.</div><div>Call an action.</div><div>Create a question node.</div><div>Create a trigger phrase.</div></div>
Provide meeting room capacity options of 1-4 people and 5-10 people.	<div><div></div><div>Call an action.</div><div>Call a fallback topic.</div><div>Create a condition.</div><div>Create a question node.</div></div>
End the chatbot session when the user attempts to schedule meeting room for more than 10 people.	<div><div></div><div>Add a condition.</div><div>Call an action.</div><div>Configure a fallback topic.</div><div>Create a trigger phrase.</div></div>

NEW QUESTION 145

DRAG DROP - (Topic 7)

You create a Power BI dashboard.

Match each option to its requirement. To answer, drag the appropriate option from the column on the left to the correct requirement on the right. Each option may be used once, more than once, or not at all.

NOTE: Each correct match is worth one point.

Options

Share

Embed

Get Data

Pin

Answer Area

Requirement	Option
Ensure that coworkers can see the dashboard.	Option
Display data from Microsoft Excel in the dashboard.	Option
Add a report tile to the dashboard.	Option

- A. Mastered
- B. Not Mastered

Answer: A

Explanation:

Options

Share

Embed

Get Data

Pin

Answer Area

Requirement	Option
Ensure that coworkers can see the dashboard.	Share
Display data from Microsoft Excel in the dashboard.	Get Data
Add a report tile to the dashboard.	Pin

NEW QUESTION 148

- (Topic 7)

A company currently does not separate testing, development, and production as per standard Application Lifecycle Management (ALM) protocol. The company uses Power for accounting and sales processes.

The company needs login only one login account per user. The company also must prevent developing and testing from impacting production.

You need to implement a solution to meet the requirements. Which method should you select?

- A. separate Microsoft Azure Storage Blobs
- B. separate connectors
- C. separate tenants
- D. separate environments

Answer: D

NEW QUESTION 151

- (Topic 7)

A company plans to move an on-premises customer service data management system to a cloud-managed solution.

The customer service application must be replaced by a model-driven application. The company uses Microsoft SQL Server Integration Services (SSIS) packages to move data from the on-premises database system to a third-party enterprise resource planning (ERP) system.

You need to replace the SSIS packages for data transfer.

What should the company use in place of the packages to move the data?

- A. Microsoft Azure Data Lake

- B. Power Virtual Agents
- C. Data Migration Framework
- D. Power Platform connector

Answer: C

NEW QUESTION 154

HOTSPOT - (Topic 7)

You are creating a Power Apps app. You want to ensure that the app can be used by individuals who have a vision impairment. For each of the following statements, select Yes if the statement is true. Otherwise, select No. NOTE: Each correct selection is worth one point.

Answer Area	Statement	Yes	No
	Power Apps can use a screen reader without the need for a connector.	<input type="radio"/>	<input type="radio"/>
	You can use an accessibility checker for Power Apps apps to check for accessibility violations and provide user interface tips.	<input type="radio"/>	<input type="radio"/>

- A. Mastered
- B. Not Mastered

Answer: A

Explanation:

Answer Area	Statement	Yes	No
	Power Apps can use a screen reader without the need for a connector.	<input type="radio"/>	<input checked="" type="radio"/>
	You can use an accessibility checker for Power Apps apps to check for accessibility violations and provide user interface tips.	<input checked="" type="radio"/>	<input type="radio"/>

NEW QUESTION 157

HOTSPOT - (Topic 7)

A company uses a cloud app built by the IT department. The app has a publicly available API to manage employee availability. You are creating an automated flow by using Power Automate that will send an email to an employee’s manager when that employee is recorded as sick in the app. You need to choose the appropriate type of connector for the flow. Select the answer that correctly completes the sentence.

Answer Area

Use a 

standard

custom

premium

standard

 connector to trigger the Power Automate cloud flow.

- A. Mastered
- B. Not Mastered

Answer: A

Explanation:

Answer Area

Use a 

standard

custom

premium

standard

 connector to trigger the Power Automate cloud flow.

NEW QUESTION 162

DRAG DROP - (Topic 7)

A company creates a new instance of Microsoft Dataverse to store customer information. Customer service agents require a simple, three-screen canvas app to interact with the Dataverse data. You need to create the app. Which four actions should you perform in sequence? To answer, move the appropriate actions from the list of actions to the answer area and arrange them in the



correct order.

Actions		Answer Area	
Choose whether to connect directly or through an on-premises data gateway.	➤		⬆
Select Dataverse from the Start from section.	⬅		⬇
Create a Dataverse connection.			
Choose a table.			
Switch to the environment with Dataverse.			

- A. Mastered
- B. Not Mastered

**Answer:** A

**Explanation:**

Actions		Answer Area	
Choose whether to connect directly or through an on-premises data gateway.	➤	Select Dataverse from the Start from section.	⬆
Select Dataverse from the Start from section.	⬅	Create a Dataverse connection.	⬇
Create a Dataverse connection.		Choose a table.	
Choose a table.		Switch to the environment with Dataverse.	
Switch to the environment with Dataverse.			

### NEW QUESTION 164

- (Topic 7)

A company uses a model-driven app for their mobile sales activities.

The company wants to modify the view that is used for sales orders. You must apply a new default filter to the view. You must also modify the default sorting for sales orders.

You need to make the changes to the view.

In which three locations can you make the changes? Each correct answer presents a complete solution.

NOTE: Each correct selection is worth one point.

- A. Power Apps site
- B. Solution Explorer
- C. Microsoft Azure DevOps
- D. App Designer

**Answer:** ACD

**Explanation:**

You can edit or remove a filter condition through the Power Apps site. You can create and edit Analytics views in Azure DevOps.

An alternative to editing views in the tables is to edit views from the app designer.

Reference:

<https://docs.microsoft.com/en-us/powerapps/maker/model-driven-apps/create-edit-view-filters>

<https://docs.microsoft.com/en-us/azure/devops/report/powerbi/analytics-views-create> <https://docs.microsoft.com/en-us/powerapps/maker/model-driven-apps/create-edit-views-app-designer>

### NEW QUESTION 165

- (Topic 7)

A company uses Microsoft Power Platform.

An administrator creates a new data loss prevention (DIP) policy.

You need to identify the Microsoft Power Platform components that must be updated to comply with the policy.

Which two types of components should you identify? Each correct answer presents a complete solution.

NOTE: Each correct selection is worth one point.

- A. Power Automate cloud flows
- B. Canvas apps
- C. Power BI reports
- D. Model-driven apps
- E. Power Pages websites

**Answer:** CE

### NEW QUESTION 169

- (Topic 7)

A Power Apps developer has sufficient permissions to create apps, connections, and flows. The developer does not have permissions needed to access company data.

You need to grant the developer access to company data for an app. Which predefined security role should you assign to the developer?

- A. Basic User
- B. System Customizer
- C. Environment Maker
- D. Delegate

**Answer:** D

#### NEW QUESTION 171

- (Topic 7)

You are developing reports for a company.

You must create visualizations that include the following data:

? Invoices due from a third-party enterprise resource planning (ERP) system

? Number of calls made to the client from Microsoft Dataverse

? Microsoft Excel file data

The reports must be displayed in a single page. You need to create the visualizations.

What should you use?

A. deployment pipelines

B. tables

C. columns

D. dashboards

**Answer: D**

#### NEW QUESTION 173

- (Topic 7)

A company is using Power Virtual Agents with Dynamics 365 Customer Service. You create a new topic. The topic performs as expected during testing.

Customers report that the new topic is not visible in the frequently asked questions section of the company's website.

You need to ensure customers can see the new topic. What should you do?

A. Analyze the chatbot

B. Paste the link to the website

C. Publish the topic.

D. Create a new variable.

E. Delete and recreate the topic.

**Answer: C**

#### NEW QUESTION 178

DRAG DROP - (Topic 7)

A company is implementing Power BI to track sales.

Each of the company's regions has specific quarterly and yearly sales goals. You need to build a Power BI dashboard for various reporting requirements.

Which chart types should you use? To answer, drag the appropriate chart types to the correct requirements. Each chart type may be used once, more than once, or not at all. You may need to drag the split bar between panes or scroll to view content.

NOTE: Each correct selection is worth one point.

Chart types	Requirement	Chart type
<div>Donut</div>	Show the quarterly sales total to date in relation to the sales goal.	<div></div>
<div>KPIs</div>	View the sales trend by month of the sales year to date for all regions.	<div></div>
<div>Line chart</div>	View the year-to-date sales as a percentage by region.	<div></div>
<div>Matrix</div>		

A. Mastered

B. Not Mastered

**Answer: A**

#### Explanation:

Box 1: KPIs

A Key Performance Indicator (KPI) is a visual cue that communicates the amount of progress made toward a measurable goal.

Box 2: Line chart

Line charts emphasize the overall shape of an entire series of values, usually over time.

Box 3: Donut

Doughnut charts are similar to pie charts. They show the relationship of parts to a whole. The only difference is that the center is blank and allows space for a label or icon.

#### NEW QUESTION 180

HOTSPOT - (Topic 7)

An organization plans to create Power Platform solutions and is evaluating Microsoft Dataverse.

Instructions: For each of the following statements, select Yes if the statement is true. Otherwise, select No.

NOTE: Each correct selection is worth one point.

	Yes	No
Virtual table data is stored in Microsoft Dataverse.	<input type="radio"/>	<input type="radio"/>
Columns are used in forms and views.	<input type="radio"/>	<input type="radio"/>

- A. Mastered
- B. Not Mastered

Answer: A

Explanation:

Graphical user interface, text  
Description automatically generated with medium confidence  
Box 1: No

A virtual table is a definition of a table in the Dataverse platform without the associated physical tables for table instances created in the Dataverse database. Instead during runtime, when a table instance is required, its state is dynamically retrieved from the associated external system.

Box 2: Yes  
Columns in forms: In the form designer, drag any columns from the Columns Explorer into the section on the form.

NEW QUESTION 183

HOTSPOT - (Topic 7)

Instructions: For each of the following statements, select Yes if the statement is true. Otherwise, select No. NOTE: Each correct selection is worth one point.

Statements	Yes	No
Stages are added under each step of a business process flow design.	<input type="radio"/>	<input type="radio"/>
Power Automate desktop flows can be used to copy a file to a folder on your local machine.	<input type="radio"/>	<input type="radio"/>
Power Automate flows can be copied to a separate solution for export to another environment.	<input type="radio"/>	<input type="radio"/>

- A. Mastered
- B. Not Mastered

Answer: A

Explanation:

Statements	Yes	No
Stages are added under each step of a business process flow design.	<input type="radio"/>	<input type="radio"/>
Power Automate desktop flows can be used to copy a file to a folder on your local machine.	<input type="radio"/>	<input type="radio"/>
Power Automate flows can be copied to a separate solution for export to another environment.	<input type="radio"/>	<input type="radio"/>

NEW QUESTION 185

HOTSPOT - (Topic 7)

A company creates the following Microsoft Power Platform environment to manage a custom model-driven app:

- ? Developer
- ? Production

You have been granted the System Administrator security role to the development environment and a custom security role named Project Team Member to the production environment Instructions: For each of the following statements, select Yes if the statement is true. Otherwise, select No.

Statements	Yes	No
You will not be able to access the app until the System Administrator security role is assigned to the app in the development environment.	<input type="radio"/>	<input type="radio"/>
You can delete records in the development environment.	<input type="radio"/>	<input type="radio"/>
You will not be able to access the app until the Project Team Member security role is assigned to the app in the production environment.	<input type="radio"/>	<input type="radio"/>

- A. Mastered
- B. Not Mastered



Answer: A

Explanation:

Statements	Yes	No
You will not be able to access the app until the System Administrator security role is assigned to the app in the development environment.	<input checked="" type="radio"/>	<input type="radio"/>
You can delete records in the development environment.	<input type="radio"/>	<input checked="" type="radio"/>
You will not be able to access the app until the Project Team Member security role is assigned to the app in the production environment.	<input checked="" type="radio"/>	<input type="radio"/>

NEW QUESTION 189

DRAG DROP - (Topic 7)

You create a model-driven app. The app is ready to be shared.  
You need to complete the process required to set the app up to be shared.  
How should you complete the process for setting up the app to be shared? To answer, drag the appropriate setting to the correct drop targets. Each source may be used once, more than once, or not at all. You may need to drag the split bar between panes or scroll to view content.  
NOTE: Each correct selection is worth one point.

Processes

Select an app from the Power Apps

Select the app and select a security

Select a user and choose a security

Select Share.

Answer Area

Step

Process

1

Process

2

Process

3

Process

4

Process

- A. Mastered
- B. Not Mastered

Answer: A

Explanation:

Processes

Select an app from the Power Apps

Select the app and select a security

Select a user and choose a security

Select Share.

Answer Area

Step

Process

1

Select an app from the Power Apps

2

Select Share.

3

Select the app and select a security

4

Select a user and choose a security

NEW QUESTION 192

HOTSPOT - (Topic 7)

You are a retail director for a large clothing company. Each week you use the corporate YouTube channel to create a video that highlights new initiatives, and goals for retail operations.  
You need to design a Power Apps app that streams the videos to internal users.  
Which objects should you use? To answer, select the appropriate options in the answer area.  
NOTE: Each correct selection is worth one point.

Action

Option

Implement the Power Apps app.

Canvas

Model-driven

Portal

Use drag and drop to add a video to the app.

View

Connector

Control

Apply consistent company colors to the app.

Unified Interface

Control

Theme

Template

- A. Mastered



B. Not Mastered

Answer: A

Explanation:

Action	Option
Implement the Power Apps app.	<div><div></div><div>Canvas</div><div>Model-driven</div><div>Portal</div></div>
Use drag and drop to add a video to the app.	<div><div></div><div>View</div><div>Connector</div><div>Control</div></div>
Apply consistent company colors to the app.	<div><div></div><div>Unified Interface</div><div>Control</div><div>Theme</div><div>Template</div></div>

NEW QUESTION 197

HOTSPOT - (Topic 7)

A company uses a model-driven app to manage its sales process.  
You are creating a Power Automate cloud flow that will send you a message in Microsoft Teams when a new order is recorded in Microsoft Dataverse.  
How should you configure the flow? Select the answer that correctly completes the sentence.

Answer Area

To determine when the flow will start, you must select

a trigger

an action

a formula

a trigger

- A. Mastered
- B. Not Mastered

Answer: A

Explanation:

Answer Area

To determine when the flow will start, you must select

a trigger

an action

a formula

a trigger

NEW QUESTION 201

- (Topic 7)

A company stores its customer warranty information in Microsoft Dataverse.  
Authenticated and authorized customers must be able to access their own warranty information without requiring a user-assigned Microsoft Power Platform license.  
You need to share warranty information with these customers. What should you use?

- A. Canvas app
- B. Model-driven app
- C. Power BI report
- D. Power Pages site

Answer: D

NEW QUESTION 204

HOTSPOT - (Topic 7)

For each of the following statements, select Yes if the statement is true. Otherwise, select No.  
NOTE: Each correct selection is worth one point.

Answer Area

Statement	Yes	No
Power Virtual Agent chatbots can be created directly in Microsoft Teams.	<input type="radio"/>	<input type="radio"/>
Power Virtual Agent chatbots can use the bot testing feature directly within Microsoft Teams.	<input type="radio"/>	<input type="radio"/>

- A. Mastered
- B. Not Mastered

Answer: A

Explanation:

Answer Area

Statement	Yes	No
Power Virtual Agent chatbots can be created directly in Microsoft Teams.	<input checked="" type="radio"/>	<input type="radio"/>
Power Virtual Agent chatbots can use the bot testing feature directly within Microsoft Teams.	<input type="radio"/>	<input checked="" type="radio"/>

NEW QUESTION 208

- (Topic 7)

The front desk of a hotel uses a model-driven app to check in guests. The hotel wants to create a canvas app for the housekeeping staff to manage cleaning supplies. The canvas app will connect to a new instance of Microsoft Dataverse. You need to create a new environment for the housekeeping staff. What should you use?

- A. Microsoft Azure portal
- B. Power Apps maker portal
- C. Microsoft 365 admin center
- D. Microsoft Power Platform admin center

Answer: D

NEW QUESTION 212

- (Topic 7)

A company wants users to start using Power Automate to improve personal productivity. You need to create a flow. Which two elements must you include? Each correct answer presents part of the solution. NOTE: Each correct selection is worth one point.

- A. condition
- B. expression
- C. trigger
- D. action

Answer: CD

Explanation:

Reference:  
<https://docs.microsoft.com/en-us/power-automate/get-started-logic-flow>

NEW QUESTION 214

HOTSPOT - (Topic 7)

A tutoring company has developed and deployed a model-driven app for the administration staff and a canvas app for teachers. Instructions: For each of the following statements, select Yes if the statement is true. Otherwise, select No. NOTE: Each correct selection is worth one point.

Answer Area

Statements	Yes	No
Teachers can access the canvas app by using desktops and mobile devices.	<input type="radio"/>	<input type="radio"/>
Only assignments of security roles are required for canvas app access.	<input type="radio"/>	<input type="radio"/>
Administration staff can create personal views and dashboards in the model-driven app.	<input type="radio"/>	<input type="radio"/>

- A. Mastered
- B. Not Mastered

Answer: A

Explanation:

Answer Area

Statements	Yes	No
Teachers can access the canvas app by using desktops and mobile devices.	<input checked="" type="radio"/>	<input type="radio"/>
Only assignments of security roles are required for canvas app access.	<input type="radio"/>	<input checked="" type="radio"/>
Administration staff can create personal views and dashboards in the model-driven app.	<input checked="" type="radio"/>	<input type="radio"/>

NEW QUESTION 215

DRAG DROP - (Topic 7)

You are assigning record level privileges for Power Apps and Model-Driven Apps.

Which privilege should you use to ensure access for each scenario? To answer, drag the appropriate privileges to the correct requirements. Each privilege may be used once, more than once, or not at all. You may need to drag the split bar between panes or scroll to view content.

NOTE: Each correct selection is worth one point.

**Privileges**

AppendAssignShare

**Requirement**

Allow users to grant access to a record they own to other users.

Grant ownership of a record to another user.

Allow the users to associate the current record with another record.

**Privilege**

- A. Mastered
- B. Not Mastered

Answer: A

Explanation:

**Privileges**

AppendAssignShare

**Requirement**

Allow users to grant access to a record they own to other users.

Grant ownership of a record to another user.

Allow the users to associate the current record with another record.

**Privilege**

Share

Assign

Append

NEW QUESTION 219

- (Topic 7)

A company is implementing Power Automate to streamline operations.

The head of customer support relations needs a Power Automate flow that texts a manager when an email meets the following criteria:

- The email is sent as high priority.
- The email is from a customer.

You need to identify how the flow's decision point will know whether the criteria are met. What should you use?

- A. data operations
- B. expressions
- C. variables
- D. actions
- E. triggers

Answer: C

NEW QUESTION 224

- (Topic 7)

You create a model-driven app for a department.

You need to make the model-driven app available to other department members. Which two methods should you use? Each correct answer presents a complete solution.

NOTE: Each correct selection is worth one point.

- A. Publish the app to AppSource.
- B. Send the application's Web URL to other team members by email.
- C. Deploy the application to other user's instances through PowerShell.
- D. Use the Share feature in the Power Apps designer.

Answer: AD

NEW QUESTION 228

DRAG DROP - (Topic 7)

You plan to use Power Automate to monitor what people are saying about your company's products. You store the feedback for research and development purposes.

You need to recommend Power Automate components to use for the solution.

To answer drag the appropriate components to the correct requirements. Each component may be used once, more than once, or not at all. You may need to drag the split Car between panes or scroll to view content.

NOTE: Each correct selection Is worth one point

Components	Requirement	Component
action	Retrieve the top five posts from your company's Facebook page.	Component
expression	Enter the resulting posts into the product database.	Component
service	Combine author and link fields into a single field.	Component
trigger	Run a flow every hour.	Component

- A. Mastered  
B. Not Mastered

**Answer: A**

**Explanation:**

Components	Requirement	Component
action	Retrieve the top five posts from your company's Facebook page.	action
expression	Enter the resulting posts into the product database.	action
service	Combine author and link fields into a single field.	expression
trigger	Run a flow every hour.	trigger

### NEW QUESTION 230

- (Topic 7)

A company uses Microsoft 365. SharePoint Online, and Dynamics 365 Sales.

You need to recommend tools to build a solution that meets the following requirements:

- Synchronize data daily (rom an external Microsoft SQL Server instance.
- Send a report automatically to specific company executives.
- Ensure that opportunities over a specified amount are approved by a sales manager.

Which two tools of components should you recommend? Each correct answer presents pan of the solution NOTE: Each correct selection is worth one point.

- A. Microsoft Word  
B. Common Data Service  
C. Power Automate  
D. Microsoft Excel  
E. Power BI

**Answer: AE**

### NEW QUESTION 235

- (Topic 7)

A company uses Power Apps canvas apps.

When a user opens Power Apps Studio in a browser and selects Apps I can edit, they do not see an app that they need to modify.

You need to determine why the user cannot see the app.

What are three possible reasons? Each correct answer presents a complete solution.

NOTE: Each correct selection is worth one point.

- A. The user selected an incorrect Power Apps environment.  
B. The user has not been granted the System Customizer role.  
C. The user has not been set as the app co-owner.  
D. The app has not been shared with the user.  
E. The environment does not have a Common Data Service database.

**Answer: ACD**

**Explanation:**

Reference:

<https://docs.microsoft.com/en-us/powerapps/maker/canvas-apps/edit-app>

### NEW QUESTION 239

- (Topic 7)

User1 creates several Power BI dashboards for a company. User1 shares a dashboard with User2 who works for another company. User2 reports that she is able to view the dashboard User2 forwards the email containing the dashboard sharing link that she received to User3.

User3 reports that he receives an error message when he selects the link to view the dashboard. User3 can view a dashboard that he has created.

You need to determine why User 3 receives an error. What is the issue?

- A. Forwarding the email does not share the dashboard with User3.  
B. User3 is running an out-of-date version of Power BI and must upgrade to a newer version.  
C. User1 is signed in using the wrong organizational account for Power BID- User2 is signed in to the dashboard and must sign out before User3 can sign in

**Answer: A**



#### NEW QUESTION 241

DRAG DROP - (Topic 7)

A company plans to implement Power BI.

The company wants to implement some specific features that Power BI does not include. You need to recommend solutions for the company.

What should you recommend? To answer, drag the appropriate solutions to the correct requirement. Each solution may be used once, more than once, or not at all. You may need to drag the split bar between panes or scroll to view content.

NOTE: Each correct selection is worth one point.

Solutions	Requirement	Solution
Microsoft AppSource	Evaluate solutions that meet current gaps in Power BI capabilities.	Solution
Microsoft Lifecycle Services	Evaluate the services of multiple companies to identify a partner that can assist in building a proof-of-concept solution.	Solution
Microsoft Azure Marketplace		

- A. Mastered  
B. Not Mastered

**Answer: A**

**Explanation:**

Solutions	Requirement	Solution
Microsoft AppSource	Evaluate solutions that meet current gaps in Power BI capabilities.	Microsoft AppSource
Microsoft Lifecycle Services	Evaluate the services of multiple companies to identify a partner that can assist in building a proof-of-concept solution.	Microsoft AppSource
Microsoft Azure Marketplace		

#### NEW QUESTION 244

DRAG DROP - (Topic 7)

You are creating a Power Automate flow.

You need to retrieve data from several sources including Microsoft Excel Azure Data Lake, and GitHub.

What should you use? To answer, drag the appropriate components to the correct data sources. Each component may be used once, more than once, or not at all.

You may need to drag the split bar between panes or scroll to view content.

NOTE: Each correct selection is worth one point.

Components	Answer Area
Connector	
Expression	
Formula	

Data source	Component
Microsoft Excel	
Azure Data Lake	
GitHub	

- A. Mastered  
B. Not Mastered

**Answer: A**

**Explanation:**

Components	Answer Area
Connector	
Expression	
Formula	

Data source	Component
Microsoft Excel	Formula
Azure Data Lake	Connector
GitHub	Expression

#### NEW QUESTION 247

- (Topic 7)

You are creating a Power Automate flow.

The flow must read each item in a Microsoft SharePoint list that details sales opportunities and set the value for a field named Status to Overdue if the value of a field named Follow up is less than or equal to the current date.

You need to select the appropriate component to cycle through the entire list. Which component should you use?

- A. Connector  
B. Action  
C. Trigger  
D. Condition

**Answer: D**

**Explanation:**

Reference:

<https://docs.microsoft.com/en-us/power-automate/use-expressions-in-conditions>

#### NEW QUESTION 248

- (Topic 7)

You overwrite a Power Automate flow by editing the definition and saving the changes. You need to be able to revert a flow to the current state. Which two options can you use? Each correct answer presents a complete solution. NOTE: Each correct selection is worth one point.

- A. Save As
- B. Rename
- C. Export
- D. Share

**Answer:** AC

#### NEW QUESTION 249

HOTSPOT - (Topic 7)

You build solutions based on Microsoft Power Platform.

You want to generate predictions in Power Automate cloud flows by using machine learning (ML) models.

You need to choose how to build and train the ML models to perform predictions. Select the answer that correctly completes the sentence.

**Answer Area**

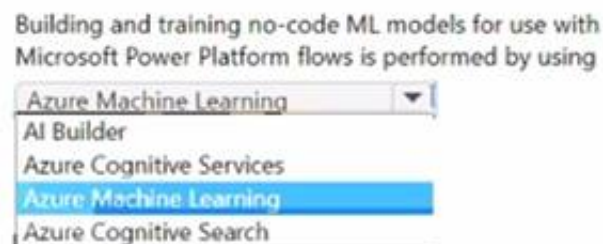

- A. Mastered
- B. Not Mastered

**Answer:** A

**Explanation:**

**Answer Area**

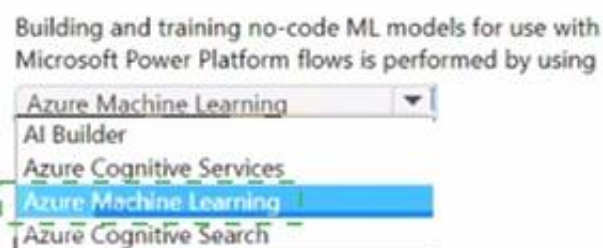

#### NEW QUESTION 253

- (Topic 7)

You create a canvas app by using the option labeled Start from data. You connect a spreadsheet that contains customer records. The customer records are displayed in a list on a screen labeled Browse.

You need to modify a property of the control on the screen. Which control should you modify?

- A. Display form
- B. Icon
- C. Search
- D. Gallery

**Answer:** C

#### NEW QUESTION 257

- (Topic 7)

You are developing a Microsoft Power Platform solution. The solution uses data stored in Microsoft Excel, a Microsoft Dataverse database, and an Azure SQL database.

You must create several visuals to enable the data to display on a screen without moving the data out of its source location.

You need to create the visuals. Which tool should you use?

- A. Power Virtual Agents
- B. Power Automate
- C. Power BI
- D. Power Platform Center of Excellence Starter Kit

**Answer:** C

#### NEW QUESTION 259

DRAG DROP - (Topic 7)

You are implementing a solution for an animal hospital.

The animal hospital must contact owners regarding their pets.

You need to model the owner and pet object information by using Microsoft Dataverse. The solution must minimize the amount of customization required:

- owner first name
- owner last name

- owner email address
- owner date of birth
- pet name
- pet breed
- pet owner

Which component should you use? To answer, drag the appropriate components to the correct data. Each component may be used once, more than once, or not at all. You may need to drag the split bar between panes or scroll to view content. NOTE: Each correct selection is worth one point.

Components

Standard Dataverse table

Custom Dataverse table

Column

Relationship

Answer Area

Data

The owner object  
The pet object  
The owner's email address  
Reference a pet record as belonging to an owner record

Component

Component

Component

Component

Component

- A. Mastered  
B. Not Mastered

Answer: A

Explanation:

Components

Standard Dataverse table

Custom Dataverse table

Column

Relationship

Answer Area

Data

The owner object  
The pet object  
The owner's email address  
Reference a pet record as belonging to an owner record

Component

Column

Column

Column

Standard Dataverse table

NEW QUESTION 260

- (Topic 7)

A company uses Dynamics 365 Supply Chain Management.

When a sales order is created for one of the customers that a specific user manages, a Microsoft Outlook task must be created to remind the user to perform any follow up activities that are required.

You need to implement the functionality to create Outlook tasks. Which feature should you use?

- A. Power Automate  
B. AI Builder  
C. Power BI  
D. Business Events  
E. Common Data Service

Answer: A

NEW QUESTION 265

HOTSPOT - (Topic 7)

You ate creating a model-driven app.

Instructions: For each of the following statements, select Yes if the statement is true. Otherwise, select No.

NOTE: Each correct selection is worth one point.

Answer Area

	Yes	No
To add entities to an app, entities are dragged onto the app canvas from the components area.	<input type="radio"/>	<input type="radio"/>
View definition is created in the component area of the app designer.	<input type="radio"/>	<input type="radio"/>
You must save, validate, and publish your app for others to see the changes.	<input type="radio"/>	<input type="radio"/>

- A. Mastered  
B. Not Mastered

Answer: A

Explanation:

Answer Area

	Yes	No
To add entities to an app, entities are dragged onto the app canvas from the components area.	<input type="radio"/>	<input checked="" type="radio"/>
View definition is created in the component area of the app designer.	<input checked="" type="radio"/>	<input type="radio"/>
You must save, validate, and publish your app for others to see the changes.	<input checked="" type="radio"/>	<input type="radio"/>

NEW QUESTION 266

HOTSPOT - (Topic 7)

For each of the following statements, select Yes if the statement is true. Otherwise, select No.

NOTE: Each correct selection is worth one point.

Statement	Yes	No
Sharing a model-driven app and sharing a canvas app both send an email with the link to the app to the users.	<input type="radio"/>	<input type="radio"/>
Administrators assign Power Platform security roles and permissions identically for canvas apps, model-driven apps, and shared apps.	<input type="radio"/>	<input type="radio"/>
You must publish both personal and system views before a user may consume them.	<input type="radio"/>	<input type="radio"/>

- A. Mastered
- B. Not Mastered

Answer: A

Explanation:  
Yes, No, No

NEW QUESTION 269

HOTSPOT - (Topic 7)  
You are creating a model-driven app.  
For each of the following statements, select Yes if the statement is true. Otherwise, select No.  
NOTE: Each correct selection is worth one point.

Statements	Yes	No
To add entities to an app, entities are dragged onto the app canvas from the components area.	<input type="radio"/>	<input type="radio"/>
View definition is created in the component area of the app designer.	<input type="radio"/>	<input type="radio"/>
You must save, validate, and publish your app for others to see the changes.	<input type="radio"/>	<input type="radio"/>

- A. Mastered
- B. Not Mastered

Answer: A

Explanation:

Statements	Yes	No
To add entities to an app, entities are dragged onto the app canvas from the components area.	<input type="radio"/>	<input checked="" type="radio"/>
View definition is created in the component area of the app designer.	<input checked="" type="radio"/>	<input type="radio"/>
You must save, validate, and publish your app for others to see the changes.	<input checked="" type="radio"/>	<input type="radio"/>

NEW QUESTION 273

DRAG DROP - (Topic 7)  
A company is creating a canvas app to manage weekly status reports from users about projects. Status reports must be created weekly. Users can enter project tasks with descriptions. Users can also add escalation requests for tasks that are late or at risk. When a status report is submitted with an escalation request the app must automatically send a text message to the submitter's manager. A reminder must be sent at 8 PM on Sunday to everyone who has not yet submitted a status report for the previous week. You need to identify the appropriate components to use in the solution. What should you use? To answer, drag the appropriate implementation mechanisms to the correct requirements. Each implementation mechanism may be used once, more than once, or not at all. You may need to drag the split bar between panes or scroll to view content  
NOTE: Each correct selection is worth one point



Implementation Mechanisms

Actions

Triggers

Conditions

Business process flows

Answer Area

Action

Automatically send a text message based on the report submission.

Automatically send a reminder at 8 PM based on a missing status report.

Implementation Mechanism

- A. Mastered
- B. Not Mastered

Answer: A

Explanation:

Implementation Mechanisms

Actions

Triggers

Conditions

Business process flows

Answer Area

Action

Automatically send a text message based on the report submission.

Automatically send a reminder at 8 PM based on a missing status report.

Implementation Mechanism

Triggers

Actions

NEW QUESTION 275

HOTSPOT - (Topic 7)

Institutions: For each of the following statements, select Yes if the statement is true. Otherwise, select No.

NOTE: Each correct selection is worth one point.

Answer Area

Statements

A Microsoft Power Platform environment must contain a Microsoft Dataverse database.

An app created in an environment can only connect to the data sources that are deployed in the same environment.

Microsoft Dataverse for Teams environments are automatically created for all members of the team when you create a Microsoft Power Platform app in Microsoft Teams.

Yes

No

- A. Mastered
- B. Not Mastered

Answer: A

Explanation:

Answer Area

Statements

A Microsoft Power Platform environment must contain a Microsoft Dataverse database.

An app created in an environment can only connect to the data sources that are deployed in the same environment.

Microsoft Dataverse for Teams environments are automatically created for all members of the team when you create a Microsoft Power Platform app in Microsoft Teams.

Yes

No

NEW QUESTION 279

- (Topic 7)

You create a multi-page Power BI report for an organization.

You must enable salespeople in the organization to use the report to view data relevant to their sales region only.

You need to enable security for the report. What should you use?

- A. Microsoft Trust Center
- B. row-level security
- C. data loss prevention policies
- D. sensitivity labels
- E. Microsoft Azure Active Directory

Answer: B

**NEW QUESTION 283**

- (Topic 7)  
A company creates canvas apps for its sales team. A user creates a canvas app from a data source. You need to determine the screens created. Which three screens should you identify? Each correct answer presents part of the solution.  
NOTE: Each correct selection is worth one point.

- A. welcome
- B. edit/create
- C. browse
- D. details
- E. delete

**Answer:** BCD

**NEW QUESTION 285**

DRAG DROP - (Topic 7)  
You create a Power Pages site to share Microsoft Dataverse data with external customer. Customer must be authenticated to view data. Which component should you use for each requirement? To answer, drag the appropriate component to the correct requirements. Each component may be used more once than once, or not at all. You may need to drag the spilt bar between panes or scroll to view content.

Components

Form

IFrame

List

Section

Answer Area

Requirement

Collect data from customers and store the data in a table.

Display multiple rows from a table.

Component

- A. Mastered
- B. Not Mastered

**Answer:** A

**Explanation:**

Components

Form

IFrame

List

Section

Answer Area

Requirement

Collect data from customers and store the data in a table.

Display multiple rows from a table.

Component

Form

List

**NEW QUESTION 290**

HOTSPOT - (Topic 7)  
You receive a copy of a Power Automate cloud flow from a colleague. For each of the following statements, select Yes if the statement is true. Otherwise, select No.  
NOTE: Each correct selection is worth one point.

Statement	Yes	No
You can create a new flow that is a copy of the original flow.	<input type="radio"/>	<input type="radio"/>
You can modify the original flow.	<input type="radio"/>	<input type="radio"/>

- A. Mastered
- B. Not Mastered

**Answer:** A

**Explanation:**

Statement	Yes	No
You can create a new flow that is a copy of the original flow.	<input checked="" type="radio"/>	<input type="radio"/>
You can modify the original flow.	<input type="radio"/>	<input checked="" type="radio"/>

NEW QUESTION 291

- (Topic 7)  
A company is using Power Automate to automate business processes. You need to run a flow when a user presses a button in an app. Which trigger type should you recommend?

- A. Power Apps
- B. for a selected row
- C. manually trigger a flow

Answer: A

Explanation:  
Reference:  
<https://docs.microsoft.com/en-us/powerapps/maker/canvas-apps/using-logic-flows>

NEW QUESTION 294

HOTSPOT - (Topic 7)  
A company plans to use Power Platform to build apps that address specific business challenges. You need to recommend the appropriate types of Power Apps to use. What should you recommend? To answer, select the appropriate options in the answer area.  
NOTE: Each correct selection is worth one point

Answer Area

Scenario

Field technicians need a mobile app to capture the location and the image of defective products.  
Sales representatives need to see different views and dashboards in the sales app.

Tool

Canvas app  
Power Apps Portals  
Common Data Service

Canvas app  
Model-driven app  
Power Apps Portals

- A. Mastered
- B. Not Mastered

Answer: A

Explanation:

Answer Area

Scenario

Field technicians need a mobile app to capture the location and the image of defective products.  
Sales representatives need to see different views and dashboards in the sales app.

Tool

Canvas app  
Power Apps Portals  
Common Data Service

Canvas app  
Model-driven app  
Power Apps Portals

NEW QUESTION 297

HOTSPOT - (Topic 7)  
Instructions: For each of the following statements, select Yes if the statement is true. Otherwise, select No.  
NOTE: Each correct selection is worth one point.

	Yes	No
Managed solutions can be used to group multiple Power Platform components together during solution development.	<input type="radio"/>	<input type="radio"/>
Managed solutions must be used to distribute a Power Platform application on AppSource.	<input type="radio"/>	<input type="radio"/>
Managed solutions always protect Power Platform components from editing when components are exported to another environment.	<input type="radio"/>	<input type="radio"/>

- A. Mastered
- B. Not Mastered

Answer: A

Explanation:  
Box 1: Yes  
Managed solutions are used to deploy to any environment that isn't a development environment for that solution.  
Box 2: No  
Unmanaged solutions can be exported either as unmanaged or managed.

Box 3: Yes  
You can't edit components directly within a managed solution. To edit managed components, first add them to an unmanaged solution.

NEW QUESTION 299

HOTSPOT - (Topic 7)

A company uses Microsoft Dataverse to manage business data.  
You need to import data into Dataverse from other data sources by using dataflows.  
For each of the following statement, select Yes if the statement is true. Otherwise, select No.  
NOTE: Each correct selection is worth one point.

Answer Area

Statements	Yes	No
You can access data sources in a dataflow by using the connectors that are used with Power Automate.	<input type="radio"/>	<input type="radio"/>
You can use Power Query to shape and transform the data in a dataflow.	<input type="radio"/>	<input type="radio"/>
You can run dataflows on a schedule to refresh the data in Dataverse.	<input type="radio"/>	<input type="radio"/>

- A. Mastered
- B. Not Mastered

Answer: A

Explanation:

Answer Area

Statements	Yes	No
You can access data sources in a dataflow by using the connectors that are used with Power Automate.	<input checked="" type="radio"/>	<input type="radio"/>
You can use Power Query to shape and transform the data in a dataflow.	<input checked="" type="radio"/>	<input type="radio"/>
You can run dataflows on a schedule to refresh the data in Dataverse.	<input checked="" type="radio"/>	<input type="radio"/>

NEW QUESTION 300

DRAG DROP - (Topic 7)

A team of five people plans to create Power Platform solutions for a company. Team member plan to initially use Power Platform trail instances to create solutions. Team members have questions about how many Power Platform instances and Common Data Service databases they need. You need to respond to the team. How should you respond? To answer, drag the appropriate responses to the correct questions. Each response may be used once, more than once, or not at all. You may need to drag the split bar between panes or scroll to view content

Responses

One per userOne per tenantOne per environmentOne per Power Platform app

Answer Area

Question	Response
How many trial instances must the team create?	<input type="text"/>
How many Microsoft Dataverse databases must the team create?	<input type="text"/>

- A. Mastered
- B. Not Mastered

Answer: A

Explanation:

Responses

One per userOne per tenantOne per environmentOne per Power Platform app

Answer Area

Question	Response
How many trial instances must the team create?	One per Power Platform app
How many Microsoft Dataverse databases must the team create?	One per environment

NEW QUESTION 301

DRAG DROP - (Topic 7)

A company plans to use Power Automate to automate tasks.  
Match each flow type to its description lo answer, drag the appropriate now type from the column on the left to its description on the right. Each option may be used once, more than once, or not at all.  
NOTE: Each correct match is worth one point.

Flow types	Answer Area
automated	Description
business process	a flow that runs after it is triggered by an event
scheduled	a flow that guides a user through a set of tasks
instant	a flow that runs after a specified number of days
	a flow that allows you to start tasks on demand
	Flow type
	Flow type
	Flow type
	Flow type

- A. Mastered



B. Not Mastered

Answer: A

Explanation:

Flow types

automated

business process

scheduled

instant

Answer Area

Description

a flow that runs after it is triggered by an event

a flow that guides a user through a set of tasks

a flow that runs after a specified number of days

a flow that allows you to start tasks on demand

Flow type

automated

business process

scheduled

instant

NEW QUESTION 303

- (Topic 7)

A user requests removal of the fax column from the following form in a model-driven app:

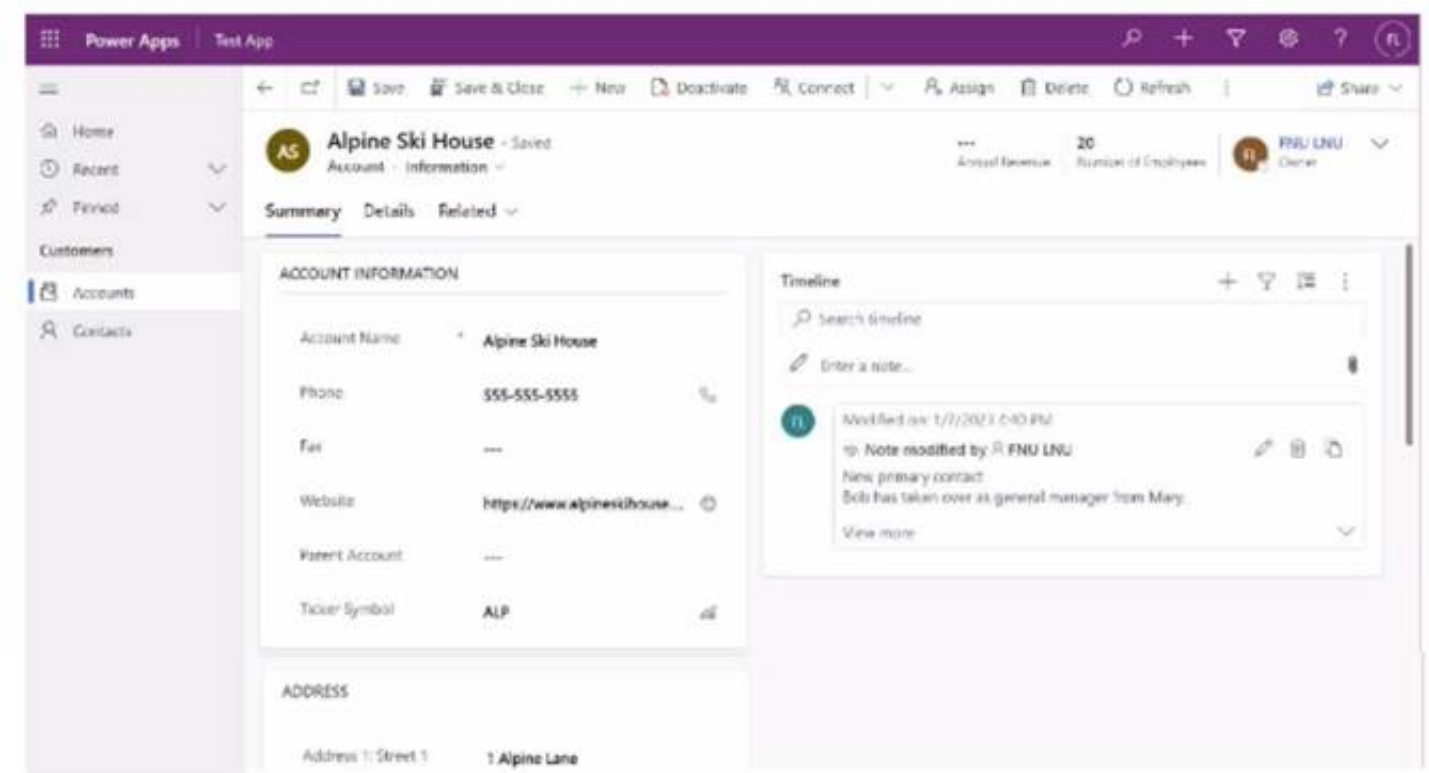

You need to remove the fax column.  
Which from should you open in the app designer?

- A. Alpine Ski House
- B. Summary
- C. Information
- D. Account

Answer: D

NEW QUESTION 307

- (Topic 7)

A company is building apps to support their business operations. The apps will use connectors to access data from several data sources and respond to a number of events generated by components.  
Which two operations can you use for connectors? Each correct answer presents part of the solution.  
NOTE: Each correct selection is worth one point.

- A. Triggers
- B. Plug-ins
- C. Actions
- D. Gateways

Answer: CD

NEW QUESTION 309

HOTSPOT - (Topic 7)

Instructions: For each of the following statements, select Yes if the statement is true. Otherwise, select No.  
NOTE: Each correct selection is worth one point.

Answer Area

The date and time are the triggers for a scheduled cloud flow.

Cloud flows must be exported to a Microsoft Excel file to copy them to another environment.

Users must create desktop flows to share them without being an administrator.

Yes

No

Yes

No

Yes

No

- A. Mastered
- B. Not Mastered

Answer: A

Explanation:

Answer Area

	Yes	No
The date and time are the triggers for a scheduled cloud flow.	<input type="radio"/>	<input checked="" type="radio"/>
Cloud flows must be exported to a Microsoft Excel file to copy them to another environment.	<input type="radio"/>	<input checked="" type="radio"/>
Users must create desktop flows to share them without being an administrator.	<input type="radio"/>	<input checked="" type="radio"/>

NEW QUESTION 310

HOTSPOT - (Topic 7)

A company plans to use Power BI to visualize data from business systems.

For each of the following statements, select Yes if the statement is true. Otherwise, select No.

NOTE: Each correct selection is worth one point.

Statement	Yes	No
You can display data aggregates and raw data in a Power BI report.	<input type="radio"/>	<input type="radio"/>
You can display related data from multiple sources in the same Power BI report.	<input type="radio"/>	<input type="radio"/>

- A. Mastered
- B. Not Mastered

Answer: A

Explanation:

Statement	Yes	No
You can display data aggregates and raw data in a Power BI report.	<input checked="" type="radio"/>	<input type="radio"/>
You can display related data from multiple sources in the same Power BI report.	<input type="radio"/>	<input checked="" type="radio"/>

NEW QUESTION 312

- (Topic 7)

A company is considering using Power Pages for its website. You need to identify the capabilities of Power Pages.

What are two capabilities of Power Pages? Each correct answer presents a complete solution.

NOTE: Each correct selection is worth one point.

- A. Supporting multiple language
- B. Creating customized styling for each user
- C. Providing low-code websites hosted as a service
- D. Supplying OData feeds

Answer: AC

NEW QUESTION 314

.....

## Thank You for Trying Our Product

### We offer two products:

1st - We have Practice Tests Software with Actual Exam Questions

2nd - Questions and Answers in PDF Format

### PL-900 Practice Exam Features:

- \* PL-900 Questions and Answers Updated Frequently
- \* PL-900 Practice Questions Verified by Expert Senior Certified Staff
- \* PL-900 Most Realistic Questions that Guarantee you a Pass on Your First Try
- \* PL-900 Practice Test Questions in Multiple Choice Formats and Updates for 1 Year

**100% Actual & Verified — Instant Download, Please Click**  
**[Order The PL-900 Practice Test Here](#)**