

PL-900 Dumps

Microsoft Power Platform Fundamentals

<https://www.certleader.com/PL-900-dumps.html>



NEW QUESTION 1

- (Topic 1)

A company uses Power Platform.

You must ensure that users cannot share customer data with other users. You must also ensure that users cannot connect to data sources unless you grant the user explicit permissions to access a data source.

You need to recommend solutions to meet the company's security requirements.

Which two types of policies should you recommend? Each correct answer presents part of the solution.

NOTE: Each correct selection is worth one point.

- A. Office cloud policies
- B. Group Policy Objects
- C. environment-level policies
- D. tenant-level policies
- E. preset security policies

Answer: CD

Explanation:

Reference:

<https://docs.microsoft.com/en-us/power-platform/admin/wp-data-loss-prevention> <https://docs.microsoft.com/en-us/power-platform/admin/create-dlp-policy>

NEW QUESTION 2

- (Topic 1)

You are a customer service manager.

You need to implement a Power Apps portal that allows customers to submit cases. Which type of data source is used?

- A. Dynamics 365 Connector
- B. Microsoft SharePoint
- C. Microsoft Azure Storage
- D. Common Data Service

Answer: B

Explanation:

SharePoint can be set up to setup customer feedback.

Note: The PowerApp uses Finance and Operations connector to grab sales order information and SharePoint connector to connect and write the data to SharePoint list.

Reference:

<https://powerapps.microsoft.com/en-us/blog/scenario-2-collect-customer-feedback-in-sharepoint-after-order-delivery/>

NEW QUESTION 3

- (Topic 1)

A company uses Dynamics 365 Sales. The company uses a browser-based app named Sales Hub.

You need ensure that users can access data from mobile devices. Which app should users install?

- A. Dynamics 365 Remote Assist
- B. Dynamics 365 Finance
- C. Dynamics 365 Business Central
- D. Dynamics 365 for Phones

Answer: D

Explanation:

Use the Dynamics 365 for phones and Dynamics 365 for tablets apps for your sales, customer service, field service, and other tasks when you're on the go. With one download from your app store, you'll automatically have access to all the apps you need for your role. You will see apps with the new Unified Interface on your mobile device.

Reference:

<https://docs.microsoft.com/en-us/dynamics365/mobile-app/dynamics-365-phones-tablets-users-guide>

NEW QUESTION 4

HOTSPOT - (Topic 1)

You are building Power Apps apps that use both Dynamics 365 Sales and Microsoft 365. For each of the following statements, select Yes if the statement is true. Otherwise, select

No.

NOTE: Each correct selection is worth one point.

Statement	Yes	No
Dynamics 365 Sales and Microsoft 365 must be in the same tenant to allow Single Sign-On (SSO).	<input type="radio"/>	<input type="radio"/>
You must download a product from AppSource to ensure that SSO works with Dynamics 365 Sales and Microsoft 365.	<input type="radio"/>	<input type="radio"/>

- A. Mastered
B. Not Mastered

Answer: A

Explanation:

Box 1: No

When you offer your application for use by other companies through a purchase or subscription, you make your application available to customers within their own Azure tenants. This is known as creating a multi-tenant application.

Box 2: No

NEW QUESTION 5

HOTSPOT - (Topic 1)

You have version 1.0.0.0 of a published Power Apps app. You create and publish version 2.0.0.0 of the app. A customer goes through the process of restoring the previous version of the app.

How many versions of the app are displayed in the Version tab for the app? To answer, select the appropriate option in the answer area.

You will see

	▼
0	
1	
2	

 versions of the app.

- A. Mastered
B. Not Mastered

Answer: A

Explanation:

You will see

	▼
0	
1	
2	

 versions of the app.

NEW QUESTION 6

- (Topic 1)

You need to implement Microsoft Business Applications along with the Microsoft Power platform.

Which three Microsoft products are part of the Power platform? Each correct answer presents a complete solution.

NOTE: Each correct selection is worth one point.

- A. Microsoft Power Apps
B. Azure Active Directory
C. Microsoft Flow
D. Azure Machine Learning
E. Microsoft Power BI

Answer: ACE

Explanation:

The Power Platform uses PowerApps, Power BI, and Power Automate (previously named Flow) to customize, extend, and build all the apps you need for your business and unlock the potential of Office 365 and Dynamics 365.
Reference:
<https://docs.microsoft.com/en-us/learn/powerplatform/>

NEW QUESTION 7

DRAG DROP - (Topic 1)
You manage the support team at a rapidly growing company.
Customers and support technicians need a better experience when logging and responding to support requests. You need more visibility into what the support technicians are doing every week.
You need to recommend tools to help the company's needs.
Which tools should you recommend? To answer, drag the appropriate tools to the correct requirements. Each tool may be used once, more than once, or not at all. You may need to drag the split bar between panes or scroll to view content.
NOTE: Each correct selection is worth one point.

Tools	Requirement	Tool
Power Apps	Customers must be able to submit support requests by using a website.	Tool
Microsoft Flow		Tool
Power BI		Tool
Common Data Service		Tool
	Support requests must be created and stored.	Tool
	Support technicians must be notified when a new support request is entered.	Tool
	Support technicians must be able to enter a status report for work completed during the previous week by using a mobile app.	Tool

- A. Mastered
- B. Not Mastered

Answer: A

Explanation:

Tools	Requirement	Tool
Power Apps	Customers must be able to submit support requests by using a website.	Power BI
Microsoft Flow		Common Data Service
Power BI		Microsoft Flow
Common Data Service		Power Apps
	Support requests must be created and stored.	
	Support technicians must be notified when a new support request is entered.	
	Support technicians must be able to enter a status report for work completed during the previous week by using a mobile app.	

NEW QUESTION 8

- (Topic 1)
A large retail company implements Power Apps, Microsoft Flow, and the Common Data Service.
The board of directors is asking whether users are finding value in the technology. The company would like to measure and report usage of the software.
You need to recommend a tool to determine software usage. What should you recommend?

- A. Microsoft Intune
- B. Azure Stream Analytics
- C. Power Platform Analytics
- D. Dynamics 365 Product Insights

Answer: C

Explanation:

The Power Platform Analytics Usage report is the default reports seen by the logged in environment admin. It provides total app launches and daily active users across all apps in the environment. Admins can filter the view with attributes like device platform, player version, country, state, and city.
Reference:
<https://docs.microsoft.com/en-us/power-platform/admin/analytics-powerapps>

NEW QUESTION 9

HOTSPOT - (Topic 1)
A company plans to implement Power Platform apps. The company does not plan to use any development tools or plug-ins.
Which actions can you perform?
For each of the following statements, select Yes if the statement is true. Otherwise, select No.
NOTE: Each correct selection is worth one point.

Statement	Yes	No
You can synchronize account names with a third-party proprietary database.	<input type="radio"/>	<input type="radio"/>
You can create invoices from orders and then send the invoices to the customer.	<input type="radio"/>	<input type="radio"/>

- A. Mastered
B. Not Mastered

Answer: A

Explanation:

The Power Platform uses PowerApps, Power BI, and Power Automate (previously named Flow) to customize, extend, and build all the apps you need for your business and unlock the potential of Office 365 and Dynamics 365.

NEW QUESTION 10

HOTSPOT - (Topic 2)

A company plans to use Power BI to visualize data from business systems.

For each of the following statements, select Yes if the statement is true. Otherwise, select No.

NOTE: Each correct selection is worth one point.

Statement	Yes	No
You can display data aggregates and raw data in a Power BI report.	<input type="radio"/>	<input type="radio"/>
You can display related data from Dynamics 365 Customer Engagement and Excel in the same Power BI report.	<input type="radio"/>	<input type="radio"/>
You create a Power App to supply data for a Power BI report. You can modify the data directly in the report.	<input type="radio"/>	<input type="radio"/>

- A. Mastered
B. Not Mastered

Answer: A

Explanation:

Box 1: Yes

The following list provides advantages to using aggregations:

Query performance over big data - as users interact with visuals on Power BI reports, DAX queries are submitted to the dataset. Boost query speeds by caching data at the aggregated level, using a fraction of the resources required at the detail level. Unlock big data in a way that would otherwise be impossible.

Box 2: No

You can connect to model-driven apps in Dynamics 365 with Power BI Desktop to create custom reports and dashboards for use with the Power BI service.

You can use similar steps to connect to model-driven apps in Dynamics 365 using Office Excel Power Query by selecting From Other Sources on the Power Query tab in Excel.

Box 3: Yes

Using the PowerApps custom visual, you will be able to pass context aware data to a PowerApps app which updates in real time as you make changes to your report.

NEW QUESTION 10

- (Topic 2)

What is a benefit of deploying Microsoft 365 and Dynamics 365 apps in the same tenant?

- A. Use Common Data Services to connect to application data.
B. You only need to set up groups in Microsoft 365 for permissions to all data.
C. Users can access both Microsoft 365 and Dynamics 365 by using Single Sign-on (SSO).

Answer: A

NEW QUESTION 13

- (Topic 2)

A company uses Microsoft 365 and Dynamics 365 Sales. The company does not have any developers on its staff.

You need to explain to the executives the benefits of using Power Platform apps. What are two benefits? Each correct answer presents a complete solution.

NOTE: Each correct selection is worth one point.

- A. Users can send emails from Dynamics 365 Sales to their personal email addresses.
B. Users can create Power Apps to create apps for different departments.

- C. Users can use Power Automate to share information between Microsoft 365 and Dynamics 365 Sales.
D. The company must unify all the mobile devices to one vendor.

Answer: BC

NEW QUESTION 14

- (Topic 2)

A company plans to use AI Builder to help improve business performance. You need to determine which AI Models are available for use. Which three types of models can you use? Each correct answer presents a complete solution.

NOTE: Each correct selection is worth one point.

- A. linear regression
B. binary classification
C. object detection
D. anomaly detection
E. text classification

Answer: BCE

Explanation:

Reference:

<https://carldesouza.com/using-the-ai-builder-in-the-microsoft-power-platform-for-binary-classification/>

NEW QUESTION 18

- (Topic 2)

A company is evaluating ways that they can implement AI Builder.

For which two scenarios can you use AI Builder? Each correct selection presents a complete solution.

NOTE: Each correct selection is worth one point.

- A. Send emails to all ai users who subscribe to a service.
B. Synchronize data from an external database.
C. Collect data from several data sources and display a dashboard that shows trending data.
D. Interpret images and perform an action on the image.

Answer: BD

Explanation:

Reference:

<https://powerapps.microsoft.com/en-us/blog/introducing-ai-builder-for-powerplatform/>

NEW QUESTION 23

HOTSPOT - (Topic 2)

You are creating a model-driven Power Apps app. You want to ensure that the app can be used by individuals who have vision impairments.

For each of the following statements, select Yes if the statement is true. Otherwise, select No.

NOTE: Each correct selection is worth one point.

Statement	Yes	No
Power Apps apps can be built with hot key support and designed so they do not require a touch screen or mouse.	<input type="radio"/>	<input type="radio"/>
Only model-driven Power Apps have support for using a screen reader without the need for a connector.	<input type="radio"/>	<input type="radio"/>
The accessibility checker can be run for your Power Apps app to provide notifications of accessibility violations as well as tips for making it even more user friendly.	<input type="radio"/>	<input type="radio"/>

- A. Mastered
B. Not Mastered

Answer: A

Explanation:

Box 1: Yes

You can use keyboard shortcuts in PowerApps. Keyboard shortcuts give you an alternate way to do common tasks instead of using your mouse or tapping with your finger. They help in seamless navigation of the interface.

Box 2: No

The following software combinations are the supported recommendations for consuming PowerApps with a screen reader:

Windows: Microsoft Edge / Narrator macOS: Safari / VoiceOver Android: PowerApps app / Talkback iOS: PowerApps app / VoiceOver
Box 3: Yes

Users who have vision, hearing, or other impairments can use your canvas app more easily and successfully if you consider accessibility as you design how the app looks and behaves. If you're not sure how to make your app more accessible, you can run the Accessibility checker in PowerApps Studio. This tool not only finds potential accessibility issues but also explains why each might be a potential problem for users who have a specific disability and offers suggestions on how to resolve each issue. The Accessibility checker detects screen-reader and keyboard issues for you, and you can find information about how to fix color-contrast issues by using accessible colors.

NEW QUESTION 24

- (Topic 2)

A coworker is creating an app in Power Apps and needs to automatically synchronize data from an external source. The coworker is unable to locate a suitable Microsoft approved connector template in AppSource.

You need to recommend a solution for the coworker. What should you recommend?

- A. Create a custom connector.
- B. Ask the outside source to send you the data once a week.
- C. Use Microsoft Flow to connect to the database.
- D. Open a ticket with Microsoft and request a new connector.
- E. Use Microsoft Azure Service Bus.

Answer: A

Explanation:

There are 250 + predefined connectors that you can use in your PowerApps and in your Microsoft Flows. If you do not find any that suits your needs you have the possibility to create a Custom Connector.

Note: A Custom Connector is a wrapper around a REST API (Logic Apps also supports SOAP APIs) that allows Logic Apps, Microsoft Flow, or PowerApps to communicate with that REST or SOAP API.

Reference:

<https://carinaclaesson.com/2019/09/06/setting-up-a-custom-connector-from-an-openapi-file-and-utilizing-it-in-powerapps-and-flow/>

NEW QUESTION 25

HOTSPOT - (Topic 2)

A company plans to create a Common Data Service environment.

For each of the following statements, select Yes if the statement is true. Otherwise, select No.

NOTE: Each correct selection is worth one point.

Statement	Yes	No
You can create a Common Data Service environment in the Power Platform Admin center.	<input type="radio"/>	<input type="radio"/>
You must enable data encryption after you create a Common Data Service environment.	<input type="radio"/>	<input type="radio"/>
You can control security roles and privileges in a Common Data Service Environment from the Power Apps Admin center.	<input type="radio"/>	<input type="radio"/>

- A. Mastered
- B. Not Mastered

Answer: A

Explanation:

Statement	Yes	No
You can create a Common Data Service environment in the Power Platform Admin center.	<input checked="" type="radio"/>	<input type="radio"/>
You must enable data encryption after you create a Common Data Service environment.	<input type="radio"/>	<input checked="" type="radio"/>
You can control security roles and privileges in a Common Data Service Environment from the Power Apps Admin center.	<input checked="" type="radio"/>	<input type="radio"/>

NEW QUESTION 26

- (Topic 2)

A toy company creates a text classification model in AI Builder to monitor customer feedback for specific key words. When negative feedback is received for a toy, the company wants to proactively perform engineering reviews for the toy and schedule additional training sessions for workers who produce the toy. What are two possible ways to achieve the goal? Each correct answer presents a complete solution. NOTE: Each correct selection is worth one point.

- A. Create a canvas app.
- B. Implement the Virtual Agent.
- C. Build a Microsoft Flow.
- D. Use the Common Data Model.

Answer: AC

Explanation:

A (not D): AI Builder comes with:

A ready-to-use business card reader available in canvas as well as in model-driven apps. Business card reader (Canvas)

Business card reader (Model-driven)

Additional canvas components to leverage your AI Builder form processing or object detection models canvas apps.

C: Use the results from your AI model across Power Platform to create end-to-end solutions that meet your business needs, even if you have no coding skills. For example, create a flow that automates document processing in Power Automate, or an app created with PowerApps that predicts whether a supplier will be out of compliance.

Reference:

<https://docs.microsoft.com/en-us/ai-builder/use-in-powerapps-overview>

NEW QUESTION 28

HOTSPOT - (Topic 2)

A company plans to create Power Platform apps that consume industry-standard and proprietary data sources.

For each of the following statements, select Yes if the statement is true. Otherwise, select No.

NOTE: Each correct selection is worth one point.

Statement	Yes	No
Custom connector cannot be used if a standard connector for the service is available.	<input type="radio"/>	<input type="radio"/>
Custom connectors are supported in instant flows only.	<input type="radio"/>	<input type="radio"/>
Standard and custom connectors cannot be mixed within the same flow or app.	<input type="radio"/>	<input type="radio"/>

- A. Mastered
- B. Not Mastered

Answer: A

Explanation:

Statement	Yes	No
Custom connector cannot be used if a standard connector for the service is available.	<input checked="" type="radio"/>	<input type="radio"/>
Custom connectors are supported in instant flows only.	<input type="radio"/>	<input checked="" type="radio"/>
Standard and custom connectors cannot be mixed within the same flow or app.	<input checked="" type="radio"/>	<input type="radio"/>

NEW QUESTION 32

- (Topic 2)

You create a Power Virtual Agents chatbot.

You need to share the bot with other team members so that they can try out the bot before you share the bot with customers.

What should you use?

- A. demo website
- B. live production website
- C. test chat feature

Answer: C

Explanation:
Reference:
<https://docs.microsoft.com/en-us/power-virtual-agents/authoring-test-bot>

NEW QUESTION 34
HOTSPOT - (Topic 2)
Your company wants to create a help desk system and implement Dynamics 365 Customer Service.
The company has the following requirements:
? Provide an application to allow support team staff to chat live with a customer.
? Automatically import data from a Microsoft Excel spreadsheet once a day.
? Provide a chatbot that can assist customers who need support.
You need to determine which applications to use to meet the requirements.
Which applications should you use? To answer, select the appropriate options in the answer area.
NOTE: Each correct selection is worth one point.

Requirement	Application
Automatically import data from a Microsoft Excel spreadsheet once a day.	<div><div></div><div>Custom Connector</div><div>Azure Data Lake</div><div>Power Automate</div><div>Power BI</div></div>
Provide a chatbot that can assist customers who need support.	<div><div></div><div>Power Virtual Agent</div><div>Power Automate</div></div>

- A. Mastered
- B. Not Mastered

Answer: A

Explanation:

Requirement	Application
Automatically import data from a Microsoft Excel spreadsheet once a day.	<div><div></div><div>Custom Connector</div><div>Azure Data Lake</div><div>Power Automate</div><div>Power BI</div></div>
Provide a chatbot that can assist customers who need support.	<div><div></div><div>Power Virtual Agent</div><div>Power Automate</div></div>

NEW QUESTION 38
- (Topic 3)
You create a Power BI dashboard that displays data from Dynamics 365 Customer Engagement.
You need to share the Power BI dashboard with coworkers.
What are three possible ways to achieve the goal? Each correct answer presents a complete solution.
NOTE: Each correct selection is worth one point.

- A. Create a Power BI workspace and grant coworkers permissions.
- B. Publish the dashboard as an app to your coworkers.
- C. Export the data into Common Data Service for others to manipulate in Power BI.
- D. Export the data to Microsoft Excel for coworkers to import and view in Power BI.
- E. Embed reports in your company's internal web portal.

Answer: ABE

Explanation:
A: Basic Sharing for Dashboards and Reports through a workspace is the most common way of sharing the Power BI content. Basic Sharing is very simple and easy to use method. You can simply click on the Share button in the dashboard or report, and then share it with other users.



B: Apps are great sharing method for multiple environment, and best way of sharing for users in production environment.

Power BI App is the solution for multiple environment approach. With Power BI App, your development environment (workspace), and user environment (App) are isolated from each other.

Note: If you are using SharePoint online as a portal for document management and some other reasons already, then consider using Embed in SharePoint Online feature of Power BI reports. This method is secure and you can share the report only with Power BI users you want.

E: Sometimes, you don't need a secure way of sharing, you may search for an easy and free way of sharing, and your content is not confidential or sensitive.

Publish to web is your friend in such situation. This is the only free way of sharing in Power BI, but be aware that this method is not secure.

Publish to web method, gives you an embed code, which you can use in any web pages to embed the Power BI report in it

Reference:

<https://radacad.com/power-bi-sharing-methods-comparison-all-in-one-review>

NEW QUESTION 40

- (Topic 3)

You are using Dynamics 365 Sales.

You need to pull data into a Power BI report for your team. The City and State columns must be combined to form one column on the report.

Which function would you use? Each correct answer presents a complete solution. NOTE: Each correct selection is worth one point.

A. Use Power Query to merge columns.

B. Import the dat

C. 18912E1457D5D1DDCBD40AB3BF70D5D

D. Export data to Microsoft Excel.

E. Create a view.

Answer: A

Explanation:

Reference:

<https://docs.microsoft.com/en-us/power-bi/desktop-shape-and-combine-data>

NEW QUESTION 41

DRAG DROP - (Topic 3)

A company plans to implement Power BI to analyze retail operations data. You need to recommend solutions for the company.

Which Power BI components should the company use? To answer, drag the appropriate Power BI components to the correct requirements. Each Power BI component may be used once, more than once, or not at all. You may need to drag the split bar between panes or scroll to view content.

NOTE: Each correct selection is worth one point.

Power BI components	Answer Area	
	Requirement	Power BI component
reports	Allow users to set and receive alerts when data changes beyond specified limits.	
workspaces		
dashboards	View and filter data and export data to Microsoft Excel for further manipulation and analysis.	
dataset		

A. Mastered

B. Not Mastered

Answer: A

Explanation:

Power BI components	Requirement	Power BI component
reports	Allow users to set and receive alerts when data changes beyond specified limits.	workspaces
workspaces		
dashboards	View and filter data and export data to Microsoft Excel for further manipulation and analysis.	dataset
dataset		

NEW QUESTION 46

- (Topic 3)

This question requires that you evaluate the BOLD text to determine if it is correct.

You have a Power BI report with a page named RevReceived. The page shows revenue received by your company. You want to create an almost identical page that shows net revenue instead of gross revenue. To accomplish this task, you modify the RevReceived page.

Review the underlined text. If it makes the statement correct, “No change is needed”. If the statement is incorrect, select the answer choice that makes the statement correct.

- A. No change is needed.
- B. duplicate the RevReceived page.
- C. import the RevReceived page.
- D. copy the visuals from RevReceived to a new page.

Answer: B

Explanation:

Reference: https://www.tutorialspoint.com/power_bi/power_bi_quick_guide.htm

NEW QUESTION 48

DRAG DROP - (Topic 3)

A company plans to display support call metrics on a screen that is visible to all call center staff.

You need to recommend solutions to meet the company's requirements.

What should you recommend? To answer, drag the appropriate components to the correct requirements. Each component may be used once, more than once, or not at all. You may need to drag the split bar between panes or scroll to view content.

NOTE: Each correct selection is worth one point.

Components	Requirement	Component
Tile	Display a chart with incoming calls versus wait time and pin the chart to a dashboard.	Component
Template App		Component
Treemap		Component
Page	Send a specific user a notification when the number of customer support calls waiting is over 20.	
Theme	Display metrics from different datasets that have related data.	
Alert		
DirectQuery		
Workspace		

- A. Mastered
- B. Not Mastered

Answer: A

Explanation:

Components	Requirement	Component
Tile	Display a chart with incoming calls versus wait time and pin the chart to a dashboard.	Tile
Template App		Alert
Treemap		DirectQuery
Page	Send a specific user a notification when the number of customer support calls waiting is over 20.	
Theme	Display metrics from different datasets that have related data.	
Alert		
DirectQuery		
Workspace		

NEW QUESTION 50

- (Topic 3)

You are a district manager for a large retail organization. You train each store manager to use Power BI to track sales and daily sales targets.

A store manager remembers learning about the Analyze in Excel option but cannot find the option in their Power BI dashboard.

You need to help the user resolve the issue. How should you advise the user?

- A. Install the Power BI Desktop app.
- B. Navigate to the report used by the dashboard.
- C. Select the Spotlight button on the dashboard tile.
- D. Subscribe to the dashboard and follow the email link.

Answer: B

Explanation:

Reference:

<https://docs.microsoft.com/en-us/power-bi/collaborate-share/service-analyze-in-excel>

NEW QUESTION 54

- (Topic 3)

You are creating visuals in Power BI.

You create area charts, pie charts, and donut charts that use your company's data. You need to display the charts to others at the company.

Which two objects can you add the charts to? Each correct answer presents a complete solution.

NOTE: Each correct selection is worth one point.

- A. Power BI service
- B. Power BI reports
- C. Power BI desktop
- D. Power BI dashboards

Answer: BD

Explanation:

Reference:

<https://docs.microsoft.com/en-us/power-bi/visuals/power-bi-visualization-types-for-reports-and-q-and-a>

NEW QUESTION 56

HOTSPOT - (Topic 3)

You are a regional sales manager for a large internet retailer. You create a series of Power BI reports and dashboards to help sales associates be more productive and increase sales.

Sales are not increasing as expected.

You need to determine if the new reports are being used and send emails to sales associates to provide guidance on how to use the reports and dashboards.

Which features should you use? To answer, select the appropriate options in the answer area.

NOTE: Each correct selection is worth one point.

Requirement

Send an email to the sales associates on a predetermined schedule.

	▼
Subscribe	
Share	
Favorites	
Publisher	

Quantify the adoption usage from the sales associates.

	▼
Explore	
Favorites	
Usage metrics	
Performance inspector	

- A. Mastered
- B. Not Mastered

Answer: A

Explanation:

Requirement

Send an email to the sales associates on a predetermined schedule.

	▼
Subscribe	
Share	
Favorites	
Publisher	

Quantify the adoption usage from the sales associates.

	▼
Explore	
Favorites	
Usage metrics	
Performance inspector	

NEW QUESTION 57

DRAG DROP - (Topic 3)

A company uses Microsoft Excel workbooks to store consolidated sales data. Workbooks are stored on OneDrive for Business.

Match each Power BI feature to its requirement. To answer, drag the appropriate features from the column on the left to its requirement on the right. Each option may be used once, more than once, or not at all.

NOTE: Each correct match is worth one point.

Features

Q&A

Mobile apps

Export to Excel

Get data from files

Answer Area

Requirement

Enable user-friendly reporting on phones.

Use natural language to query and aggregate data.

Feature

Feature

- A. Mastered
- B. Not Mastered

Answer: A

Explanation:

Features

Q&A

Mobile apps

Export to Excel

Get data from files

Answer Area

Requirement

Enable user-friendly reporting on phones.

Use natural language to query and aggregate data.

Feature

Mobile apps

Q&A

NEW QUESTION 60

DRAG DROP - (Topic 3)

A company plans to create an information portal that managers can use to view critical information about their teams. You need to recommend the type of Power BI components that the company should use. What should you recommend? To answer, drag the appropriate components to the correct requirements. Each component may be used once, more than once, or not at all. You may need to drag the split bar between panes or scroll to view content. NOTE. Each correct selection is worth one point.

Component types

Dashboard

Report

Answer Area

Requirement

Display data from a Microsoft Excel workbook that has multiple worksheets into one chart.

Display the top departmental goal metrics and alert users when specific thresholds targets are met.

Display Sales charts that can be filtered by region.

Component type

Component type

Component type

- A. Mastered
- B. Not Mastered

Answer: A

Explanation:

Box 1: Report
Reports are more detailed data displayed in many formats like chart, graphs list and in tabular, etc.
Box 2: Dashboard
Dashboards are a business key performance indicator view where it displays key values that can change business profits and can be glanced at one screen.
Box 3: Report
Power BI dashboards cannot slice and dice, but reports have many ways to filter and slice.
Note: Power BI dashboards are one placeholder to display the most important decision- making facts to run a business. But reports are more detailed data displayed in many formats like chart, graphs list and in tabular, etc. Reports are based on one dataset or one business unit data for example reports of a store belonging to California.

NEW QUESTION 65

HOTSPOT - (Topic 3)

You have a Power BI report.
For each of the following statements, select Yes if the statement is true. Otherwise, select No.
NOTE: Each correct selection is worth one point.

Statement	Yes	No
You can export data from a visualization in a Power BI report.	<input type="radio"/>	<input type="radio"/>
You can show the data behind a visual report on your screen without exporting the data.	<input type="radio"/>	<input type="radio"/>
You must export data to view supporting data for a KPI.	<input type="radio"/>	<input type="radio"/>

- A. Mastered
- B. Not Mastered

Answer: A

Explanation:

Box 1: Yes

If you'd like to see the data that Power BI uses to create a visualization, you can display that data in Power BI. You can also export that data to Excel as an .xlsx or .csv file. The option to export the data requires a Pro or Premium license and edit permissions to the dataset and report.

Note: Export data from a Power BI dashboard

? Select the ellipsis in the upper-right corner of the visualization.

? Choose the Export data icon.

? Power BI exports the data to a .csv file. If you've filtered the visualization, then the app will filter the downloaded data.

? Your browser will prompt you to save the file. Once saved, open the .csv file in Excel.

Box 2: No

Underlying data: Select this option if you want to see the data in the visual and additional data from the model (see chart below for details). If your visualization has an aggregate, selecting Underlying data removes the aggregate. When you select Export, Power BI exports the data to an .xlsx file and your browser prompts you to save the file. Once saved, open the file in Excel.

Box 3: Yes

A KPI dataset needs to contain goal values for a KPI. If your dataset doesn't contain goal values, you can create them by adding an Excel sheet with goals to your data model or PBIX file.

Note: A Key Performance Indicator (KPI) is a visual cue that communicates the amount of progress made toward a measurable goal.

NEW QUESTION 70

DRAG DROP - (Topic 4)

You are creating a model-driven app to track requests for quotes. The app must use the following navigation structure:

Sales

? Sales Log

? Request for Quotes

? Projects

? Settings

? Customers

? Product Lines

? Sales Territories Administration

? User Admin

? Users

? Roles

You need to create the app navigation.

Which sitemap component types should you use? To answer, drag the appropriate component types to the correct navigation elements. Each component type may be used once, more than once, or not at all. You may need to drag the split bar between panes or scroll to view content.

NOTE: Each correct selection is worth one point.

Component types

Area

Group

Subarea

Answer Area

Navigation element	Component type
Administration	Component type
Sales log	Component type
Customers	Component type

- A. Mastered
- B. Not Mastered

Answer: A

Explanation:

Component types

Area

Group

Subarea

Answer Area

Navigation element	Component type
Administration	Group
Sales log	Subarea
Customers	Subarea

NEW QUESTION 73

HOTSPOT - (Topic 4)

You create a canvas app by using the Generate from data feature. The app connects to a Microsoft SharePoint list.

For each of the following statements, select Yes if the statement is true. Otherwise, select No.

NOTE: Each correct selection is worth one point.

Statement	Yes	No
A screen is generated that contains a browsable list of SharePoint list items.	<input type="radio"/>	<input type="radio"/>
A screen is generated that allows users to update SharePoint list items.	<input type="radio"/>	<input type="radio"/>

- A. Mastered
- B. Not Mastered

Answer: A

Explanation:

Statement	Yes	No
A screen is generated that contains a browsable list of SharePoint list items.	<input checked="" type="radio"/>	<input type="radio"/>
A screen is generated that allows users to update SharePoint list items.	<input checked="" type="radio"/>	<input type="radio"/>

NEW QUESTION 77

- (Topic 4)

You have a Microsoft Excel workbook that contains a list of tasks for a project. You store the file in OneDrive for Business.

You need to create a canvas app that allows team members to update the status of their tasks.

What should you use?

- A. the Generate an app from data feature
- B. a custom action in Common Data Service
- C. Power Apps Checker
- D. the Open entity data in Excel feature

Answer: A

Explanation:

Reference:

<https://docs.microsoft.com/en-us/powerapps/maker/canvas-apps/add-data-connection>

NEW QUESTION 81

- (Topic 4)

You create a canvas app that allows contractors to submit time they work against a project.

Contractors must be able to use the canvas app to enter time. Contractors must not be able to perform any other actions in the app.

You need to configure permissions for the contractors. Which type of permissions should you use?

- A. application-level
- B. task-level
- C. record-level
- D. field-level

Answer: D

Explanation:

Field-level security feature to allow more granular control of security at the field level.

Reference:

<https://docs.microsoft.com/en-us/power-platform/admin/security-roles-privileges> <https://docs.microsoft.com/en-us/power-platform/admin/wp-security-cds>

NEW QUESTION 82

- (Topic 4)

A company has a Power Apps app that is used by most employees. The company is expanding to other

countries/regions.
You need to recommend a solution to translate text generated within the Power Apps in near real-time.
What should you recommend?

- A. Microsoft Azure Synapse Analytics
- B. Microsoft Azure Cognitive Services
- C. Common Data Service connector
- D. Power BI

Answer: B

Explanation:

Reference:
https://docs.microsoft.com/en-gb/azure/cognitive-services/welcome?ocid=AID2339762_TWITTER_oo_spl100000827964250
<https://powerapps.microsoft.com/en-us/blog/cognitive-services-with-powerapps-using- custom-connectors/>

NEW QUESTION 83

HOTSPOT - (Topic 4)
A company publishes e-books for independent authors.
The company wants to implement a Power Apps portal solution to make announcements about upcoming books to the general public.
You need to recommend features for the company.
Which features should you use? To answer, select the appropriate options in the answer area.
NOTE: Each correct selection is worth one point.

Requirement	
Ensure that book authors can securely access their data.	<div>Authenticate external users.</div> <div>Access data in Common Data Service.</div> <div>Use page templates.</div> <div>Browse content anonymously.</div>
Ensure consistent page design across the website.	<div>Authenticate external users.</div> <div>Access data in Common Data Service.</div> <div>Use page templates.</div> <div>Browse content anonymously.</div>
Ensure that the public can access announcements about upcoming	<div>Authenticate external users.</div> <div>Use page templates.</div> <div>Browse content anonymously.</div>

- A. Mastered
- B. Not Mastered

Answer: A

Explanation:

Requirement	
Ensure that book authors can securely access their data.	<div>Authenticate external users.</div> <div>Access data in Common Data Service.</div> <div>Use page templates.</div> <div>Browse content anonymously.</div>
Ensure consistent page design across the website.	<div>Authenticate external users.</div> <div>Access data in Common Data Service.</div> <div>Use page templates.</div> <div>Browse content anonymously.</div>
Ensure that the public can access announcements about upcoming	<div>Authenticate external users.</div> <div>Use page templates.</div> <div>Browse content anonymously.</div>

NEW QUESTION 85

HOTSPOT - (Topic 4)
You are designing a Power Apps solution that allows users to upload a status report directly to the company Microsoft SharePoint project management site from their mobile device.
For each of the following statements, select Yes if the statement is true. Otherwise, select No.
NOTE: Each correct selection is worth one point.

Statement	Yes	No
You should build a model-driven app in Power Apps.	<input type="radio"/>	<input type="radio"/>
You should build a canvas app in Power Apps.	<input type="radio"/>	<input type="radio"/>
Users must download and run the Power Apps mobile application to use the solution.	<input type="radio"/>	<input type="radio"/>

A. Mastered
B. Not Mastered

Answer: A

Explanation:
Box 1: No
Box 2: Yes
Box 3: Yes
When you create an app, or someone shares an app with you, you can run that app on Windows, iOS, Android, or in a web browser.
References:
<https://docs.microsoft.com/en-us/powerapps/maker/canvas-apps/app-from-sharepoint> <https://docs.microsoft.com/en-us/powerapps/user/run-app-client>

NEW QUESTION 86

- (Topic 4)
You create a Power Apps canvas app.
You need to ensure that your coworkers can run the app. What should you do?

- A. Share the app.
- B. Send the URL for the app to coworkers.
- C. Add a license for the app.
- D. Create a Flow for the app.

Answer: A

Explanation:
Reference:
<https://docs.microsoft.com/en-us/powerapps/maker/canvas-apps/share-app>

NEW QUESTION 88

- (Topic 4)
A company is considering implementing Power Platform.
For which three scenarios should you consider implementing Power Apps portals? Each correct answer presents a complete solution.
NOTE: Each correct selection is worth one point.

- A. a customer support website that includes knowledge search and support for document uploads
- B. a public website that supports multi-lingual communities with forums and blogs support
- C. an online store with e-commerce requirements including payment processing
- D. a secure website for vendors accessing data stored in Common Data Service
- E. an internal website for employees to access selected data from Dynamics 365 Finance

Answer: ABE

Explanation:
Reference:
<https://docs.microsoft.com/en-us/powerapps/maker/portals/portal-templates>

NEW QUESTION 89

HOTSPOT - (Topic 4)
A company plans to build Power Apps portals.
For each of the following statements, select Yes if the statement is true. Otherwise, select No.
NOTE: Each correct selection is worth one point.

Statement	Yes	No
You must use standard templates for building portals.	<input type="radio"/>	<input type="radio"/>
You can test portals in non-prodcution environments and then migrate the portals into production environments.	<input type="radio"/>	<input type="radio"/>
When transitioning to the new version of a portal, you can display a customizable maintenance page until the new portal is ready to be used.	<input type="radio"/>	<input type="radio"/>

- A. Mastered
B. Not Mastered

Answer: A

Explanation:

Statement	Yes	No
You must use standard templates for building portals.	<input checked="" type="radio"/>	<input type="radio"/>
You can test portals in non-prodcution environments and then migrate the portals into production environments.	<input checked="" type="radio"/>	<input type="radio"/>
When transitioning to the new version of a portal, you can display a customizable maintenance page until the new portal is ready to be used.	<input checked="" type="radio"/>	<input type="radio"/>

NEW QUESTION 94

- (Topic 4)

A company plans to create a canvas app that connects to three databases with different proprietary database formats. What is the minimum number of connectors required?

- A. 1
B. 2
C. 3

Answer: B

Explanation:

Reference:

<https://docs.microsoft.com/en-us/powerapps/maker/canvas-apps/working-with-data-sources>

NEW QUESTION 99

DRAG DROP - (Topic 4)

A company plans to create canvas apps.

What is the minimum number of connectors required? To answer, drag the appropriate number of connectors to the correct drop scenarios. Each number of connectors may be used once, more than once, or not at all. You may need to drag the split bar between panes or scroll to view content.

NOTE: Each correct selection is worth one point.

Number of connectors	Answer Area	Number of connectors
0	Scenario	
1	Synchronize data with three data sources that use different proprietary database formats.	
2	Create three Power Apps apps that each display data from a Microsoft SharePoint list.	
3	Create three Flows that each copy data to Microsoft Azure Data Lake on different schedules.	

- A. Mastered

B. Not Mastered

Answer: A

Explanation:

Number of connectors	Answer Area	Number of connectors
0		
1	Synchronize data with three data sources that use different proprietary database formats.	1
2	Create three Power Apps apps that each display data from a Microsoft SharePoint list.	3
3	Create three Flows that each copy data to Microsoft Azure Data Lake on different schedules.	3

NEW QUESTION 104

- (Topic 5)

You are new to working with Microsoft Flow. You create a flow that extracts birth dates for users and then sends a birthday greeting email to users on their birthday. The flow does not properly extract birth dates. Where should you make changes?

- A. Connectors
- B. Expression
- C. Templates

Answer: A

Explanation:

Select the new Date Time connector. There you will see all of the actions, which help you to convert time zones to format them for local time in an email, add or subtract times, or just get the current time.

Reference:

<https://flow.microsoft.com/en-us/blog/nested-apply-to-each/>

NEW QUESTION 108

- (Topic 5)

A company performs on-site inspections and services for air industrial equipment.

Field technicians must perform a series of maintenance checks every time they visit a customer site. Every technician performs maintenance tasks in a different order. Some technicians miss steps. You need to ensure that all technicians perform the same steps in the same order.

What should you use?

- A. Business process flow
- B. AI Builder
- C. Business rule
- D. Virtual Agent

Answer: A

Explanation:

You can help ensure that people enter data consistently and follow the same steps every time they work with a customer by creating a business process flow. For example, you might want to create a business process flow to have everyone handle customer service requests the same way, or to require that people get approval for an invoice before submitting an order. Business process flows use the same underlying technology as other processes, but the capabilities that they provide are very different from other features that use processes.

Reference:

<https://docs.microsoft.com/en-us/power-automate/business-process-flows-overview>

NEW QUESTION 113

HOTSPOT - (Topic 5)

A company plans to synchronize data between Dynamics 365 Supply Chain management and Dynamics 365 Sales.

For each of the following statements, select Yes if the statement is true. Otherwise, select No.

NOTE: Each correct selection is worth one point.

Statement	Yes	No
You can implement a process-based integration by using the Data Integration feature.	<input type="radio"/>	<input type="radio"/>
You can use Microsoft Azure Data Migration to synchronize data between the apps.	<input type="radio"/>	<input type="radio"/>

- A. Mastered
B. Not Mastered

Answer: A

Explanation:

Statement	Yes	No
You can implement a process-based integration by using the Data Integration feature.	<input checked="" type="radio"/>	<input type="radio"/>
You can use Microsoft Azure Data Migration to synchronize data between the apps.	<input type="radio"/>	<input checked="" type="radio"/>

NEW QUESTION 116

HOTSPOT - (Topic 5)

A company is using Power Automation to automate business processes. You need to recommend triggers for Instant flows. What trigger types should you recommend? To answer, select the appropriate options in the answer area.

NOTE: Each correct selection is worth one point.

Requirement	Trigger type
Run a flow when the user presses a button in a canvas app.	<div>▼</div> <div>PowerApps for a selected row</div> <div>manually trigger a flow</div> <div>for a selected file (OneDrive for a Business)</div>
Run a flow when user presses a button in the mobile Flow app.	<div>▼</div> <div>PowerApps for a selected row</div> <div>manually trigger a flow</div> <div>for a selected file (SharePoint)</div>

- A. Mastered
B. Not Mastered

Answer: A

Explanation:

Requirement	Trigger type
Run a flow when the user presses a button in a canvas app.	<div>▼</div> <div>PowerApps for a selected row</div> <div>manually trigger a flow</div> <div>for a selected file (OneDrive for a Business)</div>
Run a flow when user presses a button in the mobile Flow app.	<div>▼</div> <div>PowerApps for a selected row</div> <div>manually trigger a flow</div> <div>for a selected file (SharePoint)</div>

NEW QUESTION 119

HOTSPOT - (Topic 5)

You are creating a number of Power Automate flows.

You need to select the triggers for the flows.

Which flow types should you use? To answer, select the appropriate options in the answer area.

NOTE: Each correct selection is worth one point.

Answer Area

Requirement	Flow type
Trigger a flow when a button is selected.	<div><div></div><div>UI Flow Automatic Business Process Flow Instant</div></div>
Trigger a flow when a record is created.	<div><div></div><div>UI Flow Automatic Business Process Flow Instant</div></div>
Guide a user through a series of steps in a model-driven app.	<div><div></div><div>UI Flow Automatic Business Process Flow Instant</div></div>

- A. Mastered
- B. Not Mastered

Answer: A

Explanation:

Answer Area

Requirement	Flow type
Trigger a flow when a button is selected.	<div><div></div><div>UI Flow Automatic Business Process Flow Instant</div></div>
Trigger a flow when a record is created.	<div><div></div><div>UI Flow Automatic Business Process Flow Instant</div></div>
Guide a user through a series of steps in a model-driven app.	<div><div></div><div>UI Flow Automatic Business Process Flow Instant</div></div>

NEW QUESTION 121

HOTSPOT - (Topic 5)

You are learning about Power Apps and how to use triggers.
Which objects should you use? To answer, select the appropriate options in the answer area.
NOTE: Each correct selection is worth one point.

Answer Area

Statement	Component
A Power Apps app can trigger this when a condition is met.	<div><div>connector</div><div>Power Automate flow</div><div>gateway</div><div>solution</div></div>
Actions and triggers are properties of a	<div><div>connector</div><div>gateway</div><div>solution</div></div>

- A. Mastered
- B. Not Mastered

Answer: A

Explanation:
Answer Area

Statement	Component
A Power Apps app can trigger this when a condition is met.	<div>connector</div> <div>Power Automate flow</div> <div>gateway</div> <div>solution</div>
Actions and triggers are properties of a	<div>connector</div> <div>gateway</div> <div>solution</div>

NEW QUESTION 122

HOTSPOT - (Topic 5)

A company uses a third party application and an approval process via email. At the end of the month, the IT department enters the data into Microsoft Excel to create pivot charts.

The Excel pivot charts must use the same data source as Dynamics 365 Field Service to generate charts and reports.

You need to recommend a solution.

What should you recommend? To answer, select the appropriate configuration in the answer area.

NOTE: Each correct selection is worth one point.

Requirement	Solution
Create an approval workflow.	<div>Dynamics 365 Workflow Notifications</div> <div>Microsoft Outlook Integration</div> <div>AI Builder</div> <div>Microsoft Flow</div>
Connect to report data.	<div>Common Data Service and Power BI</div> <div>Third-party from AppSource</div> <div>Custom Code flat file integration</div> <div>Dynamics 365 Field Service</div>

- A. Mastered
- B. Not Mastered

Answer: A

Explanation:

Box 1: Dynamics 365 Workflow notifications

You can configure the system to send email messages to users when workflow-related events occur.

Note:

? Go to Navigation pane > Modules > System administration > Users > Users.

? In the list, find and select the desired record.

? On the Action pane, click User options.

? Click the Workflow tab. Make sure that the Notifications section is expanded. In the Notifications section, you can specify how you want the user to be notified about workflow-related events.

Box 2: Dynamics 365 Field Service

Supply Chain Management enables synchronization of business processes between Dynamics 365 Supply Chain Management and Dynamics 365 Field Service.

The integration scenarios are configured by using extensible Data integrator templates and Common Data Service to enable the synchronization of business processes. Standard templates can be used to create custom integration projects, where additional standard and custom fields and entities can be mapped to adjust the integration and meet specific business needs.

NEW QUESTION 127

- (Topic 5)

A company uses Dynamics 365 Sales. Every time an opportunity is created, a Power Automate flow runs to email the opportunity to the sales manager.

The sales manager leaves the company. You disable all accounts for the sales manager.

You need to ensure that the new sales manager automatically receives email about opportunities when they are created.

What should you do?

- A. Modify the flow and ensure that the correct manager's email is listed in the From field.
- B. Modify the flow and ensure that the correct manager's email is listed in the To field.
- C. Grant the new sales manager access to the departed sales manager's inbox.
- D. Modify the flow and ensure that the flow prompts the user to type the correct email for the To field.
- E. Create a flow that automatically forwards opportunity emails to the new sales manager.

Answer: B

Explanation:

Reference:

<https://www.inogic.com/blog/2020/09/power-automate-send-an-email-using-the-email-template-part-1/>

NEW QUESTION 131

DRAG DROP - (Topic 5)

A company plans to use Microsoft Flow to automate tasks.

Match each flow type to its function. To answer, drag the appropriate flow type from the column on the left to its description on the right. Each option may be used once, more than once, or not at all.

NOTE: Each correct match is worth one point.

Flow types	Answer Area	Flow type
automated		Flow type
business process	a flow that runs after it is triggered by an event	Flow type
scheduled	a flow that guides a user through a set of tasks	Flow type
instant	a flow that runs after a specified number of days	Flow type
	a flow that allows you to start tasks on-demand	Flow type

- A. Mastered
- B. Not Mastered

Answer: A

Explanation:

Box 1: automated

Automated flows start with an event or trigger, such as an email being received. These also support a multitude of actions in the 200+ Flow connectors.

Box 2: business process

The business process flow that creates stages or screens that enforce a certain sequence of steps. It collects data from users for each step in the stage and can kick off automated workflows.

Box 3: scheduled

Scheduled flows run regular reports that are sent out to a team and summarize everything that's happened in the past week. This includes everything from simple daily scheduling to more complex scheduling like "every 3rd Monday."

Box 4: instant

An instant flow is triggered when you click a button inside of the Flow mobile app, SharePoint, Dynamics, PowerApps, or Excel that passes context directly into your flow.

Note: There are four different Flow types that you can choose from when starting out. You can create a scheduled flow, automated flow, instant flow, or a business process flow.

NEW QUESTION 136

- (Topic 5)

A company uses Dynamics 365 Supply Chain Management and Dynamics 365 Finance. User account data must be synchronized between the two system.

You need to ensure that the synchronized data is stored in one place. What should you use?

- A. SQLServer
- B. Common Data Service
- C. Azure Active Directory
- D. Azure IoT Central

Answer: B

Explanation:

Reference:

<https://docs.microsoft.com/en-us/power-platform/admin/data-integrator>

NEW QUESTION 140

HOTSPOT - (Topic 5)

A company plans to create a workflow that periodically runs a Dynamics 365 action based on data in third-party cloud-based solutions.

Which features should you use to create the workflow? To answer, select the appropriate options in the answer area.

NOTE: Each correct selection is worth one point.

Action	Component
Ensure that Power Automate can interact with the third-party application.	<div> <div></div> <div> Triggers Logic Apps Connectors Gateways </div> </div>
Periodically check for data changes in the third-party application.	<div> <div></div> <div> Actions Triggers Connectors DirectQuery </div> </div>

- A. Mastered
B. Not Mastered

Answer: A

Explanation:

Action	Component
Ensure that Power Automate can interact with the third-party application.	<div> <div></div> <div> Triggers Logic Apps Connectors Gateways </div> </div>
Periodically check for data changes in the third-party application.	<div> <div></div> <div> Actions Triggers Connectors DirectQuery </div> </div>

NEW QUESTION 142

- (Topic 5)

A company uses Power Automate.

Which three items can trigger flows? Each correct answer presents a complete solution. NOTE: Each correct selection is worth one point.

- A. Lifecycle Services
B. Microsoft 365 Admin center
C. Common Data Service
D. Microsoft Outlook 365
E. Microsoft Windows Desktop

Answer: ACD

Explanation:

<https://docs.microsoft.com/en-us/power-automate/email-triggers> <https://docs.microsoft.com/en-us/power-automate/connection-cds>
<https://dynamics365.wordpress.com/category/powerapps/>

NEW QUESTION 147

- (Topic 5)

You have Power Automate Flow to create a flow that automatically sends email to a project manager when project team members mark a task as complete. Project team members are prematurely marking tasks as complete. You must add quality control into the process by sending an email to a project lead for confirmation that the task is in fact complete before sending the email to the project manager.

You need to modify the flow. Which component should you use?

- A. a process argument
B. a condition
C. an expression
D. a trigger
E. an action

Answer: B

Explanation:

Use a condition and set the action to send an email.

Reference:

<https://docs.microsoft.com/en-us/power-automate/add-condition>

NEW QUESTION 150

HOTSPOT - (Topic 5)

A software company plans to use Power Automate.

For each of the following statements, select Yes if the statement is true. Otherwise, select No.

NOTE: Each correct selection is worth one point.

Statement	Yes	No
You must certify custom connectors before users in other departments within your organization can use the connectors.	<input type="radio"/>	<input type="radio"/>
You must use Microsoft Azure API apps to create a public custom connector.	<input type="radio"/>	<input type="radio"/>

A. Mastered

B. Not Mastered

Answer: A

Explanation:

Statement	Yes	No
You must certify custom connectors before users in other departments within your organization can use the connectors.	<input type="radio"/>	<input checked="" type="radio"/>
You must use Microsoft Azure API apps to create a public custom connector.	<input checked="" type="radio"/>	<input type="radio"/>

NEW QUESTION 153

- (Topic 5)

A company uses Microsoft 365, SharePoint Online, and Dynamics 365 Sales.

You need to recommend tools to build a solution that meets the following requirements:

* Synchronize data from an external Microsoft SQL Server instance.

* Send out of the box report automatically to specific company executives.

* Ensure that opportunities over a specified amount are approved by a sales manager. Which two tools or components should you recommend? Each correct answer presents part of the solution.

NOTE: Each correct selection is worth one point.

A. Microsoft Excel

B. Microsoft Word

C. Power Automate

D. Microsoft DataService

E. Power BI

Answer: CD

Explanation:

Reference:

<https://docs.microsoft.com/en-us/power-platform/admin/data-integrator> <https://www.powerobjects.com/blog/2019/04/05/flow-approval-process/>

NEW QUESTION 154

- (Topic 5)

A company uses Dynamics 365 Supply Chain Management.

When a sales order is created for one of the customers that a specific user manages, a Microsoft Outlook task must be created to remind the user to perform any follow up activities that are required.

You need to implement the functionality to create Outlook tasks.

Which two features should you use? Each correct answer presents part of the solution. NOTE: Each correct selection is worth one point.

A. AI Builder

B. Power Apps

C. Business Events

D. Microsoft Flow

E. Common Data Service

Answer: C

Explanation:

Business events in Microsoft Power Automate
Business events can be consumed in Microsoft Power Automate via the application connector. The connector has a trigger that is named when a business event occurs. This trigger can be used to subscribe to any of the business events that are available in the target instance of the application.
Reference:
<https://docs.microsoft.com/en-us/dynamics365/fin-ops-core/dev-itpro/business-events/business-events-flow>

NEW QUESTION 156

- (Topic 5)
A company uses Dynamics 365 Supply Chain Management.
You need to use Microsoft Flow to automate the process of receiving and tracking raw materials.
Which type of connector should you use?

- A. Common Data Service
- B. Dynamics 365
- C. Dynamics 365 for Fin & Ops
- D. Dynamic Signal

Answer: A

Explanation:

Dynamics 365 for Finance and Operations is now being licensed as Dynamics 365 Finance and Dynamics 365 Supply Chain Management.
You can use Common Data Service to enable the flow of data between Finance and Operations apps and Dynamics 365 Sales.
Reference:
<https://docs.microsoft.com/en-us/dynamics365/fin-ops-core/dev-itpro/data-entities/data-integration-cds>

NEW QUESTION 160

DRAG DROP - (Topic 5)
You need to build a Power Virtual Agents chatbot for a company.
Which components should you use? To answer, drag the appropriate components to the correct requirements. Each component may be used once, more than once, or not at all. You may need to drag the split bar between panes or scroll to view content.
NOTE: Each correct selection is worth one point.

Components

Entity

Variable

Trigger Phrase

Answer Area

Requirement

Identify keywords or questions and relate them to issues.

Store a response that a user enters for later use.

Identify a specific type of information from a user response.

Component

Component

Component

- A. Mastered
- B. Not Mastered

Answer: A

Explanation:

Components

Entity

Variable

Trigger Phrase

Answer Area

Requirement

Identify keywords or questions and relate them to issues.

Store a response that a user enters for later use.

Identify a specific type of information from a user response.

Component

Trigger Phrase

Variable

Entity

NEW QUESTION 165

HOTSPOT - (Topic 6)
You create a Power Virtual Agents chatbot for use with Microsoft Teams. You are testing the chatbot.
Testers report the following issues:
? Changes that you make to the chatbot are not seen by testers.
? When users enter the word refund the chatbot must ask the user the product for which they would like a refund. The chatbot does not ask the user for product information.
You need to determine what needs to be done to fix the issues.
What should you do? To answer, select the appropriate options in the answer area.
NOTE: Each correct selection is worth one point.

Missing changes

▼

Create a new chatbot.

Publish the chatbot.

Save the topic.

Share the chatbot.

Refund responses are not working as expected.

▼

Change security.

Create a refund topic.

Create a refund chatbot.

- A. Mastered
- B. Not Mastered

Answer: A

Explanation:

Missing changes

▼

Create a new chatbot.

Publish the chatbot.

Save the topic.

Share the chatbot.

Refund responses are not working as expected.

▼

Change security.

Create a refund topic.

Create a refund chatbot.

NEW QUESTION 166

- (Topic 6)

You are planning to allow members of your team to test your chatbot. You must ensure this is done in a secure way.

A team member named User1 must test the chatbot. You need to ensure that User1 can complete testing. What should you do?

- A. Sign in to the authoring environment as the chatbot author.
- B. Sign in to Microsoft Azure DevOps as the chatbot author.
- C. Sign in to Microsoft Azure DevOps as User1.
- D. Sign in to the authoring environment as User1.

Answer: A

NEW QUESTION 170

- (Topic 6)

A company is building an interactive chatbot to answer questions about product and product warranties.

You need to create conversation paths for questions about product warranties. Which tool should you use?

- A. Authoring canvas
- B. Azure Bot Framework
- C. Power Platform admin center
- D. Power Virtual Agents portal
- E. Conversation node

Answer: D

Explanation:

Reference:

<https://docs.microsoft.com/en-us/power-virtual-agents/authoring-create-edit-topics>

NEW QUESTION 174

DRAG DROP - (Topic 7)

You create a Power BI dashboard.

Match each option to its requirement. To answer, drag the appropriate option from the column on the left to the correct requirement on the right. Each option may be used once, more than once, or not at all.

NOTE: Each correct match is worth one point.

Options	Requirement	Option
Share	Ensure that coworkers can see the dashboard.	Option
Embed	Display data from Microsoft Excel in the dashboard.	Option
Get Data	Add a report tile to the dashboard.	Option
Pin		

- A. Mastered
- B. Not Mastered

Answer: A

Explanation:

Options	Requirement	Option
Share	Ensure that coworkers can see the dashboard.	Share
Embed	Display data from Microsoft Excel in the dashboard.	Get Data
Get Data	Add a report tile to the dashboard.	Pin
Pin		

NEW QUESTION 178

HOTSPOT - (Topic 7)

You are building Power BI visualizations for a team.

For each of the following statements, select Yes if the statement is true. Otherwise, select No.

NOTE: Each correct selection is worth one point.

Statements	Yes	No
Power BI can only retrieve data from up to two different sources for each dashboard.	<input type="radio"/>	<input type="radio"/>
Power BI visualizations can be used in canvas apps and model driven apps.	<input type="radio"/>	<input type="radio"/>
Power BI can display charts and list boxes on dashboards.	<input type="radio"/>	<input type="radio"/>

- A. Mastered
- B. Not Mastered

Answer: A

Explanation:

Statements	Yes	No
Power BI can only retrieve data from up to two different sources for each dashboard.	<input type="radio"/>	<input type="radio"/>
Power BI visualizations can be used in canvas apps and model driven apps.	<input type="radio"/>	<input type="radio"/>
Power BI can display charts and list boxes on dashboards.	<input type="radio"/>	<input type="radio"/>

NEW QUESTION 183

- (Topic 7)

A company has an online store to sell toys. The volume of order tracking requests has increased.

You need to allow customers to use an interactive interface on the website to request order tracking Information.

Which technology should you use?

- A. Customer Service Insights
- B. Power BI
- C. Power Virtual Agents chatbots
- D. Power Automate flows

Answer: A

NEW QUESTION 188

- (Topic 7)

A company currently does not separate testing, development, and production as per standard Application Lifecycle Management (ALM) protocol. The company uses Power for accounting and sales processes.

The company needs login only one login account per user. The company also must prevent developing and testing from impacting production.

You need to implement a solution to meet the requirements. Which method should you select?

- A. separate Microsoft Azure Storage Blobs
- B. separate connectors
- C. separate tenants
- D. separate environments

Answer: D

NEW QUESTION 193

- (Topic 7)

A company plans to move an on-premises customer service data management system to a cloud-managed solution.

The customer service application must be replaced by a model-driven application. The company uses Microsoft SQL Server Integration Services (SSIS) packages to move data from the on-premises database system to a third-party enterprise resource planning (ERP) system.

You need to replace the SSIS packages for data transfer.

What should the company use in place of the packages to move the data?

- A. Microsoft Azure Data Lake
- B. Power Virtual Agents
- C. Data Migration Framework
- D. Power Platform connector

Answer: C

NEW QUESTION 198

- (Topic 7)

You are implement Power Apps tor a company.

Data from an online proprietary accounting system must be automatically updated every four hours in Microsoft Dataverse without creating duplicates. Only changes to the data must be added. Thousands of recants are added per hour.

You need to set up the technology to ensure that the data is Integrated awry four hours. What should you do

- A. Create a custom connector.
- B. Create a Cloud flow that exports and imports the data.
- C. Export all data Azure Blob storage.

Answer: B

NEW QUESTION 201

HOTSPOT - (Topic 7)

An environmental agency creates tables named Specimen and Species in Microsoft Dataverse to record specimens that are collected on nature walks as well as their species. Some of the columns of the Specimen table are shown in the following image:

Power Apps							
Environment 18x36 (Default)							
Tables > Specimen > Columns							
Display name	Name	Data type	Managed	Customizable	Required	Searchable	
Created By	CreatedBy	Lookup	No	No	No	No	
Created By (Delegate)	CreatedBy_Delegate	Lookup	No	No	No	No	
Created On	CreatedOn	Date and time	No	No	No	No	
Import Sequence Number	ImportSequenceNumber	Whole number	No	No	No	No	
Modified By	ModifiedBy	Lookup	No	No	No	No	
Modified By (Delegate)	ModifiedBy_Delegate	Lookup	No	No	No	No	
Modified On	ModifiedOn	Date and time	No	No	No	No	
Name (Primary name column)	o2efc_Name	Single line of text	No	No	No	No	
Owner	OwnerId	Owner	No	No	No	No	
Owning Business Unit	OwningBusinessUnit	Lookup	No	No	No	No	
Owning Team	OwningTeam	Lookup	No	No	No	No	
Owning User	OwningUser	Lookup	No	No	No	No	
Record Created On	RecordCreatedOn	Date only	No	No	No	No	
Species	o2efc_Species	Lookup	No	No	No	No	
Specimen	o2efc_SpecimenId	Unique identifier	No	No	No	No	

For each of the following statements, select Yes if the statement is true. Otherwise, select No.

NOTE: Each correct selection is worth one point.

Answer Area

Statements	Yes	No
Many specimens can be associated with a given species.	<input type="radio"/>	<input type="radio"/>
The Specimen table is organization owned.	<input type="radio"/>	<input type="radio"/>
The Name column is the primary key of the Specimen table.	<input type="radio"/>	<input type="radio"/>

- A. Mastered
- B. Not Mastered

Answer: A

Explanation:

Answer Area

Statements	Yes	No
Many specimens can be associated with a given species.	<input checked="" type="radio"/>	<input type="radio"/>
The Specimen table is organization owned.	<input type="radio"/>	<input checked="" type="radio"/>
The Name column is the primary key of the Specimen table.	<input type="radio"/>	<input checked="" type="radio"/>

NEW QUESTION 203

HOTSPOT - (Topic 7)

You are authoring a Power Virtual Agents bot for a company that sells flowers and shrubs.

For each of the following statements, select Yes if the statement is true. Otherwise, select No.

NOTE: Each correct selection is worth one point.

Statement	Yes	No
You can use the prebuilt Postal Code entity to recommend plants that will work within a customer’s growing zone.	<input type="radio"/>	<input type="radio"/>
You can create a custom entity to offer color and plant choices for landscaping options that can be made available for customer orders.	<input type="radio"/>	<input type="radio"/>

- A. Mastered
- B. Not Mastered

Answer: A

Explanation:

Box 1: Yes

Chatbots built with Power Virtual Agents will understand and display content that's locally relevant to the user. Localized handling and formatting are based on the user's browser locale setting, and include the following elements within a chat conversation:

- ? Date and time
- ? Numbers
- ? ZIP or postal code
- ? Currency
- ? Speed

Box 2: Yes Custom entities:

The prebuilt entities cover commonly used information types, but on some occasions, such as when building a bot that serves a specific purpose, you'll need to teach the bot's language understanding model some domain-specific knowledge.

For instance, let's say you want to build a bot for an outdoor store. In this case, you'll need to teach the bot to acknowledge the "outdoor gears product" category in a dialog.

NEW QUESTION 207

DRAG DROP - (Topic 7)

Match each tool to its task. To answer, drag the appropriate tool from the column on the left to its task on the right. Each tool may be used once, more than once, or not at all.

NOTE: Each correct match is worth one point.

Tools	Task	Tool
Power BI	Automate workflows.	
Power Automate	Trigger an action from an event.	
Power Apps	Create a custom mobile data entry screen.	

- A. Mastered

B. Not Mastered

Answer: A

Explanation:

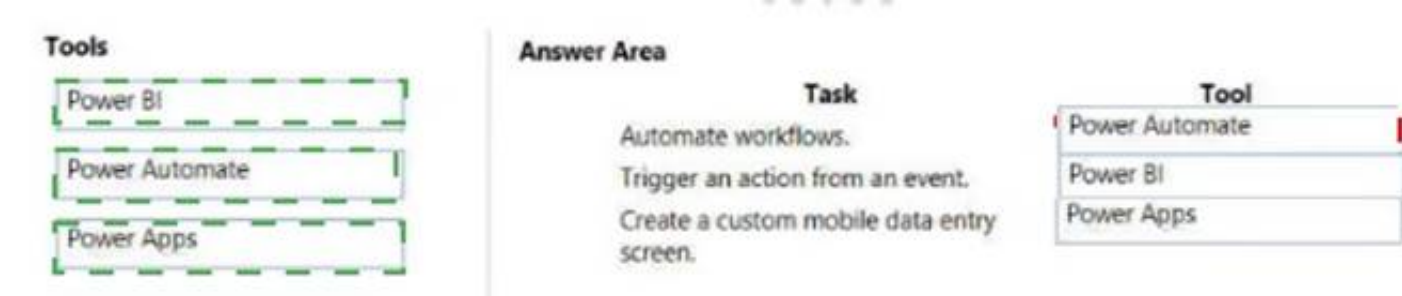

NEW QUESTION 208

- (Topic 7)

A company uses a model-driven app for their mobile sales activities.

The company wants to modify the view that is used for sales orders. You must apply a new default filter to the view. You must also modify the default sorting for sales orders.

You need to make the changes to the view.

In which three locations can you make the changes? Each correct answer presents a complete solution.

NOTE: Each correct selection is worth one point.

- A. Power Apps site
- B. Solution Explorer
- C. Microsoft Azure DevOps
- D. App Designer

Answer: ACD

Explanation:

You can edit or remove a filter condition through the Power Apps site. You can create and edit Analytics views in Azure DevOps.

An alternative to editing views in the tables is to edit views from the app designer.

Reference:

<https://docs.microsoft.com/en-us/powerapps/maker/model-driven-apps/create-edit-view-filters>

<https://docs.microsoft.com/en-us/azure/devops/report/powerbi/analytics-views-create> <https://docs.microsoft.com/en-us/powerapps/maker/model-driven-apps/create-edit-views-app-designer>

NEW QUESTION 212

- (Topic 7)

A company uses Microsoft Power Platform.

An administrator creates a new data loss prevention (DIP) policy.

You need to identify the Microsoft Power Platform components that must be updated to comply with the policy.

Which two types of components should you identify? Each correct answer presents a complete solution.

NOTE: Each correct selection is worth one point.

- A. Power Automate cloud flows
- B. Canvas apps
- C. Power BI reports
- D. Model-driven apps
- E. Power Pages websites

Answer: CE

NEW QUESTION 214

- (Topic 7)

A Power Apps developer has sufficient permissions to create apps, connections, and flows. The developer does not have permissions needed to access company data.

You need to grant the developer access to company data for an app. Which predefined security role should you assign to the developer?

- A. Basic User
- B. System Customizer
- C. Environment Maker
- D. Delegate

Answer: D

NEW QUESTION 217

- (Topic 7)

A company is creating a chatbot to replace a frequently asked questions (FAQ) site

You must perform step-by-step testing for all scenarios that are part of a complex user interaction that includes multiple topics. Testers must be able to see the workflow while interacting with the chatbot.

You need to test the chatbot. What should you do?

- A. Publish the chatbot and test it in the demo website.
- B. Use the chatbot designer to test the chatbot
- C. View analytics for a chatbot conversation.

D. Publish the chatbot and test it in any channel

Answer: B

Explanation:

Test and maintain chatbots through an incredibly easy-to-use graphical interface. Recognize and act on dozens of common entities in the user’s conversation such as colors, currencies, ages, dates and times, or create your own, and store user information in variables and use them to branch or create complex conversations.

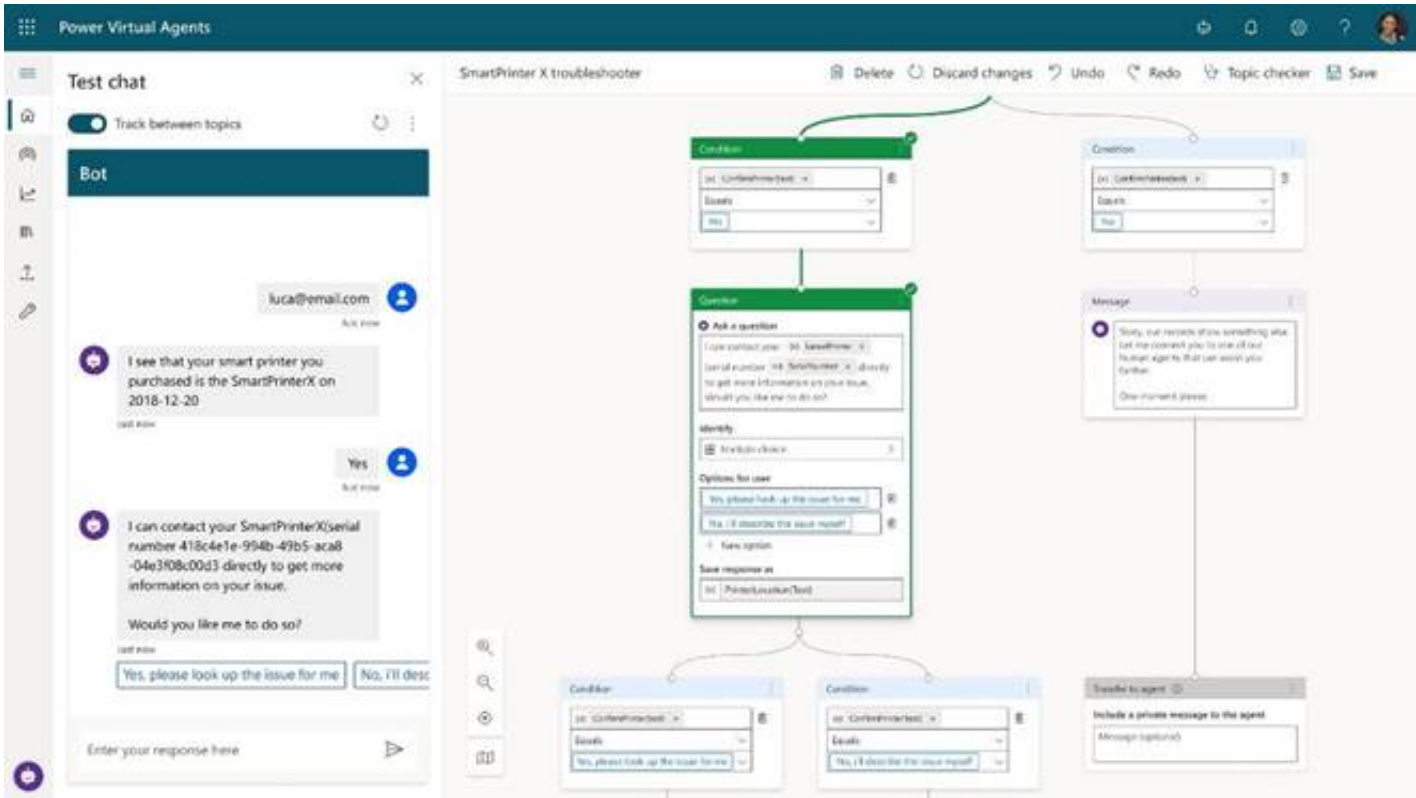

<https://powervirtualagentsblogcdn.azureedge.net/wp-content/uploads/2019/11/Tracking.png>

NEW QUESTION 220

- (Topic 7)

A company is using Power Virtual Agents with Dynamics 365 Customer Service. You create a new topic. The topic performs as expected during testing. Customers report that the new topic is not visible in the frequently asked questions section of the company s website. You need to ensure customers can see the new topic. What should you do?

- A. Analyze the chatbot
- B. Paste the link to the website
- C. Publish the topic.
- D. Create a new variable.
- E. Delete and recreate the topic.

Answer: C

NEW QUESTION 222

HOTSPOT - (Topic 7)

instructions: For each of the following statements, select Yes if the statement is true. Otherwise, select No.
NOTE: Each correct selection is worth one point.

Statements	Yes	No
A Microsoft Power Platform environment must contain a Microsoft Dataverse database.	<input type="radio"/>	<input type="radio"/>
An app created in an environment can only connect to the data sources that are deployed in the same environment.	<input type="radio"/>	<input type="radio"/>
Microsoft Dataverse for Teams environments are automatically created for all members of the team when you create a Microsoft Power Platform app in Microsoft Teams.	<input checked="" type="radio"/>	<input type="radio"/>

- A. Mastered
- B. Not Mastered

Answer: A

Explanation:

Statements	Yes	No
A Microsoft Power Platform environment must contain a Microsoft Dataverse database.	<input checked="" type="radio"/>	<input type="radio"/>
An app created in an environment can only connect to the data sources that are deployed in the same environment.	<input checked="" type="radio"/>	<input type="radio"/>
Microsoft Dataverse for Teams environments are automatically created for all members of the team when you create a Microsoft Power Platform app in Microsoft Teams.	<input checked="" type="radio"/>	<input type="radio"/>

NEW QUESTION 226

- (Topic 7)

You are using the Power BI service to view a visual on a report that has been shared with you. You need to add the visual to a dashboard as a tile. Which action should you perform?

- A. Copy
- B. Spotlight

- C. Export data
D. Pin

Answer: D

NEW QUESTION 227

HOTSPOT - (Topic 7)

Instructions: For each of the following statements, select Yes if the statement is true. Otherwise, select No. NOTE: Each correct selection is worth one point.

Answer Area

Statements	Yes	No
Stages are added under each step of a business process flow design.	<input type="radio"/>	<input type="radio"/>
Power Automate desktop flows can be used to copy a file to a folder on your local machine.	<input type="radio"/>	<input type="radio"/>
Power Automate flows can be copied to a separate solution for export to another environment.	<input type="radio"/>	<input type="radio"/>

- A. Mastered
B. Not Mastered

Answer: A

Explanation:

Answer Area

Statements	Yes	No
Stages are added under each step of a business process flow design.	<input checked="" type="radio"/>	<input type="radio"/>
Power Automate desktop flows can be used to copy a file to a folder on your local machine.	<input checked="" type="radio"/>	<input type="radio"/>
Power Automate flows can be copied to a separate solution for export to another environment.	<input checked="" type="radio"/>	<input type="radio"/>

NEW QUESTION 230

HOTSPOT - (Topic 7)

For each of the following statements, select Yes if the statement is true. Otherwise, select No.

NOTE: Each correct selection is worth one point.

Answer Area

Statement	Yes	No
Power Virtual Agent chatbots can be created directly in Microsoft Teams.	<input type="radio"/>	<input type="radio"/>
Power Virtual Agent chatbots can use the bot testing feature directly within Microsoft Teams.	<input type="radio"/>	<input type="radio"/>

- A. Mastered
B. Not Mastered

Answer: A

Explanation:

Answer Area

Statement	Yes	No
Power Virtual Agent chatbots can be created directly in Microsoft Teams.	<input checked="" type="radio"/>	<input type="radio"/>
Power Virtual Agent chatbots can use the bot testing feature directly within Microsoft Teams.	<input type="radio"/>	<input checked="" type="radio"/>

NEW QUESTION 234

DRAG DROP - (Topic 7)

A medical office has a model -driven app that uses Common Data Service.

You plan to create a screen that allows users to capture information about doctors. The screen must provide users the ability to enter or select the following information;

- ? a place to enter doctor- profile data that is not pan of the account table or the contact table.
- ? a place to enter the doctor's specialty in the profile form.
- ? a column for insurance with the ability to pick one of 10 different insurance companies.

You need to store the captured data in Common Data Service.

What should you use to store the data? To answer, drag the appropriate components to the correct requirements. Each component may be used once, more than once, or not at all You may need to drag the split bar between panes or scroll to view content.

NOTE: Each correct selection is worth one point.

Options	Answer Area
Entity	
Field	
Option set	
Record	

Requirement	Option
Store additional doctor profile data.	Option
Store information about the doctor's specialty.	Option
Select an insurance company.	Option

- A. Mastered
B. Not Mastered

Answer: A

Explanation:

Options	Answer Area
Entity	
Field	
Option set	
Record	

Requirement	Option
Store additional doctor profile data.	Field
Store information about the doctor's specialty.	Record
Select an insurance company.	Option set

NEW QUESTION 239

- (Topic 7)

A company uses a model-driven app to record customers' dietary preferences.

You need to change the order of the columns in a personal view that you created on the Contact table.

Where should you change the order?

- A. Model-driven app
B. Microsoft Power Platform admin center
C. App designer
D. Power Apps Studio

Answer: A

NEW QUESTION 240

- (Topic 7)

You develop a Power Virtual Agents chatbot in a Microsoft Teams channel named Expenses.

You need to identify the operations the chatbot can perform.

Which two actions can the chatbot perform? Each correct answer presents a complete solution.

NOTE: Each correct selection is worth one point.

- A. Transfer a chat to a live person if the chatbot cannot answer the question.
B. Staff who are not members of the Expenses team can use the chatbot.
C. Trigger a request for approval from a senior manager for high-value expenses.
D. Upload and process a PDF file.

Answer: BC

NEW QUESTION 241

- (Topic 7)

A company wants users to start using Power Automate to improve personal productivity. You need to create a flow.

Which two elements must you include? Each correct answer presents part of the solution. NOTE: Each correct selection is worth one point.

- A. condition
B. expression
C. trigger
D. action

Answer: CD

Explanation:

Reference:

<https://docs.microsoft.com/en-us/power-automate/get-started-logic-flow>

NEW QUESTION 245

DRAG DROP - (Topic 7)

You are assigning record level privileges for Power Apps and Model-Driven Apps.

Which privilege should you use to ensure access for each scenario? To answer, drag the appropriate privileges to the correct requirements. Each privilege may be used once, more than once, or not at all. You may need to drag the split bar between panes or scroll to view content.

NOTE: Each correct selection is worth one point.

Privileges

Append

Assign

Share

Answer Area

Requirement	Privilege
Allow users to grant access to a record they own to other users.	<div></div>
Grant ownership of a record to another user.	<div></div>
Allow the users to associate the current record with another record.	<div></div>

- A. Mastered
- B. Not Mastered

Answer: A

Explanation:

Privileges

Append

Assign

Share

Answer Area

Requirement	Privilege
Allow users to grant access to a record they own to other users.	<div>Share</div>
Grant ownership of a record to another user.	<div>Assign</div>
Allow the users to associate the current record with another record.	<div>Append</div>

NEW QUESTION 246

DRAG DROP - (Topic 7)

A company plans to create a Microsoft Dataverse environment.
For each of the following statements, select Yes if the statement is true. Otherwise, select No.
NOTE: Each correct selection is worth one point.

Answer Area

Statement	Yes	No
You can create a Microsoft Dataverse environment in the Power Platform Admin center.	<div></div>	<div></div>
You must enable data encryption after you create a Microsoft Dataverse environment.	<div></div>	<div></div>
You can control security roles and privileges in a Microsoft Dataverse environment from the Power Apps Admin center.	<div></div>	<div></div>

- A. Mastered
- B. Not Mastered

Answer: A

Explanation:

Answer Area

Statement	Yes	No
You can create a Microsoft Dataverse environment in the Power Platform Admin center.	<div></div>	<div></div>
You must enable data encryption after you create a Microsoft Dataverse environment.	<div></div>	<div></div>
You can control security roles and privileges in a Microsoft Dataverse environment from the Power Apps Admin center.	<div></div>	<div></div>

NEW QUESTION 250

DRAG DROP - (Topic 7)

You are creating a Power Automate flow.
You need to retrieve data from several sources deluding Microsoft Excel, Azure Data lake, and GitHub.
What should you use? To answer, drag the appropriate components to the correct data sources. Each component may be used once, more than once, or not at all.
You may need to drag the split bar between panes or scroll to view content.
NOTE: Each correct selection Is worth one point

Components

Connector

Expression

Formula

Answer Area

Data source	Component
Microsoft Excel	<div></div>
Azure Data Lake	<div></div>
GitHub	<div></div>

- A. Mastered
- B. Not Mastered

Answer: A

Explanation:

Box 1: Formula

Reading an Excel document retrieves the data from the document, allowing it to be processed and modified in flows.

Read and extract data from an Excel document with the Read from Excel worksheet action. Box 2: Connector

Azure Data Lake Store connector allows you to read and add data to an Azure Data Lake account.

The Azure Data Lake connector is available for Power Automate. Box 3: Expression

NEW QUESTION 251

- (Topic 7)

A company is implementing Power Automate to streamline operations.

The head of customer support relations needs a Power Automate flow that texts a manager when an email meets the following criteria:

- The email is sent as high priority.
- The email is from a customer.

You need to identify how the flow's decision point will know whether the criteria are met. What should you use?

- A. data operations
- B. expressions
- C. variables
- D. actions
- E. triggers

Answer: C

NEW QUESTION 252

DRAG DROP - (Topic 7)

You plan to use Power Automate to monitor what people are saying about your company's products. You store the feedback for research and development purposes.

You need to recommend Power Automate components to use for the solution.

To answer drag the appropriate components to the correct requirements. Each component may be used once, more than once, or not at all. You may need to drag the split Car between panes or scroll to view content.

NOTE: Each correct selection is worth one point

Components

action

expression

service

trigger

Answer Area

Requirement

Retrieve the top five posts from your company's Facebook page.

Enter the resulting posts into the product database.

Combine author and link fields into a single field.

Run a flow every hour.

Component

Component

Component

Component

- A. Mastered
- B. Not Mastered

Answer: A

Explanation:

Components

action

expression

service

trigger

Answer Area

Requirement

Retrieve the top five posts from your company's Facebook page.

Enter the resulting posts into the product database.

Combine author and link fields into a single field.

Run a flow every hour.

Component

action

action

expression

trigger

NEW QUESTION 253

- (Topic 7)

A company uses Power Apps canvas apps.

When a user opens Power Apps Studio in a browser and selects Apps I can edit, they do not see an app that they need to modify.

You need to determine why the user cannot see the app.

What are three possible reasons? Each correct answer presents a complete solution.

NOTE: Each correct selection is worth one point.

- A. The user selected an incorrect Power Apps environment.
- B. The user has not been granted the System Customizer role.
- C. The user has not been set as the app co-owner.
- D. The app has not been shared with the user.
- E. The environment does not have a Common Data Service database.

Answer: ACD

Explanation:

Reference:

<https://docs.microsoft.com/en-us/powerapps/maker/canvas-apps/edit-app>

NEW QUESTION 254

DRAG DROP - (Topic 7)

You need to explain the major components of the Common Data Model (CDM) and their functions.

Match each term to its definition.

Instructions: To answer, drag the appropriate term from the column on the left to its definition on the right. Each term may be used once, more than once, or not at all. Each correct match is worth one point.

NOTE: Each correct selection is worth one point.

Tools		Answer Area	
		Purpose	Tool
Entities	Data connectors	Helps jumpstart application development by leveraging business logic, security, and integrations	
Common Data Service	Common Data Model	A set of records used to store data	
Workflows			

- A. Mastered
B. Not Mastered

Answer: A

Explanation:

Tools		Answer Area	
		Purpose	Tool
Entities	Data connectors	Helps jumpstart application development by leveraging business logic, security, and integrations	Common Data Service
Common Data Service	Common Data Model	A set of records used to store data	Entities
Workflows			

NEW QUESTION 255

DRAG DROP - (Topic 7)

A company plans to implement Power BI.

The company wants to implement some specific features that Power BI does not include. You need to recommend solutions for the company.

What should you recommend? To answer, drag the appropriate solutions to the correct requirement. Each solution may be used once, more than once, or not at all. You may need to drag the split bar between panes or scroll to view content.

NOTE: Each correct selection is worth one point.

Solutions		Answer Area	
		Requirement	Solution
Microsoft AppSource		Evaluate solutions that meet current gaps in Power BI capabilities.	Solution
Microsoft Lifecycle Services		Evaluate the services of multiple companies to identify a partner that can assist in building a proof-of-concept solution.	Solution
Microsoft Azure Marketplace			

- A. Mastered
B. Not Mastered

Answer: A

Explanation:

Solutions		Answer Area	
		Requirement	Solution
Microsoft AppSource		Evaluate solutions that meet current gaps in Power BI capabilities.	Microsoft AppSource
Microsoft Lifecycle Services		Evaluate the services of multiple companies to identify a partner that can assist in building a proof-of-concept solution.	Microsoft AppSource
Microsoft Azure Marketplace			

NEW QUESTION 259

HOTSPOT - (Topic 7)

You are building Power BI visualizations for a team.

For each of the following statements, select Yes if the statement is true. Otherwise, select No.

NOTE: Each correct selection is worth one point.

Answer Area		
Statement	Yes	No
Power BI can only retrieve data from up to two different sources for each dashboard.	<input type="radio"/>	<input type="radio"/>
Power BI visualizations can be used in canvas apps and model driven apps.	<input type="radio"/>	<input type="radio"/>
Power BI can display charts and list boxes on dashboards.	<input type="radio"/>	<input type="radio"/>

- A. Mastered
B. Not Mastered

Answer: A

Explanation:

Statement	Yes	No
Power BI can only retrieve data from up to two different sources for each dashboard.	<input checked="" type="radio"/>	<input type="radio"/>
Power BI visualizations can be used in canvas apps and model driven apps.	<input checked="" type="radio"/>	<input type="radio"/>
Power BI can display charts and list boxes on dashboards.	<input checked="" type="radio"/>	<input type="radio"/>

When you complete testing, you must copy the business process flow to a production environment without bringing any data or other modifications with it. You must meet the requirements. What should you do?

- A. Export the default solution.
- B. Export the form that contains the business process flow to a separate solution.
- C. Add the business process flow to a separate solution.
- D. Export the solution.
- E. Create a view and export the view.

NOTE: Each correct selection is worth one point.

Statements	Yes	No
only tool used to create reports to be published to the Power BI service.	<input type="radio"/>	<input type="radio"/>
calculated columns.	<input type="radio"/>	<input type="radio"/>
calculated columns.	<input type="radio"/>	<input type="radio"/>

- A. Mastered
B. Not Mastered

Answer Area

Statements	Yes	No
only tool used to create reports to be published to the Power BI service.	<input type="radio"/>	<input checked="" type="radio"/>
calculated columns.	<input type="radio"/>	<input checked="" type="radio"/>
calculated columns.	<input checked="" type="radio"/>	<input type="radio"/>

NOTE: Each correct selection is worth one point.

NOTE: Each correct selection is worth one point.

Operations	Answer Area	Action	Operation
Trigger		Import into Microsoft Dataverse.	
Action		Synchronize data to ERP system.	
Business process flow			
Business rule			

- ### A. Mastered

B. Not Mastered

Answer: A

Explanation:

Operations		Answer Area		Action		Operation
Trigger				Import into Microsoft Dataverse.		Trigger
Action				Synchronize data to ERP system.		Business process flow
Business process flow	•					
Business rule	•					
	•					
	•					

NEW QUESTION 273

DRAG DROP - (Topic 7)

A customer service department uses Microsoft Dynamics 365 Customer Service to manage repair requests. The repair team tracks their efforts using a Microsoft SharePoint list. The company must use Microsoft Power Platform to connect the repair team with the Dynamics 365 Customer Service solution. The solution must meet the following requirements:

Requirement Number	Requirement
Requirement 1	From a custom page in the Dynamics 365 interface, allow the customer service team to input a repair number, view the details of the corresponding SharePoint list item, and add notes for the repair team.
Requirement 2	Create a report that visualizes real-time customer service information that the repair team can access online and use to create dashboards.
Requirement 3	Automatically send a Microsoft Teams message to a customer service agent and an email to the customer when a repair team member completes a repair.

You need to implement the appropriate technologies to meet the requirements.

Which technologies should you use? To answer, drag the appropriate technologies to the correct scenarios. Each technology may be used once, more than once, or not at all. You may need to drag the split bar between panes or scroll to view content.

NOTE: Each correct selection is worth one point.

Technologies		Answer Area		Scenario		Technology
Microsoft Power BI				Requirement 1		
Canvas app	•			Requirement 2		
Microsoft Power Automate	•			Requirement 3		
Microsoft Power Virtual Agents chatbot	•					

A. Mastered

B. Not Mastered

Answer: A

Explanation:

Technologies		Answer Area		Scenario		Technology
Microsoft Power BI				Requirement 1		Microsoft Power Automate
Canvas app	•			Requirement 2		Microsoft Power BI
Microsoft Power Automate	•			Requirement 3		Microsoft Power Virtual Agents chatbot
Microsoft Power Virtual Agents chatbot	•					

NEW QUESTION 274

HOTSPOT - (Topic 7)

A company plans to use Power BI to visualize data.

Instructions: For each of the following statements, select Yes if the statement is true. Otherwise, select No.

NOTE: Each correct selection is worth one point.

Answer Area	Yes	No
Power BI allows users to create and consume visualizations in one view by using data from several different sources.	<input type="radio"/>	<input type="radio"/>
Power Platform uses Microsoft SQL Server databases to securely store and manage data used by business applications.	<input type="radio"/>	<input type="radio"/>

A. Mastered

B. Not Mastered

Answer: A

Explanation:

Answer Area	Yes	No
Power BI allows users to create and consume visualizations in one view by using data from several different sources.	<input checked="" type="radio"/>	<input type="radio"/>
Power Platform uses Microsoft SQL Server databases to securely store and manage data used by business applications.	<input type="radio"/>	<input checked="" type="radio"/>

NEW QUESTION 278

DRAG DROP - (Topic 7)

A company is implementing a customer service solution by using Dynamics 365 Customer Service. The company is extending the solution to meet additional business requirements.

The solution has the following requirements:

- Customers can log on to a secure website and view the progress of customer service tickets.
- Refund requests over a certain value can be automatically sent for managerial approval in Microsoft Teams.
- Create a custom page showing a gallery of pictures within the Dynamics 365 Customer Service app.

You need to use Microsoft Power Platform technologies to implement the solution. Which technology should you use? To answer, drag the appropriate technologies to the

correct requirements. Each technology may be used once, more than once, or not at all.

You may need to drag the split bar between panes or scroll to view content. NOTE: Each correct selection is worth one point.

Technologies		Requirement	Technology
Power Apps portals		Customers can log on to a secure website and view the progress of customer service tickets.	
Power Automate		Refund requests over a certain value can be automatically sent for managerial approval in Microsoft Teams.	
Canvas apps		Create a custom page showing a gallery of pictures within the Dynamics 365 Customer Service app.	

A. Mastered

B. Not Mastered

Answer: A

Explanation:

Technologies		Requirement	Technology
Power Apps portals		Customers can log on to a secure website and view the progress of customer service tickets.	Power Apps portals
Power Automate		Refund requests over a certain value can be automatically sent for managerial approval in Microsoft Teams.	Power Automate
Canvas apps		Create a custom page showing a gallery of pictures within the Dynamics 365 Customer Service app.	Canvas apps

NEW QUESTION 282

DRAG DROP - (Topic 7)

A company uses Dynamics 365 Sales. You have the following requirements:

- View analytics on accounts.
- The model-driven app must automatically send an approval form to a manager when the purchase price is greater than \$10,000.
- Create a chatbot for the webpage to interact with customer questions.

You must use Microsoft Power Platform to extend the capabilities of Dynamics 365 Sales. You need to select an application for each requirement.

Which application should you use? To answer, drag the appropriate application to the correct requirement. Each application may be used once, more than once, or not at all. You may need to drag the split bar between panes or scroll to view content.

NOTE: Each correct selection is worth one point.

Applications		Requirement	Application
Power BI		View analytics on accounts.	
Power Automate		Automatically send approval.	
Power Virtual Agents		Create chatbot for webpages.	
Power Portals			

A. Mastered

B. Not Mastered

Answer: A

Explanation:

Applications		Requirement	Application
Power BI		View analytics on accounts.	Power BI
Power Automate		Automatically send approval.	Power Automate
Power Virtual Agents		Create chatbot for webpages.	Power Virtual Agents
Power Portals			

NEW QUESTION 284

HOTSPOT - (Topic 7)

Instructions: For each of the following statements, select Yes if the statement is true. Otherwise, select No.

NOTE: Each correct selection is worth one point.

Answer Area			
Statements		Yes	No
You can connect to external resources with Power BI Desktop but not with the Power BI service.		<input type="radio"/>	<input type="radio"/>
You can build and edit Power BI reports by using Power BI Desktop or the Power BI service.		<input type="radio"/>	<input type="radio"/>
The only way to distribute a Power BI Desktop report is by sending the PBIX file to others.		<input type="radio"/>	<input type="radio"/>

- A. Mastered
- B. Not Mastered

Answer: A

Explanation:

Answer Area			
Statements		Yes	No
You can connect to external resources with Power BI Desktop but not with the Power BI service.		<input checked="" type="radio"/>	<input type="radio"/>
You can build and edit Power BI reports by using Power BI Desktop or the Power BI service.		<input checked="" type="radio"/>	<input type="radio"/>
The only way to distribute a Power BI Desktop report is by sending the PBIX file to others.		<input type="radio"/>	<input checked="" type="radio"/>

NEW QUESTION 285

DRAG DROP - (Topic 7)

A manufacturing company is building a model-driven app to manage its warehouse. The app has two custom tables: Order and Batch. You need to identify the appropriate component for each required function of the app. Which component should you choose for each function? To answer, drag the appropriate components to the correct functions. Each component may be used once, more than once, or not at all. You may need to drag the split bar between panes or scroll to view content. NOTE: Each correct selection is worth one point.

Components	Answer Area											
<div>Business process flow</div> <div>Business rule</div> <div>Dashboard</div> <div>View</div>	<div><div></div><div></div><div></div><div></div></div>	<table><tr><th>Function</th><th>Component</th></tr><tr><td>Display a set of charts visualizing the order and batch data at the same time.</td><td><div></div></td></tr><tr><td>Guide users through the standard process of picking and shipping an order.</td><td><div></div></td></tr><tr><td>Show a list of all orders and allow users to reorder the columns.</td><td><div></div></td></tr><tr><td>Make the shelf number mandatory on a form when a user records the aisle location of a batch.</td><td><div></div></td></tr></table>	Function	Component	Display a set of charts visualizing the order and batch data at the same time.	<div></div>	Guide users through the standard process of picking and shipping an order.	<div></div>	Show a list of all orders and allow users to reorder the columns.	<div></div>	Make the shelf number mandatory on a form when a user records the aisle location of a batch.	<div></div>
Function	Component											
Display a set of charts visualizing the order and batch data at the same time.	<div></div>											
Guide users through the standard process of picking and shipping an order.	<div></div>											
Show a list of all orders and allow users to reorder the columns.	<div></div>											
Make the shelf number mandatory on a form when a user records the aisle location of a batch.	<div></div>											

- A. Mastered
- B. Not Mastered

Answer: A

Explanation:

Components	Answer Area											
<div>Business process flow</div> <div>Business rule</div> <div>Dashboard</div> <div>View</div>	<div><div></div><div></div><div></div><div></div></div>	<table><tr><th>Function</th><th>Component</th></tr><tr><td>Display a set of charts visualizing the order and batch data at the same time.</td><td>Dashboard</td></tr><tr><td>Guide users through the standard process of picking and shipping an order.</td><td>Business process flow</td></tr><tr><td>Show a list of all orders and allow users to reorder the columns.</td><td>View</td></tr><tr><td>Make the shelf number mandatory on a form when a user records the aisle location of a batch.</td><td>Business rule</td></tr></table>	Function	Component	Display a set of charts visualizing the order and batch data at the same time.	Dashboard	Guide users through the standard process of picking and shipping an order.	Business process flow	Show a list of all orders and allow users to reorder the columns.	View	Make the shelf number mandatory on a form when a user records the aisle location of a batch.	Business rule
Function	Component											
Display a set of charts visualizing the order and batch data at the same time.	Dashboard											
Guide users through the standard process of picking and shipping an order.	Business process flow											
Show a list of all orders and allow users to reorder the columns.	View											
Make the shelf number mandatory on a form when a user records the aisle location of a batch.	Business rule											

NEW QUESTION 289

HOTSPOT - (Topic 7)

A company uses Microsoft Power Platform to connect to multiple data sources and manage business data. The low-code components in Microsoft Power Platform must be able to create and update data in these data sources. You need to access the required data by using Microsoft Power Platform components. Which component should you use for each requirement? To answer, select the appropriate options in the answer area. NOTE: Each correct selection is worth one point.

Answer Area

Requirement	Component
Update data in an API hosted in Azure.	<div>Custom connector</div> <div>Custom connector</div> <div>Microsoft Dataverse</div> <div>Power Query</div>
Update files in SharePoint document library folders.	<div>Power Query</div> <div>Microsoft Teams connector</div> <div>Microsoft Dataverse</div> <div>Power Query</div> <div>Standard connector</div>
Ingest and transform data into Microsoft Dataverse by using dataflows.	<div>Microsoft Dataverse</div> <div>Microsoft Dataverse</div> <div>Power Query</div> <div>Standard connector</div>

- A. Mastered
B. Not Mastered

Answer: A

Explanation:

Answer Area

Requirement	Component
Update data in an API hosted in Azure.	<div>Custom connector</div> <div>Custom connector</div> <div>Microsoft Dataverse</div> <div>Power Query</div>
Update files in SharePoint document library folders.	<div>Power Query</div> <div>Microsoft Teams connector</div> <div>Microsoft Dataverse</div> <div>Power Query</div> <div>Standard connector</div>
Ingest and transform data into Microsoft Dataverse by using dataflows.	<div>Microsoft Dataverse</div> <div>Microsoft Dataverse</div> <div>Power Query</div> <div>Standard connector</div>

NEW QUESTION 291

- (Topic 7)

You are using Power Virtual Agents to create a chatbot for your Power Apps portal.
You need the chatbot to start from the beginning of the conversation if user input is unrecognized.
What should you configure?

- A. Trigger
B. Error message
C. Fallback topic
D. AI features

Answer: D

NEW QUESTION 295

- (Topic 7)

A company uses a manual process to manage escalations for customer support calls. You must use Power Automate to automate the process for routing escalated calls. You need to create the flow. Which type of connector should you use?

- A. Office 365 Users
B. Microsoft Excel
C. Microsoft Dataverse

Answer: C

NEW QUESTION 299

HOTSPOT - (Topic 7)

_____ . You want to create a Power Apps app that allows you to define a custom Sitemap. What should you do? To answer, select the appropriate options in the answer area.

- A. Mastered
B. Not Mastered

Answer: A

Explanation:

Navigate to the Power Apps portal and create

a canvas app.

a model-driven app.

a portal app.

an app by using a template.

NEW QUESTION 302

- (Topic 7)

A company uses a Power Apps canvas app to enter information. The canvas app uses a Microsoft SharePoint list to store information. A user manually copies the information to a Microsoft Dataverse instance. You must automate the manual process. You need to create a solution to meet the requirement. What should you do?

- A. Create a Power Automate cloud flow with no connectors.
- B. Create a Power Apps Component Framework (PCF) control for the OnSave event.
- C. Create a Power Automate cloud flow with a connector to email.
- D. Create a business process flow that calls a Power Automate desktop flow.
- E. Create a Power Apps Component Framework (PCF) control for the OnLoad events.

Answer: D

NEW QUESTION 305

HOTSPOT - (Topic 7)

You ate creating a model-driven app.

Instructions: For each of the following statements, select Yes if the statement is true. Otherwise, select No.

NOTE: Each correct selection is worth one point.

Answer Area

	Yes	No
To add entities to an app, entities are dragged onto the app canvas from the components area.	<input type="radio"/>	<input type="radio"/>
View definition is created in the component area of the app designer.	<input type="radio"/>	<input type="radio"/>
You must save, validate, and publish your app for others to see the changes.	<input type="radio"/>	<input type="radio"/>

- A. Mastered
- B. Not Mastered

Answer: A

Explanation:

Answer Area

	Yes	No
To add entities to an app, entities are dragged onto the app canvas from the components area.	<input type="radio"/>	<input checked="" type="radio"/>
View definition is created in the component area of the app designer.	<input checked="" type="radio"/>	<input type="radio"/>
You must save, validate, and publish your app for others to see the changes.	<input checked="" type="radio"/>	<input type="radio"/>

NEW QUESTION 310

DRAG DROP - (Topic 7)

A company uses a model-driven app for its sales team.

You must customize a form to meet the following requirements:

- If a check box is checked, a hidden field must appear.
- The form must display a list of customers and fields about customers.

You need to identify the components a developer must configure to meet the requirements. What should you identify?

Components

Column

View

Form

Table

Answer Area

Requirement

Hidden field appears

List of customers and fields displays

Component

Component

Component

- A. Mastered

B. Not Mastered

Answer: A

Explanation:

Components

Column

View

Form

Table

Requirement

Hidden field appears

List of customers and fields displays

Component

Form

Table

NEW QUESTION 315

HOTSPOT - (Topic 7)

For each of the following statements, select Yes if the statement is true. Otherwise, select No.

NOTE: Each correct selection is worth one point.

Statement	Yes	No
Sharing a model-driven app and sharing a canvas app both send an email with the link to the app to the users.	<input type="radio"/>	<input type="radio"/>
Administrators assign Power Platform security roles and permissions identically for canvas apps, model-driven apps, and shared apps.	<input type="radio"/>	<input type="radio"/>
You must publish both personal and system views before a user may consume them.	<input type="radio"/>	<input type="radio"/>

A. Mastered

B. Not Mastered

Answer: A

Explanation:

Yes, No, No

NEW QUESTION 319

HOTSPOT - (Topic 7)

A company plans to create Power Platform apps that use industry-standard and proprietary data sources.

For each of the following statements, select Yes if the statement is true. Otherwise, select No.

NOTE: Each correct selection is worth one point.

Answer Area

Statement	Yes	No
Custom connectors can be used if a standard connector for the service is available.	<input type="radio"/>	<input type="radio"/>
Custom connectors are supported in instant flows only.	<input type="radio"/>	<input type="radio"/>
Standard and custom connectors can be mixed within the same flow or app.	<input type="radio"/>	<input type="radio"/>

A. Mastered

B. Not Mastered

Answer: A

Explanation:

Answer Area

Statement	Yes	No
Custom connectors can be used if a standard connector for the service is available.	<input checked="" type="radio"/>	<input type="radio"/>
Custom connectors are supported in instant flows only.	<input type="radio"/>	<input checked="" type="radio"/>
Standard and custom connectors can be mixed within the same flow or app.	<input checked="" type="radio"/>	<input type="radio"/>

NEW QUESTION 323

- (Topic 7)

A company creates canvas apps that us a data source from its sales team.

To meet company device policies, you must determine the available app formats the sales team can select when the sales team creates the canvas.
You need to determine the available app formats.
Which two app formats should you select? Each correct answer presents a complete solution.
NOTE Each correct selection is worth one point.

- A. Mobile
- B. iOS
- C. Desktop
- D. Tablet
- E. Android

Answer: AD

NEW QUESTION 326

DRAG DROP - (Topic 7)

Match each type of Power Apps app to its capability.

To answer, drag the appropriate app type from the column on the left to its capability on the right. Each app type may be used once, more than once, or not at all
NOTE Each correct match is worth one point.

App types		Answer Area		App type
Canvas app		Capability		
Model-driven app		Enables fully customizable layout, design, and color scheme		
		Connects to multiple data sources		
		Uses business process flows to guide users through a data entry process		
		Scans barcodes		

- A. Mastered
- B. Not Mastered

Answer: A

Explanation:

App types		Answer Area		App type
Canvas app		Capability		Canvas app
Model-driven app		Enables fully customizable layout, design, and color scheme		Canvas app
		Connects to multiple data sources		Model-driven app
		Uses business process flows to guide users through a data entry process		Canvas app
		Scans barcodes		

NEW QUESTION 330

HOTSPOT - (Topic 7)

Institutions: For each of the following statements, select Yes if the statement is true. Otherwise, select No.

NOTE: Each correct selection is worth one point.

Statements	Yes	No
A Microsoft Power Platform environment must contain a Microsoft Dataverse database.	<input type="radio"/>	<input type="radio"/>
An app created in an environment can only connect to the data sources that are deployed in the same environment.	<input type="radio"/>	<input type="radio"/>
Microsoft Dataverse for Teams environments are automatically created for all members of the team when you create a Microsoft Power Platform app in Microsoft Teams.	<input type="radio"/>	<input type="radio"/>

- A. Mastered
- B. Not Mastered

Answer: A

Explanation:

Statements	Yes	No
A Microsoft Power Platform environment must contain a Microsoft Dataverse database.	<input type="radio"/>	<input checked="" type="radio"/>
An app created in an environment can only connect to the data sources that are deployed in the same environment.	<input checked="" type="radio"/>	<input type="radio"/>
Microsoft Dataverse for Teams environments are automatically created for all members of the team when you create a Microsoft Power Platform app in Microsoft Teams.	<input checked="" type="radio"/>	<input type="radio"/>

NEW QUESTION 332

- (Topic 7)

You create a multi-page Power BI report for an organization.

You must enable salespeople in the organization to use the report to view data relevant to their sales region only.

You need to enable security for the report. What should you use?

- A. Microsoft Trust Center
- B. row-level security
- C. data loss prevention policies
- D. sensitivity labels
- E. Microsoft Azure Active Directory

Answer: B

NEW QUESTION 333

DRAG DROP - (Topic 7)

You create a Power Pages site to share Microsoft Dataverse data with external customers. Customers must be authenticated to view data. You need to configure Power Pages.

Which component should you use for each requirement? To answer, drag the appropriate components to the correct requirements. Each component may be used once, more than once, or not at all. You may need to drag the split bar between panes or scroll to view content.

NOTE: Each correct selection is worth one point.

Form

IFrame

List

Section

Answer Area

Requirement

Collect data from customers and store the data in a table.

Display multiple rows from a table.

Component

- A. Mastered
- B. Not Mastered

Answer: A

Explanation:

Form

IFrame

List

Section

Answer Area

Requirement

Collect data from customers and store the data in a table.

Display multiple rows from a table.

Component

Form

List

NEW QUESTION 338

- (Topic 7)

A company creates canvas apps for its sales team. A user creates a canvas app from a data source. You need to determine the screens created.

Which three screens should you identify? Each correct answer presents part of the solution.

NOTE: Each correct selection is worth one point.

- A. welcome
- B. edit/create
- C. browse
- D. details
- E. delete

Answer: BCD

NEW QUESTION 343

- (Topic 7)

A company is evaluating ways that they can implement AI Builder.

For which two scenarios can you use AI Builder? Each correct selection presents a complete solution.

NOTE: Each correct selection is worth one point.

- A. Send emails to all ai users who subscribe to a service.
- B. Synchronize data from an external database.
- C. Collect data from several data sources and display a dashboard that shows trending data.
- D. Interpret images and perform an action on the image.
- E. Detect patterns in data and predict outcomes

Answer: BD

NEW QUESTION 348

DRAG DROP - (Topic 7)

You create a Power Pages site to share Microsoft Dataverse data with external customer. Customer must be authenticated to view data.

Which component should you use for each requirement? To answer, drag the appropriate component to the correct requirements. Each component may be used more once than once, or not at all. You may need to drag the spilt bar between panes or scroll to view content.

Components

Form

IFrame

List

Section

Answer Area

Requirement

Collect data from customers and store the data in a table.
Display multiple rows from a table.

Component

- A. Mastered
- B. Not Mastered

Answer: A

Explanation:

Components

Form

IFrame

List

Section

Answer Area

Requirement

Collect data from customers and store the data in a table.
Display multiple rows from a table.

Component

Form

List

NEW QUESTION 352

HOTSPOT - (Topic 7)
You receive a copy of a Power Automate cloud flow from a colleague.
For each of the following statements, select Yes if the statement is true. Otherwise, select No.
NOTE: Each correct selection is worth one point.

Answer Area

Statement	Yes	No
You can create a new flow that is a copy of the original flow.	<input type="radio"/>	<input type="radio"/>
You can modify the original flow.	<input type="radio"/>	<input type="radio"/>

- A. Mastered
- B. Not Mastered

Answer: A

Explanation:

Answer Area

Statement	Yes	No
You can create a new flow that is a copy of the original flow.	<input checked="" type="radio"/>	<input type="radio"/>
You can modify the original flow.	<input type="radio"/>	<input checked="" type="radio"/>

NEW QUESTION 355

DRAG DROP - (Topic 7)
A company implements Microsoft Power Platform.
Sales team members must take photos for their travel expense receipts and enter basic information about purchases.
The accounting team must be able to view and update records in a shared Microsoft Excel document on mobile devices.
You need to select the type of Power Apps app for each scenario.
Which type of app should you use? To answer, drag the appropriate apps to the correct scenarios- Each app may be used once, more than once, or not at all. You may need to drag the split bar between panes or scroll to view content

Apps

Canvas app

Model-driven app

Answer Area

Scenario

Sales team

Accounting team

App

- A. Mastered
- B. Not Mastered

Answer: A

Explanation:



NEW QUESTION 357

- (Topic 7)

A company using Power Platform is implementing Power BI. The company plans to connect to several datasources and create reports and dashboards. You need to identify the data sources they can connect to. Which two data sources should you use? Each correct answer presents a complete solution. NOTE: Each correct selection is worth one point.

- A. Microsoft OneNote
- B. Microsoft Dataverse
- C. Microsoft Excel
- D. Microsoft Word

Answer: BC

NEW QUESTION 361

- (Topic 7)

A hotel develops a housekeeping checklist for its housekeeping staff to use when they finish cleaning a room. The housekeeping staff must be able to use their mobile device to add a check mark for each completed task and take a picture of the prepared bed. The results of the checklist for each room must be stored in a SharePoint list. You need to select the Microsoft Power Platform component that fulfills the requirement. Which component should you select?

- A. Power Pages site
- B. Power Virtual Agents Chabot
- C. Power BI report
- D. Model-driven app
- E. Canvas app

Answer: E

NEW QUESTION 364

DRAG DROP - (Topic 7)

A team of five people plans to create Power Platform solutions for a company. Team member plan to initially use Power Platform trail instances to create solutions. Team members have questions about how many Power Platform instances and Common Data Service databases they need. You need to respond to the team. How should you respond? To answer, drag the appropriate responses to the correct questions. Each response may be used once, more than once, or not at all. You may need to drag the split bar between panes or scroll to view content.



- A. Mastered
- B. Not Mastered

Answer: A

Explanation:



NEW QUESTION 365

DRAG DROP - (Topic 7)

You are creating a Power Apps solution for a company that manufactures bicycles. The company has The following requirements:
• A vendor uploads a Microsoft Excel workbook to the company each week. The workbook contains lists of parts and their current prices. You must automatically Import the data into Microsoft Dataverse as soon as the workbook is uploaded. You must send specific users an alert when new files are uploaded.
• Synchronize customer data with a proprietary accounting database when a user selects a button on the Account form.
You need to recommend the trigger types to use to meet the requirements.

Which trigger types should you use? To answer, drag the appropriate trigger types to the correct requirements. Each trigger type may be used once, more than once, or not at all. You may need to drag the split bar between panes or scroll to view content.
NOTE: Each correct selection is worth one point.

Trigger types	Requirement	Trigger type
Push trigger	Send a notification when an Excel workbook is uploaded.	Trigger type
Polling trigger	Synchronize customer data with a proprietary accounting database.	Trigger type
Triggers for scheduled flows		
Triggers for business process flow		

- A. Mastered
- B. Not Mastered

Answer: A

Explanation:

Trigger types	Requirement	Trigger type
Push trigger	Send a notification when an Excel workbook is uploaded.	Push trigger
Polling trigger	Synchronize customer data with a proprietary accounting database.	Triggers for business process flow
Triggers for scheduled flows		
Triggers for business process flow		

NEW QUESTION 369

- (Topic 7)
A user requests removal of the fax column from the following form in a model-driven app:

The screenshot shows a Power Apps form for 'Alpine Ski House'. The form has a left-hand navigation pane with 'Accounts' selected. The main area displays 'ACCOUNT INFORMATION' with fields for Account Name, Phone, Fax, Website, Parent Account, and Ticker Symbol. The 'Fax' field is currently empty. Below this is an 'ADDRESS' section with 'Address 1: Street 1' and '1 Alpine Lane'. On the right, there is a 'Timeline' section showing a recent note: 'Modified on: 1/1/2023 6:40 PM' by 'FNU UNU'.

You need to remove the fax column.
Which form should you open in the app designer?

- A. Alpine Ski House
- B. Summary
- C. Information
- D. Account

Answer: D

NEW QUESTION 372

- (Topic 7)
A company is building apps to support their business operations. The apps will use connectors to access data from several data sources and respond to a number of events generated by components.
Which two operations can you use for connectors? Each correct answer presents part of the solution.
NOTE: Each correct selection is worth one point.

- A. Triggers
- B. Plug-ins
- C. Actions
- D. Gateways

Answer: CD

NEW QUESTION 377

HOTSPOT - (Topic 7)
Instructions: For each of the following statements, select Yes if the statement is true. Otherwise, select No.

NOTE: Each correct selection is worth one point.

Answer Area

	Yes	No
The date and time are the triggers for a scheduled cloud flow.	<input type="radio"/>	<input type="radio"/>
Cloud flows must be exported to a Microsoft Excel file to copy them to another environment.	<input type="radio"/>	<input type="radio"/>
Users must create desktop flows to share them without being an administrator.	<input type="radio"/>	<input type="radio"/>

- A. Mastered
- B. Not Mastered

Answer: A

Explanation:

Answer Area

	Yes	No
The date and time are the triggers for a scheduled cloud flow.	<input type="radio"/>	<input checked="" type="radio"/>
Cloud flows must be exported to a Microsoft Excel file to copy them to another environment.	<input type="radio"/>	<input checked="" type="radio"/>
Users must create desktop flows to share them without being an administrator.	<input type="radio"/>	<input checked="" type="radio"/>

NEW QUESTION 381

- (Topic 7)
A company is considering using Power Pages for its website. You need to identify the capabilities of Power Pages. What are two capabilities of Power Pages? Each correct answer presents a complete solution.
NOTE: Each correct selection is worth one point.

- A. Supporting multiple language
- B. Creating customized styling for each user
- C. Providing low-code websites hosted as a service
- D. Supplying OData feeds

Answer: AC

NEW QUESTION 385

- (Topic 7)
A company uses Microsoft Power Platform to monitor social media. You create a Power Automate cloud flow to process social message that positively mention the company and its product. You need to choose a connector to perform sentiment analysis on the social media messages. Which two connectors can you use in the flow? Each correct answer presents solution. NOTE: Each correct selection is worth one point.

- A. Azure Communication Services Chat
- B. Language-Question Answering
- C. Azure Cognitive Service for Language
- D. AI Builder
- E. Azure Application Insights

Answer: CD

NEW QUESTION 387

.....

Thank You for Trying Our Product

* 100% Pass or Money Back

All our products come with a 90-day Money Back Guarantee.

* One year free update

You can enjoy free update one year. 24x7 online support.

* Trusted by Millions

We currently serve more than 30,000,000 customers.

* Shop Securely

All transactions are protected by VeriSign!

100% Pass Your PL-900 Exam with Our Prep Materials Via below:

<https://www.certleader.com/PL-900-dumps.html>